



**TOYOTA LANDCRUISER PRADO 7 SEAT
WITHOUT SUNROOF
FRONT POSITION KIT INSTALLATION
INSTRUCTION—Part # 609372
FOR USE WITH CARGO BARRIER PART NUMBER 609350 ONLY**



The installation kit contains sufficient components for conversion of part number 609350 into a two position cargo barrier for vehicles without sunroof fitted. A high degree of technical competence is necessary to correctly install this product.

We recommend this kit be installed by an authorised outlet to ensure the cargo barrier installation complies with AS/NZS 4034 Standard.

Installation time approximately 1/4 Hour



WARNINGS

- Strict compliance with fitting instructions is essential for this safety product to meet its rated capacity. Refer user instructions regarding correct usage of the cargo barrier.
- Do not modify cargo barrier in any way.
- Do not use this cargo barrier in any other vehicle for which it is not designed.
- Modifications to the cargo barrier or its fixings or use in any other vehicle for which it is not designed may void the load rating and warranty.
- Do not attach the cargo barrier to the vehicle using seat, seat belt or child restraint anchorage's.
- Where high tensile threaded fasteners are used, the cargo barrier must be installed using the size and grade fasteners specified by Milford Industries.
- Do not drill, rivet, adhere or attach objects to the front or rear of the cargo barrier.
- Do not place smaller items, that may bypass the cargo barrier in the event of heavy braking or collision, near the edges of the barrier.
- Position the load against the cargo barrier.
- When load is positioned against cargo barrier, secure the load with a restraint system.
- During a collision moving cargo may damage seat belts or tether straps of a child restraint device, or its anchorage. Load should be carefully positioned so as not to come in contact with these items.
- Do not obstruct seat belts or child restraints, or their operation.
- Long thin items of cargo should be positioned in the vehicle with the long axis across the vehicle to minimise the penetration risk.
- If involved in an accident or accidentally damaged, the cargo barrier should be replaced and the anchorage's repaired to as new condition.
- Clean with soap and water only. Do not use solvents or chemicals. Discard cargo barrier if it becomes rusted. Do not expose to direct sunlight for long periods.
- It is extremely dangerous to ride in the cargo area of the vehicle behind the cargo barrier. It is recommended that the cargo barrier be removed. In a collision people or children riding unrestrained in these areas are more likely to be seriously injured or killed.
- Never leave a child in the vehicle unattended, particularly in the rear cargo area. The cargo area should never be used as a play area for children.
- The cargo barrier may deform and significantly intrude into occupant's space in an accident.
- Remember that the tailgate cannot be opened from inside the cargo area.
- The fixed labeling should not be removed from the cargo barrier.
- Failure to comply with warning notes may prevent the barrier protecting the occupants.
- Parents should explain to children how and when to use **EMERGENCY ESCAPE HAMMER** attached to cargo barrier.
- Do not remove the rating plaque from the cargo barrier.

NOTICE TO INSTALLERS & DISTRIBUTORS

Please ensure User Instructions are left with vehicle owner after installation.



**TOYOTA LANDCRUISER PRADO 7 SEAT
WITHOUT SUNROOF
FRONT POSITION KIT INSTALLATION
INSTRUCTION—Part # 609372
FOR USE WITH CARGO BARRIER PART NUMBER 609350 ONLY**



IMPORTANT: The installation kit contains sufficient components to fit the cargo barrier. A high degree of technical competence is necessary to correctly install this product. We recommend this cargo barrier be installed by an authorised outlet to ensure the barrier installation is correct. These instructions must be read and clearly understood before commencing installation. Check contents of kit before commencing fitment and report any discrepancies or damage.

Parts List

Item	Component Name	Part No.	Qty
1	Lower Bracket—R/H	756215	1
2	Lower Bracket—L/H	756220	1
3	Screw—S/H Cap M6 x 1.0 HT ZP	711419	4
4	Pivot Saddle Bush	752680	2
5	Pivot Saddle— Powder coated	752700	2
6	Screw— Hex Hd. M10 x 1.5 x 20 ZP	912205	2
7	Nyloc Hex Nut—M10 x 1.5 ZP	922090	2

Item	Component Name	Part No.	Qty
8	Milbolt—M10 x 1.5 x 24mm	912825	2
9	Milbolt—M10 x 1.5 x 14mm	912816	4
10	Support Leg ASM	609341	2
11	Long Tube Strap ASM (Top extension—L/H)	776331	1
12	Long Tube Strap ASM (Top extension—R/H)	776336	1
13	Short Tube Strap	776315	2

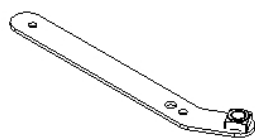

1

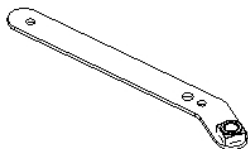

2



3



4

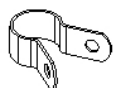

5



6



7



8



9

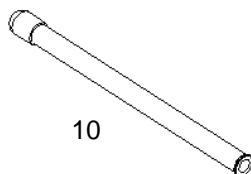

10

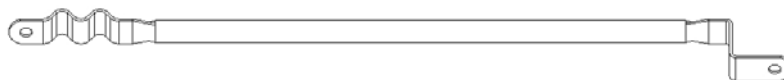

13



11

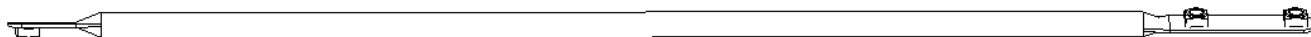

12

**TOYOTA LANDCRUISER PRADO 7 SEAT
WITHOUT SUNROOF
FRONT POSITION KIT INSTALLATION
INSTRUCTION—Part # 609372
FOR USE WITH CARGO BARRIER PART NUMBER 609350 ONLY**



ADVICE TO FITTER

Note: To fit the cargo barrier the following is essential:

- ☐ Always drill perpendicular to surface (Unless stated otherwise).
- ☐ A positive drill stop should always be used to prevent accidental damage to external panels, fuel lines etc.
- ☐ Ensure Safety Eye Protection and Gloves are worn as required when using cutting tools.
- ☐ When cutting metal panels be very careful of sharp edges, for risk of skin cuts etc.
- ☐ Care should be taken when applying Rust Preventative sealer to all holes drilled, to negate the possibility of skin and eye irritation.
- ☐ Check screws in relevant components by hand before installation. Should there be resistance re-tap threads and re-check.
- ☐ **Before marking or drilling to install this cargo barrier, check vehicle for LPG conversion & non standard fuel tanks. Locate tanks and all lines attached and take EXTREME CARE not to damage whilst installing this cargo barrier.**
- ☐ **Before drilling to install this cargo barrier, check for concealed wiring looms. E.g. tow bar, reversing camera, reversing sensor wiring etc.. Relocate before drilling to avoid damage.**

**CARE SHOULD BE TAKEN NOT TO CROSS THREAD THE FASTENERS DURING
INSTALLATION OF COMPONENTS TO THE VEHICLE.**

TOOLS REQUIRED

- | | |
|----------------------|----------------------------|
| • Socket wrench | • Drill stop's |
| • Metric hex sockets | • 25mm Hole Saw |
| • Power Drill | • Hex bits & driver |
| • Masking Tape | • Vacuum Cleaner |
| • Marker | • Cover sheet / Drop sheet |
| • 5mm, Drill Bit | • Torque wrench (9Nm) |

INSTALLATION PROCEDURE FOR LOWER SIDE MOUNTS



Drivers side shown

1. Locate grab handles just behind 2nd row seat door openings.
2. Remove screw covers to allow access to M6 screws.
3. Undo the screws & remove the grab handles. ***The screws are no longer required and will be replaced with high tensile screws from the kit.***

**TOYOTA LANDCRUISER PRADO 7 SEAT
WITHOUT SUNROOF
FRONT POSITION KIT INSTALLATION
INSTRUCTION—Part # 609372
FOR USE WITH CARGO BARRIER PART NUMBER 609350 ONLY**



INSTALLATION PROCEDURE FOR LOWER SIDE MOUNTS Cont'd

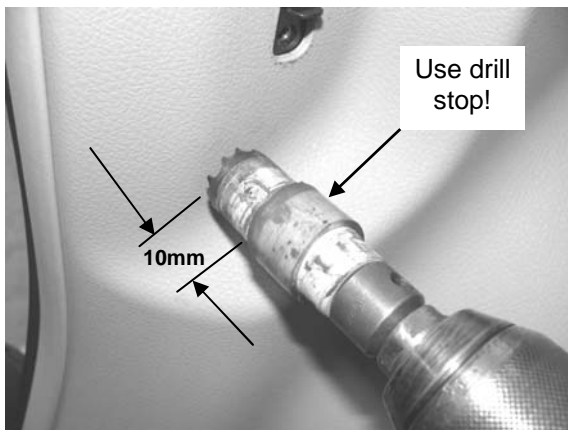
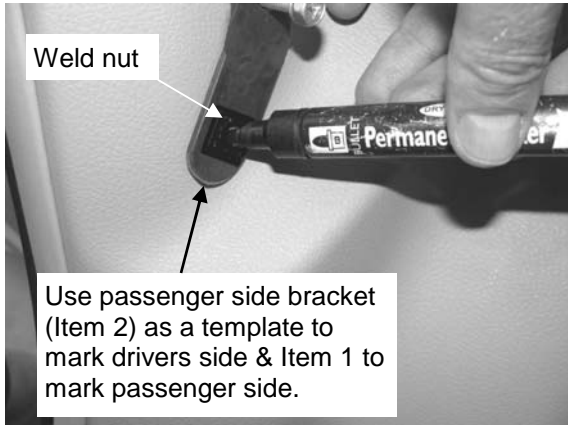

4. On the drivers side of vehicle and using the passenger side lower bracket (Item 2) as a template, position bracket in line with grab handle captive nuts. Temporarily secure the bracket using M6 screws (Item 3).
5. With bracket located mark the M10 bracket nut location onto the hard plastic trim as shown.
6. Repeat on passenger side using drivers side bracket (Item 1). Remove both brackets.

7. At marked locations from steps 5/6 use a Ø5mm drill bit with **drill stop** set at 10mm to drill a pilot hole through hard plastic trim.
8. Using a Ø25mm hole saw with **drill stop** set at 10mm enlarge the pilot holes. Vacuum away any drilling swarf.
Note: There may be wiring present in the vicinity of the holes being drilled. Check behind trim before drilling and push out of way if necessary.



Drivers side shown

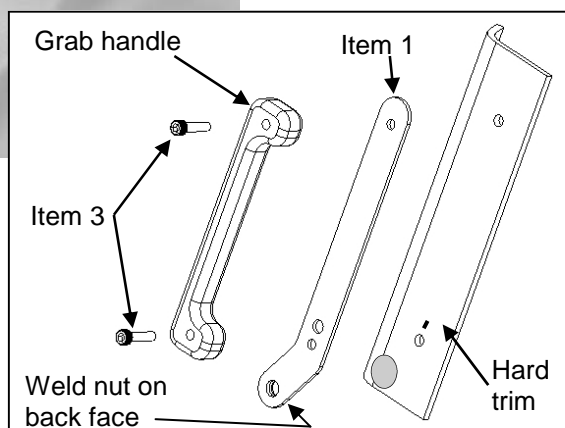

9. On drivers side of vehicle assemble screws, grab handle & RH lower bracket as per exploded picture shown.
10. Secure grab handle and bracket back in place. Tighten screws to 9Nm/7ft.lbs.
11. Repeat on passenger side using bracket (Item 2).
12. Replace screw covers.



INSTALLATION PROCEDURE FOR PIVOT SADDLES

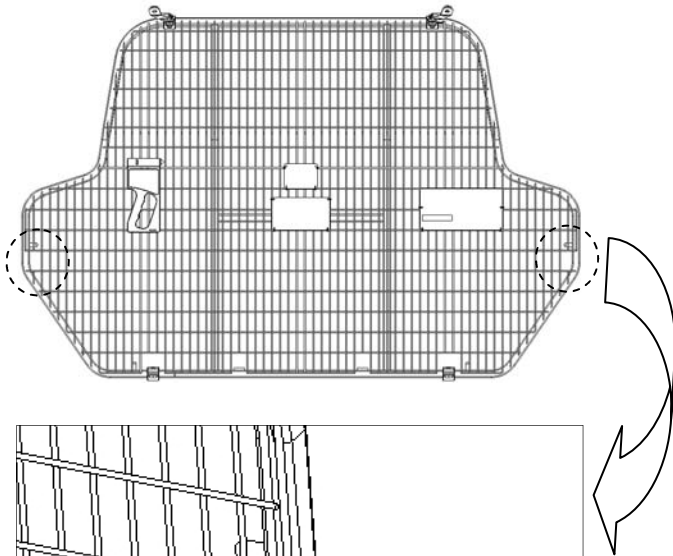

13. Locate the saddle openings in the cargo barrier mesh as shown.

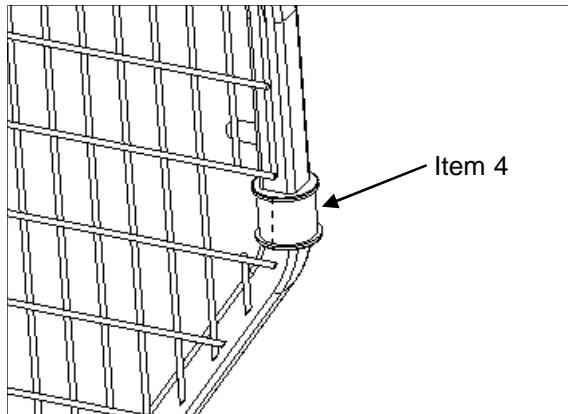

14. Fit pivot saddle bushes (Item 4) to frame as shown, at the saddle openings.

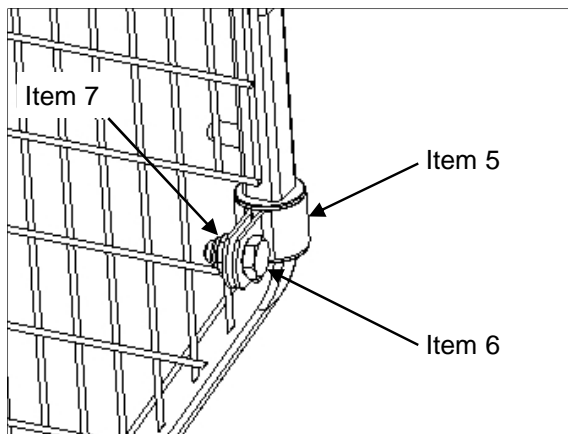

15. Place pivot saddles (Item 5) over saddle bushes then crimp closed. *(If using multi grips or similar to close saddle, take care not to damage powder coating)*
16. Fit hex head screw (Item 6) to saddle then secure in place using nyloc nut (Item 7).

Note: If installing cargo barrier in front position refer to user instructions for details of strap attachment, etc.

**TOYOTA LANDCRUISER PRADO 7 SEAT
WITHOUT SUNROOF
FRONT POSITION KIT INSTALLATION
INSTRUCTION—Part # 609372
FOR USE WITH CARGO BARRIER PART NUMBER 609350 ONLY**



INSTALLATION OF SUPPORT LEGS

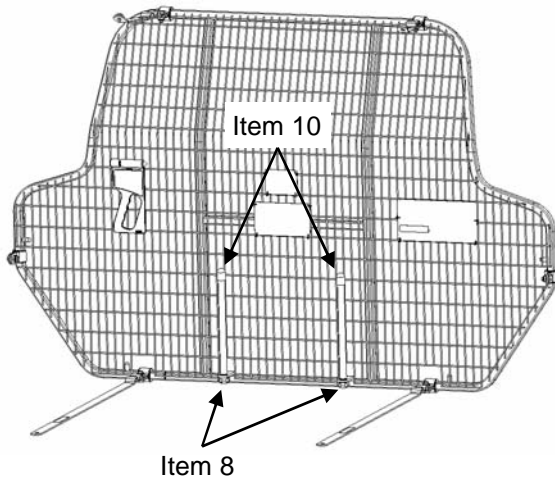

17. Attach support leg assemblies (Item 10) to frame brackets as shown using 24mm Milbolts (Item 8) .

Note: If installing cargo barrier in front position refer to user instructions for details of support leg attachment, etc.

ASSEMBLY OF CARGO BARRIER IN FORWARD POSITION

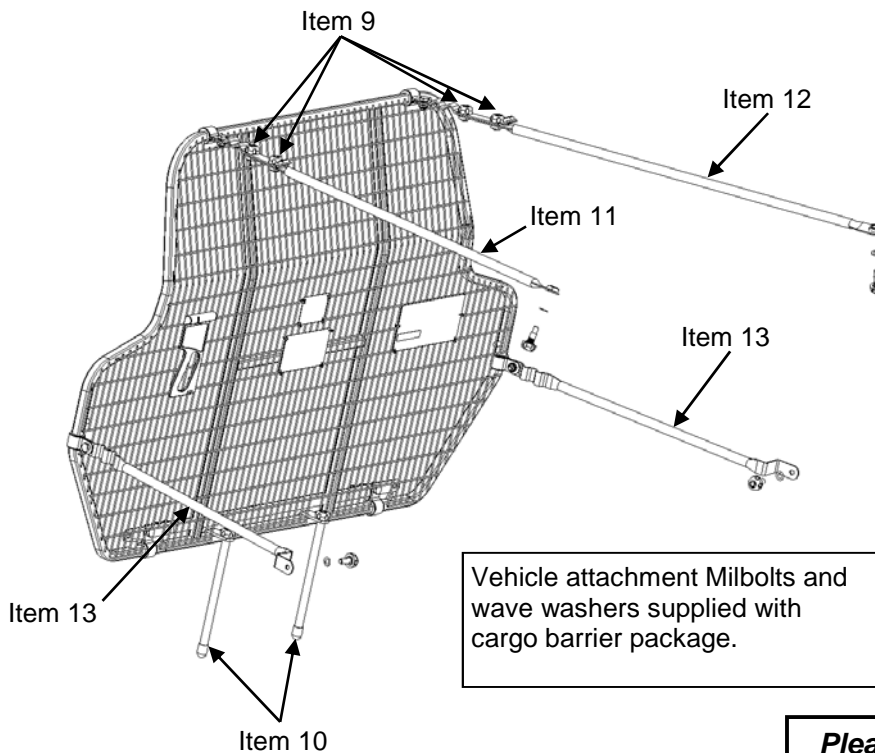

Please ensure User Instructions are left with vehicle owner after installation.



IMPORTANT NOTE: Check that all bolts and screws are tight and re check periodically.