

SUBARU OUTBACK

FRONT POSITION KIT INSTALLATION INSTRUCTION

Part # 705602 (with sunroof)

(For use with cargo barrier P/N 705600 only)



IMPORTANT: The installation kit contains sufficient components to allow the cargo barrier P/N 705600 to be installed behind the 1st row seats. A high degree of technical competence is necessary to correctly install this product. We recommend this kit be installed by an authorised outlet to ensure the barrier installation is correct. These instructions must be read and clearly understood before commencing installation. Check contents of kit before commencing fitment and report any discrepancies or damage.

Parts List

Item	Component Name	Part No.	Qty
1	Pivot Saddle Bush	752680	2
2	Pivot Saddle	752700	2
3	Screw - Hex Head M10 x 20mm ZP	912205	2
4	Hex Nut - Nyloc ZP	922090	2
5	Milbolt - M10 x 29mm	912830	2
6	Milbolt - M10 x 19mm	912820	5
7	Washer - Flat, 10mm ZP	932006	1
8	Velcro Tie	904003	4
9	Tube Extension Strap (Top)	776913	2
10	Strap - Front Position LHS	776914	1
11	Strap - Front Position RHS	776915	1
12	Support Leg ASM	609258	2
13	Lateral Support Bracket	753496	1

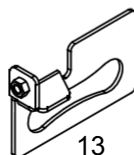
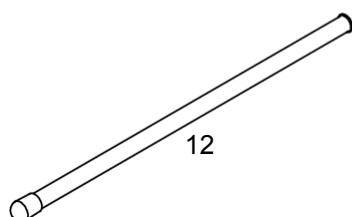
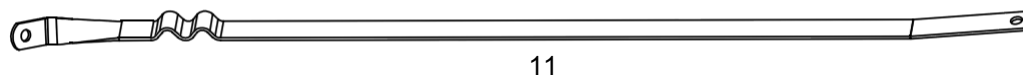
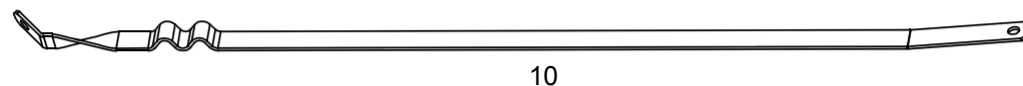
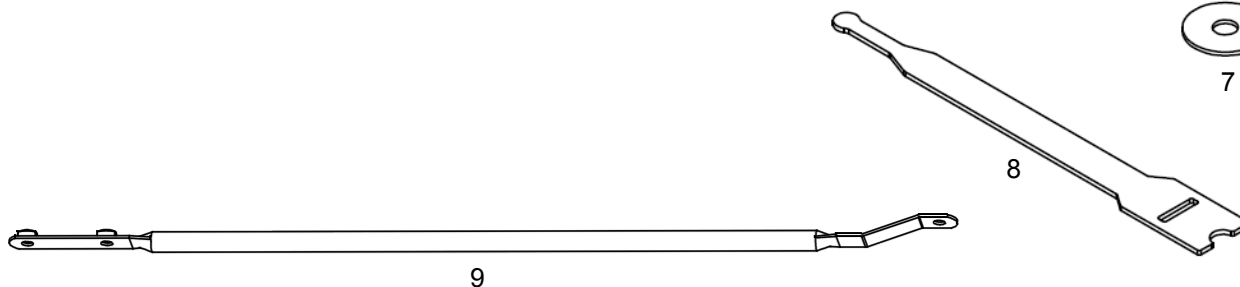
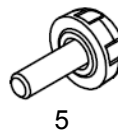
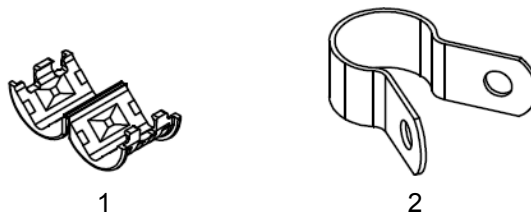

Installation time approximately 10 Mins.

**E and OE—Errors and Omissions
Excepted**

SUBARU OUTBACK
FRONT POSITION KIT INSTALLATION INSTRUCTION
Part # 705602 (with sunroof)
(For use with cargo barrier P/N 705600 only)



TOOLS REQUIRED

- Socket Wrench
- 17mm Hex Socket
- 16mm Ring Spanner

INSTALLATION OF BOTTOM FRONT POSITION STRAPS

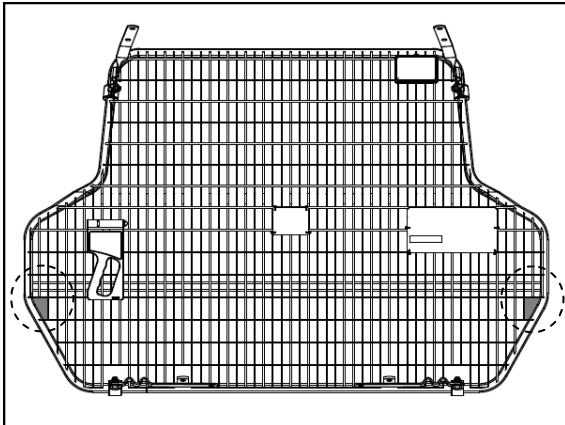

1. Locate the mesh openings circled on the bottom sides of the cargo barrier frame.

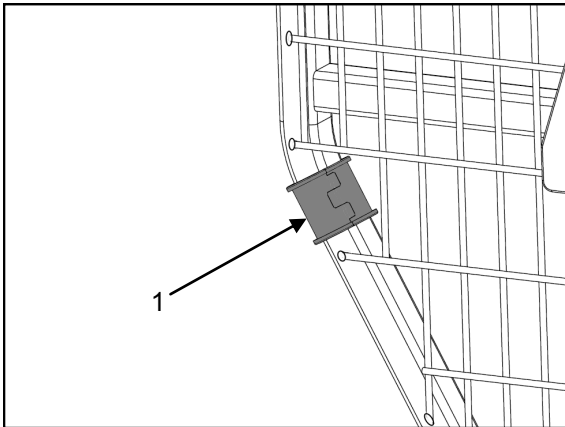

2. Place a pivot saddle bush (1) over the frame at the selected openings then clip in place.

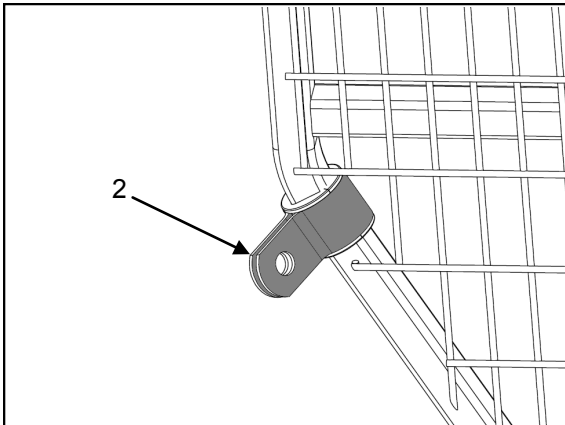

3. Place a pivot saddle (2) over each of the saddle bushes then push the ends together.

SUBARU OUTBACK

FRONT POSITION KIT INSTALLATION INSTRUCTION

Part # 705602 (with sunroof)
(For use with cargo barrier P/N 705600 only)



INSTALLATION OF BOTTOM FRONT POSITION STRAPS - Cont'd

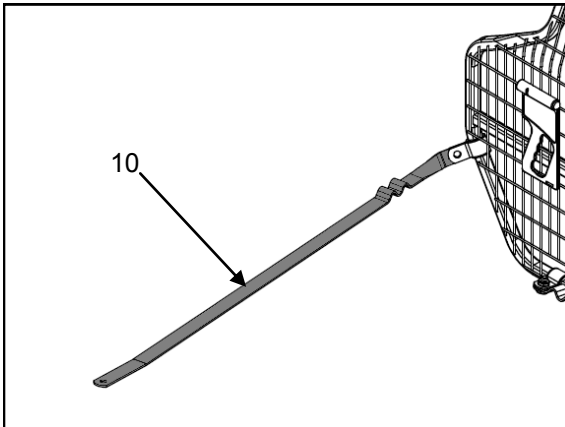

4. Position the LH front position strap (10) in between the pivot saddle as shown.

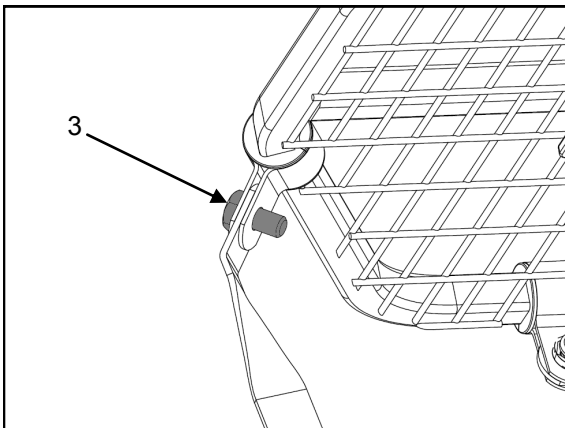

5. Place an M10 screw (3) through the pivot saddle/strap ASM as shown.

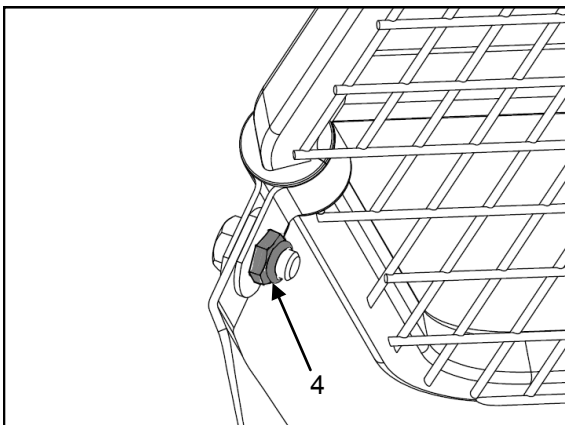

6. Thread an M10 nyloc nut (4) onto the screw then tighten until the strap is firm in the saddle but can still be pivoted.
7. Repeat steps 4 to 6 on the RHS using RH front position strap (11).

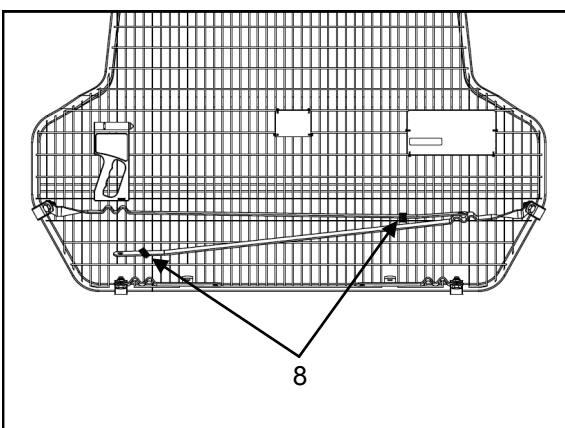

8. Pivot the front position bottom straps across the cargo barrier as shown, then secure in place using 2 velcro ties (8).
9. If not installing the cargo barrier in the front position immediately, tie the tube straps and support legs together with Velcro ties (8) and store in the cargo area under floor compartment, along with the lateral support bracket and hardware.

SUBARU OUTBACK
FRONT POSITION KIT INSTALLATION INSTRUCTION
Part # 705602 (with sunroof)
(For use with cargo barrier P/N 705600 only)



INSTALLATION OF CARGO BARRIER
'Behind 2nd row of seats'

- Remove cargo blind if installed.
- Fold 2nd row seats forward to allow space to manoeuvre cargo barrier into position.
- Ensure all straps are pivoted towards the meshed side of the cargo barrier.
- Manoeuvre cargo barrier into vehicle with the rating label (meshed side of cargo barrier) facing the rear of the vehicle. Locate cargo barrier in the behind 2nd row seat position.
- Attach the top straps to the upper mounts using 39mm Milbolts with wave washers under heads.
- Attach the bottom straps to the bottom mounts using 29mm Milbolts with wave washers under heads.
- Tighten all Milbolts.
- Replace cargo blind if required.
- Put 2nd row seat backs back into upright position.

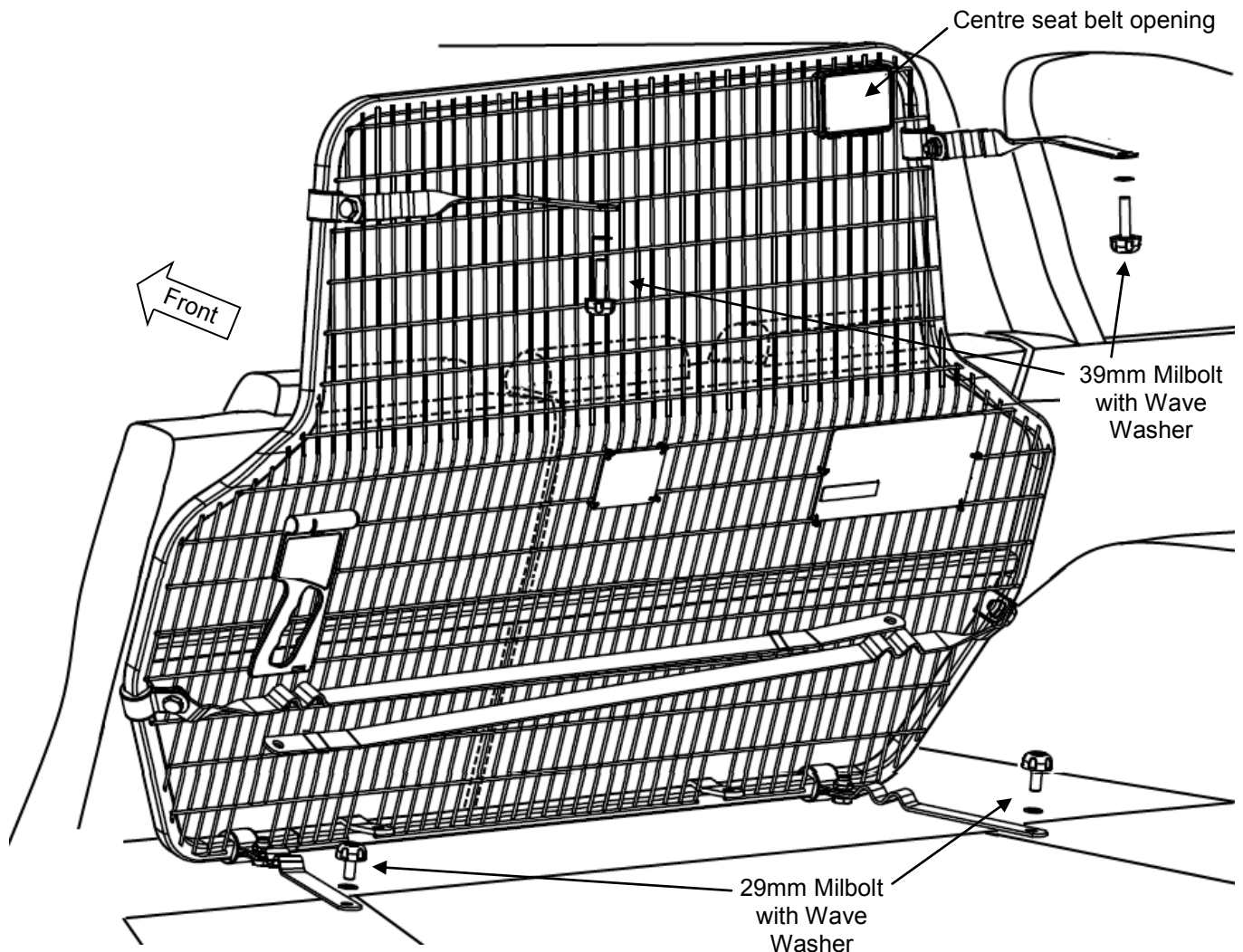

***Please ensure User Instructions are
left with vehicle owner after
installation.***



**IMPORTANT NOTE: Check that all bolts and
screws are tight and re check periodically.**



INSTALLATION OF CARGO BARRIER **'Behind 1st row of seats'**

1. Remove the cargo blind if fitted.
2. With the head restraints in their fully down position lay the 2nd row seats flat as shown in owners handbook.
3. Move the front seats fully forward on their sliders to allow manoeuvring space.
4. If moving from the rear position undo all Milbolts securing cargo barrier in place.
5. Ensure all straps are pivoted towards the meshed side of the Cargo Barrier.
6. Lay the cargo barrier on its back in the cargo area.
7. Attach the support legs (12) to bottom brackets as shown using 29mm Milbolts (5).
8. Stand the cargo barrier upright behind the 1st row of seats with the rating label (meshed side of cargo barrier) facing the rear of the vehicle and the support legs sitting on the floor.
9. Attach the tube extension straps (9) to the top straps as shown using 19mm Milbolts (6). -2 Milbolts per strap.
10. Attach the other end of the tube extension straps to the roof mounts using 39mm Milbolts with wave washers under heads from rear position kit.
11. Unfasten the front position bottom straps from the cargo barrier.
12. Attach the loose ends of the long bottom straps to bottom mounts using 29mm Milbolts with wave washers under heads from rear position kit.
13. Tighten all Milbolts securely.
14. Attach the lateral support bracket (13) to the barrier mesh as shown on page 6.
15. Reverse the procedure to remove cargo barrier or move to the behind 2nd row seats position.

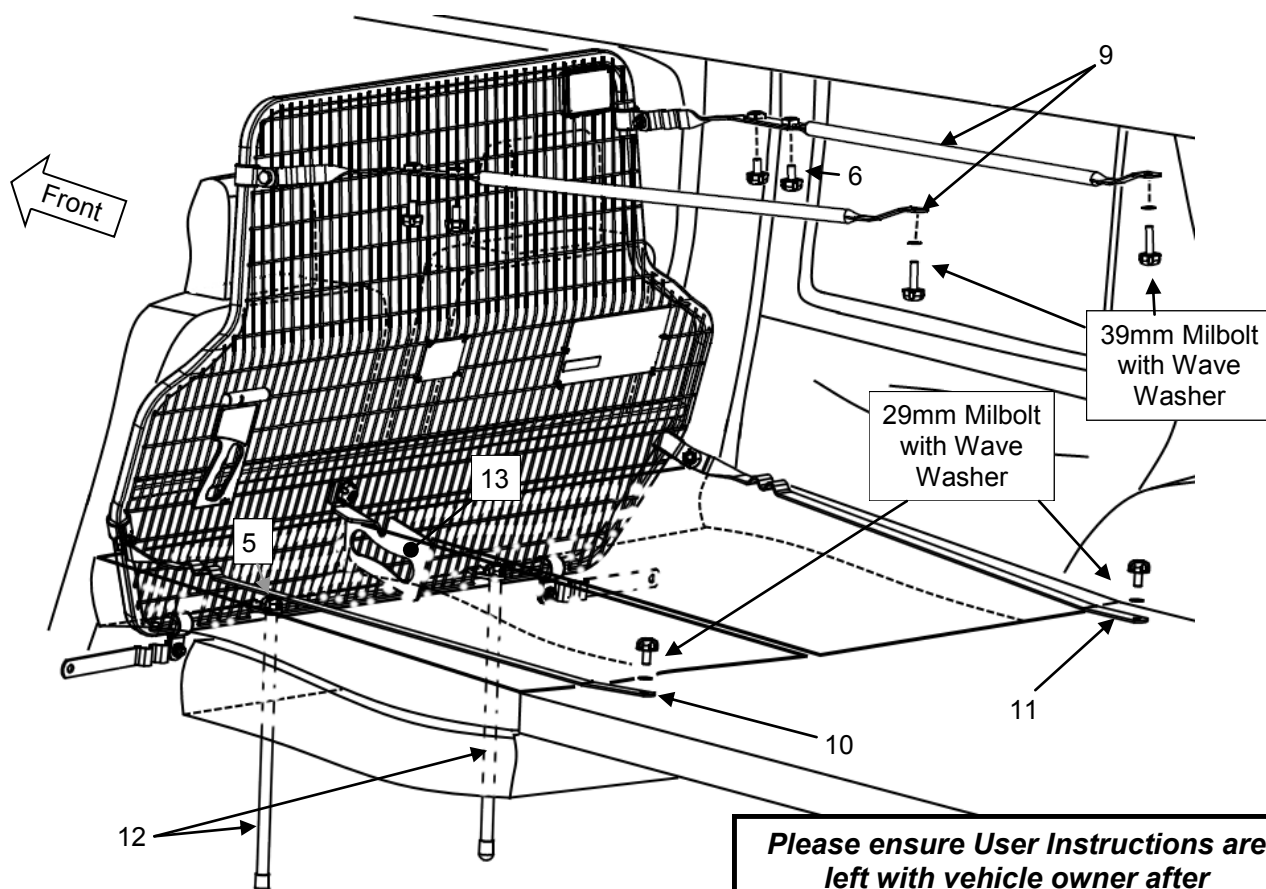

Please ensure User Instructions are left with vehicle owner after installation.



IMPORTANT NOTE: Check that all bolts and screws are tight and re check periodically.



INSTALLATION OF LATERAL SUPPORT BRACKET

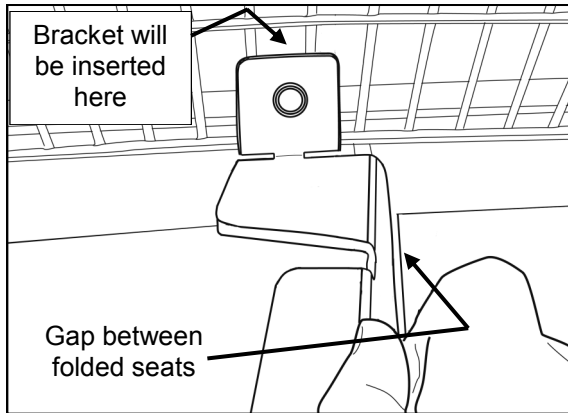

16. Centre the cargo barrier in the middle of the vehicle. (Even gap each side)
17. Locate the best mesh aperture opening for the lateral support bracket (13). (Bracket will locate in gap between folded seat backs)

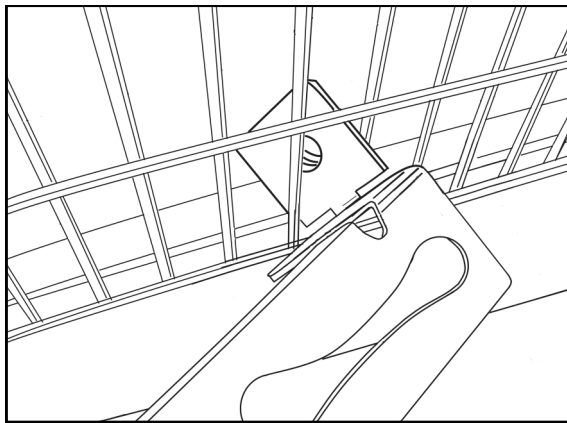

18. Manoeuvre the lateral support bracket into position through mesh aperture selected.

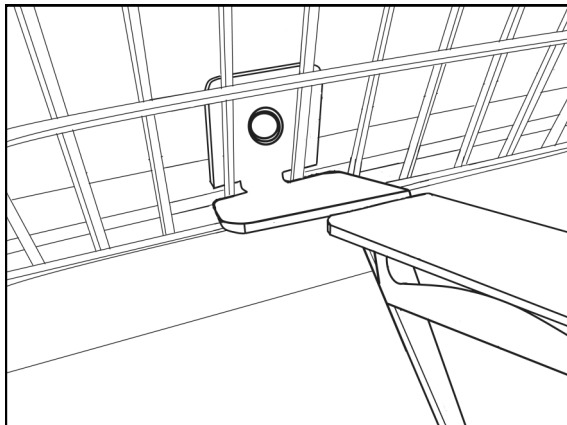

19. With the lateral support bracket positioned in gap between folded seat backs, secure in position using 19mm Milbolt (6) with flat washer (7) under head.

