

TOYOTA RAV 4 SUV CARGO BARRIER FRONT POSITION KIT INSTALLATION INSTRUCTION

Part # 610002

For use with Cargo Barrier P/N 610000 only
(Not suitable for Moonroof equipped vehicles)

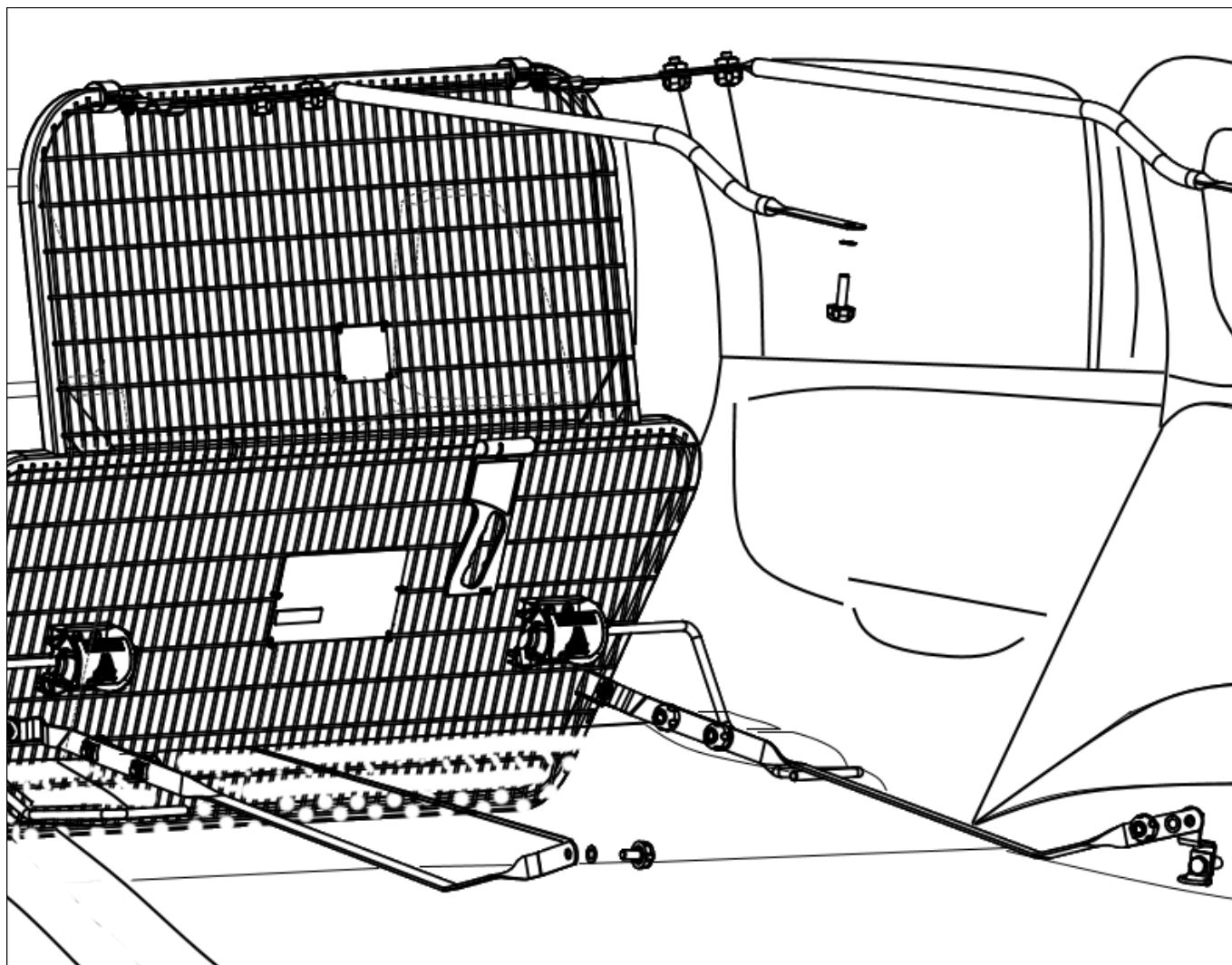

Cargo Barrier Not Included

TOOLS REQUIRED

- Tape Measure
- 2.5mm/5mm Hex Driver Bit & Adaptor
- Torque Wrench (2Nm)

Installation time approximately 0.25 Hour

"The estimated fitting time is based on an experienced fitter conversant with the fitment procedure"

E and OE—Errors and Omissions Excepted

NOTICE TO INSTALLERS & DISTRIBUTORS

Please ensure these instructions are left with vehicle owner after installation.

TOYOTA RAV 4 SUV CARGO BARRIER FRONT POSITION KIT INSTALLATION INSTRUCTION

Part # 610002

For use with Cargo Barrier P/N 610000 only
(Not suitable for Moonroof equipped vehicles)



IMPORTANT: The installation kit contains sufficient components to fit the accessory. A high degree of technical competence is necessary to correctly install this product. We recommend this accessory be installed by an authorised outlet to ensure the installation is correct. These instructions must be read and clearly understood before commencing installation. Check contents of kit before commencing fitment and report any discrepancies or damage.

Parts List

| Item | Component Name | Part No. | Qty |
|------|--|----------|-----|
| 1 | AutoShift ASM's (LH + RH) | 610022 | 1 |
| 2 | Backing Plate | 754006 | 2 |
| 3 | Screw - Button Head, M8 x 1.25 x 16 ZP | 913140 | 4 |
| 4 | Milbolt - M10 x 1.5 x 19mm | 912820 | 8 |
| 5 | Velcro Tie | 904001 | 4 |
| 6 | Flat Extension Strap LHS | 776067 | 1 |
| 7 | Flat Extension Strap RHS | 776069 | 1 |
| 8 | Tube Extension Strap ASM | 776057 | 2 |

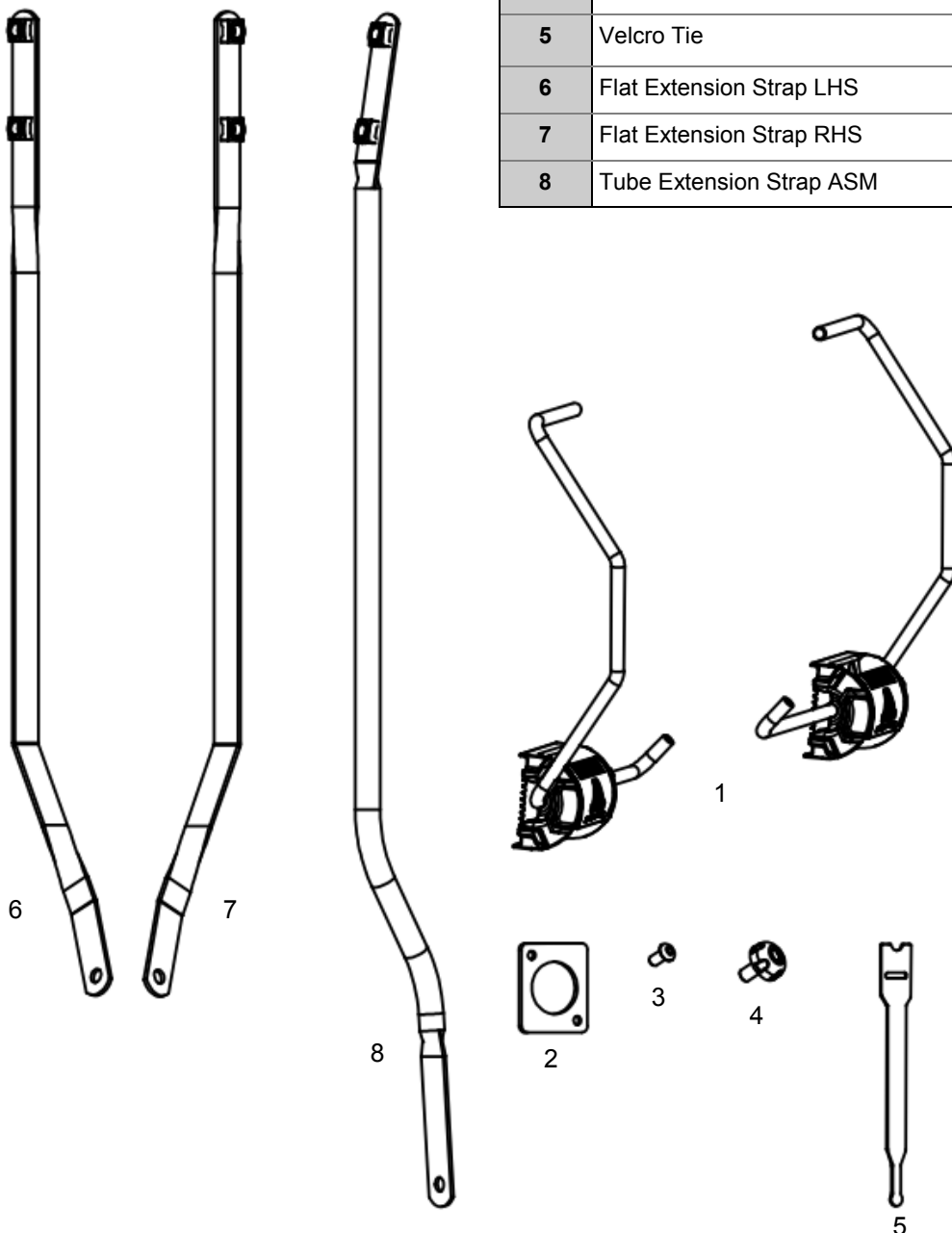

TOYOTA RAV 4 SUV CARGO BARRIER FRONT POSITION KIT INSTALLATION INSTRUCTION

Part # 610002

For use with Cargo Barrier P/N 610000 only
(Not suitable for Moonroof equipped vehicles)



INSTALLATION OF AutoShift ON CARGO BARRIER

1. Carefully establish the centre line of the cargo barrier.
2. Position the complete LH pivot housing and adjustable AutoShift support brace ASM on the LHS of the cargo barrier as shown. The inside of the housing should be 325mm from the centre line of the cargo barrier frame. The bottom of the housing should be 173mm above the bottom of the cargo barrier frame.

Note: The pivot housing ASM is ultimately located by the grooves in the pivot housing clamping plate. Use the position closest to the dimensions specified.

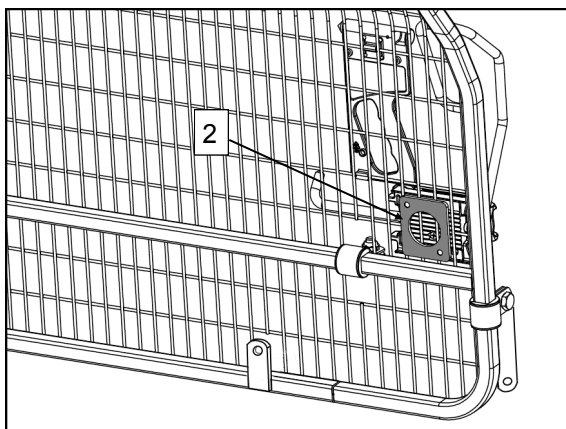
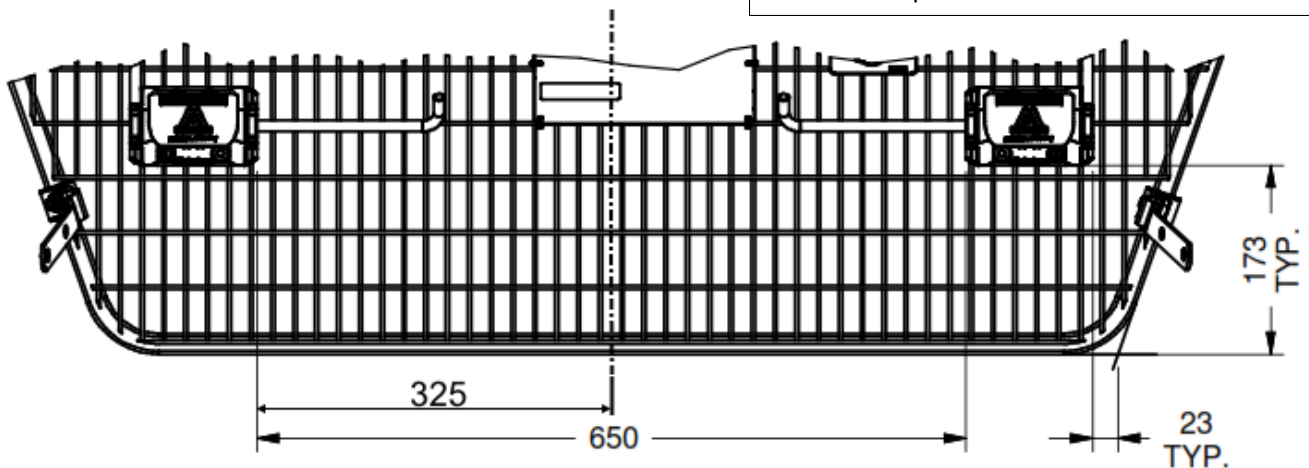

3. On the forward face of the cargo barrier mesh position a backing plate (2) with the threaded holes aligned with the screw holes in the pivot housing.

TOYOTA RAV 4 SUV CARGO BARRIER FRONT POSITION KIT INSTALLATION INSTRUCTION

Part # 610002

For use with Cargo Barrier P/N 610000 only
(Not suitable for Moonroof equipped vehicles)



INSTALLATION OF AutoShift ON CARGO BARRIER - Cont'd

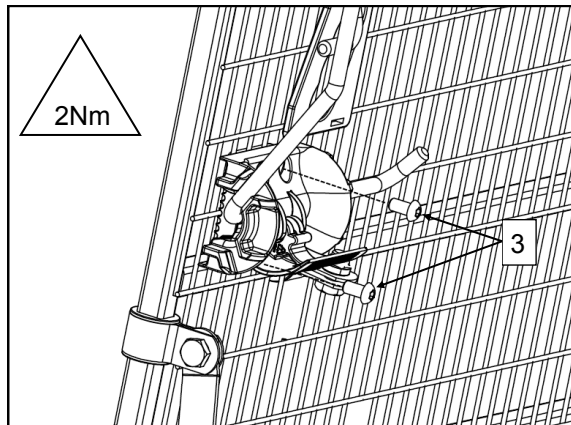

4. With the backing plate in position secure the pivot housing and adjustable AutoShift support brace ASM to the mesh using the button head screws (3) x2.
5. Tighten and torque up the screws to 2Nm.
6. Repeat the above steps on the RHS using the RHS pivot housing and adjustable AutoShift support brace ASM.

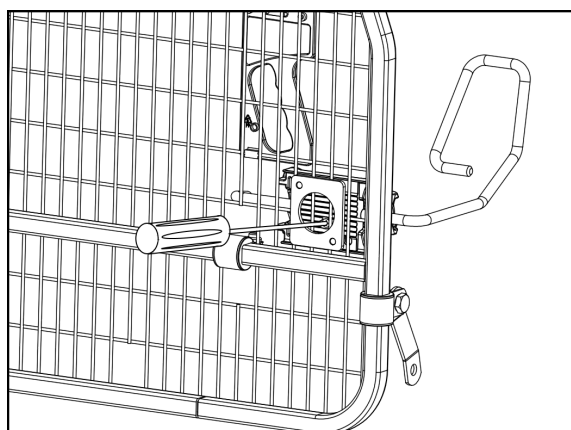

7. Adjust the clamping handle pressure using the M4 screw. The screw should be tightened until the adjustable AutoShift support braces own weight, can be held when the clamping handle is in the locked position. Do not over tighten.

8. The Cargo Barrier can now be installed in the behind 1st row of seats position using the straps and Milbolts supplied. See the User instruction for details.

TOYOTA RAV 4 SUV CARGO BARRIER FRONT POSITION KIT INSTALLATION INSTRUCTION

Part # 610002

For use with Cargo Barrier P/N 610000 only
(Not suitable for Moonroof equipped vehicles)



USING THE AutoShift EQUIPPED CARGO BARRIER

The AutoShift has 3 main modes to assist in installing, relocating and securing the cargo barrier in the vehicle.

1. **The parked position** - Use this position when the cargo barrier is installed in the behind 2nd row seats position and as a slide to assist in moving the cargo barrier between positions.
2. **The behind 2nd row seats installation assist position** - Use this position to hold the cargo barrier upright whilst securing the mounting straps to the vehicle.
3. **The behind 1st row seats support and stabilise position** - Use this position to support the cargo barrier at the correct height behind the 1st row seats, and to keep the cargo barrier laterally secure.



Scan here or visit <https://youtu.be/s7JzaUVtKz0> to watch the Milford AutoShift in operation:

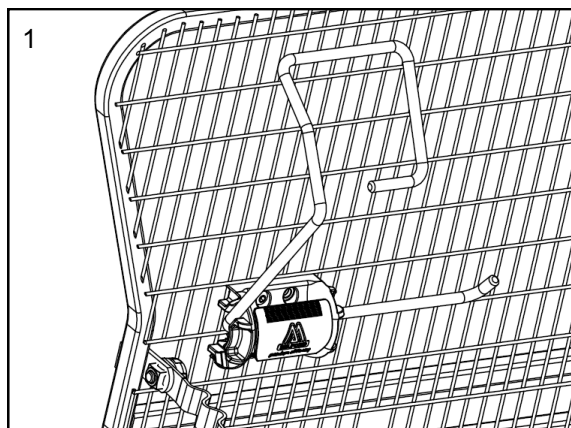

Ensure the adjustable AutoShift support brace is fully engaged in the pivot housing as shown, before using in positions 2 or 3.

