



SUBARU IMPREZA/XV HATCH
CARGO BARRIER USER INSTRUCTION
Part # 705100 2 POSITION—NON SUNROOF
VEHICLE YEARS OF MANUFACTURE - FROM JAN 2012 to
OCT.2016 (Impreza) - APR. 2017 (XV)



This cargo barrier is capable of being located in two positions, behind the 2nd row of seats with the seats in an upright position, and behind the 1st row of seats with the 2nd row of seats in their folded position using accessory kit #705102. **Note:** Cargo blind cannot be reinstalled with cargo barrier installed. A high degree of technical competence is necessary to correctly install this product. We recommend this cargo barrier be installed by an authorised outlet to ensure the barrier installation complies with AS/NZS 4034 Standard.

The cargo barrier is designed, manufactured and fitted to decrease the impact hazard in an accident to occupants from cargo carried within the interior cargo space of the vehicle. In the event of an accident, a cargo barrier can reduce injuries caused by cargo intruding into occupant's space.



WARNINGS

- Strict compliance with fitting instructions is essential for this safety product to meet its rated capacity. Refer user instructions regarding correct usage of the cargo barrier.
- Do not modify cargo barrier in any way.
- Do not use this cargo barrier in any other vehicle for which it is not designed.
- Modifications to the cargo barrier or its fixings or use in any other vehicle for which it is not designed may void the load rating and warranty.
- Do not attach the cargo barrier to the vehicle using seat, seat belt or child restraint anchorage's.
- Where high tensile threaded fasteners are used, the cargo barrier must be installed using the size and grade fasteners specified by Milford Industries.
- Do not drill, rivet, adhere or attach objects to the front or rear of the cargo barrier.
- Do not place smaller items, that may bypass the cargo barrier in the event of heavy braking or collision, near the edges of the barrier.
- Position the load against the cargo barrier.
- When load is positioned against cargo barrier, secure the load with a restraint system.
- During a collision moving cargo may damage seat belts or tether straps of a child restraint device, or its anchorage. Load should be carefully positioned so as not to come in contact with these items.
- Do not obstruct seat belts or child restraints, or their operation.
- Long thin items of cargo should be positioned in the vehicle with the long axis across the vehicle to minimise the penetration risk.
- If involved in an accident or accidentally damaged, the cargo barrier should be replaced and the anchorage's repaired to as new condition.
- Clean with soap and water only. Do not use solvents or chemicals. Discard cargo barrier if it becomes rusted. Do not expose to direct sunlight for long periods.
- It is extremely dangerous to ride in the cargo area of the vehicle behind the cargo barrier. It is recommended that the cargo barrier be removed. In a collision people or children riding unrestrained in these areas are more likely to be seriously injured or killed.
- Never leave a child in the vehicle unattended, particularly in the rear cargo area. The cargo area should never be used as a play area for children.
- The cargo barrier may deform and significantly intrude into occupant's space in an accident.
- Remember that the tailgate cannot be opened from inside the cargo area.
- The fixed labeling should not be removed from the cargo barrier.
- Failure to comply with warning notes may prevent the barrier protecting the occupants.
- Parents should explain to children how and when to use **EMERGENCY ESCAPE HAMMER** attached to cargo barrier.
- Do not remove the rating plaque from the cargo barrier.

NOTICE TO INSTALLERS & DISTRIBUTORS

Please ensure User Instructions are left with vehicle owner after installation.



SUBARU IMPREZA/XV HATCH
CARGO BARRIER USER INSTRUCTION
Part # 705100 2 POSITION—NON SUNROOF
VEHICLE YEARS OF MANUFACTURE - FROM JAN 2012 to
OCT.2016 (Impreza) - APR. 2017 (XV)



FRONT POSITION ACCESSORY KIT #705102

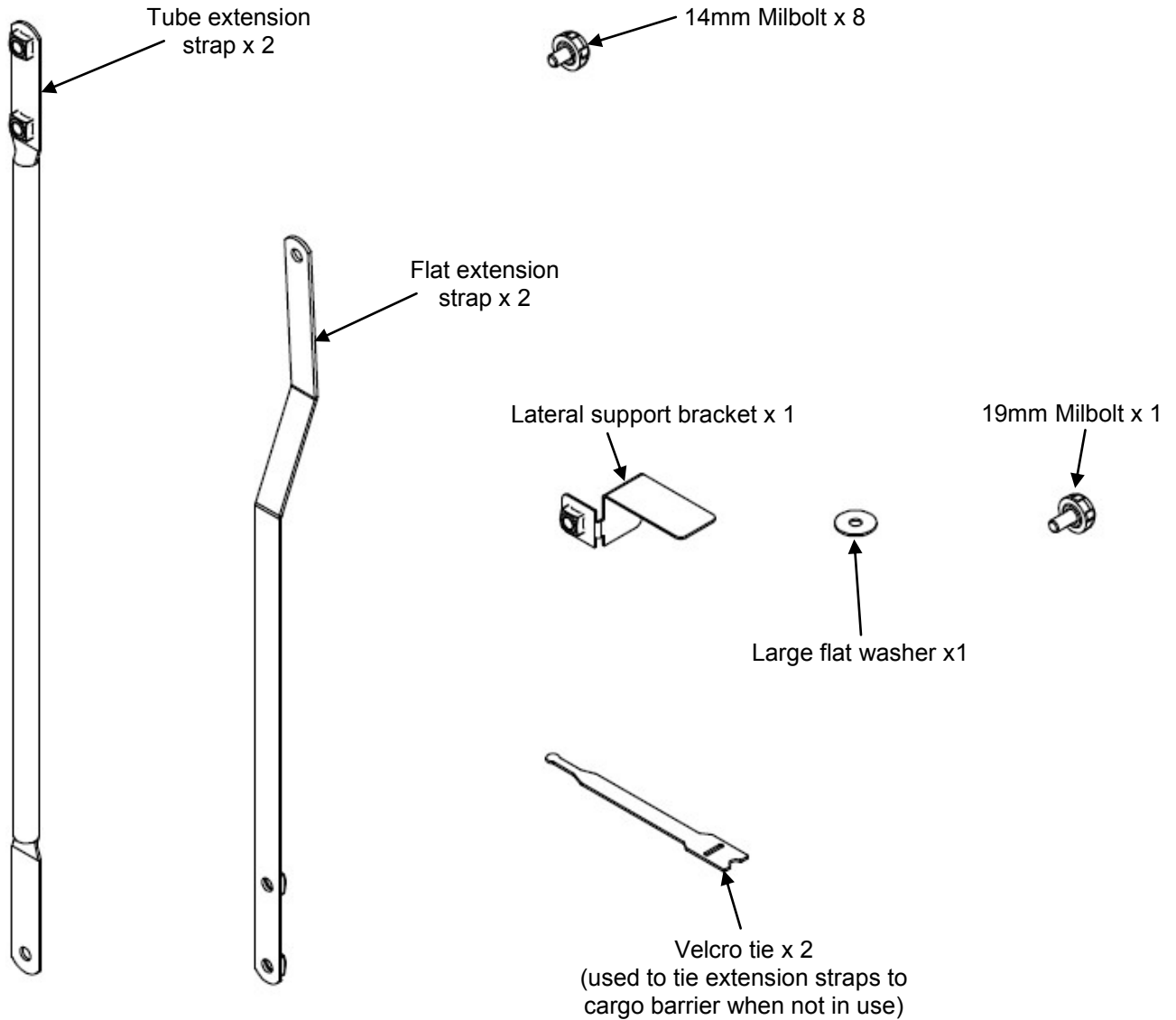

SUBARU IMPREZA/XV HATCH
CARGO BARRIER USER INSTRUCTION
Part # 705100 2 POSITION—NON SUNROOF
 VEHICLE YEARS OF MANUFACTURE - FROM JAN 2012 to
 OCT.2016 (Impreza) - APR. 2017 (XV)



INSTALLATION OF CARGO BARRIER
'Behind 2nd row of seats' - XV

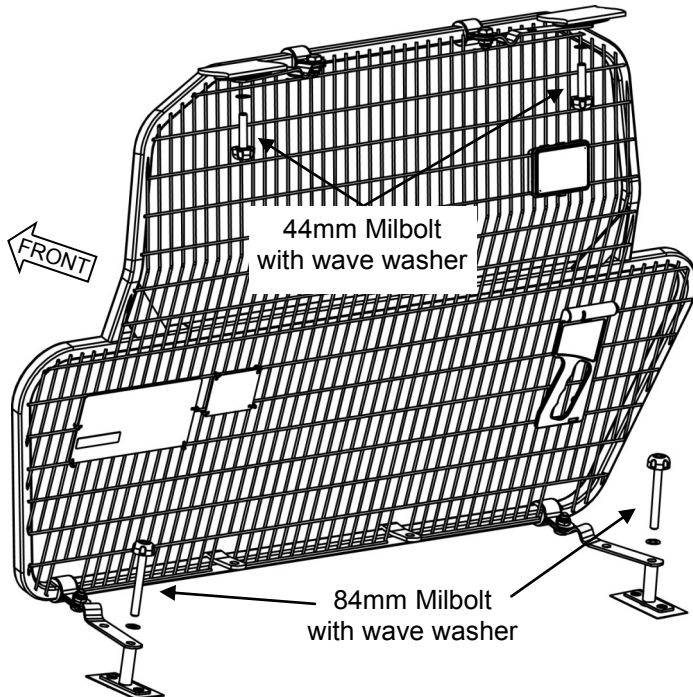

- *With cargo area floor covering & styrene foam under floor inserts out of the vehicle -*
- 1. Place Cargo Barrier in vehicle directly behind 2nd row of seats with rating label (meshed side of barrier) facing the rear of the vehicle.
- 2. Attach top straps to upper mounts using 44mm Milbolts with Wave washers under heads.
- 3. Attach bottom straps to bottom mounts using 84mm Milbolts with Wave washers under heads.
- 4. Tighten all Milbolts.
- 5. Re install styrene foam under floor inserts into vehicle.
- 6. Re install floor covering to vehicle with the front flap angled upwards leaning against the cargo barrier mesh.
- 7. Cargo blind cannot be re installed.

INSTALLATION OF CARGO BARRIER
'Behind 2nd row of seats' - Impreza

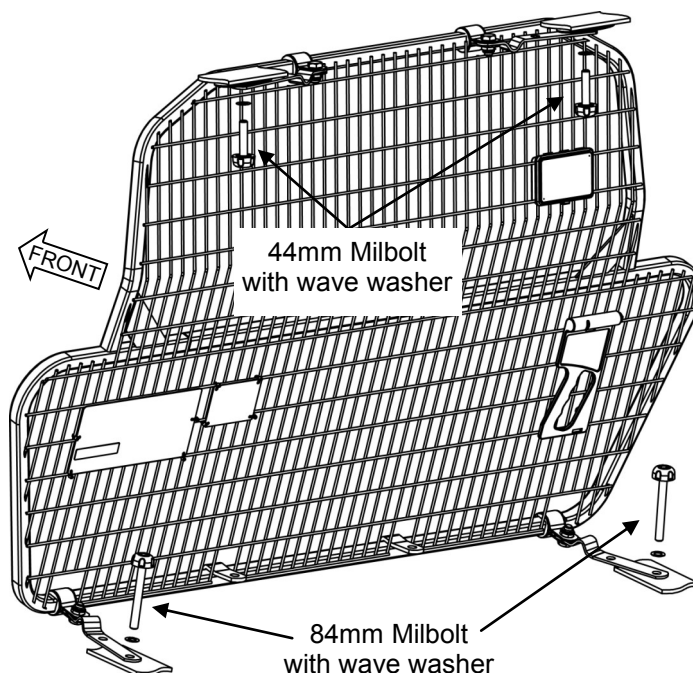

1. Place Cargo Barrier in vehicle directly behind 2nd row of seats with rating label (meshed side of barrier) facing the rear of the vehicle.
2. Attach top straps to upper mounts using 44mm Milbolts with Wave washers under heads.
3. Attach bottom straps to bottom mounts using 84mm Milbolts with Wave washers under heads.
4. Tighten all Milbolts.
5. Cargo blind cannot be re installed.



IMPORTANT NOTE: Check that all bolts and screws are tight and re check periodically.



INSTALLATION OF CARGO BARRIER **'Behind 1st row of seats' - XV & Impreza Non Sun Roof**

1. If installing/relocating cargo barrier in XV remove cargo area floor covering and styrene foam under floor inserts.
2. Lay 2nd row seats flat as shown in owner handbook.
3. Undo all Milbolts if relocating from rear position.
4. Place Cargo Barrier in vehicle on the forward edge of the folded 2nd row seat backs, with rating label (meshed side of barrier) facing the rear of the vehicle.
5. Attach tube extension straps (from front position kit) to top straps as shown, using 14mm Milbolts (from front position kit). -2 per strap.
6. Attach other end of tube extension straps to upper mounts using 44mm Milbolts with Wave washers under heads.
7. Attach flat extension straps (from front position kit) to bottom straps as shown, using 14mm Milbolts (from front position kit). -2 per strap.
8. Attach other end of flat extension straps to bottom mounts using 84mm Milbolts with Wave washers under heads.
9. Tighten all Milbolts.
10. For **XV** re install styrene foam under floor inserts into vehicle.
11. For **XV** re install floor covering to vehicle.
12. **See page 4 for correct use of Lateral Support Bracket.**
13. To move cargo barrier to rear position reverse procedure. (See page 3)

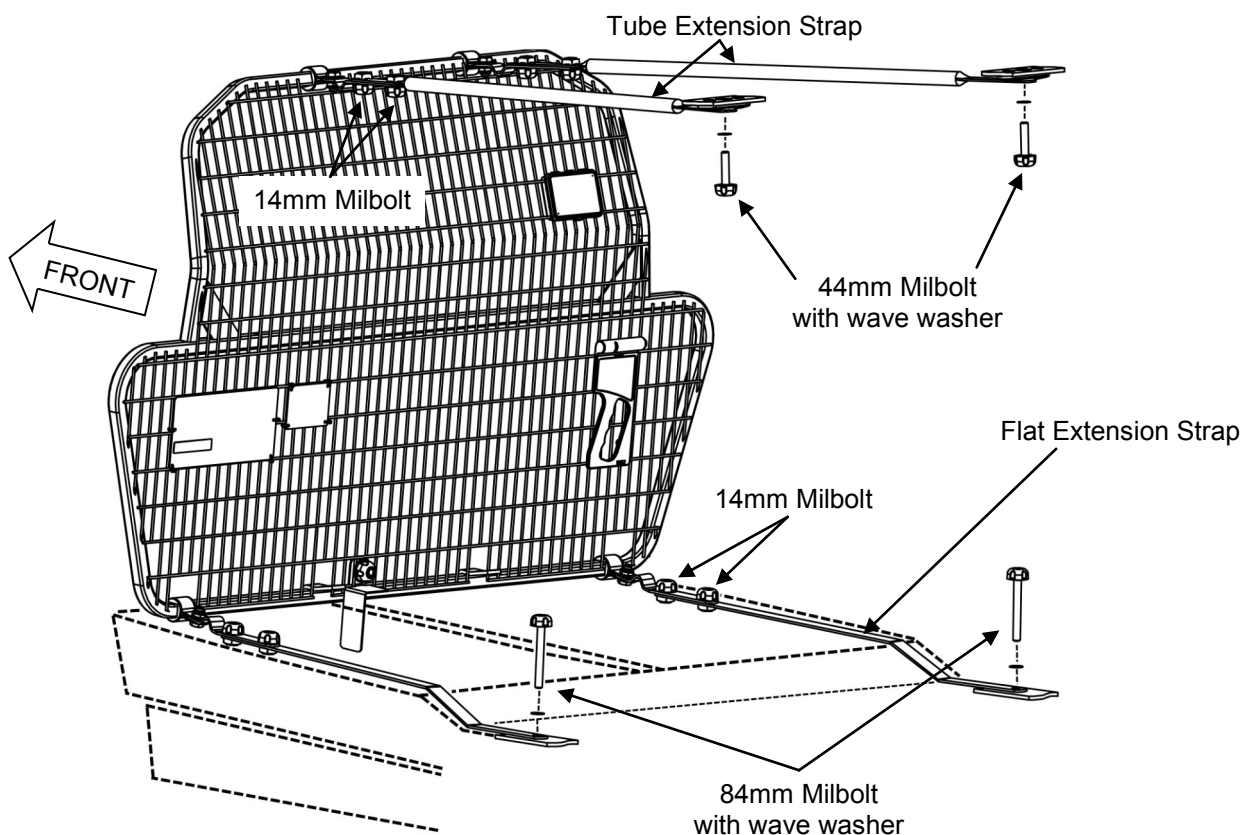

IMPORTANT NOTE: Check that all bolts and screws are tight and re check periodically.



INSTALLATION OF LATERAL SUPPORT BRACKET—(Front Position)

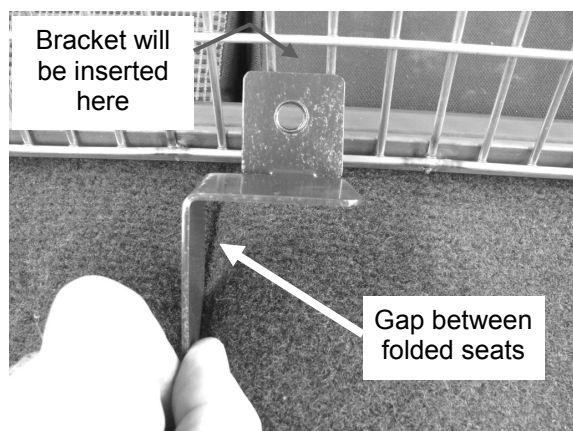

Note: Lateral support bracket & securing hardware supplied with front position kit.

1. Centre cargo barrier in the middle of the vehicle. (Even gap each side)
2. Locate best mesh aperture opening along bottom of cargo barrier for lateral support bracket. (Bracket will locate in gap between folded seat backs)



3. Manoeuvre lateral support bracket into position through mesh aperture selected.



4. With lateral support bracket positioned in gap between folded seat backs, secure in position using 19mm Milbolt with flat washer under head.

