

# Toyota RAV-4 CV CARGO BARRIER

Installation Instructions  
February 2006 to January 2013

Excluding Side Air Curtain and Sunroof



Accessory Part No. **603825**

Installation Time: Approx 1.5hrs

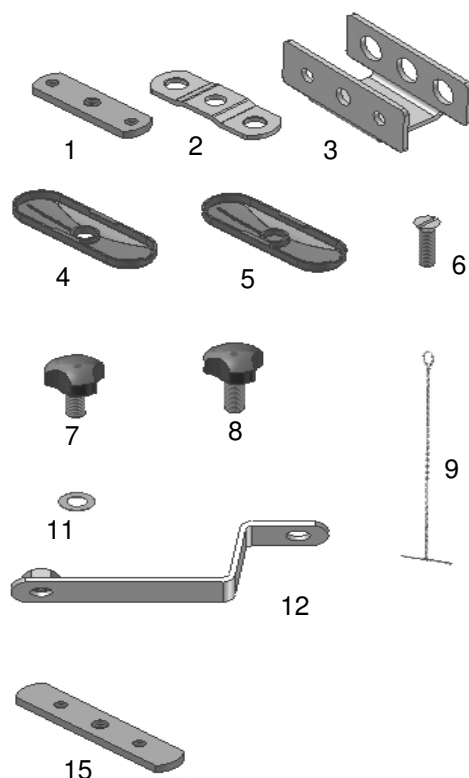
Place these Instructions in the vehicles glove box after installation is complete

**IMPORTANT:** The installation kit contains sufficient components to fit the cargo barrier. A high degree of technical competence is necessary to correctly install this product. We recommend this Cargo Barrier be installed by an authorised Dealer to ensure the barrier installation is correct. These instructions must be read and clearly understood before commencing installation.

## Parts List

**Important:** Check contents of kit before commencing fitment and report any discrepancies.

Item	Component Name	Part No.	Qty
1	Mounting Plate	754000	4
2	Cover Plate concealed	754955	4
3	Bracket	752976	2
4	Plastic cover plate (hole)	754960	2
5	Plastic cover plate (no hole)	754965	2
6	5/16 x 1" CSK Screws	912000	12
7	M10 x 19 x 1.5 Milbolt	912820	2
8	M10 x 24 x 1.5 Milbolt	912825	2
9	Installation Tool	754200	2
10	Tekote Rust Preventative (Not Shown)	906300	1
11	3/8 Crinkle washer	932125	4
12	Bracket Assembly	775161	2
13	Cleaning Pad (Not Shown)	906302	1
14	Warning Label (Not Shown)	905017	1
15	Mounting Plate 105mm	754593	2



### TOOLS REQUIRED

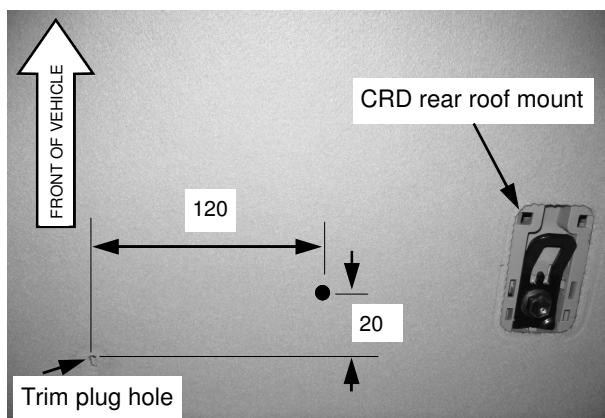
- ☐ Hammer
- ☐ Screwdriver
- ☐ Drill
- ☐ Masking Tape
- ☐ Marker
- ☐ Centre Punch
- ☐ 5mm, 10mm Drill Bits
- ☐ 22mm Hole Saw
- ☐ Drill stops
- ☐ Tape Measure
- ☐ Steel Rule

### FITTERS ADVICE

**Note:** To fit the Cargo Barrier the following is essential:

- ☐ Always drill perpendicular to surface (Unless stated otherwise).
- ☐ A positive drill stop should always be used to prevent accidental damage to external panels, fuel lines etc.
- ☐ Care should be taken when applying Tekote Sealer/Rust Preventative to all holes drilled to negate the possibility of skin and eye irritation.
- ☐ Check screws in relevant components by hand before installation. Should there be resistance re-tap threads and re-check.
- ☐ **Before marking or drilling for this Cargo Barrier, check vehicle for LPG Conversion. If LPG is fitted, locate gas unit and all lines attached and take EXTREME CARE whilst installing this Cargo Barrier.**

**CARE SHOULD BE TAKEN NOT TO CROSS THREAD THE FASTNERS DURING INSTALLATION OF COMPONENTS TO THE VEHICLE.**

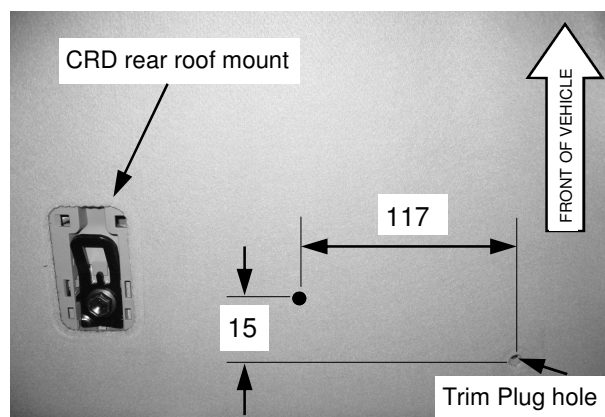


**Diagram 1:** Top drivers side rear roof mount location.

### **1. TOP DRIVERS REAR MOUNT LOCATION.**

- Place Masking tape in approximate area shown in adjacent picture.
- Mark location accordingly to picture with felt pen.

**Important:** Take measurement from trim plug hole. Mount location is on the roof lining.

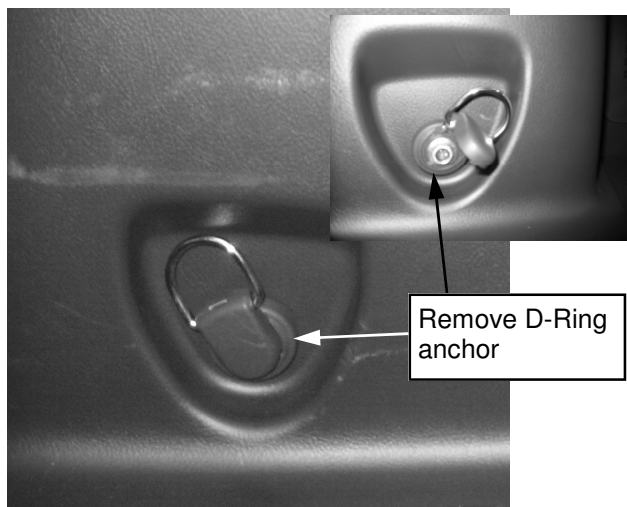


**Diagram 2:** Top passenger side rear roof mount location.

### **2. TOP PASSENGER REAR MOUNT LOCATION.**

- Place Masking tape in approximate area shown in adjacent picture.
- Mark location accordingly to picture with felt pen.

**Important:** Take measurement from trim plug hole. Mount location is on the roof lining.



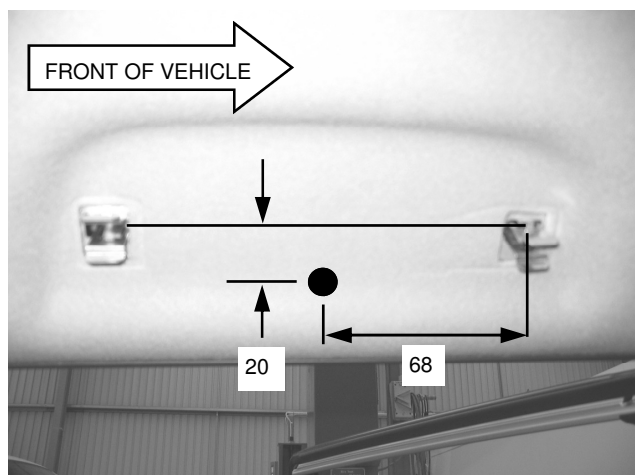
**Diagram 3:** Bottom mount locations.

### **3. BOTTOM MOUNT LOCATIONS.**

- Remove the D-Ring anchor and retain for later fitment.
- Repeat on other side.

**Important:** Retain D-Ring Anchor for later fitment.



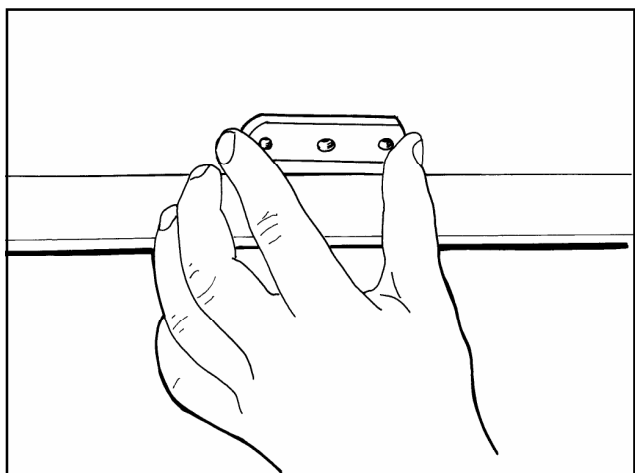


**Diagram 4:** Passenger side shown. Drivers side the same.

#### **4. FRONT TOP MOUNT LOCATIONS.**

- Place Masking tape in approximate area shown in adjacent picture.
- Mark centre line between grab handle mounts. (Take from centre of holes).
- Mark location accordingly to picture with felt pen.

**Important:** Do not drill holes until marked locations are confirmed.

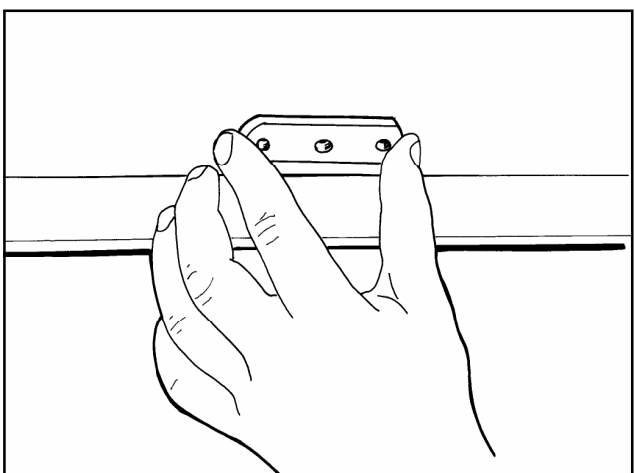


**Diagram 5:** Marking outer holes with Mounting Plate.

#### **5. MARK MOUNTING PLATE OUTER HOLES FOR TOP MOUNTS (REAR).**

- Place centre hole of Mounting Plate over marked location's from step's 1 and 2.
- Mark outer holes with Mounting Plate (Item 1) with felt pen.

**Important:** Mark outer holes parallel with rear tailgate support.



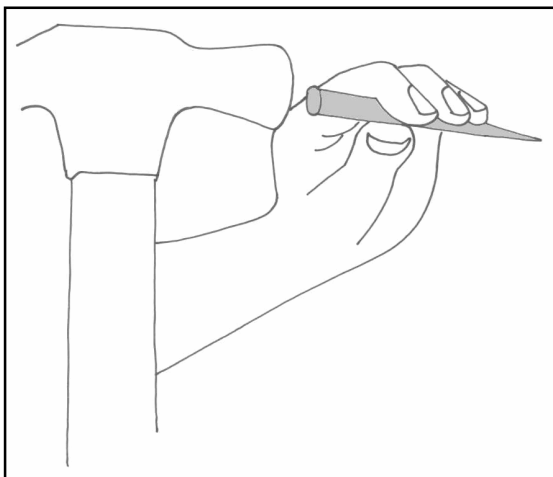
**Diagram 6:** Marking outer holes with Mounting Plate.

#### **5. MARK MOUNTING PLATE OUTER HOLES FOR TOP MOUNTS (FRONT).**

- Place centre hole of Mounting Plate over marked location's from step's 4.
- Mark outer holes with Mounting Plate (Item 1) with felt pen.

**Important:** Mark outer holes parallel with the side of the vehicle.



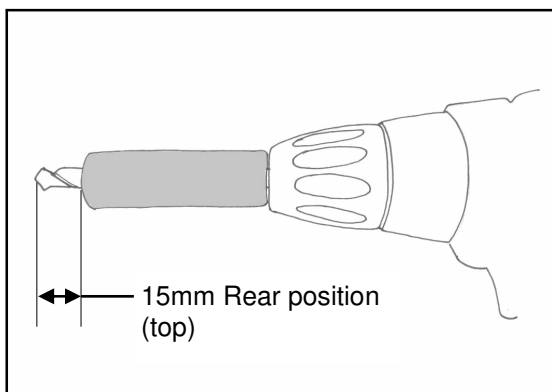


**Diagram 7:** Centre punch all marked locations.

## 7. CENTRE PUNCH .

- Centre punch all marked location points.
- In the front top mounts centre punch through soft trim until metal panel is marked.

**Important:** Centre punch through soft trim so metal panels are marked.

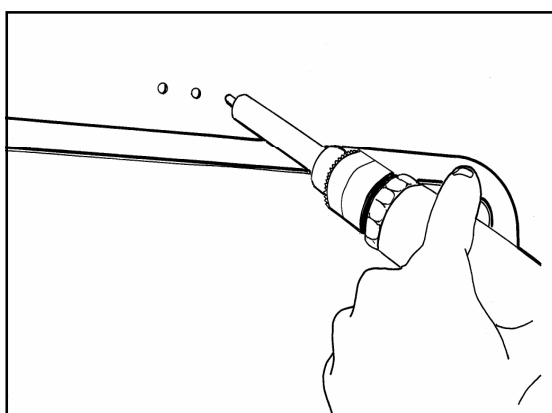


**Diagram 8:** Drill stop settings Rear top setting shown.

## 8. SETTING DRILL STOP LENGTH.

- Set Drill stop length as shown in picture for rear position.
- Set drill stop to 60mm when drill through the soft trim and metal panel in front position. **NOTE** ensure that care is taken not to drill through outer panels.

**Important:** Set Drill stop so outer panels or do not get damaged.



**Diagram 9:** Drilling 5 mm pilot holes in top panel shown.

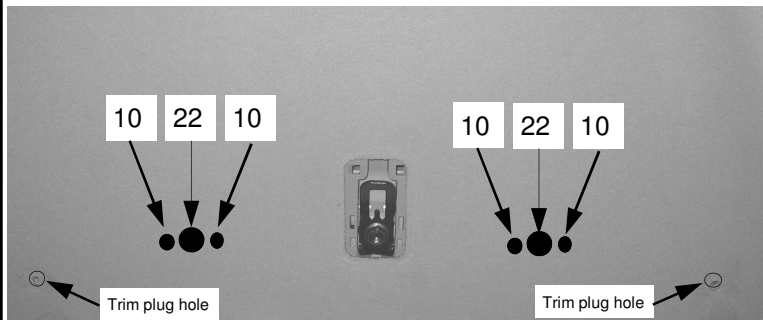
## 9. DRILLING PILOT HOLES

- Drill 5 mm pilot holes at all centre punched points.
- As the use of a drill stop may be difficult to use in the front top drilling process, **NOTE** ensure that care is taken not to drill through outer panels.

**Important:**

Drill perpendicular to all surfaces.





**Diagram 10:** This view show is the rear roof lining, looking from the floor to the roof.

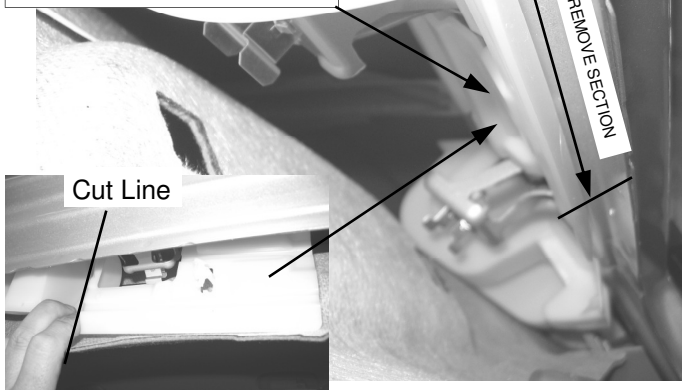
## **10. DRILLING TOP REAR MOUNTS .**

- Drill out holes as shown in picture.
- Holes should be drilled through the soft roof lining and the metal tailgate panel.

**Important:** Caution should be taken not to drill through outer panels.



Remove by cutting this section of plastic out exposing the metal panel

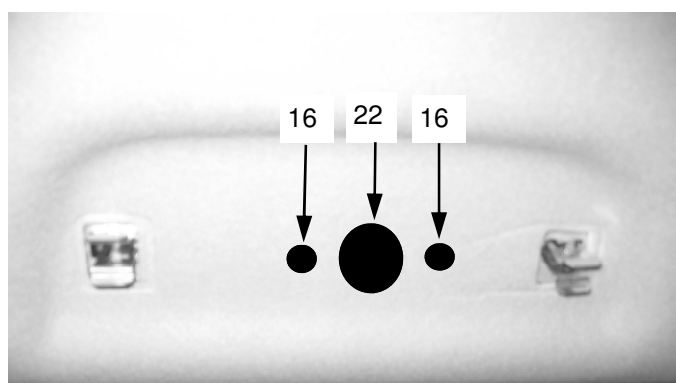


**Diagram 11:** This view show's where the section to be removed is behind the top front mounts.

## **11. REMOVING PLASTIC RIBBING IN TOP FRONT MOUNT LOCATION**

- Behind the roof lining grab handle area is a plastic rib re-enforcement that needs to be removed before mounts are installed.
- Cut and remove section of plastic as shown in picture.
- Repeat for other side.

**Important:** The use of a hack saw blade is advised to remove plastic section, but care should be taken.



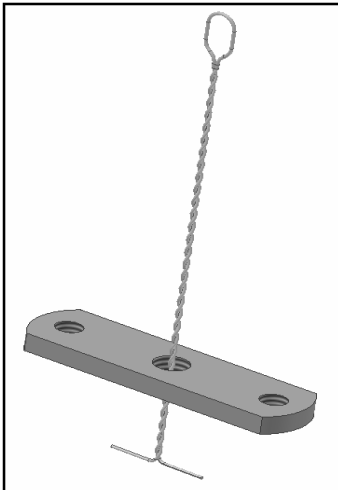
**Diagram 12:** Drilling the soft trim holes. Passenger side shown. Drivers side is the same

## **12. DRILLING FRONT TOP MOUNTS**

- Drill out holes as shown in picture in soft trim only.
- In the metal panel behind soft trim the outer holes should only be 10mm and the use of a drill stop is essential. **Set drill stop at 10mm.**
- As there is a void between the soft trim (roof lining) and the metal cantrail behind, care should be taken.

**Important:** Caution should be taken not to drill through outer panels. Always drill perpendicular to the trim lining.

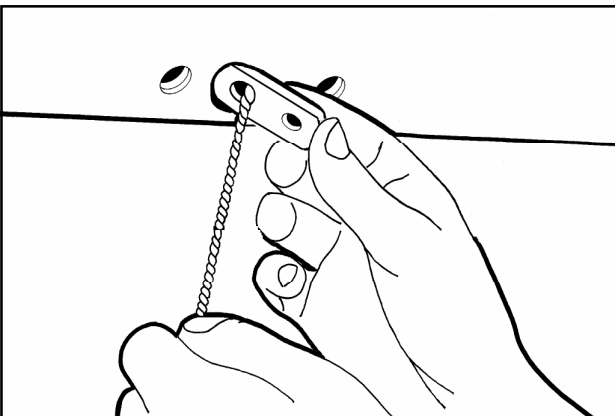




**Diagram 13:** Assembly of Installation Tool and Mounting Plate.

### **13. ASSEMBLY OF INSTALLATION TOOL AND MOUNTING PLATE.**

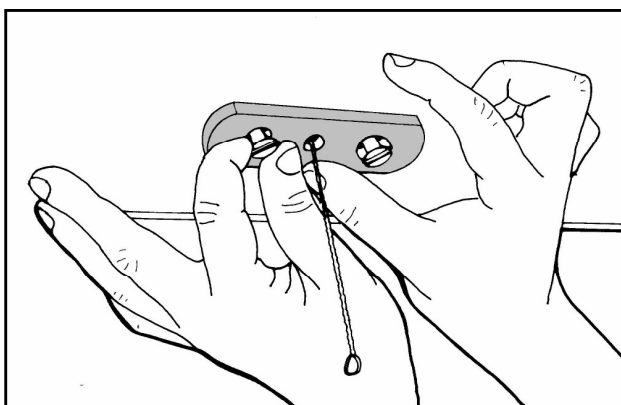
- Push eye of Installation Tool (Item 9) through centre hole of Mounting Plate (Item 1 ) as shown in picture.



**Diagram 14:** Inserting mounting plate.

### **14. INSERTING MOUNTING PLATE FOR TOP MOUNTS.**

- Insert Mounting Plate through centre 22mm holes drilled in step's 10 and 12 as shown in picture.



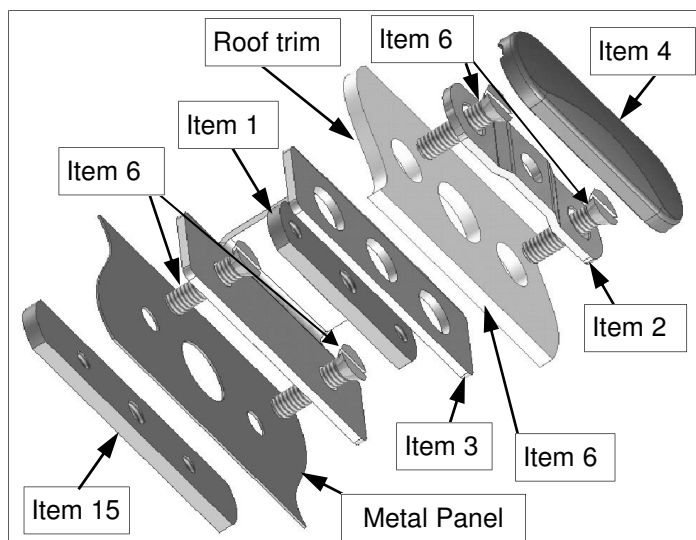
**Diagram 15:** Attaching Cover Plate to Mounting Plate.

### **15. COVERPLATE ASSEMBLY TOP MOUNTS (REAR).**

- Slide centre hole of Concealed Cover Plate (Item 2) over eye of Installation Tool.
- Hold Cover Plate in position with end holes lined up with those of the Mounting Plate behind the metal panel.
- Attach outer holes using 5/16 x 1" CSK Screws (Item 6).
- Attach Plastic cover plate (Item 4) to concealed cover plate (Item 2).
- **NOTE**– When position is not in use, replace plastic cover plate with hole (Item 4) with plastic cover plate blank (Item 5).
- Repeat for other side.

**Important:** Ensure M10 x 1.5 centre thread is aligned correctly.





**NOTE:** There may be some foam packing where the mounting plate (Item 15) sits towards the front of the vehicle. It may be necessary to remove some foam for the plate to fit.

## 16. FRONT TOP COVER PLATE ASSEMBLY.

- Whilst holding the mounting plate in position with the installation tool, slide the centre small hole of the Bracket over eye of installation tool with the large holes facing outwards.
- Assemble as shown in diagram.
- **NOTE**– When position is not in use, replace plastic cover plate with hole (Item 4) with plastic cover plate blank (Item 5).
- Repeat for the other side.

### Important:



Ensure the all 5/16 screws are tight.



Fig 1



Fig 2

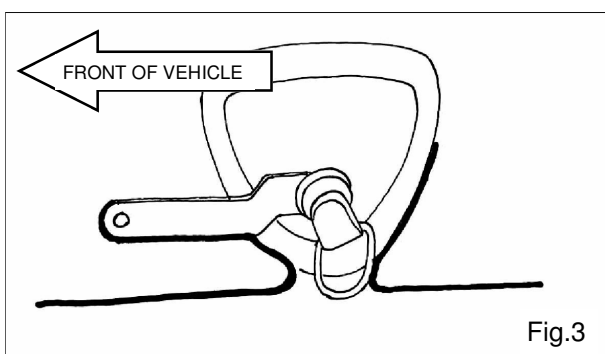


Fig.3

## 17. BOTTOM MOUNT INSTALLATION.

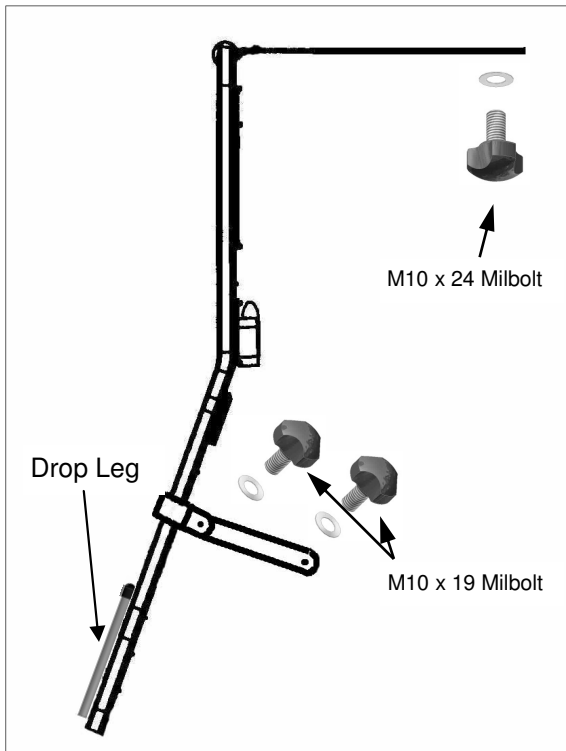
- Assemble strap bracket (Item 12) to D-Ring anchor as shown in Fig 1.
- Ensure the strap is between the shoulder of the main D-Ring body and the washer as show in Fig 2.
- Assemble D-Ring anchor and strap bracket back to original position shown in Fig 3.

**Diagram 18 :** Assembly orientation of the bottom mount assembly.

### Important:



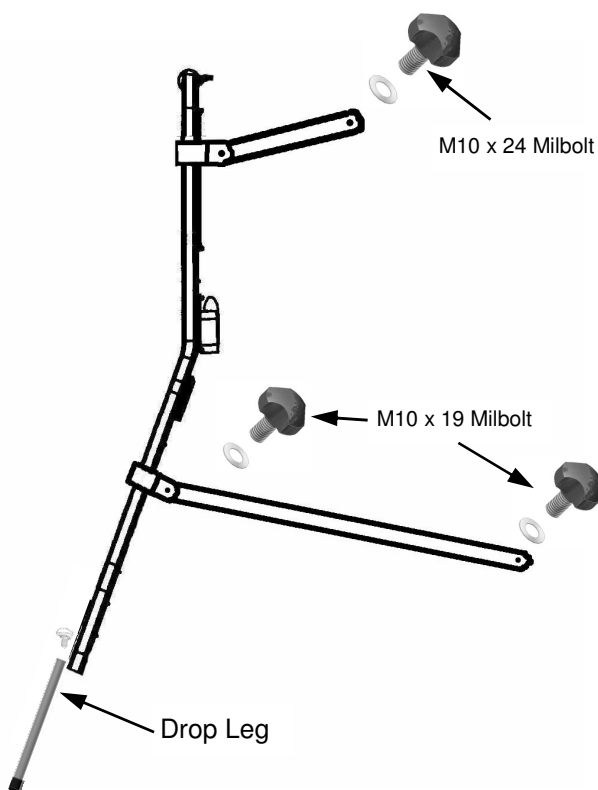
Ensure the D-Ring anchor screw is firmly tightened.



## **18. REAR POSITION CARGO BARRIER ASSEMBLY.**

- Place the cargo Barrier behind the rear seats.
- Using the M10 x 24mm Milbolts (Item 8), attach the top straps to the top mounts in the rear mounts.
- Using the M10 x 19mm Milbolts (Item 7), attach the bottom straps to the strap bracket.
- **NOTE:** Make sure the Identification label is facing towards the rear of the vehicle.

**Important:** Check that all nuts, bolts and screws are tight and re-check periodically.



## **19. FRONT POSITION CARGO BARRIER ASSEMBLY.**

- Place the cargo Barrier behind the front seats.
- Release drop leg from cargo Barrier, so leg is resting on floor tunnel.
- Attach long straps (attached to mesh of Cargo barrier) to bottom side bracket. Wrinkles facing in towards the barrier.
- Using the M10 x 24mm Milbolts (Item 8), attach the top straps to the top mounts in the rear mounts.
- Using the M10 x 19mm Milbolts (Item 7), attach the bottom straps to the strap bracket.
- **NOTE:** Make sure the Identification label is facing towards the rear of the vehicle.

**Important:** Check that all nuts, bolts and screws are tight and re-check periodically.

