



VOLKSWAGEN CRAFTER CARGO BARRIER FITTING INSTRUCTION PART # 717025

VEHICLE YEARS OF MANUFACTURE - From July 2018 (August 2018 release)



This cargo barrier is capable of being located in one position only, behind the 1st row of seats in an upright position. The installation kit contains sufficient components for fitment to front position only. A high degree of technical competence is necessary to correctly install this product.

We recommend this cargo barrier be installed by an authorised outlet to ensure the barrier installation complies with AS/NZS 4034 Standard.

The cargo barrier is designed, manufactured and fitted to decrease the impact hazard in an accident to occupants from cargo carried within the interior cargo space of the vehicle. In the event of an accident, a cargo barrier can reduce injuries caused by cargo intruding into occupant's space.

Installation time approximately 0.75 Hours

"The estimated fitting time is based on an experienced fitter conversant with the fitment procedure"



WARNINGS

- Strict compliance with fitting instructions is essential for this safety product to meet its rated capacity. Refer user instructions regarding correct usage of the cargo barrier.
- Do not modify cargo barrier in any way.
- Do not use this cargo barrier in any other vehicle for which it is not designed.
- Modifications to the cargo barrier or its fixings or use in any other vehicle for which it is not designed may void the load rating and warranty.
- Do not attach the cargo barrier to the vehicle using seat, seat belt or child restraint anchorage's.
- Where high tensile threaded fasteners are used, the cargo barrier must be installed using the size and grade fasteners specified by Milford Industries.
- Do not drill, rivet, adhere or attach objects to the front or rear of the cargo barrier.
- Do not place smaller items, that may bypass the cargo barrier in the event of heavy braking or collision, near the edges of the barrier.
- Position the load against the cargo barrier.
- When load is positioned against cargo barrier, secure the load with a restraint system.
- During a collision moving cargo may damage seat belts or tether straps of a child restraint device, or its anchorage. Load should be carefully positioned so as not to come in contact with these items.
- Do not obstruct seat belts or child restraints, or their operation.
- Long thin items of cargo should be positioned in the vehicle with the long axis across the vehicle to minimise the penetration risk.
- If involved in an accident or accidentally damaged, the cargo barrier should be replaced and the anchorage's repaired to as new condition.
- Clean with soap and water only. Do not use solvents or chemicals. Discard cargo barrier if it becomes rusted. Do not expose to direct sunlight for long periods.
- It is extremely dangerous to ride in the cargo area of the vehicle behind the cargo barrier. It is recommended that the cargo barrier be removed. In a collision people or children riding unrestrained in these areas are more likely to be seriously injured or killed.
- Never leave a child in the vehicle unattended, particularly in the rear cargo area. The cargo area should never be used as a play area for children.
- The cargo barrier may deform and significantly intrude into occupant's space in an accident.
- Remember that the tailgate cannot be opened from inside the cargo area.
- The fixed labeling should not be removed from the cargo barrier.
- Failure to comply with warning notes may prevent the barrier protecting the occupants.
- Parents should explain to children how and when to use EMERGENCY ESCAPE HAMMER attached to cargo barrier.
- Do not remove the rating plaque from the cargo barrier.

NOTICE TO INSTALLERS & DISTRIBUTORS

Please ensure Fitting Instructions are left with vehicle owner after installation.



VOLKSWAGEN CRAFTER CARGO BARRIER FITTING INSTRUCTION PART # 717025

VEHICLE YEARS OF MANUFACTURE - From July 2018 (August 2018 release)



IMPORTANT: The installation kit contains sufficient components to fit the cargo barrier. A high degree of technical competence is necessary to correctly install this product. We recommend this cargo barrier be installed by an authorised outlet to ensure the barrier installation is correct. These instructions must be read and clearly understood before commencing installation. Check contents of kit before commencing fitment and report any discrepancies or damage.

Parts List

Item	Component Name	Part No.	Qty
1	Cargo Barrier ASM (not shown)	717040	1
2	Pivot Saddle	752700	6
3	Pivot Saddle Bush	752680	6
4	Top Strap	776054	2
5	Bottom Bracket (LHS)	753868	1
6	Bottom Bracket (RHS)	753869	1
7	Screw - Hex Head M10 x 1.5 x 20mm Zn	912205	6
8	Nut - Nyloc M10 x 1.5 Zn	922090	6
9	Middle Bracket (LHS)	754919	1
10	Middle Bracket (RHS)	754929	1
11	Screw - Button Head M8 x 1.25 x 30mm	913137	2
12	Washer - Flat M8	932085	2
13	Versa-Nut M8 x 1.25 Zn	922290	2
14	Rust Preventative Sealer	906300	1



2



3

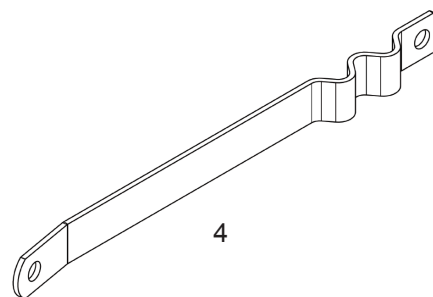

4

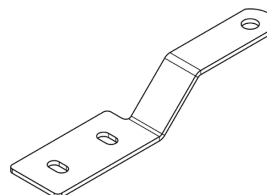

5

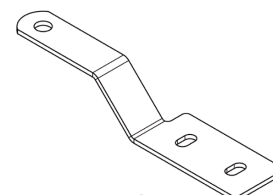

6



7



8

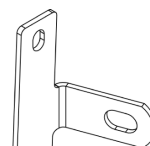

9

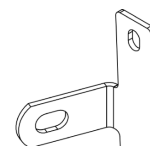

10



11



12

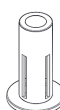

13

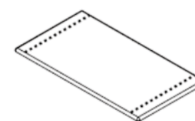

14

E and OE—Errors and Omissions Excepted



VOLKSWAGEN CRAFTER CARGO BARRIER FITTING INSTRUCTION PART # 717025

VEHICLE YEARS OF MANUFACTURE - From July 2018 (August 2018 release)



ADVICE TO FITTER

Note: To fit the cargo barrier the following is essential:

- ☐ Always drill perpendicular to surface (Unless stated otherwise).
- ☐ A positive drill stop should always be used to prevent accidental damage to external panels, fuel lines etc.
- ☐ Ensure Safety Eye Protection and Gloves are worn as required when using cutting tools.
- ☐ When cutting metal panels be very careful of sharp edges, for risk of skin cuts etc.
- ☐ Care should be taken when applying Rust Preventative sealer to all holes drilled, to negate the possibility of skin and eye irritation.
- ☐ Check screws in relevant components by hand before installation. Should there be resistance re-tap threads and re-check.
- ☐ **Before marking or drilling to install this cargo barrier, check vehicle for LPG conversion & non standard fuel tanks. Locate tanks and all lines attached and take EXTREME CARE not to damage whilst installing this cargo barrier.**
- ☐ **Before drilling to install this cargo barrier, check for concealed wiring looms. E.g. tow bar, reversing camera, reversing sensor wiring etc.. Relocate before drilling to avoid damage.**

CARE SHOULD BE TAKEN NOT TO CROSS THREAD THE FASTENERS DURING INSTALLATION OF COMPONENTS TO THE VEHICLE.

TOOLS REQUIRED

- | | |
|------------------|---------------------|
| • Drill | • Masking Tape |
| • 11mm Drill Bit | • Marker |
| • Torque Wrench | • Versa-Nut Tool |
| • Steel Rule | • Cover Sheet |
| • Hex Sockets | • Tape Measure |
| • Socket Wrench | • Small Screwdriver |
| • Vacuum Cleaner | |



VOLKSWAGEN CRAFTER CARGO BARRIER FITTING INSTRUCTION PART # 717025

VEHICLE YEARS OF MANUFACTURE - From July 2018 (August 2018 release)



PREPARATION FOR TOP MOUNTS

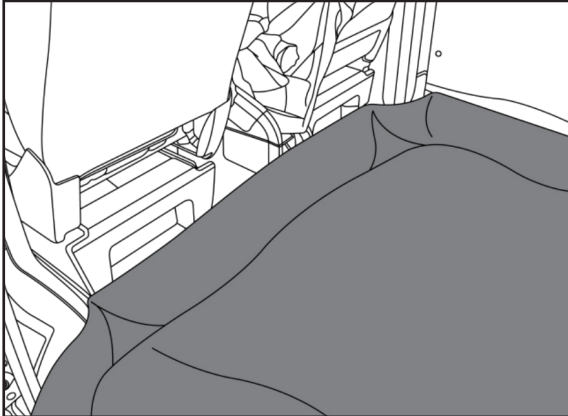

1. Open the sliding door on the vehicle and place a drop sheet over the floor area behind the front seats.



2. Find the hole shown on the first crossbeam from the front of the vehicle, on both sides.

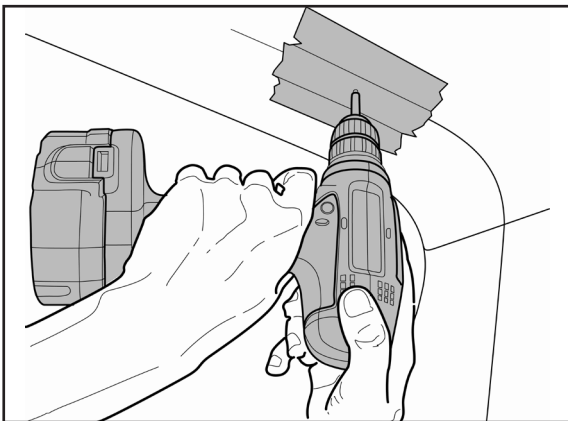

3. Place masking tape over the hole and enlarge the hole using a 11mm drill bit with a 10mm drill stop.
4. Apply rust preventative sealer (14) to the raw edges of the drilled hole using a small screwdriver.

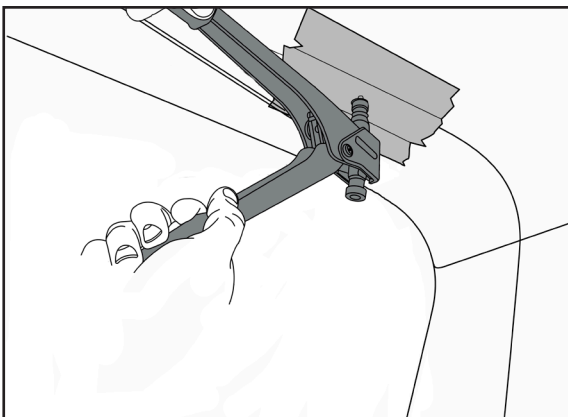

5. Repeat on the other side.
6. Screw a threaded insert (13) onto a suitable threaded insert tool.
7. Push the threaded insert fully into one of the drilled holes then pull to secure in place.



VOLKSWAGEN CRAFTER CARGO BARRIER FITTING INSTRUCTION PART # 717025

VEHICLE YEARS OF MANUFACTURE - From July 2018 (August 2018 release)



PREPARATION FOR MIDDLE MOUNTS



8. Repeat on the other side.
9. Remove the two screws shown underneath the door handle on the LHS of the vehicle and retain for use in step 32.

PREPARATION FOR BOTTOM MOUNTS



10. Repeat on the RHS of the vehicle.
11. Find the two 'D' anchor locations behind the front seats on either side of the vehicle.

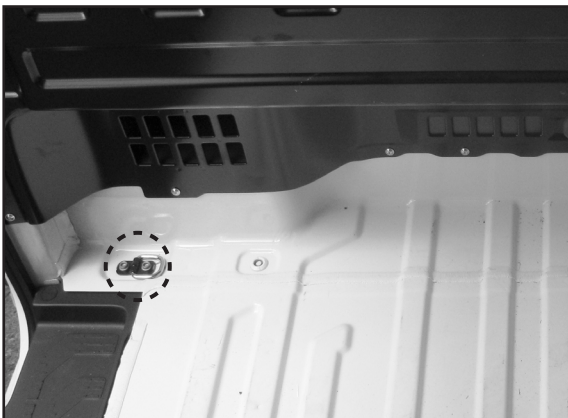

12. Remove the screws securing the 'D' anchors in place, and remove the 'D' anchors from the floor of vehicle. Retain for use in step 33.



VOLKSWAGEN CRAFTER CARGO BARRIER FITTING INSTRUCTION PART # 717025

VEHICLE YEARS OF MANUFACTURE - From July 2018 (August 2018 release)



PREPARING TOP MOUNTS FOR INSTALLATION

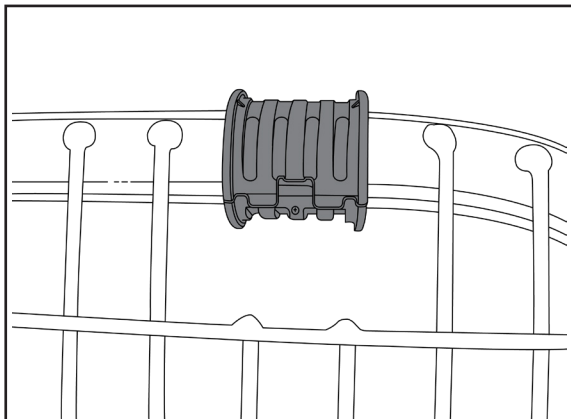

13. At the two cut outs at the top of the mesh on the perimeter of the cargo barrier, place a pivot saddle bush (3) as shown.

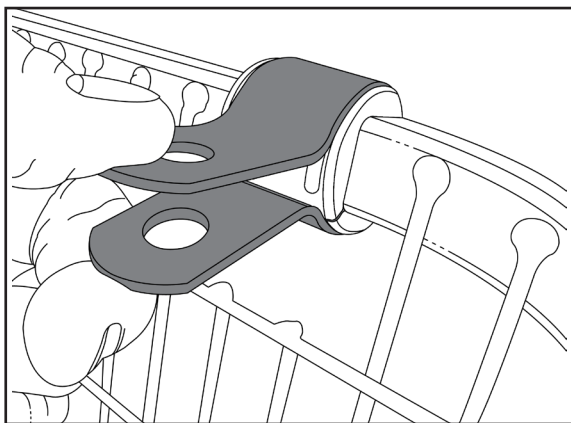

14. Place a pivot saddle (2) over each of the pivot saddle bushes then push the ends together.

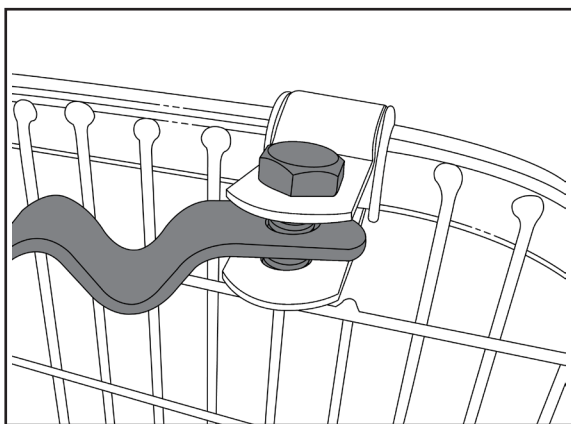

15. Place a correct strap (4) in between the pivot saddle ends, then place a hex screw (7) through the saddle and strap.

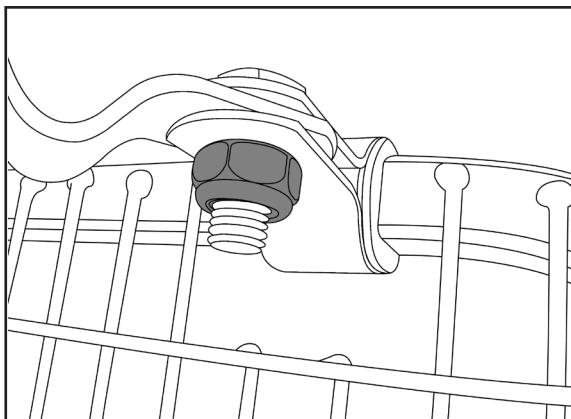

16. Place a nyloc hex nut (8) onto each of the hex screws then tighten until strap is firm in saddle but can still be pivoted.



VOLKSWAGEN CRAFTER CARGO BARRIER FITTING INSTRUCTION PART # 717025

VEHICLE YEARS OF MANUFACTURE - From July 2018 (August 2018 release)



Behind you all the way

PREPARING MIDDLE MOUNTS FOR INSTALLATION

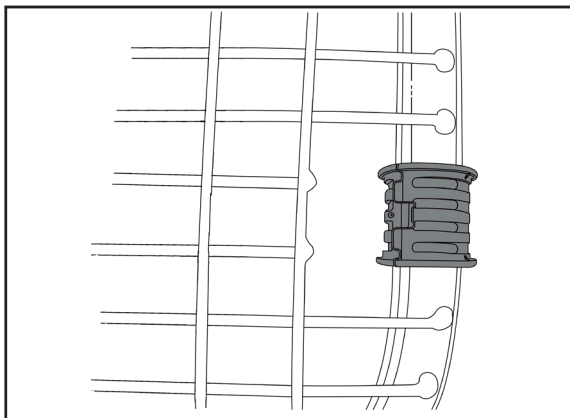

17. At the two cut outs on either vertical side of the mesh, place a pivot saddle bush (3) as shown.

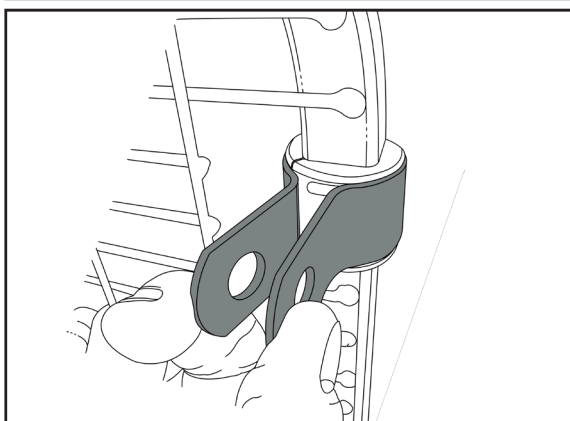

18. Place a pivot saddle (2) over each of the pivot saddle bushes then push the ends together.

PREPARING BOTTOM MOUNTS FOR INSTALLATION

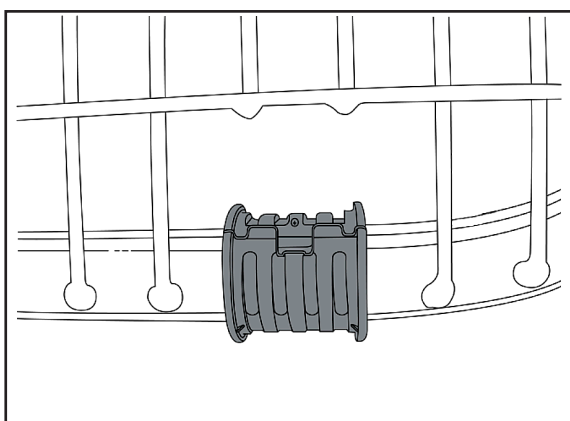

19. At the bottom cut outs on the perimeter of the mesh, place a pivot saddle bush (3) as shown.

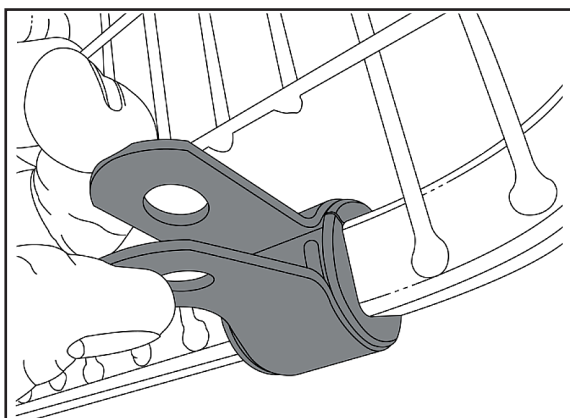

20. Place a pivot saddle (2) over each of the pivot saddle bushes then push the ends together.



VOLKSWAGEN CRAFTER CARGO BARRIER FITTING INSTRUCTION PART # 717025

VEHICLE YEARS OF MANUFACTURE - From July 2018 (August 2018 release)



INSTALLING CARGO BARRIER TO VEHICLE

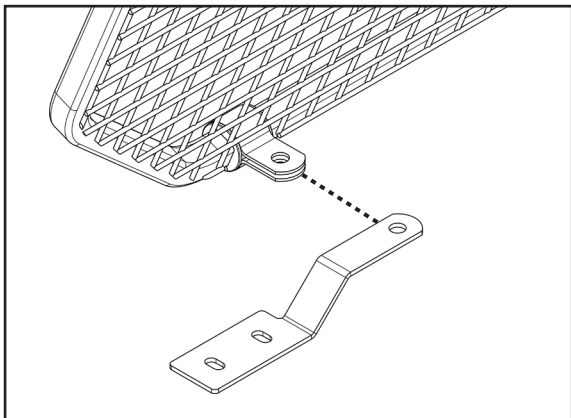

21. Place the LHS bottom bracket (5) between the pivot saddle ends.

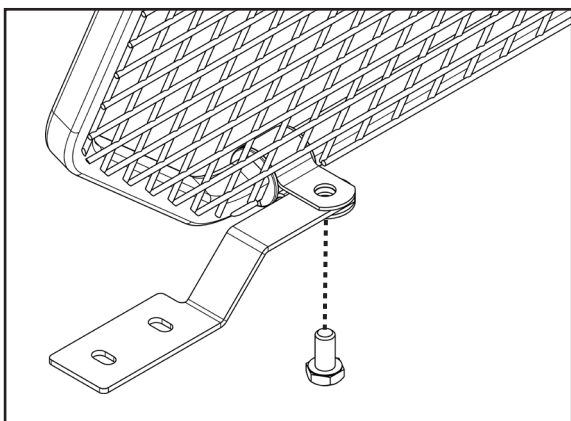

22. Place a hex screw (7) up through the bottom bracket and strap as shown.

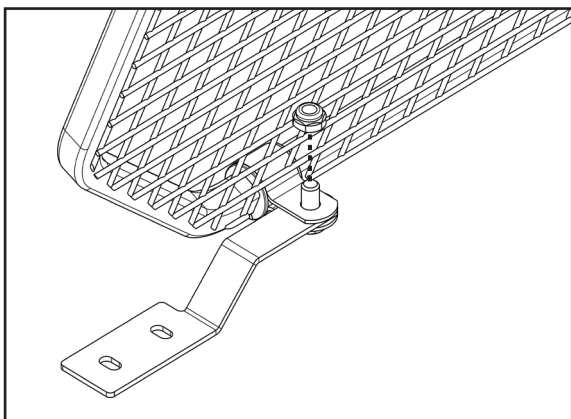

23. Place a nyloc hex nut (8) onto the screw then tighten until the strap is form in saddle but can still be pivoted.
24. Repeat on the RHS.

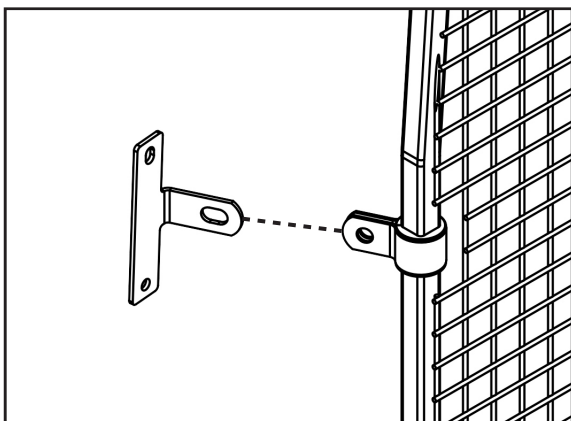

25. Align the LHS middle bracket (9) with the saddle pivot on the LHS of the cargo barrier.



VOLKSWAGEN CRAFTER CARGO BARRIER FITTING INSTRUCTION PART # 717025

VEHICLE YEARS OF MANUFACTURE - From July 2018 (August 2018 release)



PREPARING MIDDLE MOUNTS FOR INSTALLATION

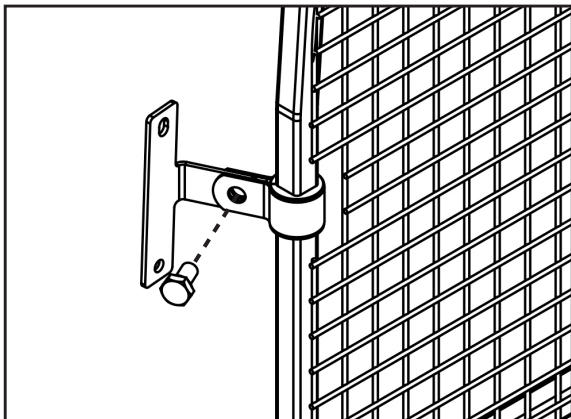

26. Place the strap between the pivot saddle ends then place a hex screw (7) through the saddle and strap, towards the centre of the vehicle.

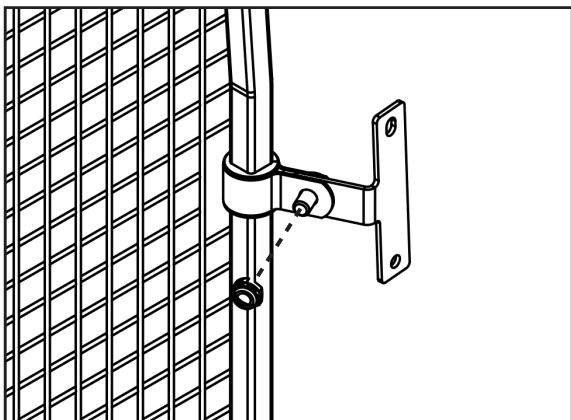

27. Secure the screw in place with a nyloc hex nut (8).
28. Repeat on the RHS of the vehicle.



VOLKSWAGEN CRAFTER CARGO BARRIER FITTING INSTRUCTION PART # 717025

VEHICLE YEARS OF MANUFACTURE - From July 2018 (August 2018 release)



INSTALLATION OF CARGO BARRIER

29. Ensure all straps and brackets are pivoted towards the meshed side of the cargo barrier.
30. Manoeuvre cargo barrier into vehicle with the rating label (meshed side of cargo barrier) facing the rear of the vehicle. Locate cargo barrier behind front seat position.
31. Attach the top straps to the upper mounts using button head screws (11) and flat washers (12) under heads.
32. Attach middle brackets to middle mounts using original screws.
33. Attach bottom brackets (5 & 6) to floor mounts using original 'D' anchor screws and 'D' anchors.
34. Tighten all screws and bolts.
35. Torque up all screws to 22 Nm.

