



*behind you all the way.*

**T5 TRANSPORTER. Part # 707150**  
**STANDARD ROOF**



This Cargo Barrier is capable of being located in **one position only**, behind the front row of seats. The installation kit contains sufficient components for fitment to the location.

The cargo barrier is designed, manufactured and fitted to decrease the impact hazard in an accident to occupants from cargo carried within the interior cargo space of the vehicle. In the event of an accident, a cargo barrier can reduce injuries caused by cargo intruding into occupant's space.

The installation kit contains sufficient components to fit the cargo barrier. A high degree of technical competence is necessary to correctly install this product. We recommend this Cargo Barrier be installed by an Authorised outlet to ensure the barrier installation complies with AS/NZS 4034 Standard.



**WARNING!**

- Strict compliance with fitting instructions is essential for this safety product to perform as designed. Refer user instructions regarding correct usage of the Cargo Barrier.
- Seat, seat belt or child restraint anchorage's must not be used for mounting the Cargo Barrier.
- Where high tensile threaded fasteners are used, the cargo barrier must be installed using the size and grade fasteners specified by Milford Industries.
- Do not drill, rivet, adhere or attach objects to the front or rear of the Cargo Barrier.
- When load is positioned against cargo barrier, secure the load with a restraint system.
- During a collision moving cargo may damage seat belts or tether straps of a child restraint device, or its anchorage. Load should be carefully positioned so as not to come in contact with these items.
- Do not obstruct seat belts or child restraints, or their operation.
- Long thin items of cargo should be positioned in the vehicle with the long axis across the vehicle to minimize the penetration risk.
- If involved in an accident or accidentally damaged, the cargo barrier should be replaced and the anchorage's repaired to as new condition.
- Clean with soap and water only. Do not use solvents or chemicals. Discard Cargo Barrier if it becomes rusted.
- Do not store cargo barrier outside in direct sunlight.
- It is extremely dangerous to ride in the cargo area of the vehicle behind the cargo barrier. It is recommended that the cargo barrier be removed. In a collision people or children riding unrestrained in these areas are more likely to be seriously injured or killed.
- Never leave a child in the vehicle unattended, particularly in the rear cargo area. The cargo area should never be used as a play area for children.
- The Cargo Barrier may deform and significantly intrude into occupant's space in an accident.
- The plaque shall not be removed from the cargo barrier.
- Failure to comply with warning notes may prevent the barrier protecting the occupants.
- Parents should explain to children how and when to use **EMERGENCY ESCAPE HAMMER** attached to Cargo Barrier.



# MILFORD INDUSTRIES

## CARGO BARRIER

### PART # 707150



## VOLKSWAGEN T5 TRANSPORTER

### CARGO BARRIER

**TO SUIT STANDARD ROOF MODELS ONLY**

YEARS OF MANUFACTURE - 2004 ONWARDS.

This is a single position Cargo Barrier for location directly behind the front row of seats.

### CARGO BARRIER PARTS LIST

<u>Item No</u>	<u>Component No.</u>	<u>Qty</u>	<u>Component Description</u>
1	707150	1	Cargo Barrier Panel
2	753017	2	Mounting Plate Long (all holes M10)
3	754000	2	Mounting Plate Short
4	912000	4	$\frac{5}{16}$ " BSW x 1" CSK Screw
5	754235	4	Metal Cover Plate
6	754829	2	Tube, Spacer 24mm 16 x 24 mm Zinc
7	912205	4	Screw , Hex HD M10 x 1.5 20mm Zn
8	913055	2	Screw , Hex HD M10 x 1.5 50mm Zn
9	922090	2	M10 Nyloc Nut
10	904315	2	Washer, Rubber
11	775025	1	Powder Coated Strap (L/H) (yellow dot)
12	775030	1	Powder Coated Strap (R/H)
13	932125	8	$\frac{3}{8}$ Crinkle Washer
14	906300	1	Tekote Sealer/Rust Preventative (Not Shown)
15	754200	2	Installation Tool - Short (Not Shown)
16	912015	4	Screw, Pan HD M10 x 1.5 25mm Zn

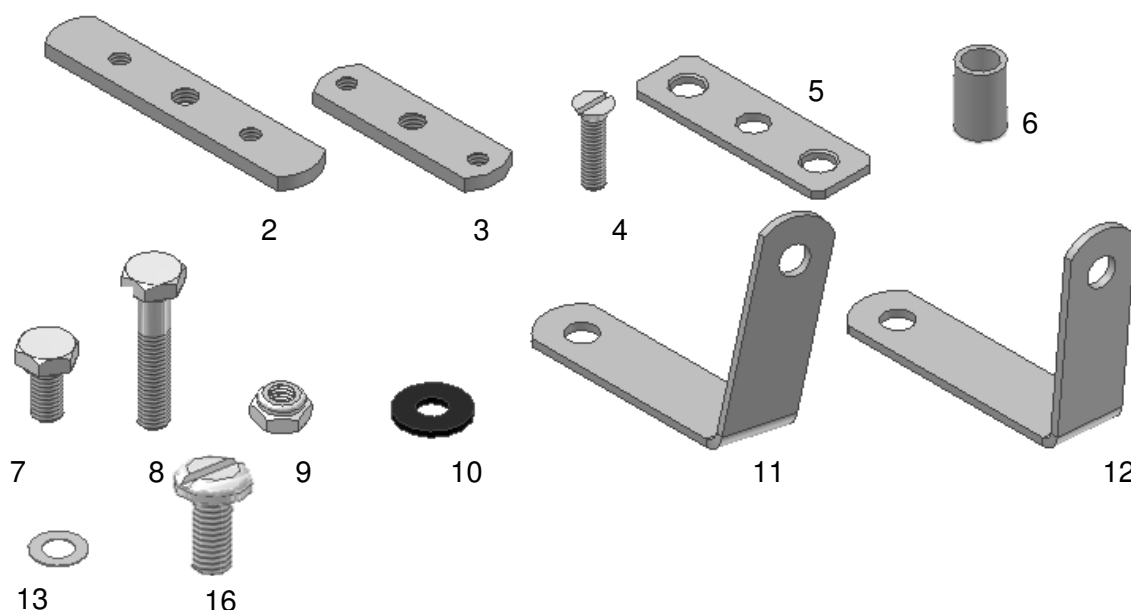



## T5 TRANSPORTER. Part # 707150 STANDARD ROOF



### TOP MOUNTING POINT LOCATIONS

#### PASSENGERS SIDE SHOWN

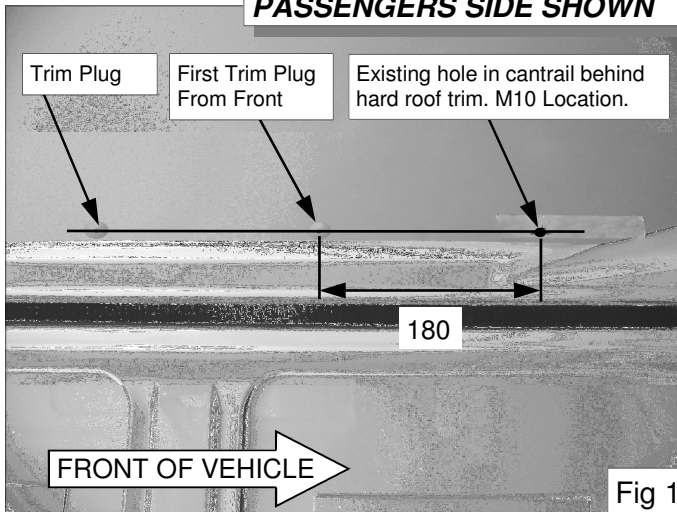

Fig 1



#### CAUTION!!!

- If fitting Dual Siding Door vehicle, mark mounting points as per Figure 1 on both sides.
- If fitting Single Siding Door vehicle, mark passenger side as per figure 1 & drivers side as per Figure 2.

1. Remove trim plug so a visual check can be done to find mounting point.
2. Mark a straight line intersecting the centre of both trim plugs as shown.
3. Measure 180mm from the centre of the trim plug in roof hard trim toward the front of the vehicle. (Fig. 1)
4. Where these two lines intersect is the mounting plate M10 centre hole location. **NOTE**– At this M10 location there will be an existing hole behind the trim.

#### DRIVERS SIDE SHOWN

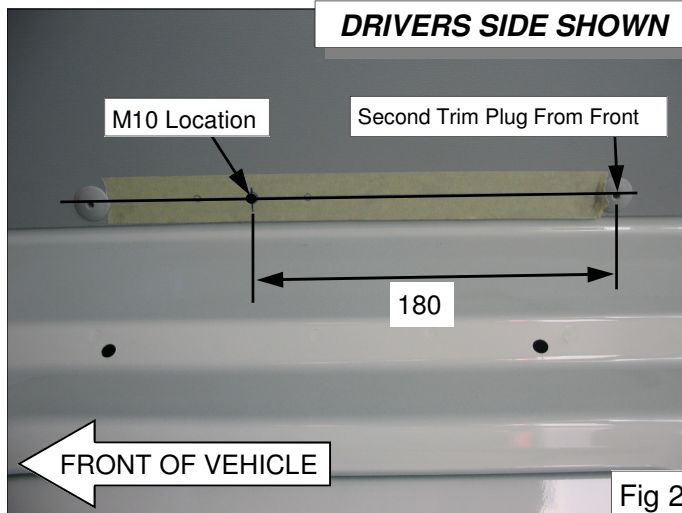

Fig 2

1. Mark a straight line intersecting the centre of both trim plugs as shown.
2. Measure 180mm from the centre of the trim plug in roof hard trim toward the front of the vehicle. (Fig. 2)
3. Where these two line intersect is the centre M10 location.

### FLOOR MOUNTING POINT LOCATIONS

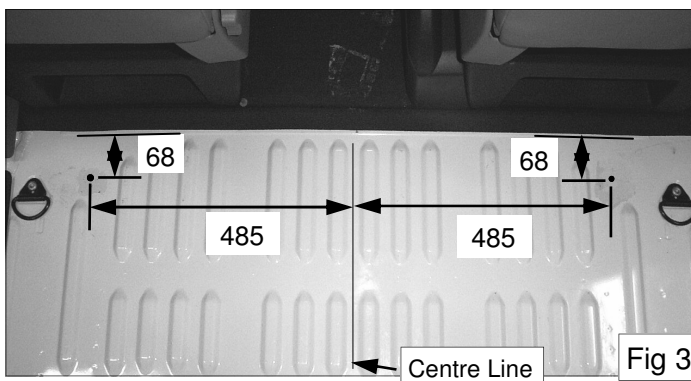

Fig 3

1. Measure from centre of floor outward 485mm in both directions. (Fig. 3)
2. From edge of the transverse rib (just behind the edge of the rubber mat) measure back 68mm. (Fig. 3)
3. Where these points intersect, is the centre hole of the mounting plate.
4. Mark these points for reference in step 5.
5. **Place barrier in vehicle to ensure bottom straps align with marked points.**



## T5 TRANSPORTER. Part # 707150 STANDARD ROOF



### FLOOR MOUNT LOCATION cont'd.

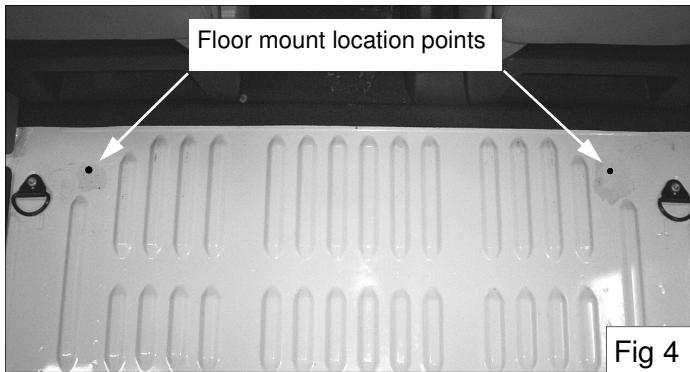

Fig 4

5. Now the reference points are marked on the floor, place the Cargo Barrier in position and check that the holes on the bottom brackets (attached to the barrier) align with the marked points.
6. If marked locations are correct remove Cargo Barrier for later fitment. If not correct, adjust marked points to suit hole locations on brackets.

### MARKING ALL OUTER HOLES

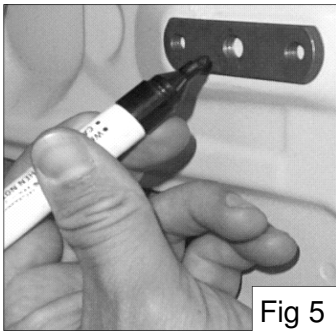

Fig 5

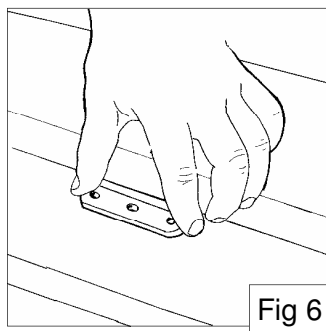

Fig 6

1. Using mounting plate (Item 3) as a template, position centre hole over locations marked previously and mark with a felt pen all outer holes as follows (Fig. 5).
2. **Top Mounts;** horizontal with the side of vehicle. (Fig. 7)
3. **Floor Mounts;** parallel with the sides of the vehicle. (Fig. 6)

### DRILLING PROCEDURE for TOP MOUNTS

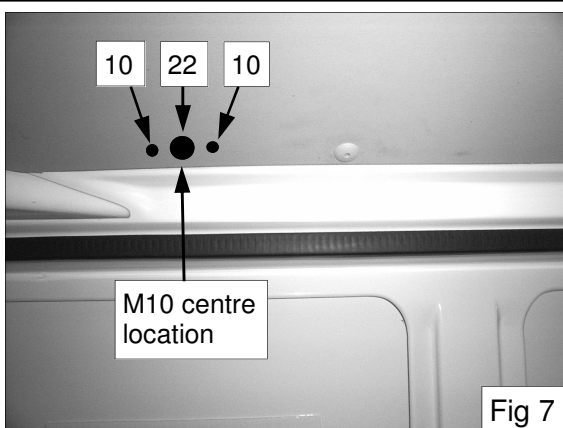

Fig 7

1. Centre punch all marked locations.
2. Using a 5mm drill bit (**ensure a suitable drill stop is set at a depth of 20mm so outer panels do not get damaged**), pilot drill all marked locations through roof trim and metal panel.
3. Drill a 22mm hole using a hole saw at all centre M10 locations. (Fig. 7)
4. Drill outer holes to 10mm. (Fig. 7)
5. Repeat procedure for other side.



**NOTE:** WHEN DRILLING OUT ALL MARKED LOCATIONS THE USE OF A POSITIVE DRILL STOP IS ADVISED TO PREVENT THE DAMAGE OF THE OUTER PANELS. ( The specified depth is advised in the Drilling Procedures)





## T5 TRANSPORTER. Part # 707150 STANDARD ROOF



### DRILLING PROCEDURE for FLOOR MOUNTS

Fig 8



1. Centre punch all marked locations.
2. Using a 5mm drill bit (**ensure a suitable drill stop is set at a depth of 10mm so under panels do not get damaged**), pilot drill all marked locations through metal floor.
3. Drill a 22mm hole using a hole saw at all centre M10 locations. (Fig. 8)
4. Drill outer holes to 12mm. (Fig. 8)
5. Vacuum all swarf from drilled holes.
6. Apply Tekote sealer to ALL drill points (Item 14).
7. Repeat procedure for other side.



**NOTE:** WHEN DRILLING OUT ALL MARKED LOCATIONS THE USE OF A POSITIVE DRILL STOP IS ADVISED TO PREVENT THE DAMAGE OF THE OUTER PANELS. ( The specified depth is advised in the Drilling Procedures)

### INSTALLATION of TOP MOUNTS

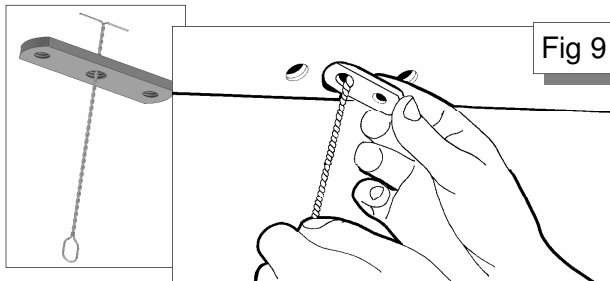

Fig 9

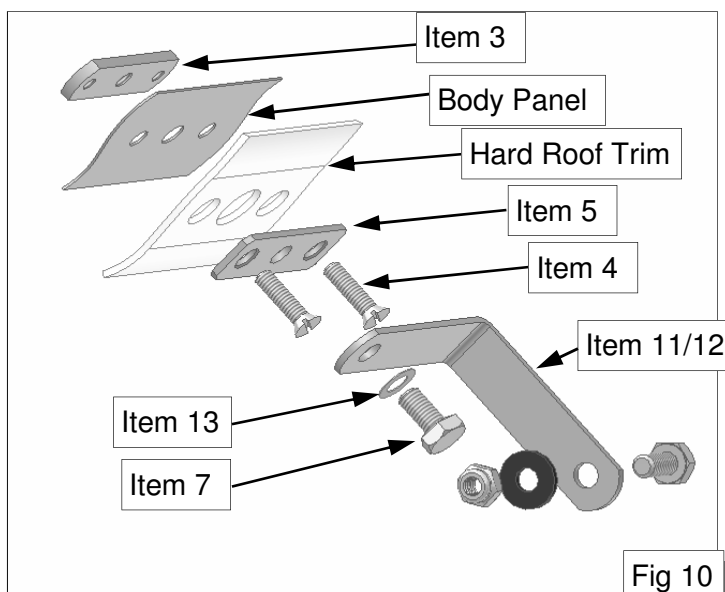

Fig 10

1. Insert the installation tool (Item 15) through the centre hole of the short mounting plate (Item 3) as seen in Fig. 9.
2. Whilst holding the end of the installation tool, push the mounting plate through the centre 22mm hole in the metal panel. (Fig. 9)
3. Slide the centre hole of the metal cover plate (Item 5) over the end of the installation tool.
4. Using the CSK 5/16 Screws (Item 4) attach the assembly together through the outer holes.
5. Remove the installation tool and square up the ends, tighten CSK screws ensuring that the M10 centre hole is Alined. Assembly has been exploded for alined explanation see (Fig. 10).
6. Repeat procedure for other side.

**NOTE:** DO NOT OVER TIGHTEN OR CROSS THREAD SCREWS. THREADS SHOULD BE CHECKED BEFORE USE.



## T5 TRANSPORTER. Part # 707150 STANDARD ROOF



### INSTALLATION of FLOOR MOUNTS

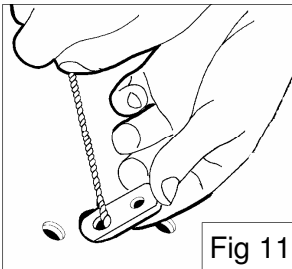

Fig 11

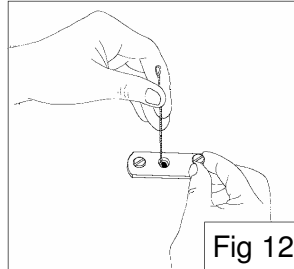

Fig 12

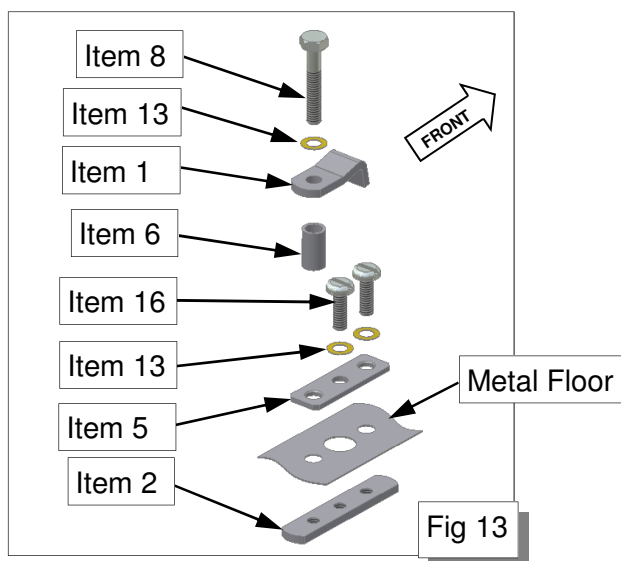

Fig 13

1. Insert installation tool (Item 15) into the centre hole of the long mounting plate (item 2). See Fig 11.
2. Whilst holding the installation tool, insert the mounting plate through the centre 22mm hole previously drilled. See Fig 11
3. Slide the centre hole of the cover plate Asm. (Item 5) over the eye of the installation tool.
4. Using pan head screws (item 16) with crinkle washers (item 13) under heads, secure the assembly through the outer holes.
5. Remove installation tool and reset ends ready for use.
6. Relocate rearward pan head screw to centre hole and tighten (Fig. 13).
7. Repeat on the other side.

### INSTALLATION of CARGO BARRIER and TOP STRAPS

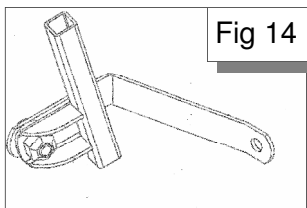
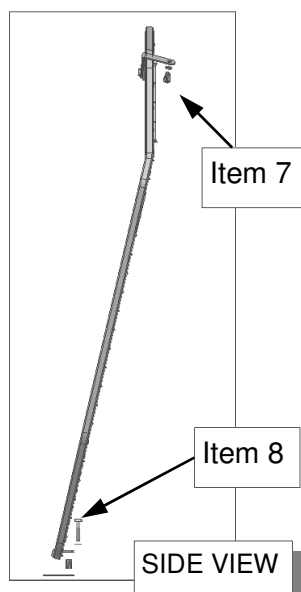

Fig 14



#### TOP STRAP ASSEMBLY

1. Attach top straps to the brackets on the top of the Cargo Barrier with M10 Hex Head Screws (Item 7) and Nyloc Nuts (Item 9) with rubber washer (Item 10) between strap and barrier.
2. See Item list (Page 2) for correct strap to correct side. Leave loose.
3. See Fig 10/14 for Detail.
1. Stand Cargo Barrier up directly behind front seats.
2. Attach the top straps the top mounts using M10 x 20mm Hex Head Screws (Item 7) with crinkle washer (Item 13) under head.
3. Attach the bottom brackets of the Cargo Barrier to rear holes of floor mounts using M10 x 50 Hex Head Bolts (Item 8) with Crinkle Washer (item 13) under head.
4. Tighten all screws and bolts!

**NOTE:** CHECK THAT ALL BOLTS, NUTS AND SCREWS ARE TIGHT AND RE-CHECK PERIODICALLY.