



## **HONDA CRV CARGO BARRIER INSTALLATION INSTRUCTION Part # 502200**

VEHICLE YEARS OF MANUFACTURE - FROM Nov. 2012 to April 2017.



This cargo barrier is capable of being located in one position only, behind the 2nd row of seats with the seats in an upright position. The installation kit contains sufficient components for fitment to this location. A high degree of technical competence is necessary to correctly install this product.

We recommend this cargo barrier be installed by an authorised outlet to ensure the barrier installation complies with AS/NZS 4034 Standard.

The cargo barrier is designed, manufactured and fitted to decrease the impact hazard in an accident to occupants from cargo carried within the interior cargo space of the vehicle. In the event of an accident, a cargo barrier can reduce injuries caused by cargo intruding into occupant's space.

**Installation time approximately 1.0 Hour**

"The estimated fitting time is based on an experienced fitter conversant with the fitment procedure"



### **WARNINGS**

- **Strict compliance with fitting instructions is essential for this safety product to meet its rated capacity. Refer user instructions regarding correct usage of the cargo barrier.**
- **Do not modify cargo barrier in any way.**
- **Do not use this cargo barrier in any other vehicle for which it is not designed.**
- **Modifications to the cargo barrier or its fixings or use in any other vehicle for which it is not designed may void the load rating and warranty.**
- **Do not attach the cargo barrier to the vehicle using seat, seat belt or child restraint anchorage's.**
- **Where high tensile threaded fasteners are used, the cargo barrier must be installed using the size and grade fasteners specified by Milford Industries.**
- **Do not drill, rivet, adhere or attach objects to the front or rear of the cargo barrier.**
- **Do not place smaller items, that may bypass the cargo barrier in the event of heavy braking or collision, near the edges of the barrier.**
- **Position the load against the cargo barrier.**
- **When load is positioned against cargo barrier, secure the load with a restraint system.**
- **During a collision moving cargo may damage seat belts or tether straps of a child restraint device, or its anchorage. Load should be carefully positioned so as not to come in contact with these items.**
- **Do not obstruct seat belts or child restraints, or their operation.**
- **Long thin items of cargo should be positioned in the vehicle with the long axis across the vehicle to minimise the penetration risk.**
- **If involved in an accident or accidentally damaged, the cargo barrier should be replaced and the anchorage's repaired to as new condition.**
- **Clean with soap and water only. Do not use solvents or chemicals. Discard cargo barrier if it becomes rusted. Do not expose to direct sunlight for long periods.**
- **It is extremely dangerous to ride in the cargo area of the vehicle behind the cargo barrier. It is recommended that the cargo barrier be removed. In a collision people or children riding unrestrained in these areas are more likely to be seriously injured or killed.**
- **Never leave a child in the vehicle unattended, particularly in the rear cargo area. The cargo area should never be used as a play area for children.**
- **The cargo barrier may deform and significantly intrude into occupant's space in an accident.**
- **Remember that the tailgate cannot be opened from inside the cargo area.**
- **The fixed labeling should not be removed from the cargo barrier.**
- **Failure to comply with warning notes may prevent the barrier protecting the occupants.**
- **Parents should explain to children how and when to use *EMERGENCY ESCAPE HAMMER* attached to cargo barrier.**
- **Do not remove the rating plaque from the cargo barrier.**

### **NOTICE TO INSTALLERS & DISTRIBUTORS**

***Please ensure User Instructions are left with vehicle owner after installation.***

# HONDA CRV

## CARGO BARRIER INSTALLATION INSTRUCTION

### Part # 502200

VEHICLE YEARS OF MANUFACTURE - FROM Nov. 2012 to April 2017.



**IMPORTANT:** The installation kit contains sufficient components to fit the cargo barrier. A high degree of technical competence is necessary to correctly install this product. We recommend this cargo barrier be installed by an authorised outlet to ensure the barrier installation is correct. These instructions must be read and clearly understood before commencing installation. Check contents of kit before commencing fitment and report any discrepancies or damage.

## Parts List

Item	Component Name	Part No.	Qty
1	Cargo Barrier ASM (see page 10)	502200	1
2	Mounting Plate ZP	754000	2
3	Cover Plate ASM	754875	2
4	Tube Spacer - Ø16mm x 14mm	754772	4
5	Cover Plate Garnish (plastic)	754960	2
6	Screw - CSK, 5/16" BSW x 11/4" ZP	912901	4
7	Screw - Socket Hd. M6 x 1.0 x 25mm	711419	2
8	Washer - Flat, 6mm	932080	2
9	Milbolt - M10 x 39mm	912840	2
10	Milbolt - M10 x 59mm	913115	2
11	Wave Washer - 10mm ZP	932125	4
12	Warning Label (Orange)	905017	1
13	Rust Preventative Sealer (Sachet)	906300	1
14	Installation Tool	754200	1
15	Bracket ASM - Bottom	753466	1
16	Marking Template (Upper mounts) (Card)	502209	1

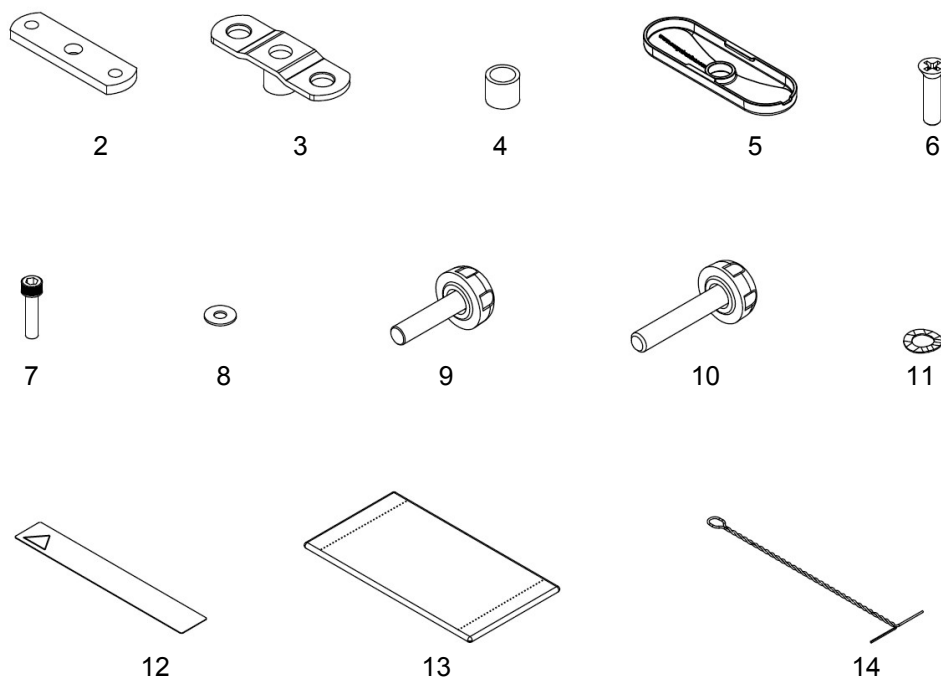
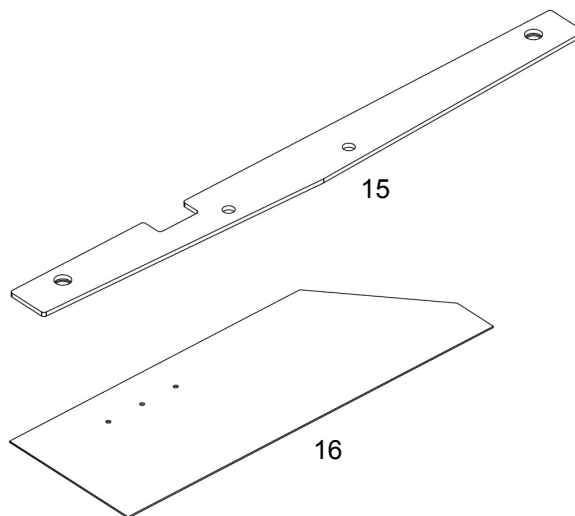

**E and OE—Errors and Omissions Excepted**

## **HONDA CRV**

### **CARGO BARRIER INSTALLATION INSTRUCTION**

#### **Part # 502200**

VEHICLE YEARS OF MANUFACTURE - FROM Nov. 2012 to April 2017.



### **ADVICE TO FITTER**

**Note:** To fit the cargo barrier the following is essential: (where applicable)

- ☐ Always drill perpendicular to surface (Unless stated otherwise).
- ☐ A positive drill stop should always be used to prevent accidental damage to external panels, fuel lines etc.
- ☐ Ensure Safety Eye Protection and Gloves are worn as required when using cutting tools.
- ☐ When cutting metal panels be very careful of sharp edges, for risk of skin cuts etc.
- ☐ Care should be taken when applying Rust Preventative sealer to all holes drilled, to negate the possibility of skin and eye irritation.
- ☐ Check screws in relevant components by hand before installation. Should there be resistance re-tap threads and re-check.
- ☐ **Before marking or drilling to install this cargo barrier, check vehicle for LPG conversion & non standard fuel tanks. Locate tanks and all lines attached and take EXTREME CARE not to damage whilst installing this cargo barrier.**
- ☐ **Before drilling to install this cargo barrier, check for concealed wiring looms. E.g. tow bar, reversing camera, reversing sensor wiring etc.. Relocate before drilling to avoid damage.**

**CARE SHOULD BE TAKEN NOT TO CROSS THREAD THE FASTENERS DURING  
INSTALLATION OF COMPONENTS TO THE VEHICLE.**

### **TOOLS REQUIRED**

- |  |   |
|--|---|
| <input type="checkbox"/> Tape Measure              | <input type="checkbox"/> 16mm/22mm Hole Saw           |
| <input type="checkbox"/> Steel Rule                | <input type="checkbox"/> Hole De-Burring Tool         |
| <input type="checkbox"/> Socket wrench             | <input type="checkbox"/> Hex bits & driver            |
| <input type="checkbox"/> Metric hex sockets        | <input type="checkbox"/> Rust Preventative Applicator |
| <input type="checkbox"/> Screwdriver - Phillips #4 | <input type="checkbox"/> Vacuum Cleaner               |
| <input type="checkbox"/> Power Drill               | <input type="checkbox"/> Cover sheet / Drop sheet     |
| <input type="checkbox"/> Masking Tape              | <input type="checkbox"/> Sharp Knife                  |
| <input type="checkbox"/> Marker                    | <input type="checkbox"/> Torque Wrench (13Nm)         |
| <input type="checkbox"/> 5mm, 9mm, Drill Bits      | <input type="checkbox"/> Clean Rag                    |
| <input type="checkbox"/> Drill stop's              |   |



## PREPARATION FOR FLOOR MOUNTS



1. Identify the area which you will be working in. Forward end of cargo area floor.
2. Remove the cargo blind if installed.



3. Remove the cargo area floor covering from the vehicle.

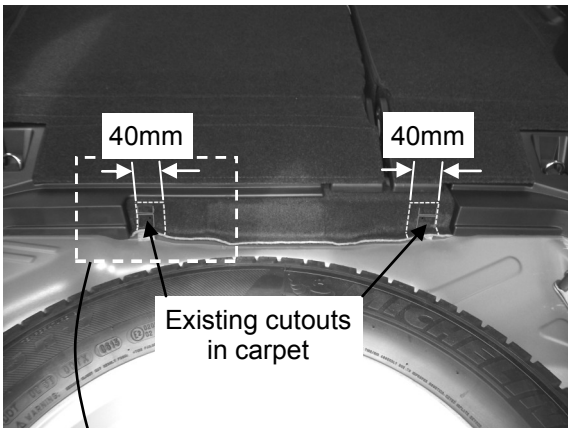

4. Just forward of the spare wheel locate the square cuts at the sides of the centre carpet flap.
5. Mark the carpet out as shown.

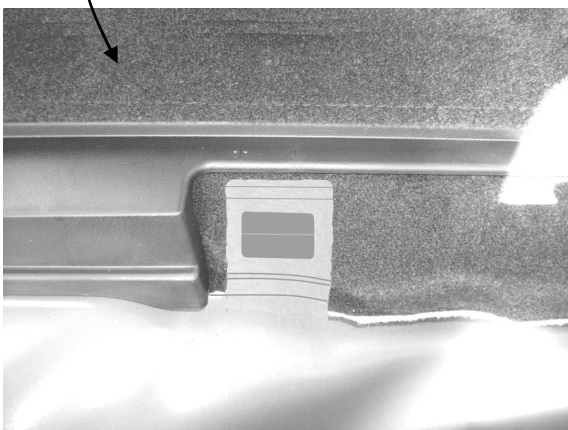

6. Using a sharp knife cut away the carpet as marked out above to fully expose the rectangular cut outs in the metal panel behind.



## SECURING BOTTOM BRACKET/TRIMMING FLOOR PANEL

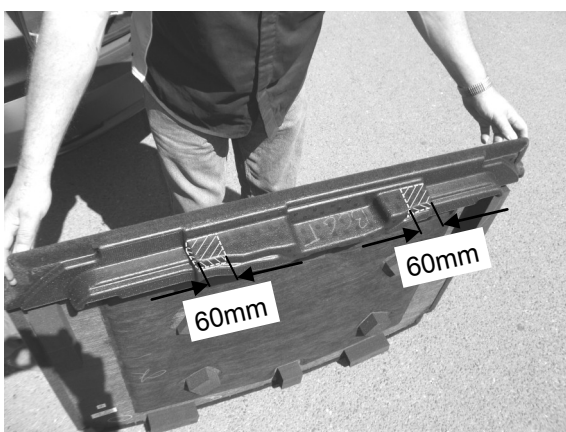
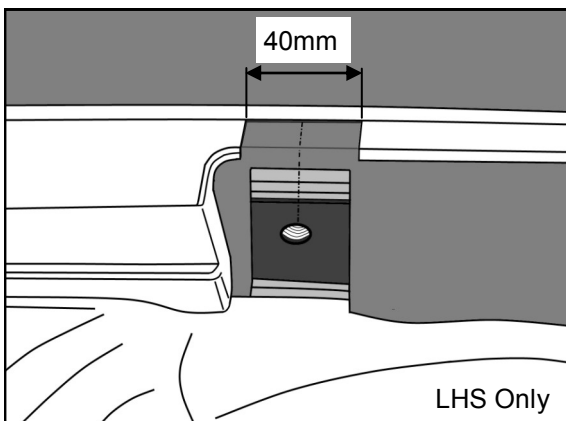
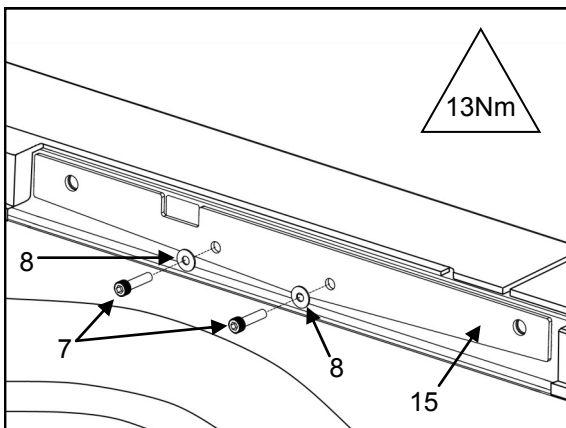
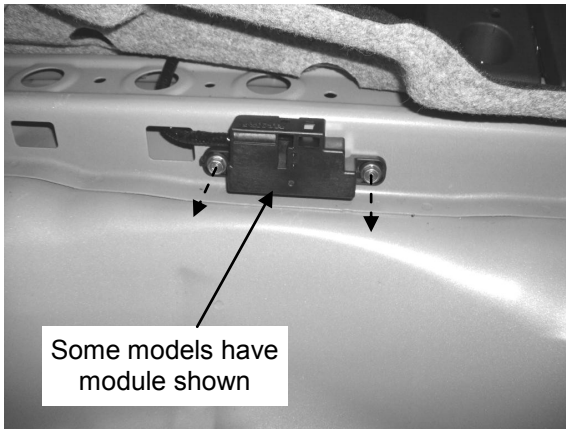

7. Lift up the carpet flap and locate the 2 M6 captive nuts in the metal cross member.

Note: A stability control module may be attached to the captive nuts in some models. If so undo the M6 securing screws and discard.

8. Position the bottom bracket (15) over the M6 captive nuts as shown with the bracket nuts sitting inside the rectangular holes of the cross member.
9. If applicable relocate the stability control module back in position on top of the bottom bracket, then secure the bracket in place using socket head screws (7) with flat washers (8) under heads.
10. Tighten and torque up screws to 13Nm.

11. Push the carpet flap back over the top of the bottom bracket.
12. Mark out the hard plastic trim panel adjacent to the LHS mounting point as shown.
13. Using a sharp knife carefully notch out the hard plastic trim.

14. On the forward edge of the floor panel mark out the styrene as shown.
15. Using a sharp knife cut away the marked out sections of the styrene foam down as far as the next layer. (about 20mm)

Note: Leave the floor panel out of the vehicle at this stage.

# HONDA CRV CARGO BARRIER INSTALLATION INSTRUCTION Part # 502200

VEHICLE YEARS OF MANUFACTURE - FROM Nov. 2012 to April 2017.



## MARKING PROCEDURE FOR UPPER MOUNTS

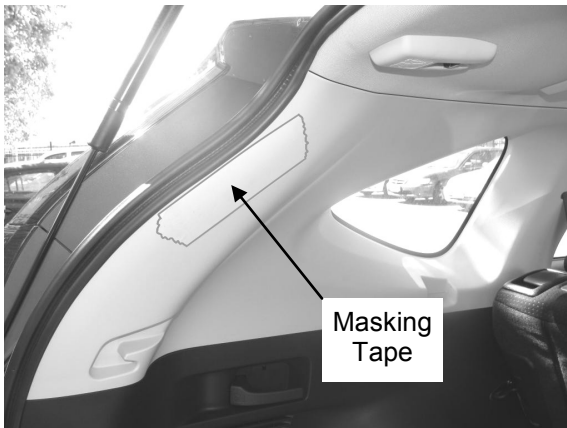

16. Place a cover sheet over the cargo area floor to protect trim etc.
17. Affix masking tape to the rear upper 1/4 trims in approximate location shown. Both sides.



18. Carefully position the upper mounts marking template (16) on the LHS upper 1/4 trim as shown and indicated on the template. Tape in position if required.

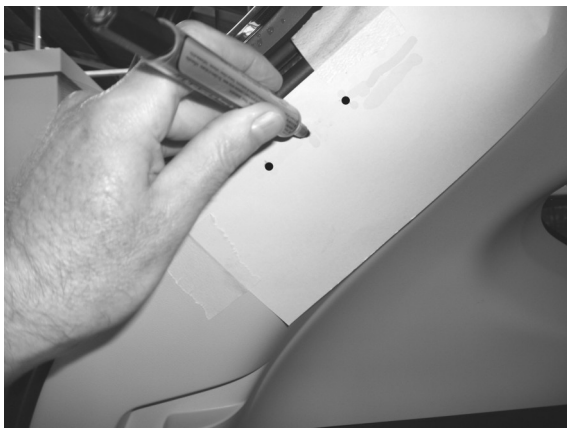

19. With the template in the correct position mark the mounting hole locations onto the masking tape behind.
20. Remove the template then repeat steps 18 & 19 on the RHS with the template reversed.

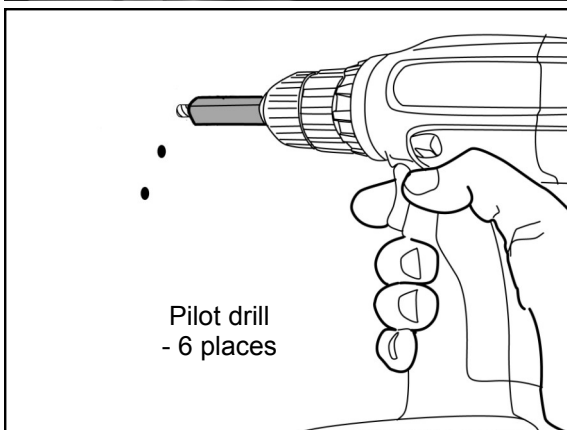

21. Using a 5mm drill bit with drill stop set at 20mm, carefully pilot drill the 6 marked locations through the hard plastic trim and the metal panel behind.  
Note: Take care to ensure the drill is kept perpendicular to the trim face when drilling the metal panel behind.

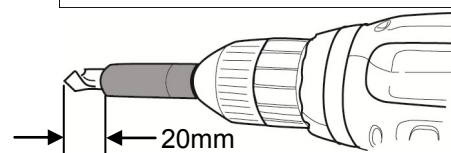



## DRILLING PROCEDURE FOR UPPER MOUNTS

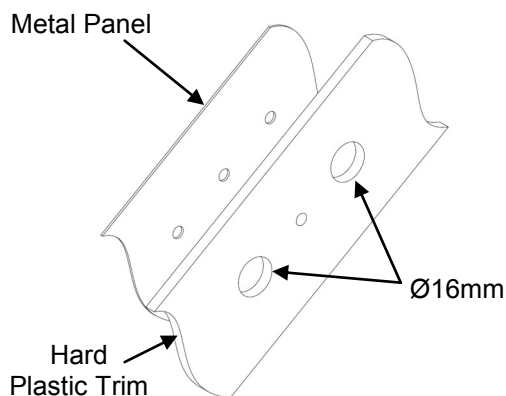

22. Using a 16mm hole saw with drill stop set at 5mm enlarge the outer pilot holes only through just the hard plastic trims.

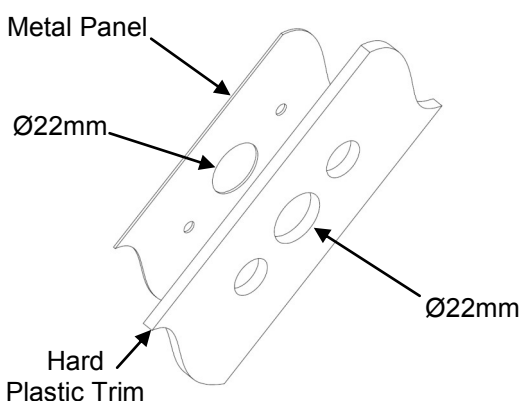
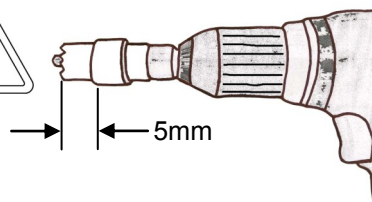

23. Using a 22mm hole saw with drill stop set at 20mm enlarge the centre pilot holes through both the hard plastic trim and the metal panel behind.

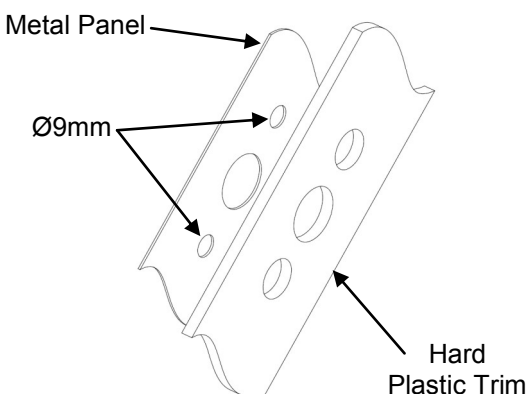
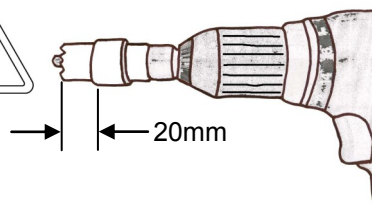

24. Using a 9mm drill bit with drill stop set at 5mm enlarge the outer holes only through the metal panels.

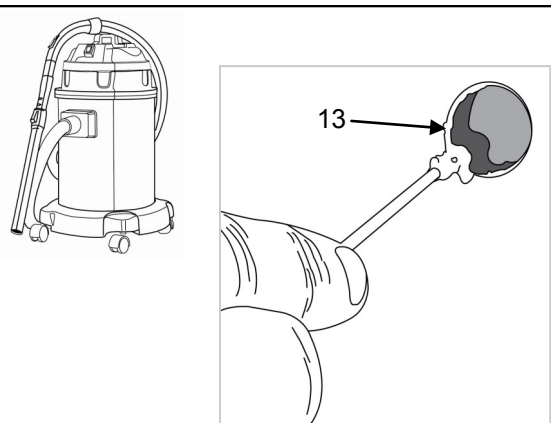
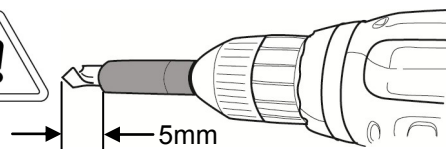

25. Deburr the drilled holes if necessary.  
26. Vacuum away all drilling swarf.  
27. Apply rust preventative sealer (13) to the raw edges of the drilled holes in metal panels.





## INSTALLATION PROCEDURE FOR UPPER MOUNTS

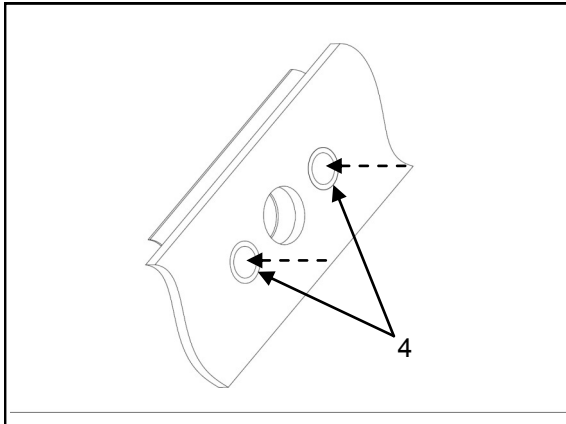

28. Push a tube spacer (4) into each of the outer holes in the 1/4 trims until flush with the trim surface.

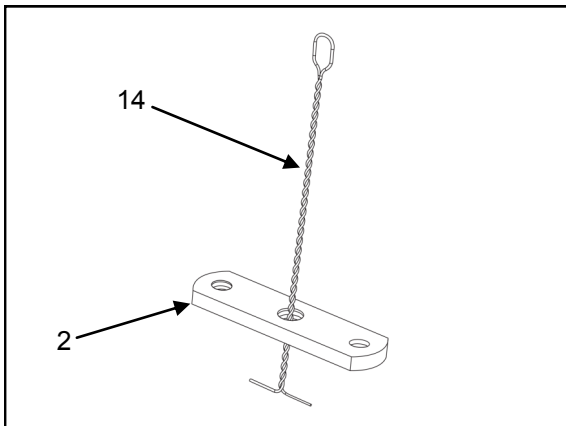

29. Place a mounting plate (2) over installation tool (14) as shown.

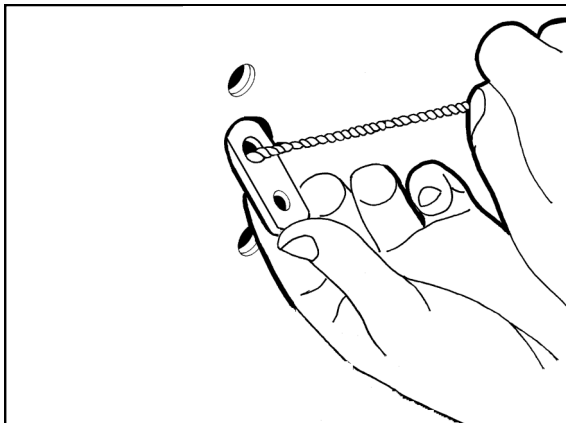

30. Whilst keeping hold of the installation tool push the mounting plate through the 22mm centre hole in the trim & metal panel.  
31. Manoeuvre the mounting plate into position behind the metal panel with the outer holes aligned.

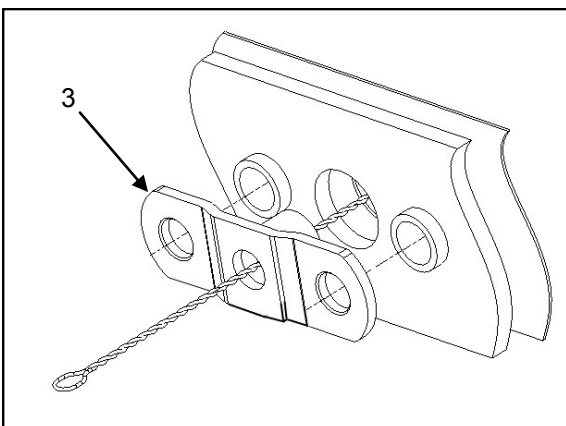

32. Whilst keeping hold of the installation tool feed a cover plate ASM (3) centre hole over the installation tool as shown.





## INSTALLATION PROCEDURE FOR UPPER MOUNTS - Cont'd

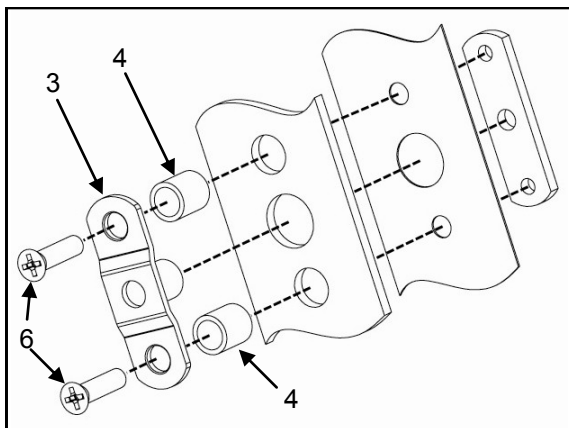

33. With all holes aligned secure the assembly in place using CSK screws (6) through the outer holes.
34. Remove the installation tool by pulling inwards then tighten the screws.  
Hint: Thread a Milbolt (9) into the centre hole before tightening outer screws to ensure correct alignment.
35. Repeat steps 28 to 34 on the other side with the ends of the installation tool reset.

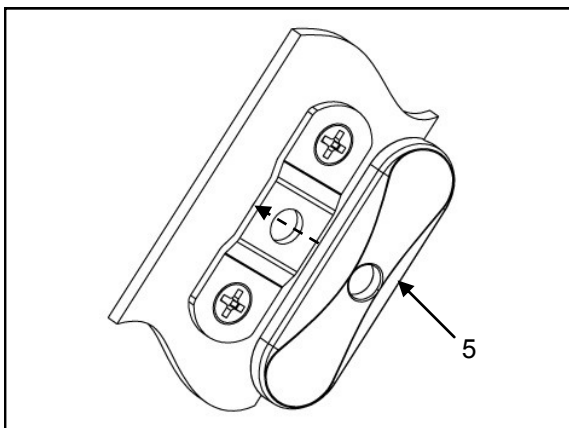

36. Clip a cover plate garnish (5) onto each of the upper mounts.

## AFFIXING OF WARNING LABEL



37. Clean the area inside the drivers door opening as shown using clean rag.
38. Affix orange warning label (12) at that location as shown.

**Please ensure User Instructions are left with vehicle owner after installation.**

## **HONDA CRV CARGO BARRIER INSTALLATION INSTRUCTION**

**Part # 502200**

VEHICLE YEARS OF MANUFACTURE - FROM Nov. 2012 to April 2017.



### **INSTALLATION OF CARGO BARRIER 'Behind 2nd row of seats'**

1. Remove the cargo blind if installed.
2. Remove the cargo area floor panel from the vehicle if in place.
3. Ensure the cargo barrier straps are pivoted towards the meshed side of the cargo barrier.
4. With the 2nd row of seats folded down manoeuvre the cargo barrier through the tailgate opening and into position in the behind 2nd row seats location.
5. Attach the top straps to the upper mounts using 39mm Milbolts (9) with wave washers (11) under heads.
6. Attach the bottom straps to the bottom mounts using 59mm Milbolts (10) with wave washers (11) under heads. *(Note: The bottom Milbolts may seem excessively long. This is intentional and is necessary.)*
7. Tighten all Milbolts.
8. Reposition the 2nd row seat backs.
9. Reinstall the cargo area floor panel into the vehicle.
10. Reinstall the cargo blind if required.

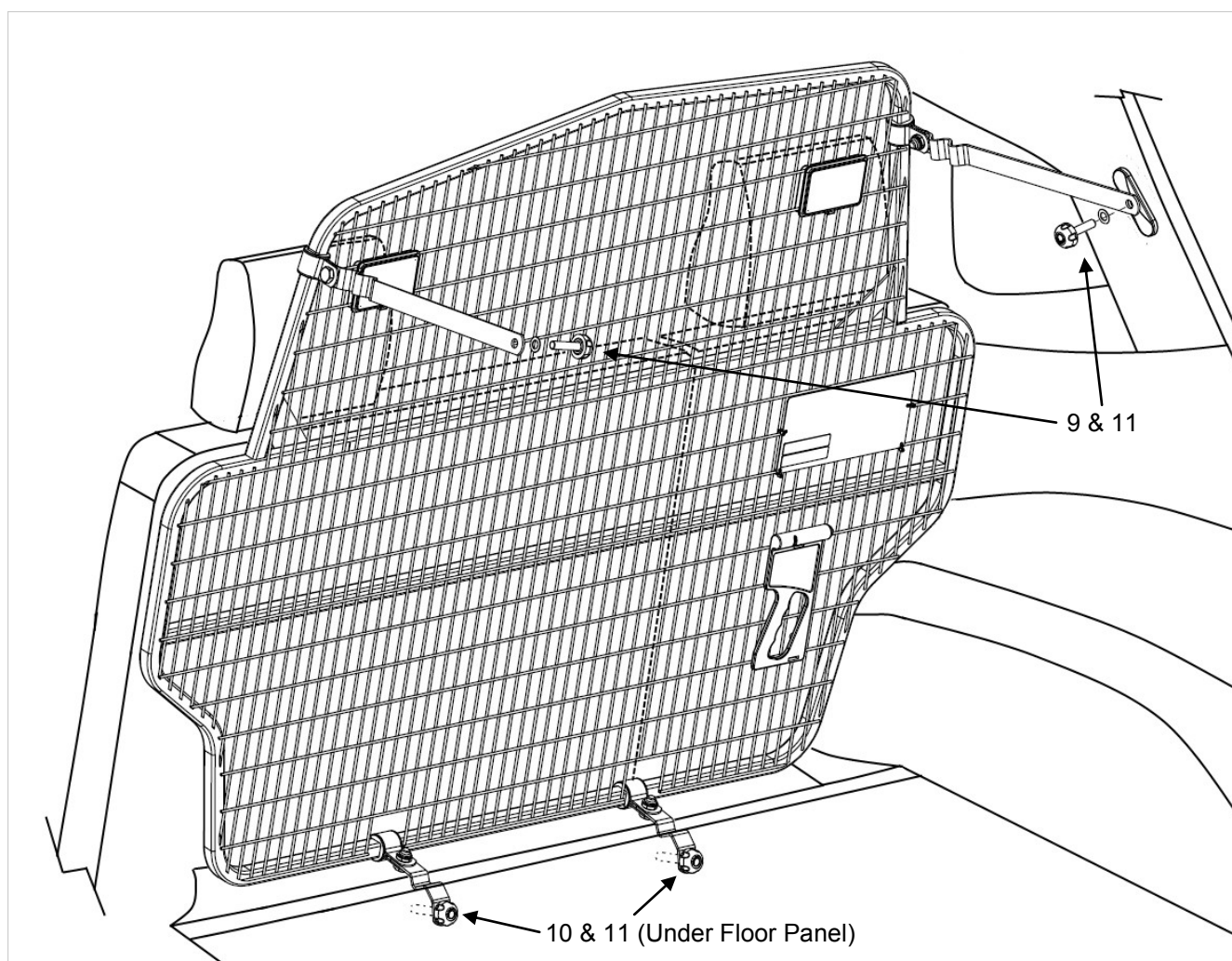

**IMPORTANT NOTE: Check that all bolts and screws are tight and re check periodically.**