



HYUNDAI i-LOAD CARGO BARRIER FITTING INSTRUCTION

PART #709575

YEARS OF MANUFACTURE – MARCH 2008 ONWARDS

BEHIND FIRST ROW SEATS



This Cargo Barrier is capable of being located in **one position only**, behind the 1st row of seats.

The cargo barrier is designed, manufactured and fitted to decrease the impact hazard in an accident to occupants from cargo carried within the interior cargo space of the vehicle. In the event of an accident, a cargo barrier can reduce injuries caused by cargo intruding into occupant's space.

The installation kit contains sufficient components to fit the cargo barrier. A high degree of technical competence is necessary to correctly install this product. We recommend this Cargo Barrier be installed by an Authorised outlet to ensure the barrier installation complies with AS/NZS 4034 Standard.



WARNING

- Strict compliance with fitting instructions is essential for this safety product to perform as designed. Refer user instructions regarding correct usage of the Cargo Barrier.
- Seat, seat belt or child restraint anchorage's must not be used for mounting the Cargo Barrier.
- Where high tensile threaded fasteners are used, the cargo barrier must be installed using the size and grade fasteners specified by Milford Industries.
- Do not drill, rivet, adhere or attach objects to the front or rear of the Cargo Barrier.
- When load is positioned against cargo barrier, secure the load with a restraint system.
- During a collision moving cargo may damage seat belts or tether straps of a child restraint device, or its anchorage. Load should be carefully positioned so as not to come in contact with these items.
- Do not obstruct seat belts or child restraints, or their operation.
- Long thin items of cargo should be positioned in the vehicle with the long axis across the vehicle to minimize the penetration risk.
- If involved in an accident or accidentally damaged, the cargo barrier should be replaced and the anchorage's repaired to as new condition.
- Clean with soap and water only. Do not use solvents or chemicals. Discard Cargo Barrier if it becomes rusted.
- Do not store cargo barrier outside in direct sunlight.
- It is extremely dangerous to ride in the cargo area of the vehicle behind the cargo barrier. It is recommended that the cargo barrier be removed. In a collision people or children riding unrestrained in these areas are more likely to be seriously injured or killed.
- Never leave a child in the vehicle unattended, particularly in the rear cargo area. The cargo area should never be used as a play area for children.
- The Cargo Barrier may deform and significantly intrude into occupant's space in an accident.
- The plaque shall not be removed from the cargo barrier.
- Failure to comply with warning notes may prevent the barrier protecting the occupants.

NOTICE TO FITTERS AND DISTRIBUTORS

Please ensure this notice and the fitting instructions are left in the glove box after installation of Cargo Barrier

TOOLS REQUIRED

- ☐ 5mm Hex Key
- ☐ 16, 17mm Spanners
- ☐ Adjustable Spanner

FITTERS ADVICE

Note: To fit the Cargo Barrier the following is essential

- ☐ Check screws in relevant components by hand before installation. Should there be resistance re-tap threads and re-check.

CARE SHOULD BE TAKEN NOT TO CROSS THREAD THE FASTNERS DURING INSTALLATION OF COMPONENTS TO THE VEHICLE.

Item	Component Name	Part No.	Qty.
1	SCREW SOCKET HD M6 X 12MM ZINC PLATED	711420	6
2	FLAT WASHER M6 ZINC PLATED	932080	6
3	i-LOAD SINGLE POSITION CARGO BARRIER	709575	1

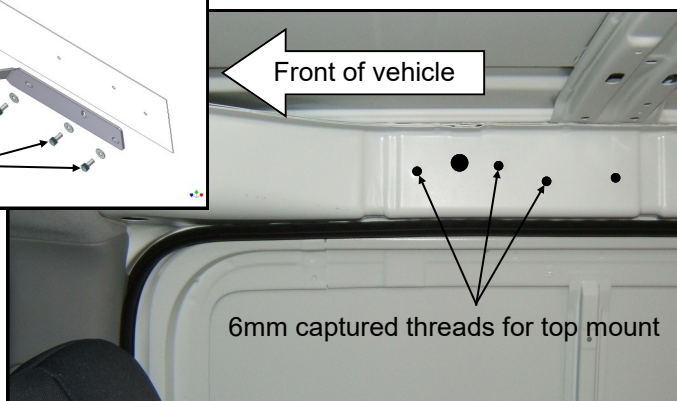
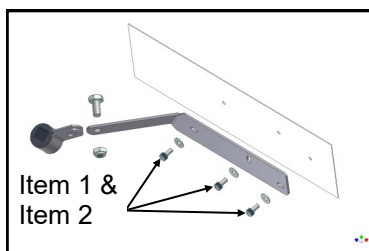

TOP MOUNTS

- Place barrier in vehicle and secure using M6 socket head screws (Item 1) and 6mm washers (item 2) placed between screws and strap at locations as shown in picture.

NOTE:

Leave screws loose until bottom mounts are tight. Then tighten top mount screws.

Drivers side top mount shown. Passengers side the same.

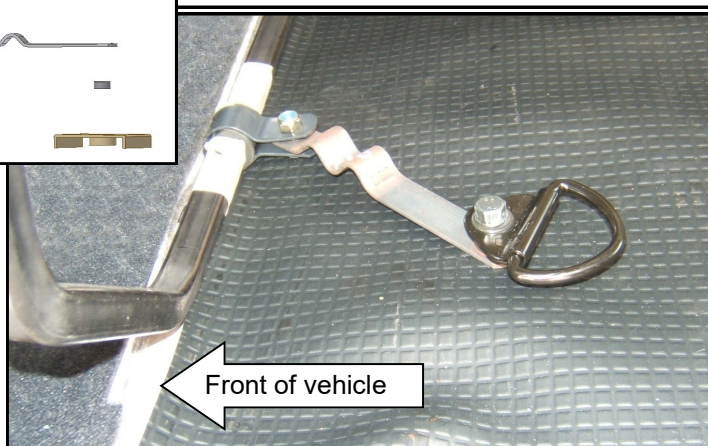
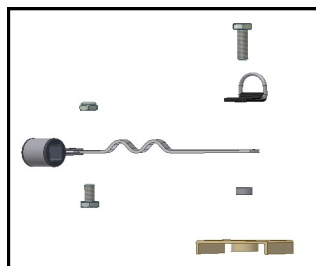

Passengers side bottom mount shown. Drivers side the same.

BOTTOM MOUNTS

- Undo Bolts for forward most tie downs behind front row of seats and remove the spacer.
- Attach the bottom straps and replace spacer. Locate assy back to floor mount thread and tighten.