



MAZDA 6
CARGO BARRIER FRONT POSITION KIT
INSTALLATION INSTRUCTION
Part # 704677
For use with cargo barrier 704675 only



WARNINGS

- Strict compliance with fitting instructions is essential for this safety product to meet its rated capacity. Refer user instructions regarding correct usage of the cargo barrier.
- Do not modify cargo barrier in any way.
- Do not use this cargo barrier in any other vehicle for which it is not designed.
- Modifications to the cargo barrier or its fixings or use in any other vehicle for which it is not designed may void the load rating and warranty.
- Do not attach the cargo barrier to the vehicle using seat, seat belt or child restraint anchorage's.
- Where high tensile threaded fasteners are used, the cargo barrier must be installed using the size and grade fasteners specified by Milford Industries.
- Do not drill, rivet, adhere or attach objects to the front or rear of the cargo barrier.
- Do not place smaller items, that may bypass the cargo barrier in the event of heavy braking or collision, near the edges of the barrier.
- Position the load against the cargo barrier.
- When load is positioned against cargo barrier, secure the load with a restraint system.
- During a collision moving cargo may damage seat belts or tether straps of a child restraint device, or its anchorage. Load should be carefully positioned so as not to come in contact with these items.
- Do not obstruct seat belts or child restraints, or their operation.
- Long thin items of cargo should be positioned in the vehicle with the long axis across the vehicle to minimise the penetration risk.
- If involved in an accident or accidentally damaged, the cargo barrier should be replaced and the anchorage's repaired to as new condition.
- Clean with soap and water only. Do not use solvents or chemicals. Discard cargo barrier if it becomes rusted. Do not expose to direct sunlight for long periods.
- It is extremely dangerous to ride in the cargo area of the vehicle behind the cargo barrier. It is recommended that the cargo barrier be removed. In a collision people or children riding unrestrained in these areas are more likely to be seriously injured or killed.
- Never leave a child in the vehicle unattended, particularly in the rear cargo area. The cargo area should never be used as a play area for children.
- The cargo barrier may deform and significantly intrude into occupant's space in an accident.
- Remember that the tailgate cannot be opened from inside the cargo area.
- The fixed labeling should not be removed from the cargo barrier.
- Failure to comply with warning notes may prevent the barrier protecting the occupants.
- Parents should explain to children how and when to use **EMERGENCY ESCAPE HAMMER** attached to cargo barrier.
- Do not remove the rating plaque from the cargo barrier.

NOTICE TO INSTALLERS & DISTRIBUTORS

Please ensure User Instructions are left with vehicle owner after installation.

MAZDA 6

CARGO BARRIER FRONT POSITION KIT

INSTALLATION INSTRUCTION

Part # 704677

For use with cargo barrier 704675 only



IMPORTANT: The installation kit contains sufficient components to fit the cargo barrier. A high degree of technical competence is necessary to correctly install this product. We recommend this cargo barrier be installed by an authorised outlet to ensure the barrier installation is correct. These instructions must be read and clearly understood before commencing installation. Check contents of kit before commencing fitment and report any discrepancies or damage.

Parts List

Item	Component Name	Part No.	Qty
1	Bush—Pivot Saddle	752680	2
2	Pivot Saddle	752700	2
3	Screw Hex. Hd.—M10 x 1.5 x 20 ZP	912205	2
4	Nut—Nyloc M10 x 1.5 ZP	922090	2
5	Milbolt—M10 x 1.5 x 24mm	912825	2
6	Milbolt—M10 x 1.5 x 14mm	912816	6
7	Velcro Ties (Not shown)	904003	4
8	Support Leg	904722	2
9	Tube Strap ASM—Top LHS	776540	1
10	Tube Strap ASM—Top RHS	776542	1
11	Bracket ASM (Lateral support)	756257	2
12	Strap—Bottom LHS	776535	1
13	Strap—Bottom RHS	776536	1

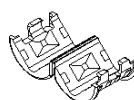

1

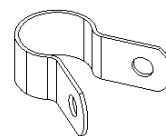

2



3



4



5



6

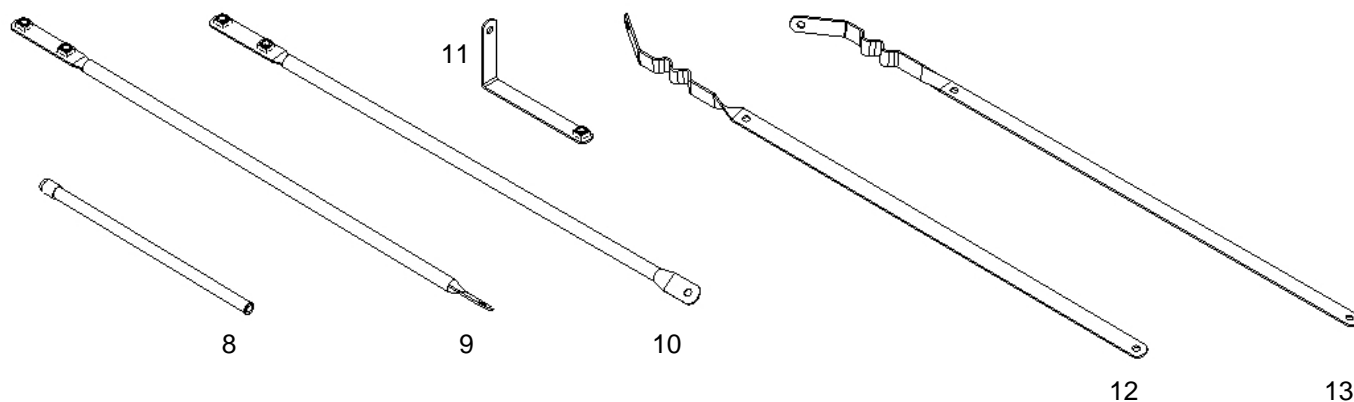

Note: Items 8 to 13 shown at reduced scale to rest of kit



MAZDA 6 CARGO BARRIER FRONT POSITION KIT INSTALLATION INSTRUCTION

Part # 704677

For use with cargo barrier 704675 only



TOOLS REQUIRED

Socket wrench
Metric hex socket (17mm A/F)
16mm A/F ring spanner

ATTACH FRONT POSITION BOTTOM STRAPS TO BARRIER

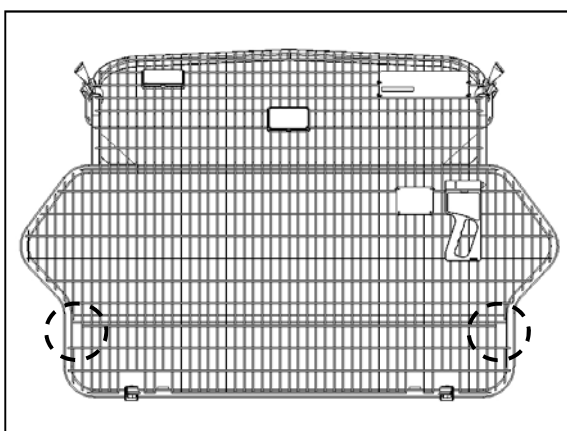

1. Locate the mesh cut outs at the bottom sides of the cargo barrier. (just under lower cross member)

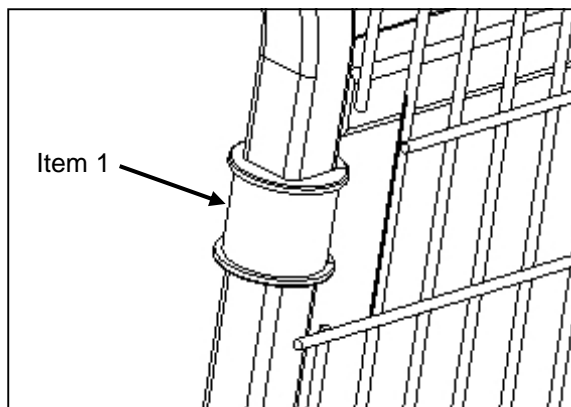

2. Place plastic pivot saddle bush (Item 1) over frame at mesh cut outs as shown.

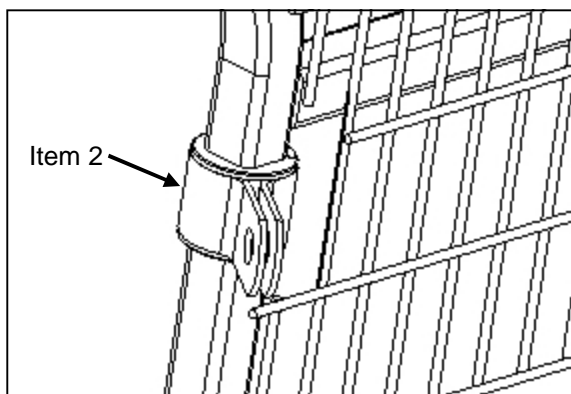

3. Place pivot saddle (Item 2) over pivot bush, then close shut by pushing the open ends together.

MAZDA 6 CARGO BARRIER FRONT POSITION KIT INSTALLATION INSTRUCTION

Part # 704677

For use with cargo barrier 704675 only



ATTACH FRONT POSITION BOTTOM STRAPS TO BARRIER—Cont'd

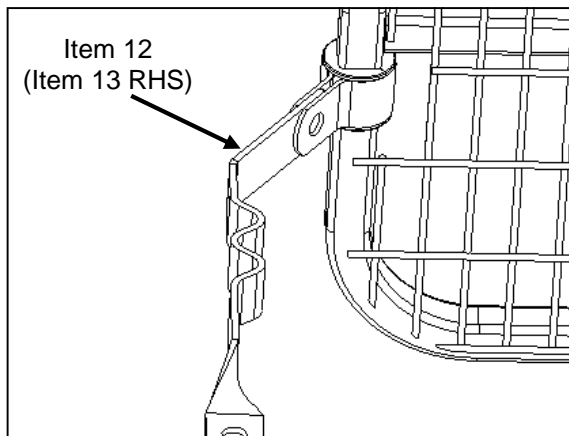

4. On LHS of cargo barrier place LH bottom strap (Item 12) between pivot saddle as shown.

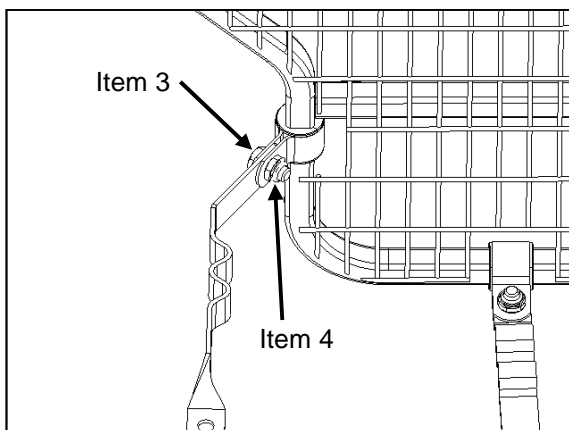

5. Secure strap to saddle as shown using Hex head screw (Item 3) and nyloc nut (Item 4). Tighten until strap is firm between pivot saddle but can still be rotated.
6. Repeat on other side.

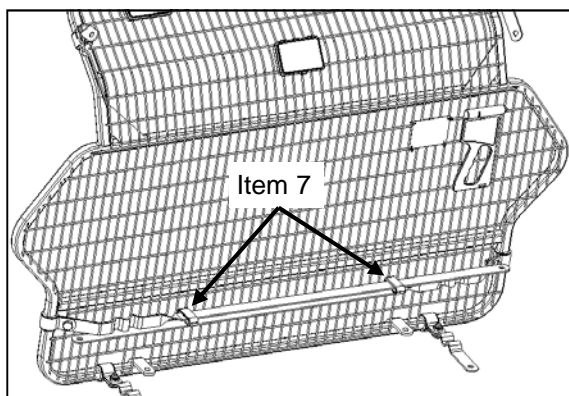

7. Pivot straps across each other on the meshed side of the cargo barrier then tie together using 2x Velcro ties (Item 7).



MAZDA 6 CARGO BARRIER FRONT POSITION KIT INSTALLATION INSTRUCTION

Part # 704677

For use with cargo barrier 704675 only



ATTACH SUPPORT LEGS TO CARGO BARRIER

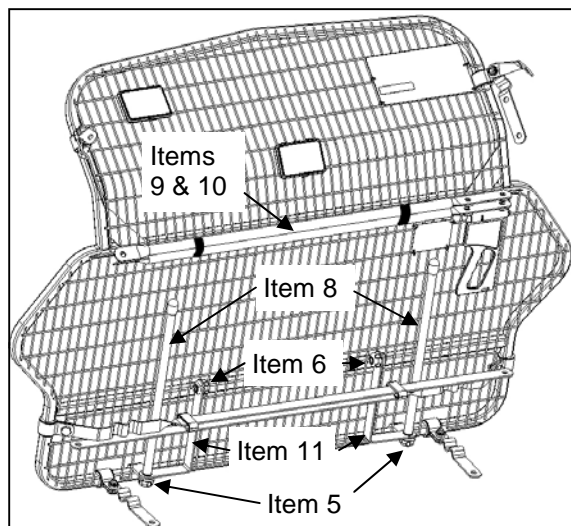

8. Attach support legs (Item 8) & bracket assemblies (Item 11) to cargo barrier bottom brackets as shown using 24mm Milbolts (Item 5).
9. Screw 14mm Milbolts (Item 6) into bracket assemblies for safe keeping.

8. Secure tube straps (Items 9 & 10) to barrier mesh using Velcro ties (Item 7).



INSTALLATION OF CARGO BARRIER 'Behind 1st row of seats'

1. Remove head restraints from 2nd row of seats and store in a safe place.
2. Lay 2nd row seats flat as shown in owners handbook.
3. If moving from rear position undo all Milbolts.
4. Lay cargo barrier on its meshed side on top of folded 2nd row seat.
5. Attach support legs to leg brackets as shown.
6. With the front seats moved forward, manoeuvre cargo barrier into position with the meshed side of the barrier to the rear of the vehicle and support legs resting on floor.
7. Attach tube extension straps to long top straps as shown using 14mm Milbolts.
8. Attach other end of tube straps to roof brackets using 19mm Milbolts with wave washers under heads.
9. Place tube spacers into floor mount access holes in floor covering. (should already be in place if moving from rear position)
10. Release long bottom straps from cargo barrier and attach to floor mounts using 39mm Milbolts with wave washers under heads.
11. Attach lateral support brackets to bottom straps as shown using 14mm Milbolts.
12. Tighten all Milbolts.

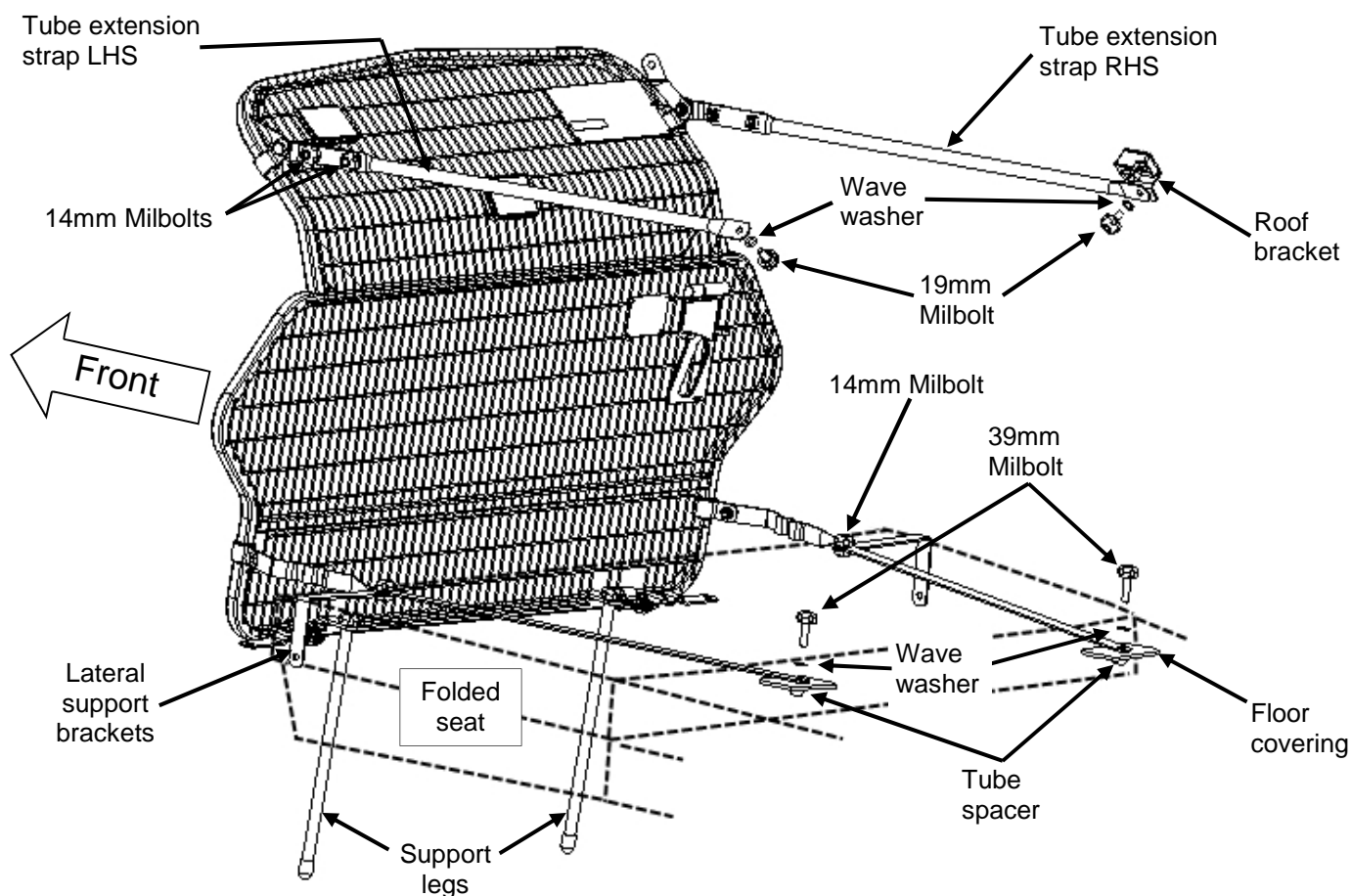

IMPORTANT NOTE: Check that all bolts and screws are tight and re check periodically.