



# TOYOTA PRIUS V CARGO BARRIER INSTALLATION INSTRUCTION Part # 609825

VEHICLE YEARS OF MANUFACTURE - From May 2012



This Cargo Barrier is capable of being located in one position only, behind the 2nd row of seats in their normal upright position, with the 3rd row seats in their stored position. The cargo barrier must be removed if the 3rd row seats are to be used. The installation kit contains sufficient components for fitment. A high degree of technical competence is necessary to correctly install this product.

We recommend this cargo barrier be installed by an authorised outlet to ensure the barrier installation complies with AS/NZS 4034 Standard.

The cargo barrier is designed, manufactured and fitted to decrease the impact hazard in an accident to occupants from cargo carried within the interior cargo space of the vehicle. In the event of an accident, a cargo barrier can reduce injuries caused by cargo intruding into occupant's space.

**Installation time approximately 0.75 Hours**

"The estimated fitting time is based on an experienced fitter conversant with the fitment procedure"



## WARNINGS

- Strict compliance with fitting instructions is essential for this safety product to meet its rated capacity. Refer user instructions regarding correct usage of the cargo barrier.
- Do not modify cargo barrier in any way.
- Do not use this cargo barrier in any other vehicle for which it is not designed.
- Modifications to the cargo barrier or its fixings or use in any other vehicle for which it is not designed may void the load rating and warranty.
- Do not attach the cargo barrier to the vehicle using seat, seat belt or child restraint anchorage's.
- Where high tensile threaded fasteners are used, the cargo barrier must be installed using the size and grade fasteners specified by Milford Industries.
- Do not drill, rivet, adhere or attach objects to the front or rear of the cargo barrier.
- Do not place smaller items, that may bypass the cargo barrier in the event of heavy braking or collision, near the edges of the barrier.
- Position the load against the cargo barrier.
- When load is positioned against cargo barrier, secure the load with a restraint system.
- During a collision moving cargo may damage seat belts or tether straps of a child restraint device, or its anchorage. Load should be carefully positioned so as not to come in contact with these items.
- Do not obstruct seat belts or child restraints, or their operation.
- Long thin items of cargo should be positioned in the vehicle with the long axis across the vehicle to minimise the penetration risk.
- If involved in an accident or accidentally damaged, the cargo barrier should be replaced and the anchorage's repaired to as new condition.
- Clean with soap and water only. Do not use solvents or chemicals. Discard cargo barrier if it becomes rusted. Do not expose to direct sunlight for long periods.
- It is extremely dangerous to ride in the cargo area of the vehicle behind the cargo barrier. It is recommended that the cargo barrier be removed. In a collision people or children riding unrestrained in these areas are more likely to be seriously injured or killed.
- Never leave a child in the vehicle unattended, particularly in the rear cargo area. The cargo area should never be used as a play area for children.
- The cargo barrier may deform and significantly intrude into occupant's space in an accident.
- Remember that the tailgate cannot be opened from inside the cargo area.
- The fixed labeling should not be removed from the cargo barrier.
- Failure to comply with warning notes may prevent the barrier protecting the occupants.
- Parents should explain to children how and when to use **EMERGENCY ESCAPE HAMMER** attached to cargo barrier.
- Do not remove the rating plaque from the cargo barrier.
- Do not use cargo barrier in vehicles intended for motorsport.

## NOTICE TO INSTALLERS & DISTRIBUTORS

**Please ensure User Instructions are left with vehicle owner after installation.**

# TOYOTA PRIUS V CARGO BARRIER INSTALLATION INSTRUCTION

Part # 609825

VEHICLE YEARS OF MANUFACTURE - From May 2012



**IMPORTANT:** The installation kit contains sufficient components to fit the cargo barrier. A high degree of technical competence is necessary to correctly install this product. We recommend this cargo barrier be installed by an authorised outlet to ensure the barrier installation is correct. These instructions must be read and clearly understood before commencing installation. Check contents of kit before commencing fitment and report any discrepancies or damage.

## Parts List

Item	Component Name	Part No.	Qty
1	Cargo Barrier ASM (see page 9)	609825	1
2	Strap - Bottom LHS	772018	1
3	Strap - Bottom RHS	772019	1
4	Top Strap	776975	2
5	Bracket ASM	752657	2
6	Felt Tape - Adhesive Backed	904685	4
7	Bracket - Roof	753887	1
8	Threaded Insert (M8 x 1.25)	922290	3
9	Plug - Plastic	904175	1
10	Screw - Socket Head M6 x 25mm	711419	2
11	Milbolt - M8 x 1.25 x 24mm	913205	2
12	Wave Washer - 10mm ZP	932125	4
13	Warning Label (orange)	905017	1
14	Milbolt - M10 x 1.5 x 19mm	912820	2
15	Rust Preventative Sealer (sachet)	906300	1

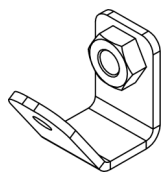
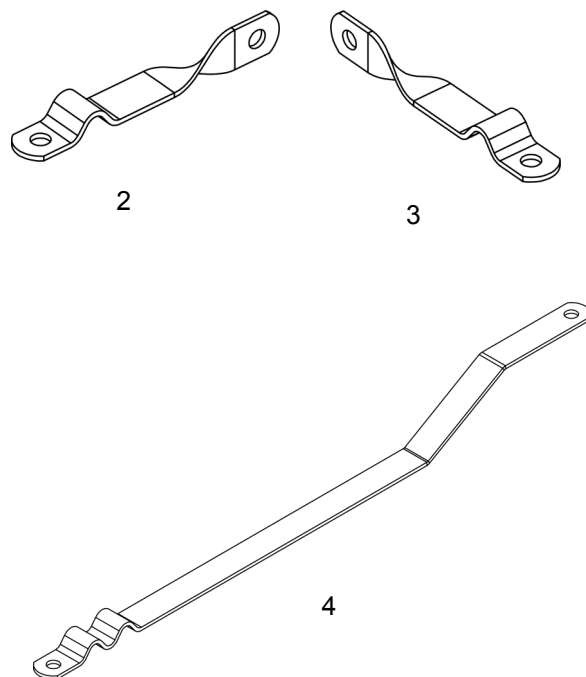

5



6

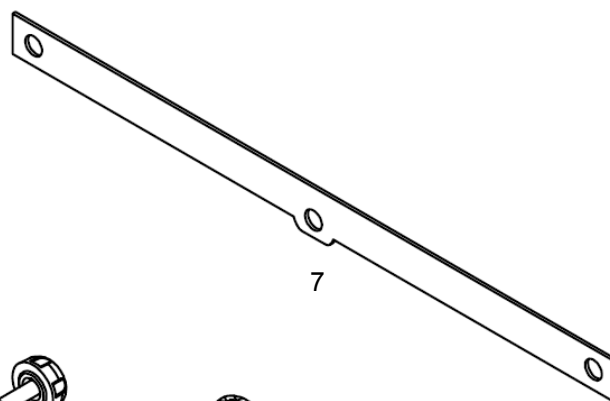

7



8



9



10



11



12

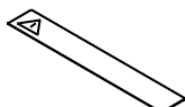

13



14

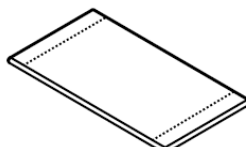

15

**E and OE—Errors and Omissions Excepted**



## ADVICE TO FITTER

**Note:** To fit the cargo barrier the following is essential: (where applicable)

- ☐ Always drill perpendicular to surface (Unless stated otherwise).
- ☐ A positive drill stop should always be used to prevent accidental damage to external panels, fuel lines etc.
- ☐ Ensure Safety Eye Protection and Gloves are worn as required when using cutting tools.
- ☐ When cutting metal panels be very careful of sharp edges, for risk of skin cuts etc.
- ☐ Care should be taken when applying Rust Preventative sealer to all holes drilled, to negate the possibility of skin and eye irritation.
- ☐ Check screws in relevant components by hand before installation. Should there be resistance re-tap threads and re-check.
- ☐ **Before marking or drilling to install this cargo barrier, check vehicle for LPG conversion & non standard fuel tanks. Locate tanks and all lines attached and take EXTREME CARE not to damage whilst installing this cargo barrier.**
- ☐ **Before drilling to install this cargo barrier, check for concealed wiring looms. E.g. tow bar, reversing camera, reversing sensor wiring etc.. Relocate before drilling to avoid damage.**

**CARE SHOULD BE TAKEN NOT TO CROSS THREAD THE FASTENERS DURING  
INSTALLATION OF COMPONENTS TO THE VEHICLE.**

## TOOLS REQUIRED

- |                        |                                |
|------------------------|--------------------------------|
| • Trim removal tools   | • Long Socket Extension        |
| • Threaded Insert Tool | • Universal Sock Drive         |
| • Power Drill          | • Torque Wrench (30Nm)         |
| • 20mm Vinyl Cutter    | • Rust Preventative Applicator |
| • Hole De-Burring Tool | • Vacuum Cleaner               |
| • 11.5mm Drill Bit     | • Cover sheet / Drop sheet     |
| • Drill stop's         | • Clean Rag                    |
| • Metric Socket Set    |                                |



## INSTALLATION PROCEDURE FOR UPPER MOUNTS

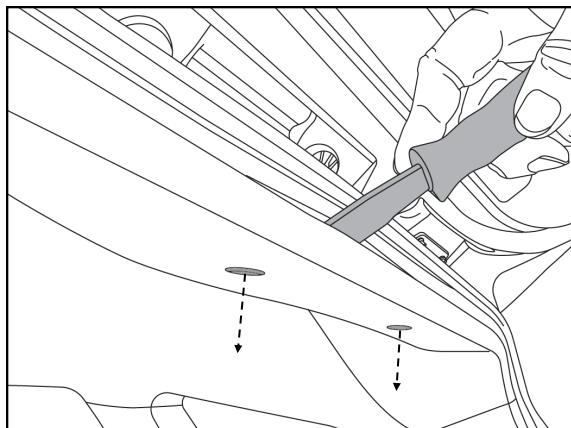

1. Place a cover sheet over the cargo area floor to protect the trim.
2. Remove the three trim plugs securing the roof lining near the tailgate opening. This is best done by using a trim plug removal tool above the roof lining.

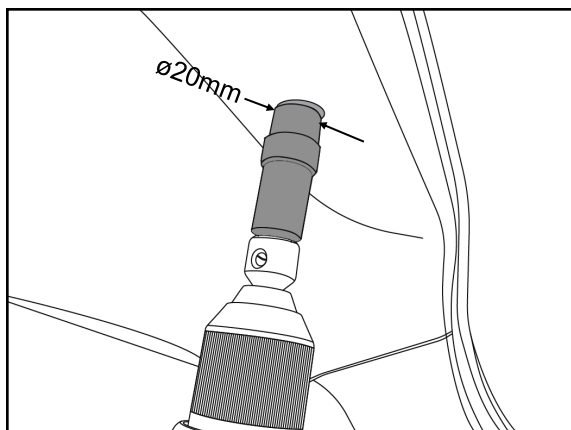

3. Using a 20mm vinyl cutter enlarge the hole in the roof lining at each of the trim plug holes.

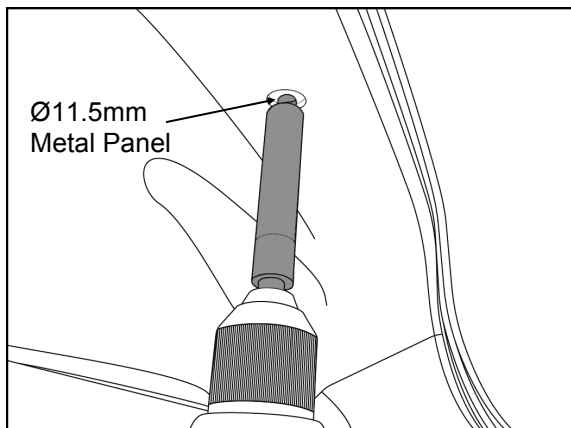

4. Using an 11.5mm drill bit with a drill stop set a 10mm enlarge the trim plug holes.



**Note: Maximum drill size 11.5mm  
 Minimum drill size 11.1mm**

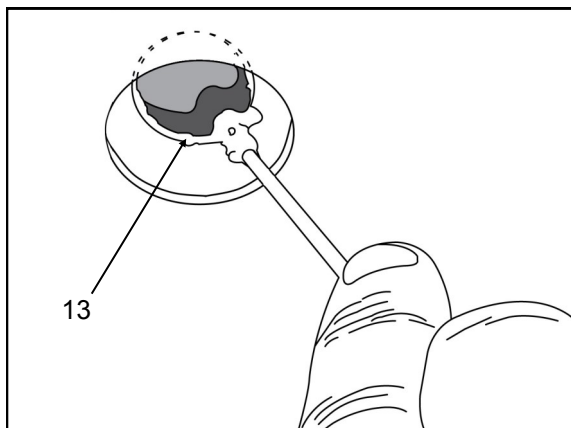
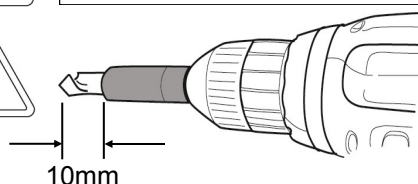

5. Deburr the drilled holes if necessary.
6. Vacuum away all drilling swarf.
7. Apply rust preventative sealer (13) to the raw edges of the drilled holes.



### INSTALLATION PROCEDURE FOR UPPER MOUNTS - Cont'd

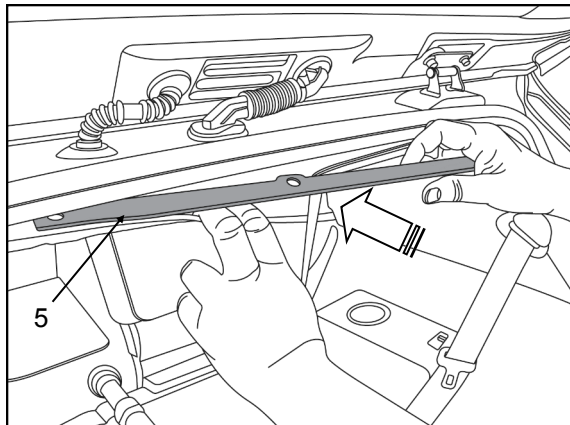

8. With the centre lug of the roof bracket (5) towards the front, slide it in between the roof lining and the metal roof panel.
9. Align the bracket holes with the drilled holes in the roof.

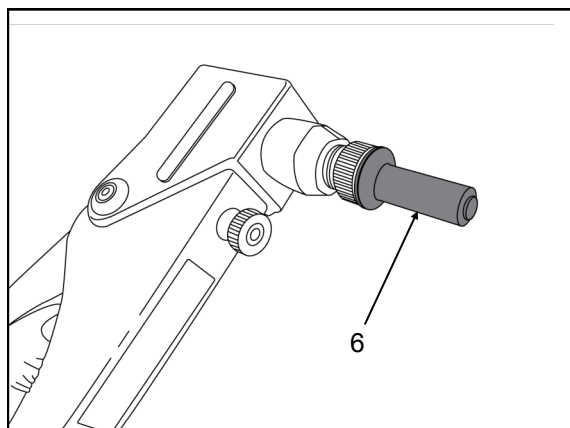

10. Screw a threaded insert (6) onto a suitable threaded insert tool.
11. Push the threaded insert fully through a bracket hole into one of the drilled holes in the roof panel.

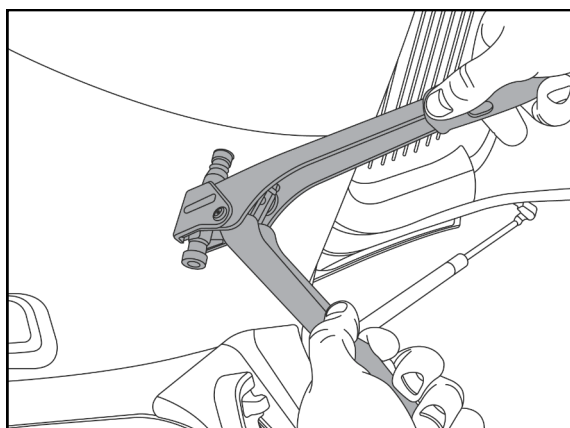

12. Fully pull up the threaded insert to secure in place.
13. Repeat for the other two holes.

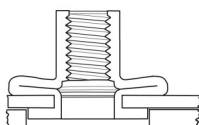

Cross section of threaded insert fully pulled up

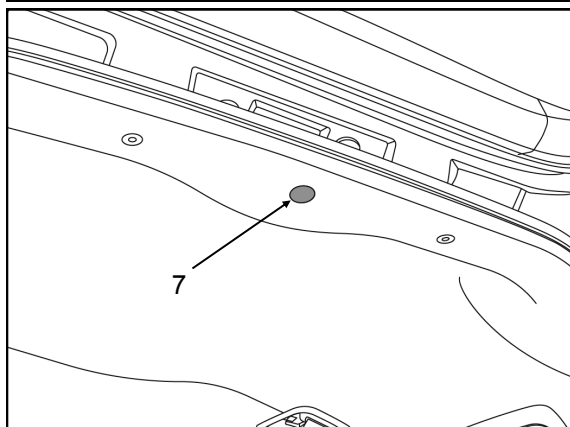

14. Fit the plastic trim plug (7) to the centre threaded insert.
15. Reset the rubber door seal over the edge of the roof lining.





## INSTALLATION OF BOTTOM MOUNTS

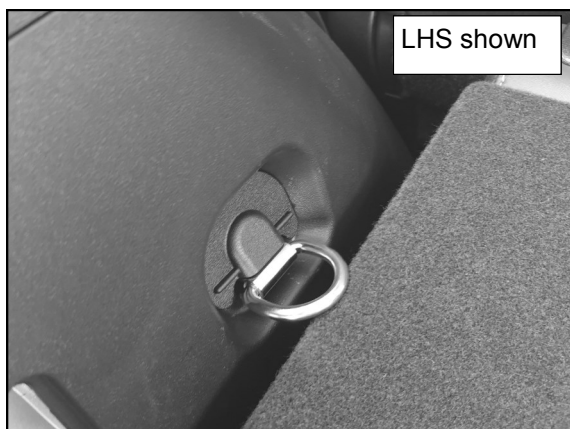

16. Find the 'D' anchor in the rear LHS of the vehicle.

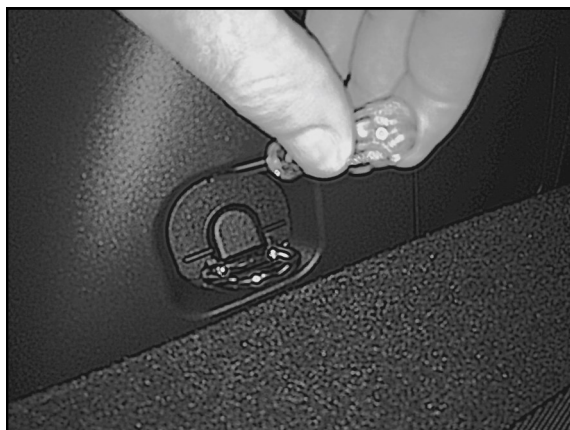

17. Carefully remove the trim cover with a

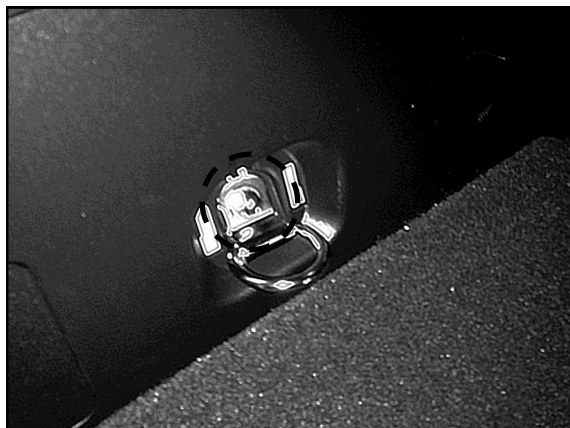

18. flat-bladed screwdriver, as shown. Remove the screw securing the 'D' anchor in place, then remove the 'D'

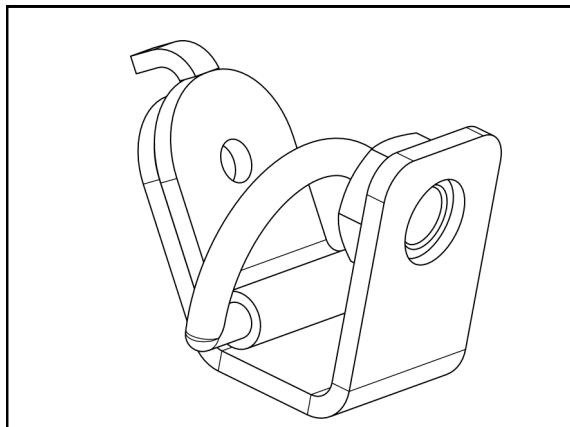

19. anchor. Place the 'D' anchor over the bracket

# TOYOTA PRIUS V CARGO BARRIER INSTALLATION INSTRUCTION

Part # 609825

VEHICLE YEARS OF MANUFACTURE - From May 2012



## INSTALLATION OF BOTTOM MOUNTS - Cont'd

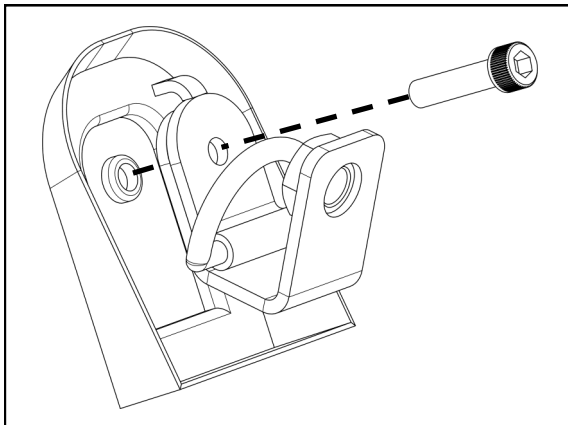

20. ASM (5) as shown.  
Place the bracket ASM and 'D' anchor aligned with the hole and secure in place with a socket head screw (10).

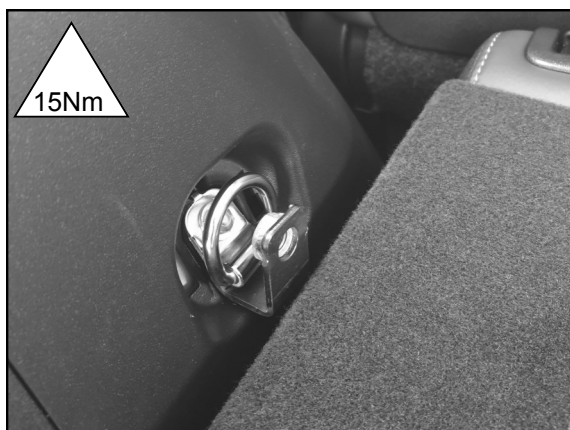

21. Repeat steps 16-20 on the RHS of the vehicle.

## AFFIXING OF WARNING LABEL

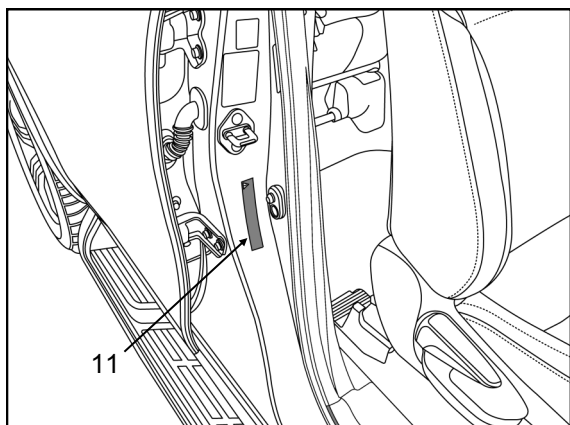

22. Tighten and torque up socket head screws to 15Nm.  
23. Clean the area shown inside the drivers door opening.

***Please ensure User Instructions are left with vehicle owner after installation.***



## **INSTALLATION OF CARGO BARRIER** **'Behind 2nd row of seats'**

1. Fold the 2nd row seat backs down to create manoeuvring space.
2. Place the 3rd row seats in their stored position if not already.
3. Ensure the cargo barrier straps are pivoted towards the meshed side of the cargo barrier.
4. Manoeuvre the cargo barrier into position in the behind 2nd row seat position.
5. Attach the top straps to the upper mounts using the 24mm (**M8**) Milbolts (11) with wave washers (12) under heads.
6. Attach the bottom straps to the side mounts using the 19mm (**M10**) Milbolts (14).
7. Tighten all Milbolts.
8. Lift the second row seats back into position.

**Note:** Replace current bottom straps with new bottom straps - bottom LHS strap (2) and bottom RHS strap (3).

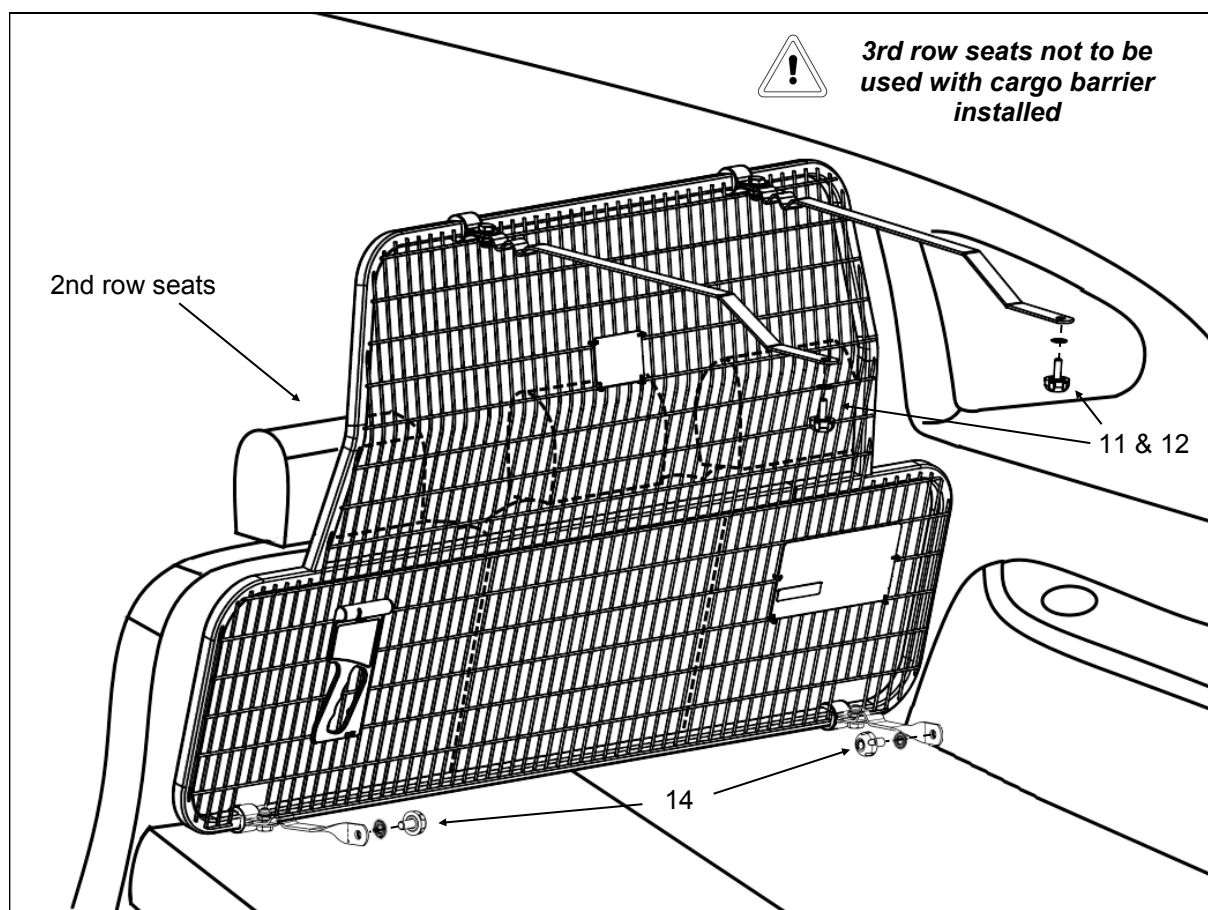

**IMPORTANT NOTE: Check that all bolts and screws are tight and re check periodically.**