



**MITSUBISHI OUTLANDER CARGO BARRIER**  
**'FRONT POSITION KIT'**  
**INSTALLATION INSTRUCTION - Part # 306327**  
VEHICLE YEARS OF MANUFACTURE - FROM NOV. 2012



**Use this kit with Cargo Barrier part number 306325 only.**  
**Kit will enable the barrier to be installed in the behind 1st row seats position.**

**Installation time approximately 10 Mins.**

"The estimated fitting time is based on an experienced fitter conversant with the fitment procedure"

### Parts List

Item	Component Name	Part No.	Qty
1	Velcro Tie	904003	4
2	Bottom Strap - LHS	776807	1
3	Bottom Strap - RHS	776808	1
4	Tube Extension Strap (Top)	776717	2
5	Lateral Support Bracket	753973	1
6	Milbolt - M10 x 1.5 x 19mm	912820	5
7	Flat Washer - 10mm ZP	932006	1

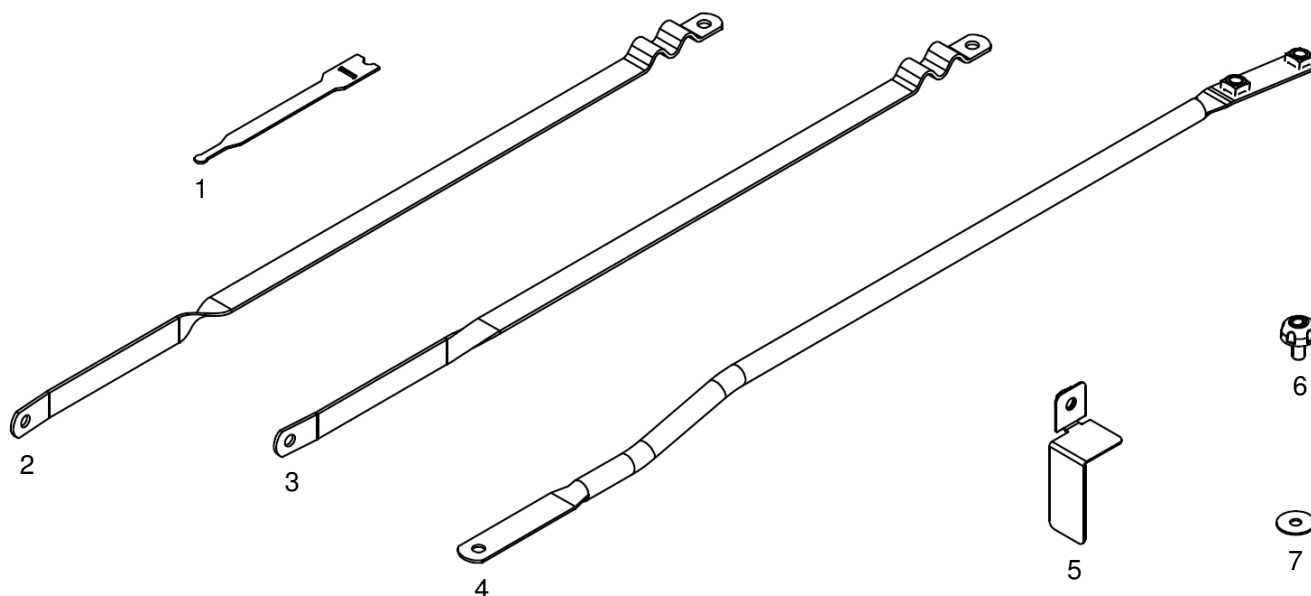

### TOOLS REQUIRED

- ☐ Socket Wrench
- ☐ 17mm A/F Hex Socket
- ☐ 16mm A/F Spanner

***E and OE—Errors and Omissions Excepted***



## SECURE BOTTOM STRAPS TO CARGO BARRIER ASM

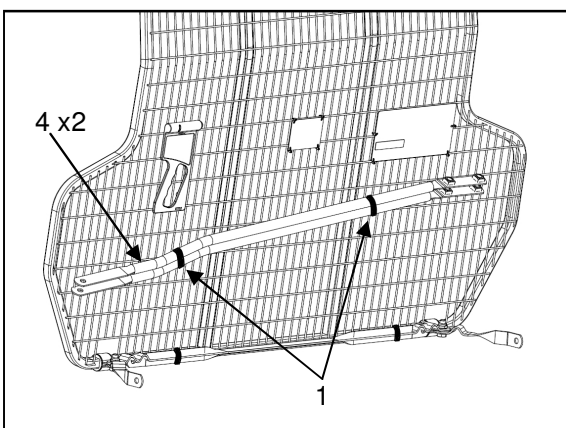
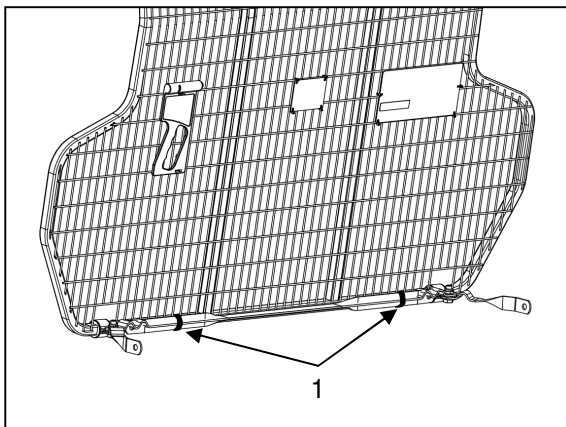
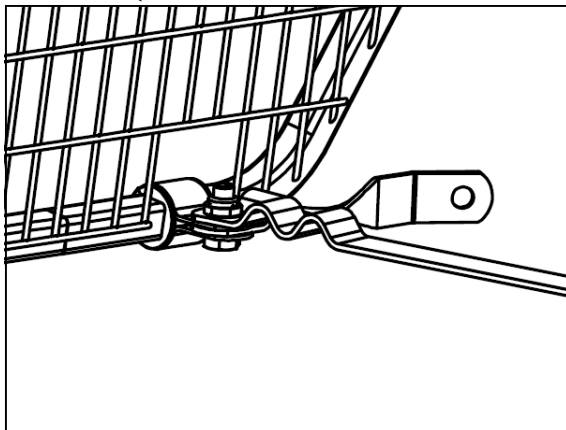
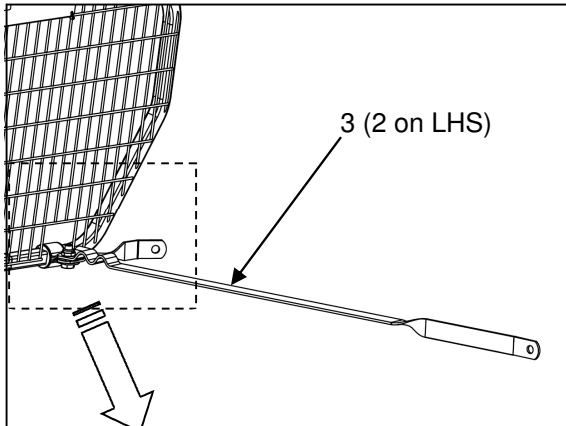

1. Undo the nyloc nuts securing the bottom straps to the saddles.
2. Place the correct flat strap over the saddle screw then replace the nyloc nuts.
3. Tighten the nuts so the straps are firm but can still be pivoted.

4. Tie the bottom straps together across the cargo barrier using Velcro ties (1).

5. Tie the tube extension straps together using Velcro ties (1). Tube extension straps can be secured across the cargo barrier or stored in a safe place.
6. Store the lateral support bracket and other fasteners in a safe place.
7. Refer to the User instructions for correct use of front position kit.