



FORD ENDURA CARGO BARRIER FRONT POSITION KIT FITTING INSTRUCTION PART # 107527

VEHICLE YEARS OF MANUFACTURE - From October 2018



For use with cargo barrier 107525 only.

Installation time approximately 0.5 Hours

"The estimated fitting time is based on an experienced fitter conversant with the fitment procedure"



WARNINGS

- **Strict compliance with fitting instructions is essential for this safety product to meet its rated capacity. Refer user instructions regarding correct usage of the cargo barrier.**
- **Do not modify cargo barrier in any way.**
- **Do not use this cargo barrier in any other vehicle for which it is not designed.**
- **Modifications to the cargo barrier or its fixings or use in any other vehicle for which it is not designed may void the load rating and warranty.**
- **Do not attach the cargo barrier to the vehicle using seat, seat belt or child restraint anchorage's.**
- **Where high tensile threaded fasteners are used, the cargo barrier must be installed using the size and grade fasteners specified by Milford Industries.**
- **Do not drill, rivet, adhere or attach objects to the front or rear of the cargo barrier.**
- **Do not place smaller items, that may bypass the cargo barrier in the event of heavy braking or collision, near the edges of the barrier.**
- **Position the load against the cargo barrier.**
- **When load is positioned against cargo barrier, secure the load with a restraint system.**
- **During a collision moving cargo may damage seat belts or tether straps of a child restraint device, or its anchorage. Load should be carefully positioned so as not to come in contact with these items.**
- **Do not obstruct seat belts or child restraints, or their operation.**
- **Long thin items of cargo should be positioned in the vehicle with the long axis across the vehicle to minimise the penetration risk.**
- **If involved in an accident or accidentally damaged, the cargo barrier should be replaced and the anchorage's repaired to as new condition.**
- **Clean with soap and water only. Do not use solvents or chemicals. Discard cargo barrier if it becomes rusted. Do not expose to direct sunlight for long periods.**
- **It is extremely dangerous to ride in the cargo area of the vehicle behind the cargo barrier. It is recommended that the cargo barrier be removed. In a collision people or children riding unrestrained in these areas are more likely to be seriously injured or killed.**
- **Never leave a child in the vehicle unattended, particularly in the rear cargo area. The cargo area should never be used as a play area for children.**
- **The cargo barrier may deform and significantly intrude into occupant's space in an accident.**
- **Remember that the tailgate cannot be opened from inside the cargo area.**
- **The fixed labeling should not be removed from the cargo barrier.**
- **Failure to comply with warning notes may prevent the barrier protecting the occupants.**
- **Parents should explain to children how and when to use EMERGENCY ESCAPE HAMMER attached to cargo barrier.**
- **Do not remove the rating plaque from the cargo barrier.**

NOTICE TO INSTALLERS & DISTRIBUTORS

Please ensure Fitting Instructions are left with vehicle owner after installation.



FORD ENDURA CARGO BARRIER FRONT POSITION KIT FITTING INSTRUCTION PART # 107527



VEHICLE YEARS OF MANUFACTURE - From October 2018

IMPORTANT: The installation kit contains sufficient components to fit the cargo barrier. A high degree of technical competence is necessary to correctly install this product. We recommend this cargo barrier be installed by an authorised outlet to ensure the barrier installation is correct. These instructions must be read and clearly understood before commencing installation. Check contents of kit before commencing fitment and report any discrepancies or damage.

Parts List

Item	Component Name	Part No.	Qty
1	Pivot Saddle	752700	2
2	Saddle Pivot Bush	752680	2
3	Support Leg	755373	2
4	Bottom Strap (LHS)	772006	1
5	Bottom Strap (RHS)	772007	1
6	Nut - Hex Head Nyloc M10 Zn	922090	2
7	Bolt - Hex Head M10 x 1.5 x 20mm Zn	912205	2
8	Tube Strap ASM (LHS)	772016	1
9	Tube Strap ASM (RHS)	772017	1
10	Milbolt M10 x 14mm	912816	4
11	Milbolt M10 x 34mm	912835	2
12	Velcro Ties	904001	2

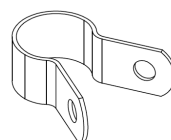

1

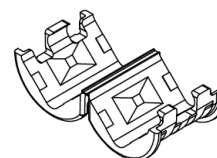

2



3

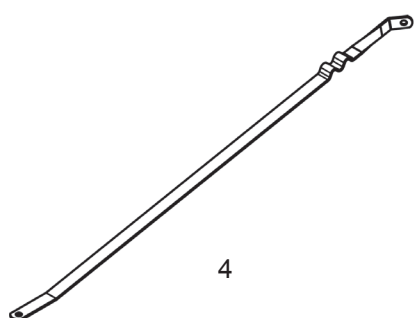

4

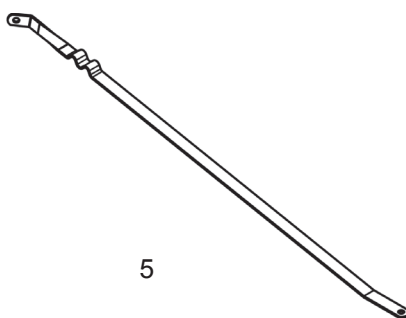

5



6



7

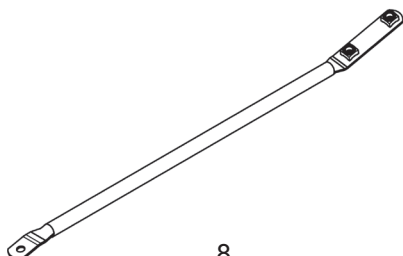

8

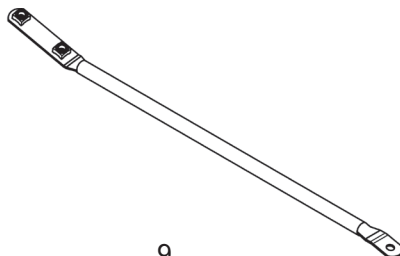

9



10

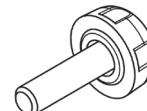

11

TOOLS REQUIRED

- Hex Sockets
- Socket Wrench
- 16mm Socket

E and OE—Errors and Omissions Excepted



FORD ENDURA **CARGO BARRIER FRONT POSITION KIT** **FITTING INSTRUCTION** **PART # 107527**

VEHICLE YEARS OF MANUFACTURE - From October 2018



PREPARATION FOR INSTALLING MOUNTS

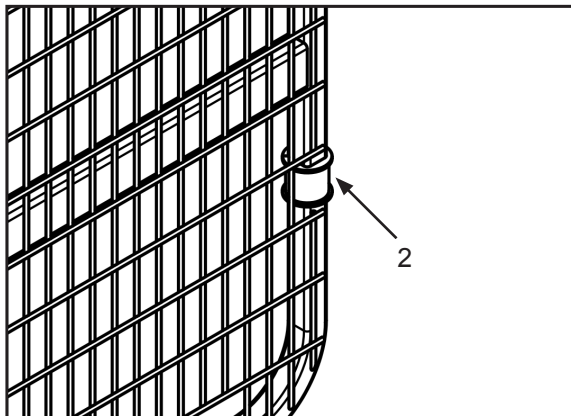

1. On the RHS of the cargo barrier at the cut out, place a pivot saddle bush (2) as shown.

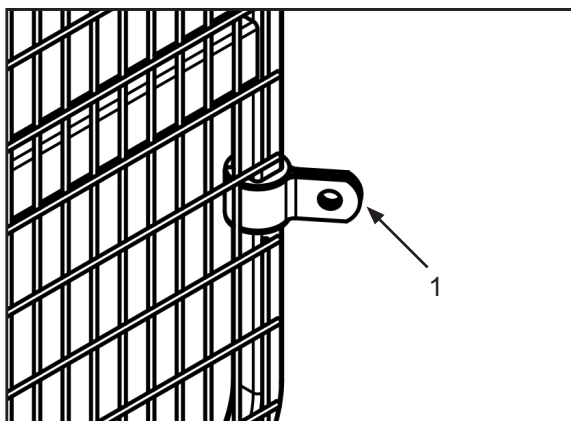

2. Place a pivot saddle (1) over each of the pivot saddle.

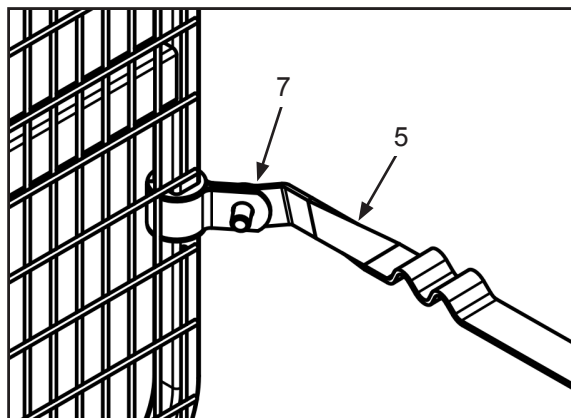

3. Place the correct strap (5) in between the pivot saddle ends then place a hex screw (7) through the saddle and strap.

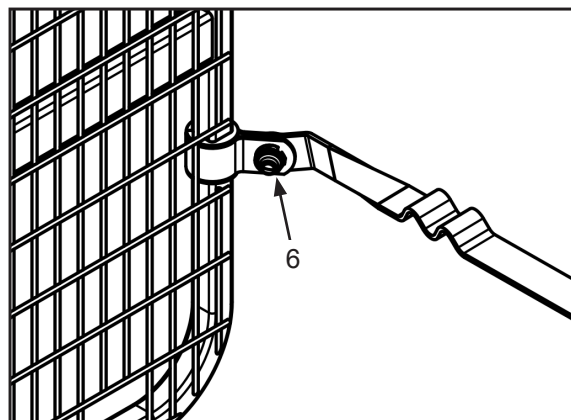

4. Place a nyloc hex nut (6) onto the hex screw then tighten until the strap is firm in saddle but can still be pivoted.
5. Repeat above steps for the LHS bottom strap (4) .
6. Rotate the long bottom straps across the meshed side of the barrier and secure with velcro ties (12).



FORD ENDURA CARGO BARRIER FRONT POSITION KIT FITTING INSTRUCTION PART # 107527



VEHICLE YEARS OF MANUFACTURE - From October 2018

INSTALLATION OF CARGO BARRIER

- Remove cargo blind if installed.
- Lay the 2nd row seat backs down flat as shown in the owners handbook.
- If moving from the behind 2nd row seats position, undo the Milbolts securing the bottom straps to the bottom mounts.
- If moving from the behind second row seats position, undo the Milbolts securing the top straps to the upper mounts.
- Ensure the top cargo barrier straps are pivoted towards the meshed side of the cargo barrier.
- Lay the cargo barrier on its meshed side on the back of the folded seats.
- Secure the support legs (3) to leg brackets as shown using the 34mm M10 Milbolts (11).
- With the front seats moved forwards on their runners, manoeuvre the cargo barrier into position behind the front row seats with the support legs on the floor.
- Secure the tube extension straps (4 & 5) to the top straps as shown using 14mm M10 Milbolts (10).
- Secure the other end of the tube extension straps to the upper mounts using 14mm M8 Milbolts with wave washers under heads from the rear position kit.
- Untie the long bottom straps from the cargo barrier.
- Secure the long bottom straps to the bottom mounts as shown using 39mm M10 Milbolts with wave washers under heads.
- Tighten all Milbolts.
- Reverse the procedure to move the cargo barrier to the behind 2nd row seats position or remove from the vehicle.

