



MITSUBISHI PAJERO SPORT CARGO BARRIER FRONT POSITION KIT INSTALLATION INSTRUCTION Part # 306402

VEHICLE YEARS OF MANUFACTURE - OCT. 2015 ONWARD (Dec. Release)
(For use with Cargo Barrier P/N 306400 only)



The installation kit contains sufficient components to allow Cargo Barrier part number 306400 to be located behind the 2nd row of seats in their folded/tumbled position. A high degree of technical competence is necessary to correctly install this product.

We recommend this cargo barrier be installed by an authorised outlet to ensure the barrier installation complies with AS/NZS 4034 Standard.

The cargo barrier is designed, manufactured and fitted to decrease the impact hazard in an accident to occupants from cargo carried within the interior cargo space of the vehicle. In the event of an accident, a cargo barrier can reduce injuries caused by cargo intruding into occupant's space.

Installation time approximately 0.25 Hour

"The estimated fitting time is based on an experienced fitter conversant with the fitment procedure"



WARNINGS

- **Strict compliance with fitting instructions is essential for this safety product to meet its rated capacity. Refer user instructions regarding correct usage of the cargo barrier.**
- **Do not modify cargo barrier in any way.**
- **Do not use this cargo barrier in any other vehicle for which it is not designed.**
- **Modifications to the cargo barrier or its fixings or use in any other vehicle for which it is not designed may void the load rating and warranty.**
- **Do not attach the cargo barrier to the vehicle using seat, seat belt or child restraint anchorage's.**
- **Where high tensile threaded fasteners are used, the cargo barrier must be installed using the size and grade fasteners specified by Milford Industries.**
- **Do not drill, rivet, adhere or attach objects to the front or rear of the cargo barrier.**
- **Do not place smaller items, that may bypass the cargo barrier in the event of heavy braking or collision, near the edges of the barrier.**
- **Position the load against the cargo barrier.**
- **When load is positioned against cargo barrier, secure the load with a restraint system.**
- **During a collision moving cargo may damage seat belts or tether straps of a child restraint device, or its anchorage. Load should be carefully positioned so as not to come in contact with these items.**
- **Do not obstruct seat belts or child restraints, or their operation.**
- **Long thin items of cargo should be positioned in the vehicle with the long axis across the vehicle to minimise the penetration risk.**
- **If involved in an accident or accidentally damaged, the cargo barrier should be replaced and the anchorage's repaired to as new condition.**
- **Clean with soap and water only. Do not use solvents or chemicals. Discard cargo barrier if it becomes rusted. Do not expose to direct sunlight for long periods.**
- **It is extremely dangerous to ride in the cargo area of the vehicle behind the cargo barrier. It is recommended that the cargo barrier be removed. In a collision people or children riding unrestrained in these areas are more likely to be seriously injured or killed.**
- **Never leave a child in the vehicle unattended, particularly in the rear cargo area. The cargo area should never be used as a play area for children.**
- **The cargo barrier may deform and significantly intrude into occupant's space in an accident.**
- **Remember that the tailgate cannot be opened from inside the cargo area.**
- **The fixed labeling should not be removed from the cargo barrier.**
- **Failure to comply with warning notes may prevent the barrier protecting the occupants.**
- **Parents should explain to children how and when to use *EMERGENCY ESCAPE HAMMER* attached to cargo barrier.**
- **Do not remove the rating plaque from the cargo barrier.**
- **Do not use cargo barrier in vehicles intended for motorsport.**

NOTICE TO INSTALLERS & DISTRIBUTORS

Please ensure User Instructions are left with vehicle owner after installation.



MITSUBISHI PAJERO SPORT CARGO BARRIER FRONT POSITION KIT INSTALLATION INSTRUCTION

Part # 306402

VEHICLE YEARS OF MANUFACTURE - OCT. 2015 ONWARD (Dec. Release)
(For use with Cargo Barrier P/N 306400 only)



IMPORTANT: The installation kit contains sufficient components to fit the cargo barrier. A high degree of technical competence is necessary to correctly install this product. We recommend this cargo barrier be installed by an authorised outlet to ensure the barrier installation is correct. These instructions must be read and clearly understood before commencing installation. Check contents of kit before commencing fitment and report any discrepancies or damage.

Parts List

Item	Component Name	Part No.	Qty
1	Strap - Bottom Forward Position	776970	2
2	Tube Strap ASM - Top Forward Position	776506	2
3	Milbolt - M10 x 1.5 x 19mm	912820	4
4	Velcro Tie	904001	4

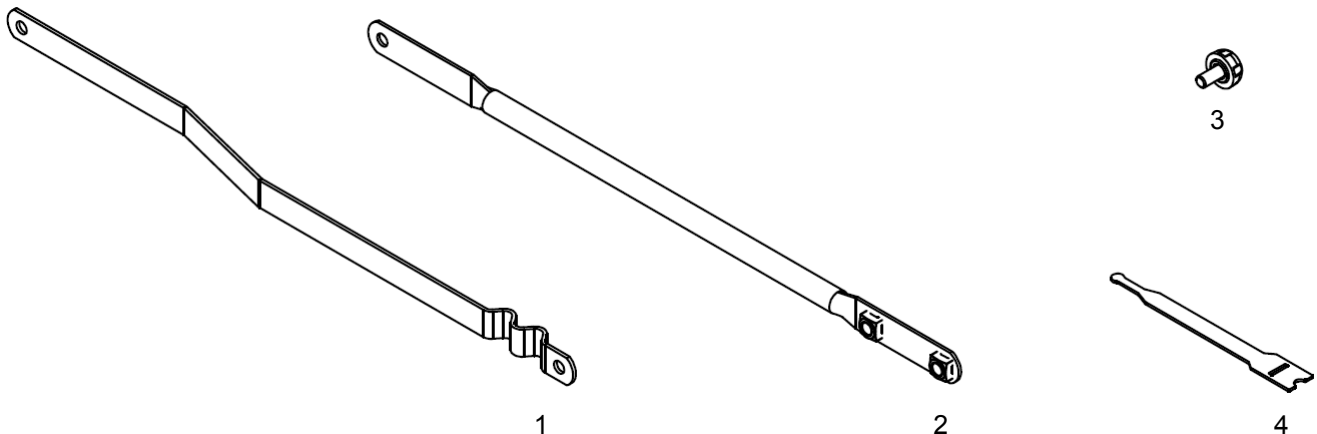

E and OE—Errors and Omissions Excepted

TOOLS REQUIRED

- Socket wrench
- Metric hex sockets
- Metric spanners

MITSUBISHI PAJERO SPORT CARGO BARRIER FRONT POSITION KIT INSTALLATION INSTRUCTION

Part # 306402

VEHICLE YEARS OF MANUFACTURE - OCT. 2015 ONWARD (Dec. Release)
(For use with Cargo Barrier P/N 306400 only)



INSTALLATION OF FRONT POSITION BOTTOM STRAPS TO CARGO BARRIER

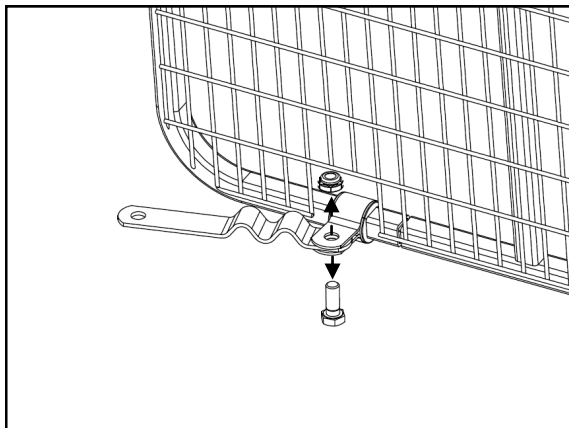

1. On the LHS remove the nyloc nut from the securing screw for the bottom strap ASM. Remove the screw from the saddle

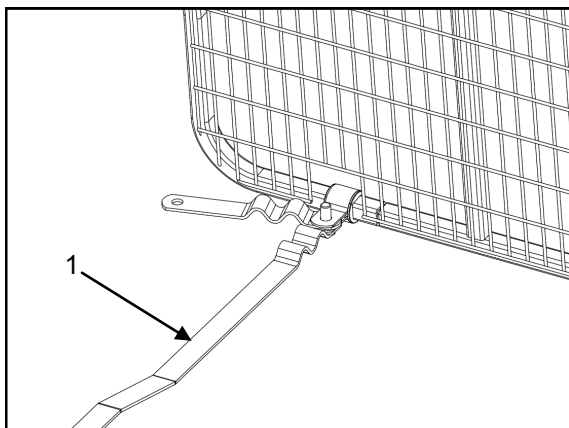

2. Position a bottom forward position strap (1) on the underside of the saddle as shown with the wrinkle facing upwards.
3. With the rear position strap inside the saddle replace the securing screw.

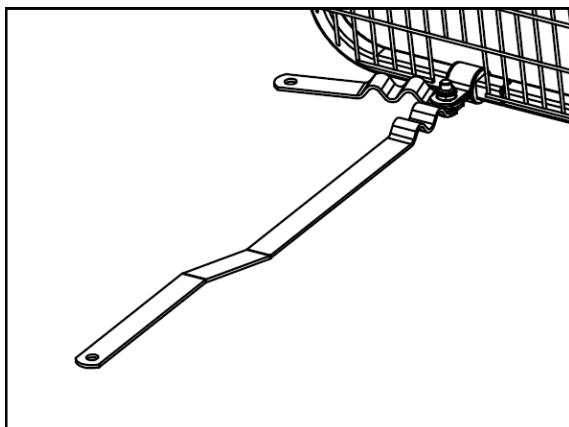

4. Replace the nyloc nut and tighten until the straps are firm in/on the saddle but can still be pivoted.

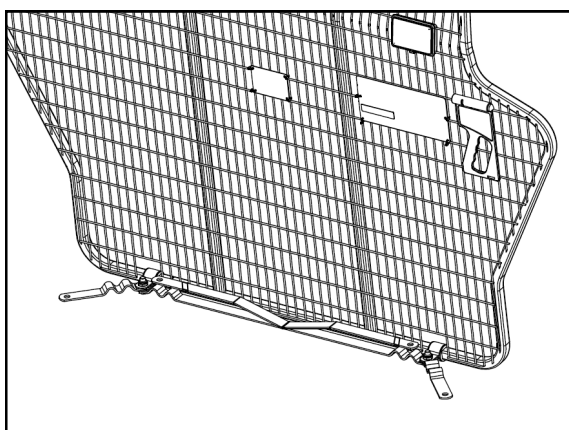

5. Repeat the above for the RH bottom forward position strap.
6. Fold and secure the long bottom straps across the back of the cargo barrier using the Velcro ties (4).

MITSUBISHI PAJERO SPORT CARGO BARRIER FRONT POSITION KIT INSTALLATION INSTRUCTION

Part # 306402

VEHICLE YEARS OF MANUFACTURE - OCT. 2015 ONWARD (Dec. Release)
(For use with Cargo Barrier P/N 306400 only)



INSTALLATION OF CARGO BARRIER - FORWARD POSITION

1. Tumble the 2nd row seats forward.
2. If moving from the rear position undo the Milbolts securing the cargo barrier in position.
3. Ensure the cargo barrier straps are pivoted towards the meshed side of the cargo barrier.
4. Manoeuvre the cargo barrier into position behind the tumbled 2nd row seats with the meshed side facing the rear.
5. Attach the tube extension straps (2) to the top cargo barrier straps as shown using the 19mm Milbolts (3).
6. Attach the other ends of the tube extension straps to the upper mounts using the 19mm Milbolts with wave washers under heads from the rear position kit.
7. Untie the long bottom straps from the cargo barrier.
8. Attach the long bottom straps to the bottom mounts using 19mm Milbolts with wave washers under heads, from the rear position kit.
9. Tighten all Milbolts.
10. Reverse the procedure to relocate the cargo barrier or remove from the vehicle.

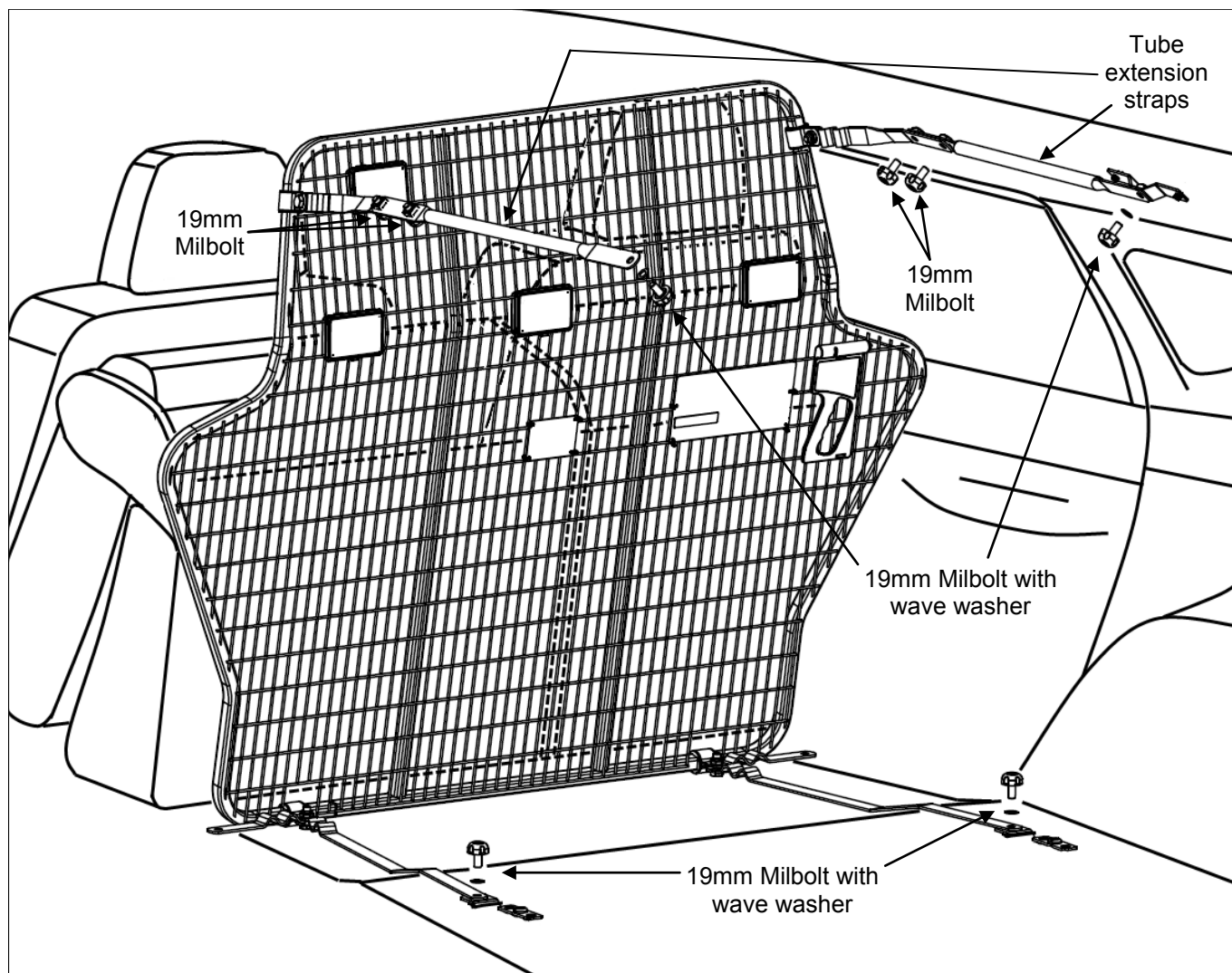

IMPORTANT NOTE: Check that all bolts and screws are tight and re check periodically.

MITSUBISHI PAJERO SPORT CARGO BARRIER FRONT POSITION KIT INSTALLATION INSTRUCTION

Part # 306402

VEHICLE YEARS OF MANUFACTURE - OCT. 2015 ONWARD (Dec. Release)
(For use with Cargo Barrier P/N 306400 only)



INSTALLATION OF CARGO BARRIER - REAR POSITION

1. Remove the cargo blind if installed.
2. Tumble the 2nd row seats forward to allow manoeuvring space for the cargo barrier installation.
3. Ensure the mounting straps are pivoted towards the meshed side of the cargo barrier.
4. With the meshed side of the cargo barrier to the rear, manoeuvre the cargo barrier into position in the behind 2nd row seats location.
5. Secure the top straps to the roof brackets using a 19mm Milbolt with wave washer under head, through the 2nd strap hole.
6. Secure the bottom straps to the bottom mounts using a 19mm Milbolt with wave washer under head.
7. Tighten all Milbolts.
8. Replace the cargo blind if required.
9. Lift the 2nd row seats back into position.

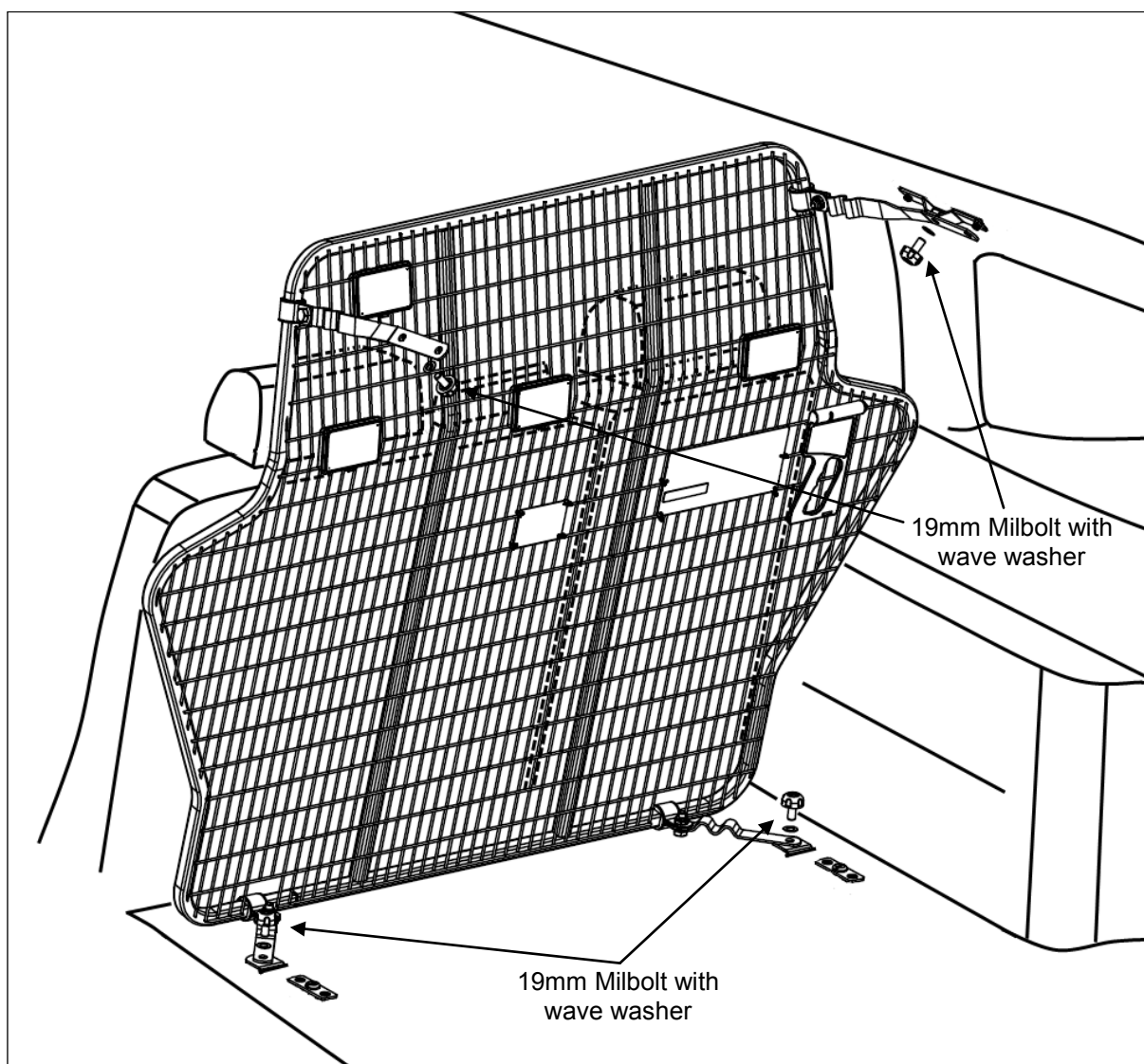

IMPORTANT NOTE: Check that all bolts and screws are tight and re check periodically.