



## TOYOTA LANDCRUISER PRADO 5 SEAT CARGO BARRIER INSTALLATION INSTRUCTION

Part # 609375

YEARS OF MANUFACTURE - AUG. 2009 ONWARD  
SUITS ALL MODELS WITH 5 SEATS (NOT SUITABLE FOR 7 SEAT MODELS)



This cargo barrier is capable of being located in two positions, behind the 2nd row of seats with the seats in an upright position, and behind the 1st row of seats with the 2nd row of seats in their folded position.

**Note** -(In front position cargo barrier sits between flipped up base of 2nd row seat and top of folded 2nd row seat back)

**The installation kit contains sufficient components for fitment in rear position only.** If front position is required please also purchase - Part #609395.

A high degree of technical competence is necessary to correctly install this product.

We recommend this cargo barrier be installed by an authorised outlet to ensure the barrier installation complies with AS/NZS 4034 Standard.

The cargo barrier is designed, manufactured and fitted to decrease the impact hazard in an accident to occupants from cargo carried within the interior cargo space of the vehicle. In the event of an accident, a cargo barrier can reduce injuries caused by cargo intruding into occupant's space.

**Installation time approximately 1 Hour**



### WARNINGS

- **Strict compliance with fitting instructions is essential for this safety product to meet its rated capacity. Refer user instructions regarding correct usage of the cargo barrier.**
- **Do not modify cargo barrier in any way.**
- **Do not use this cargo barrier in any other vehicle for which it is not designed.**
- **Modifications to the cargo barrier or its fixings or use in any other vehicle for which it is not designed may void the load rating and warranty.**
- **Do not attach the cargo barrier to the vehicle using seat, seat belt or child restraint anchorage's.**
- **Where high tensile threaded fasteners are used, the cargo barrier must be installed using the size and grade fasteners specified by Milford Industries.**
- **Do not drill, rivet, adhere or attach objects to the front or rear of the cargo barrier.**
- **Do not place smaller items, that may bypass the cargo barrier in the event of heavy braking or collision, near the edges of the barrier.**
- **Position the load against the cargo barrier.**
- **When load is positioned against cargo barrier, secure the load with a restraint system.**
- **During a collision moving cargo may damage seat belts or tether straps of a child restraint device, or its anchorage. Load should be carefully positioned so as not to come in contact with these items.**
- **Do not obstruct seat belts or child restraints, or their operation.**
- **Long thin items of cargo should be positioned in the vehicle with the long axis across the vehicle to minimise the penetration risk.**
- **If involved in an accident or accidentally damaged, the cargo barrier should be replaced and the anchorage's repaired to as new condition.**
- **Clean with soap and water only. Do not use solvents or chemicals. Discard cargo barrier if it becomes rusted. Do not expose to direct sunlight for long periods.**
- **It is extremely dangerous to ride in the cargo area of the vehicle behind the cargo barrier. It is recommended that the cargo barrier be removed. In a collision people or children riding unrestrained in these areas are more likely to be seriously injured or killed.**
- **Never leave a child in the vehicle unattended, particularly in the rear cargo area. The cargo area should never be used as a play area for children.**
- **The cargo barrier may deform and significantly intrude into occupant's space in an accident.**
- **Remember that the tailgate cannot be opened from inside the cargo area.**
- **The fixed labeling should not be removed from the cargo barrier.**
- **Failure to comply with warning notes may prevent the barrier protecting the occupants.**
- **Parents should explain to children how and when to use *EMERGENCY ESCAPE HAMMER* attached to cargo barrier.**
- **Do not remove the rating plaque from the cargo barrier.**

### NOTICE TO INSTALLERS & DISTRIBUTORS

***Please ensure User Instructions are left with vehicle owner after installation.***



# TOYOTA LANDCRUISER PRADO 5 SEAT CARGO BARRIER INSTALLATION INSTRUCTION

Part # 609375

YEARS OF MANUFACTURE - AUG. 2009 ONWARD  
SUITS ALL MODELS WITH 5 SEATS (NOT SUITABLE FOR 7 SEAT MODELS)



**IMPORTANT:** The installation kit contains sufficient components to fit the cargo barrier. A high degree of technical competence is necessary to correctly install this product. We recommend this cargo barrier be installed by an authorised outlet to ensure the barrier installation is correct. These instructions must be read and clearly understood before commencing installation. Check contents of kit before commencing fitment and report any discrepancies or damage.

## Parts List

Item	Component Name	Part No.	Qty
1	Cargo Barrier ASM (not shown)	609390	1
2	Upper Bracket—R/H	756230	1
3	Upper Bracket—L/H	756235	1
4	Cover Plate ASM—Powder coated	754602	2
5	Mounting Plate - ZP	754000	2
6	Screw—CSK 5/16" BSW x 1 ZP	912000	4
7	Screw—S/H Cap M6 x 1.0 HT ZP	711419	4
8	Washer—Flat 6mm	932282	4

Item	Component Name	Part No.	Qty
9	Milbolt—M10 x 1.5 x 39mm	912840	4
10	Installation Tool	754200	1
11	Shouldered Nut—M10 x 1.5	907626	2
12	Wave Washer—10mm	932125	4
13	Rust Preventative Wax (sachet)	906300	1
14	Marking Pin—M10 x 1.5 x 40	906186	2
15	Warning Label—Orange	905016	2
16	Cleaning Pad (sachet)	906302	1

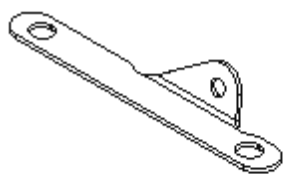

2

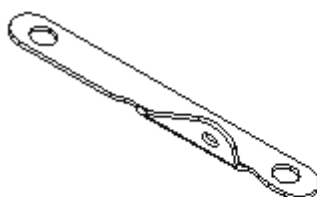

3



4



5



6



7



8



9



10



11



12



13



14



15



16

## **TOYOTA LANDCRUISER PRADO 5 SEAT CARGO BARRIER INSTALLATION INSTRUCTION**

**Part # 609375**

YEARS OF MANUFACTURE - AUG. 2009 ONWARD  
SUITS ALL MODELS WITH 5 SEATS (NOT SUITABLE FOR 7 SEAT MODELS)



### **ADVICE TO FITTER**

**Note:** To fit the cargo barrier the following is essential:

- ☐ Always drill perpendicular to surface (Unless stated otherwise).
- ☐ A positive drill stop should always be used to prevent accidental damage to external panels, fuel lines etc.
- ☐ Ensure Safety Eye Protection and Gloves are worn as required when using cutting tools.
- ☐ When cutting metal panels be very careful of sharp edges, for risk of skin cuts etc.
- ☐ Care should be taken when applying Rust Preventative sealer to all holes drilled, to negate the possibility of skin and eye irritation.
- ☐ Check screws in relevant components by hand before installation. Should there be resistance re-tap threads and re-check.
- ☐ **Before marking or drilling to install this cargo barrier, check vehicle for LPG conversion & non standard fuel tanks. Locate tanks and all lines attached and take EXTREME CARE not to damage whilst installing this cargo barrier.**
- ☐ **Before drilling to install this cargo barrier, check for concealed wiring looms. E.g. tow bar, reversing camera, reversing sensor wiring etc.. Relocate before drilling to avoid damage.**

**CARE SHOULD BE TAKEN NOT TO CROSS THREAD THE FASTENERS DURING  
INSTALLATION OF COMPONENTS TO THE VEHICLE.**

### **TOOLS REQUIRED**

- |                                |                                |
|--------------------------------|--------------------------------|
| • Socket wrench                | • 5mm, 13mm, Drill Bits        |
| • Metric hex sockets           | • Drill stop's                 |
| • Metric spanners              | • 22mm Hole Saw                |
| • Trim removal tools           | • 20mm Vinyl Cutter            |
| • Hammer                       | • Hole De-Burring Tool         |
| • Screwdriver—Large Flat Blade | • Hex bits & driver            |
| • Power Drill                  | • Rust Preventative Applicator |
| • Masking Tape                 | • Vacuum Cleaner               |
| • Marker                       | • Cover sheet / Drop sheet     |
| • Centre Punch                 | • Torque wrench (9Nm)          |

# TOYOTA LANDCRUISER PRADO 5 SEAT CARGO BARRIER INSTALLATION INSTRUCTION

Part # 609375

YEARS OF MANUFACTURE - AUG. 2009 ONWARD  
SUITS ALL MODELS WITH 5 SEATS (NOT SUITABLE FOR 7 SEAT MODELS)



## MARKING PROCEDURE FOR FLOOR MOUNTS



1. Identify area which you will be working in. Forward end of cargo area.
2. Fold 2nd row seats down flat to allow access to area where mounts will be installed.



Remove forward  
'D' Ring anchors

3. Remove the 2 'D' Ring anchors at the forward end of the cargo area by first unclipping the screw covers as shown, then removing the M6 attaching screws.

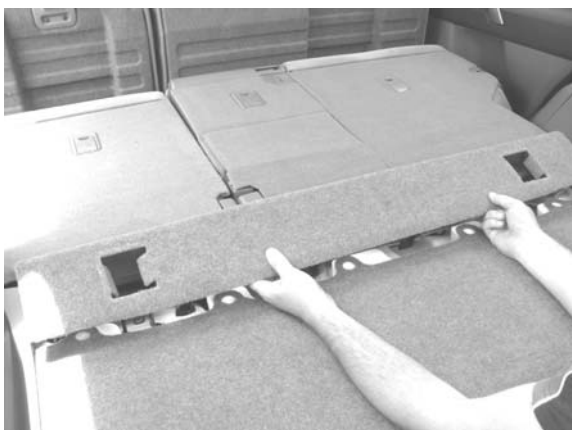

4. With the assistance of trim removal tools unclip the floor panel located at the forward end of the cargo area.

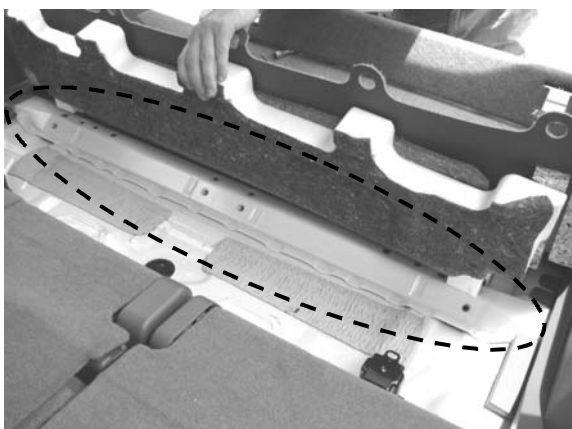

5. Pull back the floor covering enough to expose the cross member located between the wheel arches.

# TOYOTA LANDCRUISER PRADO 5 SEAT CARGO BARRIER INSTALLATION INSTRUCTION

Part # 609375

YEARS OF MANUFACTURE - AUG. 2009 ONWARD  
SUITS ALL MODELS WITH 5 SEATS (NOT SUITABLE FOR 7 SEAT MODELS)



## MARKING PROCEDURE FOR FLOOR MOUNTS Cont'd

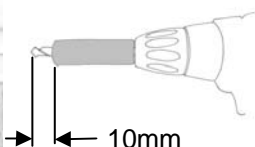
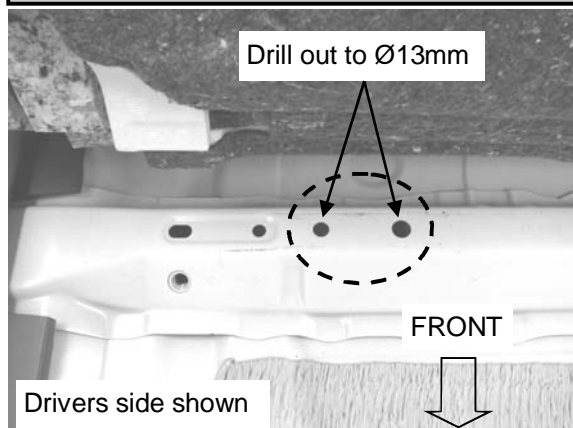

6. The two holes circled in the picture will be used for the outer holes of mounting plate (Item 5).
7. Using a power drill & Ø13mm drill bit with **drill stop** set at 10mm, enlarge both of the holes.
8. Repeat on passenger side holes.

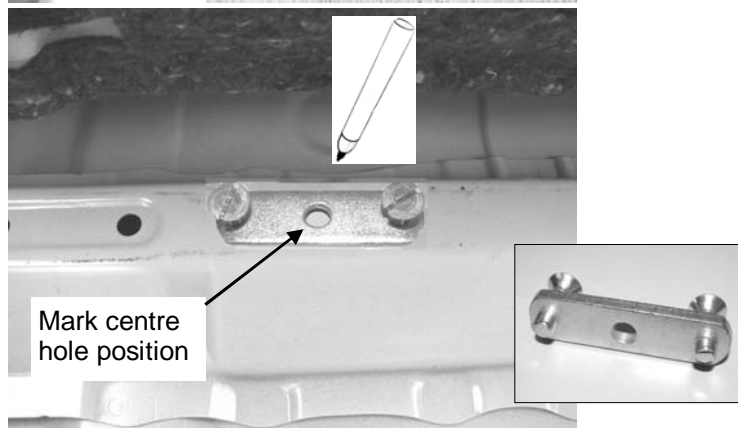

9. Temporarily fit 5/16" CSK screws (Item 6) into the outer holes of mounting plate (Item 5) with about 5mm of thread sticking out.
10. Place assembly on top of cross member with the 2 screws located in the 13mm drilled holes.
11. With the mounting plate held parallel with the cross member, use the mounting plate as a template and mark the centre hole position onto the cross member.
12. Repeat on the other side.

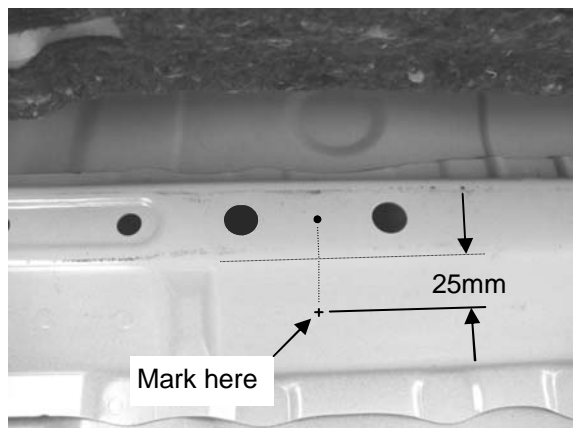

13. On the same centre line as marked centre hole location, and 25mm down from the top surface of the cross member mark front face of member as shown.
14. Repeat on other side.

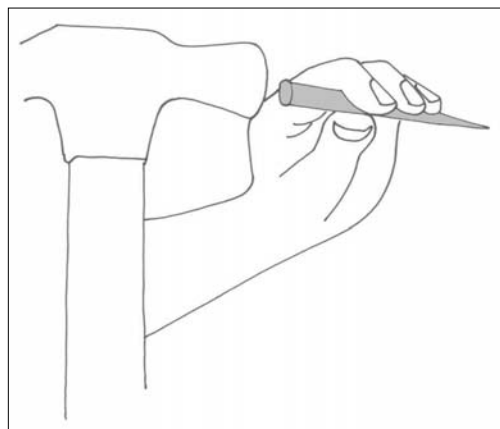

15. Centre punch all 4 marked locations.

# TOYOTA LANDCRUISER PRADO 5 SEAT CARGO BARRIER INSTALLATION INSTRUCTION

Part # 609375

YEARS OF MANUFACTURE - AUG. 2009 ONWARD  
SUITS ALL MODELS WITH 5 SEATS (NOT SUITABLE FOR 7 SEAT MODELS)



## DRILLING PROCEDURE FOR FLOOR MOUNTS

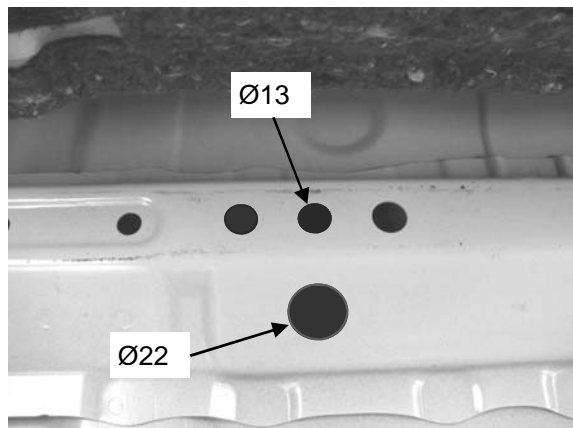

16. Using a Ø5mm drill bit with **drill stop** set at 10mm, pilot drill each of the centre punched locations from step 15.
17. Using a Ø13mm drill bit with **drill stop** set at 10mm enlarge centre mounting plate holes in top of cross member.
18. Using a Ø22mm hole saw with **drill stop** set at 10mm, enlarge the mounting plate access holes in the front face of the cross member.
19. De burr holes and vacuum away any drilling swarf.
20. Apply rust preventative wax (Item 13) to all drilled holes using an applicator such as a cotton bud.

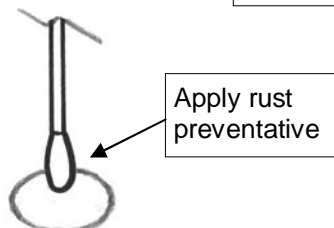
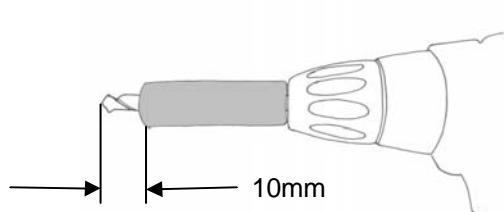

## INSTALLATION PROCEDURE FOR FLOOR MOUNTS

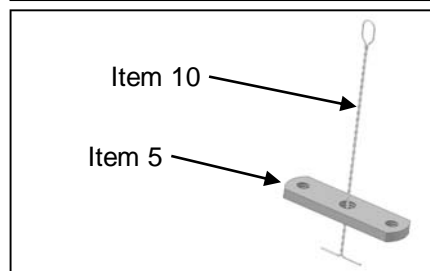

21. Place mounting plate (Item 5) over installation tool (Item 10) as shown.

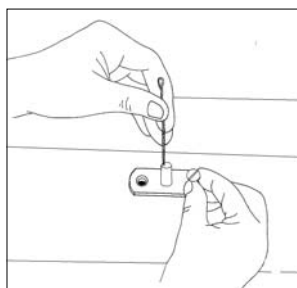
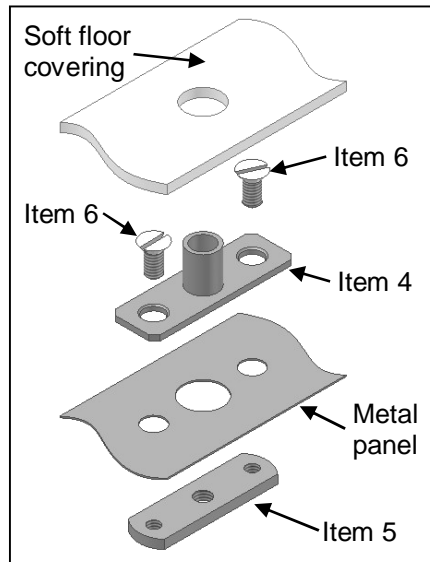

22. Insert loop end of installation tool through the 22mm access hole in the front face of the cross member and up through the 13mm mounting plate centre hole. At the same time insert the mounting plate in through the 22mm access hole.
23. Position the mounting plate against the back face of the cross member with the outer holes aligned.
24. Place cover plate ASM (Item 4) over the installation tool with the spacer tube facing upwards.
25. With the outer holes aligned secure the assembly in place using 5/16" CSK screws (Item 6)
26. Repeat for other side.

# TOYOTA LANDCRUISER PRADO 5 SEAT CARGO BARRIER INSTALLATION INSTRUCTION

Part # 609375

YEARS OF MANUFACTURE - AUG. 2009 ONWARD  
SUITS ALL MODELS WITH 5 SEATS (NOT SUITABLE FOR 7 SEAT MODELS)



## INSTALLATION PROCEDURE FOR FLOOR MOUNTS - Cont'd

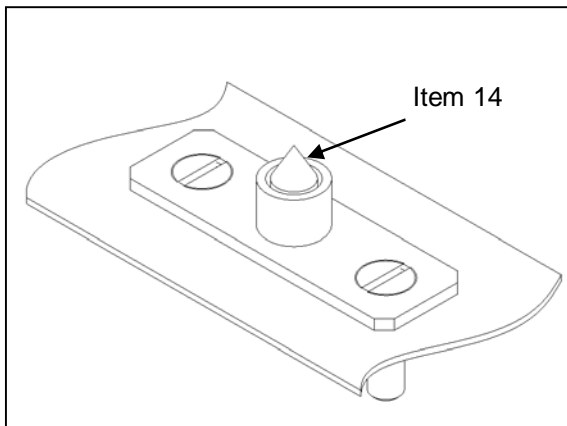

27. Fit marking pins (Item 14) to centre M10 threads in floor mount assemblies with the points protruding.

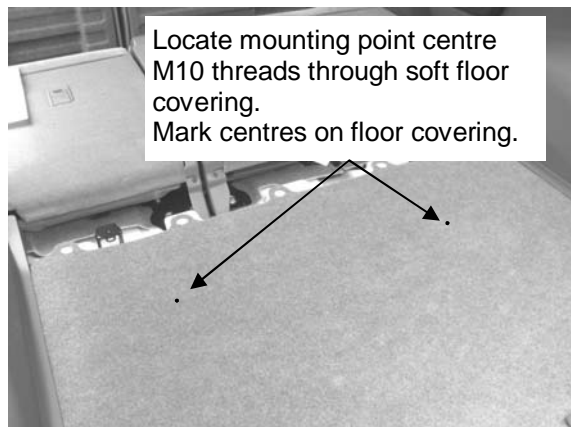

28. Lay floor covering back down into its natural position.
29. Once floor covering is in position apply pressure to the covering in the locations of the mounts/markings pins. *(Take care not to spike yourself on the sharp pins)*
30. Once the points of the marking pins are located on the floor covering mark those locations using a marker pen.

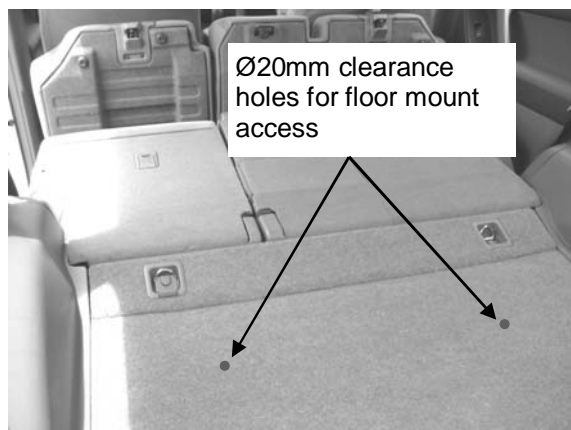

31. Lift the floor covering up slightly and using a Ø20mm vinyl cutter cut holes through the floor covering at the marked locations.
32. Remove the marking pins then reposition floor covering.
33. Re install forward floor panel and D Ring anchors removed at steps 3 & 4.

## TOYOTA LANDCRUISER PRADO 5 SEAT CARGO BARRIER INSTALLATION INSTRUCTION

Part # 609375

YEARS OF MANUFACTURE - AUG. 2009 ONWARD  
SUITS ALL MODELS WITH 5 SEATS (NOT SUITABLE FOR 7 SEAT MODELS)



### INSTALLATION PROCEDURE FOR UPPER MOUNTS



34. Unclip the screw covers for the (3rd row seat) grab handles located above the cargo area.
35. Undo the screws & remove the grab handles. **The screws are no longer required and will be replaced with high tensile screws from the kit.**

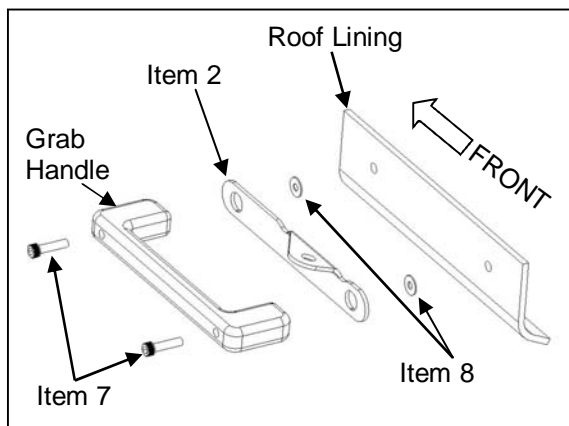

36. On drivers side of vehicle assemble screws, grab handle, RH upper bracket and flat washers as per exploded picture shown.  
**Note:** Ensure grab handle is correct way up. Arrow inside screw cover should be pointing upwards.
37. Secure grab handle and bracket back in place. Tighten screws to 9Nm/7ft.lbs.
38. Repeat on passenger side using bracket (Item 3).

### AFFIXING OF WARNING LABELS



39. Clean area inside drivers door opening as shown using cleaning pad (Item 16).
40. Allow to dry then affix orange warning label (Item 15) at that location as shown.

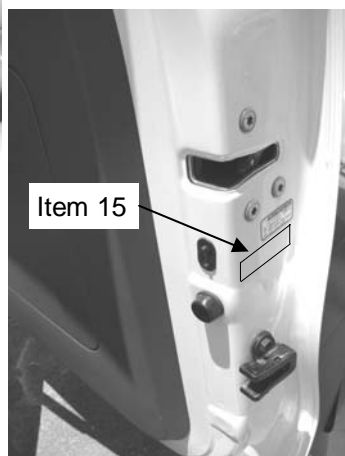

41. Clean area adjacent to child lock on tailgate as shown using cleaning pad (Item 16).
42. Allow to dry then affix orange warning label (Item 15) at that location as shown.

**Please ensure User Instructions are left with vehicle owner after installation.**



## TOYOTA LANDCRUISER PRADO 5 SEAT CARGO BARRIER INSTALLATION INSTRUCTION

Part # 609375

YEARS OF MANUFACTURE - AUG. 2009 ONWARD  
SUITS ALL MODELS WITH 5 SEATS (NOT SUITABLE FOR 7 SEAT MODELS)



### INSTALLATION OF CARGO BARRIER 'Behind 2nd row of seats'

1. Assemble shouldered nut (Item 11) to 39mm Milbolt (Item 9) as shown.
2. Remove cargo blind if installed.
3. With the rating label on the RH side of the cargo barrier and facing the rear of the vehicle position barrier behind the second row of seats.  
**Hint:** Lay the 2nd row seat backs down to allow sufficient room to manoeuvre the cargo barrier into position.
4. Attach top straps to rear grab handle brackets using 39mm Milbolt ASM with wave washer (Item 12) under shouldered nut.  
**Note:** Some manipulation of the straps may be required to allow the straps and brackets to mate together correctly.
5. Attach bottom straps to floor mounts using 39mm Milbolts (Item 9) with wave washers (Item 12) under heads.
6. Tighten all Milbolts & reinstall cargo blind.
7. Push 2nd row seat backs back into position.

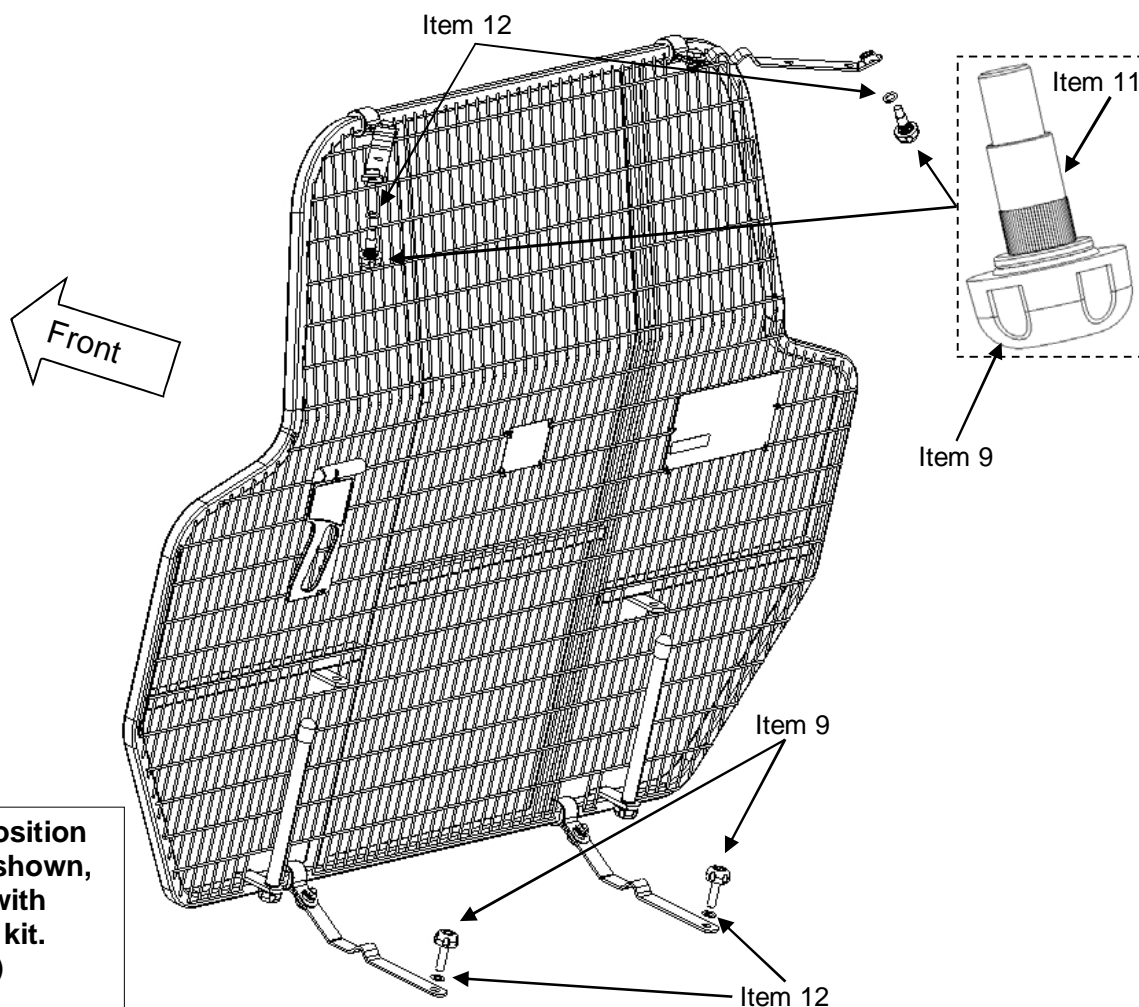

**Note: Front position support legs shown, are supplied with front position kit. (Refer page 1)**



**IMPORTANT NOTE: Check that all bolts and screws are tight and re check periodically.**