



## TOYOTA COROLLA HATCHBACK CARGO BARRIER INSTALLATION INSTRUCTION Part # 609750

VEHICLE YEARS OF MANUFACTURE - FROM OCT 2012 TO JUNE 2018



This cargo barrier is capable of being located in two positions\*, behind the 2nd row of seats with the seats in an upright position, and behind the 1st row of seats\* with the 2nd row of seats in their folded position. The installation kit contains sufficient components for fitment in rear position only. A high degree of technical competence is necessary to correctly install this product.

We recommend this cargo barrier be installed by an authorised outlet to ensure the barrier installation complies with AS/NZS 4034 Standard.

The cargo barrier is designed, manufactured and fitted to decrease the impact hazard in an accident to occupants from cargo carried within the interior cargo space of the vehicle. In the event of an accident, a cargo barrier can reduce injuries caused by cargo intruding into occupant's space.

\*For installation in the behind 1st row seats position, front position kit P/N 609752 (sold separately) is required.

**Note: There is a danger of entrapment if rear cargo shelf is installed with cargo barrier. Cargo barrier does not comply with AS4034 if cargo shelf is installed.**

"The estimated fitting time is based on an experienced fitter conversant with the fitment procedure"

**Installation time approximately 0.75 Hour**



### WARNINGS

- Strict compliance with fitting instructions is essential for this safety product to meet its rated capacity. Refer user instructions regarding correct usage of the cargo barrier.
- Do not modify cargo barrier in any way.
- Do not use this cargo barrier in any other vehicle for which it is not designed.
- Modifications to the cargo barrier or its fixings or use in any other vehicle for which it is not designed may void the load rating and warranty.
- Do not attach the cargo barrier to the vehicle using seat, seat belt or child restraint anchorage's.
- Where high tensile threaded fasteners are used, the cargo barrier must be installed using the size and grade fasteners specified by Milford Industries.
- Do not drill, rivet, adhere or attach objects to the front or rear of the cargo barrier.
- Do not place smaller items, that may bypass the cargo barrier in the event of heavy braking or collision, near the edges of the barrier.
- Position the load against the cargo barrier.
- When load is positioned against cargo barrier, secure the load with a restraint system.
- During a collision moving cargo may damage seat belts or tether straps of a child restraint device, or its anchorage. Load should be carefully positioned so as not to come in contact with these items.
- Do not obstruct seat belts or child restraints, or their operation.
- Long thin items of cargo should be positioned in the vehicle with the long axis across the vehicle to minimise the penetration risk.
- If involved in an accident or accidentally damaged, the cargo barrier should be replaced and the anchorage's repaired to as new condition.
- Clean with soap and water only. Do not use solvents or chemicals. Discard cargo barrier if it becomes rusted. Do not expose to direct sunlight for long periods.
- It is extremely dangerous to ride in the cargo area of the vehicle behind the cargo barrier. It is recommended that the cargo barrier be removed. In a collision people or children riding unrestrained in these areas are more likely to be seriously injured or killed.
- Never leave a child in the vehicle unattended, particularly in the rear cargo area. The cargo area should never be used as a play area for children.
- The cargo barrier may deform and significantly intrude into occupant's space in an accident.
- Remember that the tailgate cannot be opened from inside the cargo area.
- The fixed labeling should not be removed from the cargo barrier.
- Failure to comply with warning notes may prevent the barrier protecting the occupants.
- Parents should explain to children how and when to use **EMERGENCY ESCAPE HAMMER** attached to cargo barrier.
- Do not remove the rating plaque from the cargo barrier.

#### NOTICE TO INSTALLERS & DISTRIBUTORS

**Please ensure User Instructions are left with vehicle owner after installation.**



# TOYOTA COROLLA HATCHBACK CARGO BARRIER INSTALLATION INSTRUCTION

**Part # 609750**

VEHICLE YEARS OF MANUFACTURE - FROM OCT 2012 TO JUNE 2018



**IMPORTANT:** The installation kit contains sufficient components to fit the cargo barrier. A high degree of technical competence is necessary to correctly install this product. We recommend this cargo barrier be installed by an authorised outlet to ensure the barrier installation is correct. These instructions must be read and clearly understood before commencing installation. Check contents of kit before commencing fitment and report any discrepancies or damage.

## Parts List

Item	Component Name	Part No.	Qty
1	Cargo Barrier ASM (see page 8)	609750	1
2	Bracket ASM PC (bottom mounts)	753296	2
3	Bracket ASM PC (LHS top mount)	753464	1
4	Bracket ASM PC (RHS top mount)	753462	1
5	Screw—Button Head M6 x 1.0 x 20mm ZP	912981	2
6	Milbolt—M10 x 1.5 x 19mm	912820	2
7	Milbolt—M10 x 1.5 x 24mm	912825	2
8	Wave Washer—10mm ZP	932125	4
9	Marking Pin (M10)	906185	1
10	Warning Label (Orange)	905017	1
11	Threaded Hex Spacer ZP	753042	4
12	Screw—Button Head M8 x 1.25 x 16mm ZP	913140	4
13	Trim plug - Base	753075	2
14	Trim plug - Insert	753077	2

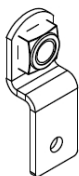

2

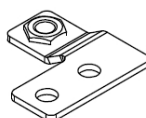

3

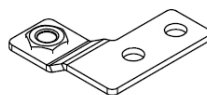

4



5



6



7



8



9

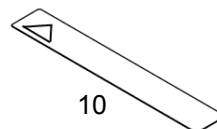

10



11



12

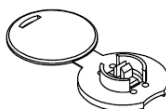

13



14

**E and OE—Errors and Omissions Excepted**

## **TOYOTA COROLLA HATCHBACK CARGO BARRIER INSTALLATION INSTRUCTION**

**Part # 609750**

VEHICLE YEARS OF MANUFACTURE - FROM OCT 2012 TO JUNE 2018



### **ADVICE TO FITTER**

**Note:** To fit the cargo barrier the following is essential: (where applicable)

- ☐ Always drill perpendicular to surface (Unless stated otherwise).
- ☐ A positive drill stop should always be used to prevent accidental damage to external panels, fuel lines etc.
- ☐ Ensure Safety Eye Protection and Gloves are worn as required when using cutting tools.
- ☐ When cutting metal panels be very careful of sharp edges, for risk of skin cuts etc.
- ☐ Care should be taken when applying Rust Preventative sealer to all holes drilled, to negate the possibility of skin and eye irritation.
- ☐ Check screws in relevant components by hand before installation. Should there be resistance re-tap threads and re-check.
- ☐ **Before marking or drilling to install this cargo barrier, check vehicle for LPG conversion & non standard fuel tanks. Locate tanks and all lines attached and take EXTREME CARE not to damage whilst installing this cargo barrier.**
- ☐ **Before drilling to install this cargo barrier, check for concealed wiring looms. E.g. tow bar, reversing camera, reversing sensor wiring etc.. Relocate before drilling to avoid damage.**

**CARE SHOULD BE TAKEN NOT TO CROSS THREAD THE FASTENERS DURING  
INSTALLATION OF COMPONENTS TO THE VEHICLE.**

### **TOOLS REQUIRED**

- |  |                            |
|--|----------------------------|
| ◦ Socket wrench                              | ◦ Masking Tape             |
| ◦ Metric hex sockets                         | ◦ Marker                   |
| ◦ Metric spanners                            | ◦ 5mm Drill Bit            |
| ◦ 4mm,5mm A/F Hex drive bit & wrench adaptor | ◦ Drill stop               |
| ◦ Torque wrench (10Nm/22Nm)                  | ◦ Ø20mm Vinyl Cutter       |
| ◦ Trim removal tools                         | ◦ Vacuum Cleaner           |
| ◦ Power Drill                                | ◦ Cover sheet / Drop sheet |
| ◦ Small Flat Blade Screwdriver               | ◦ Clean Cloth              |



### INSTALLATION PROCEDURE FOR LOWER MOUNTS



1. Remove the cargo shelf. (Note: Cargo shelf cannot be reinstalled with the cargo barrier in the behind 2nd row seats position)
2. Remove the cargo area floor covering.



3. Locate the 'D' anchors at the sides of the cargo area.
4. Undo the screws securing the 'D' anchors to the vehicle.

**Note: Anchor screws will not be reused and should be discarded.**

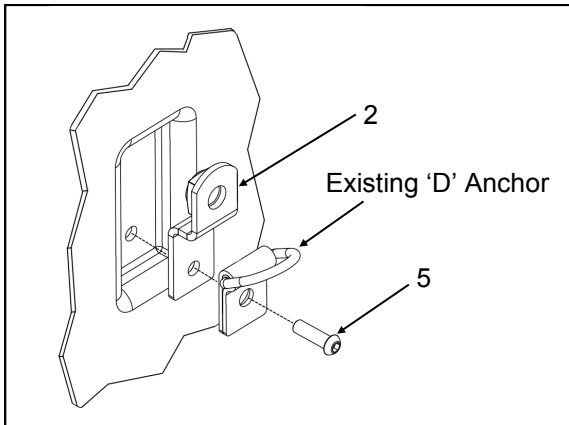

5. Place a bottom bracket assembly (2) over a 'D' anchor mounting point with the captive nut to the top as shown.
6. Place the 'D' anchor over the top of the bracket then secure the assembly in place using an M6 button head screw (5).
7. Repeat procedure on other side.

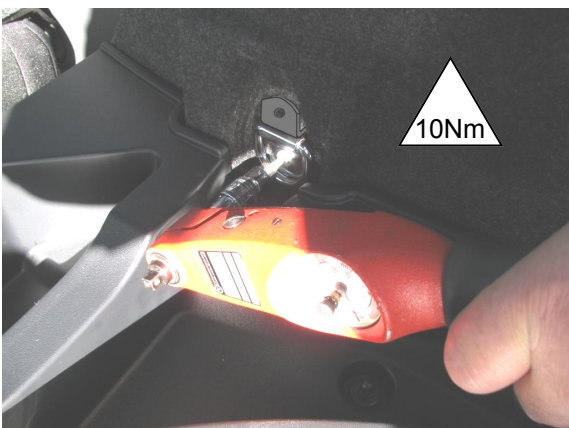

8. Tighten and torque up screws to 10Nm.

**Warning—Do not over tighten!**

9. Replace floor covering.





### INSTALLATION PROCEDURE FOR UPPER MOUNTS



10. At the top of the tailgate opening unfasten the rubber door seal.
11. Using a suitable trim removal tool carefully remove the trim clips securing the back of the roof lining in place.

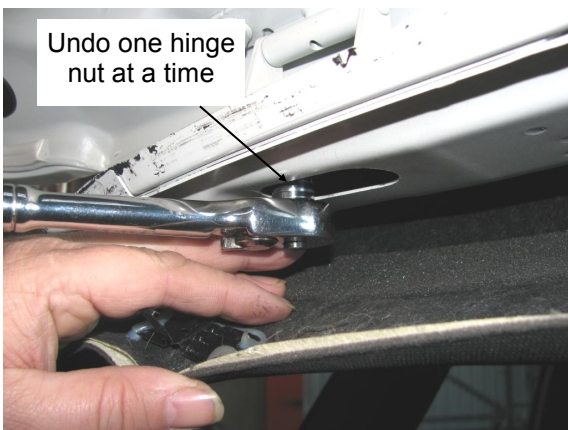

12. Whilst taking care not to stress damage the roof lining, pull the roof lining down far enough to access the LHS pair of tailgate hinge securing nuts.
13. Working on one hinge nut at a time remove a nut & discard.



**Warning—Avoid undoing more than one hex nut at a time.**

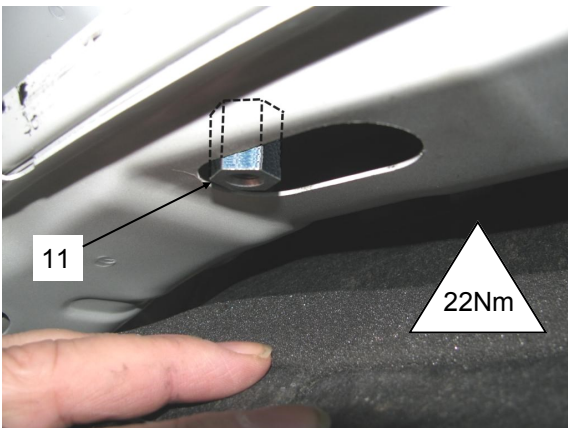

14. Replace the nut with a threaded spacer (11) from the kit.
15. Tighten and torque up the threaded spacer to 22Nm. (use 16mm AF socket)
16. Repeat this procedure for the other 3 hinge nuts.

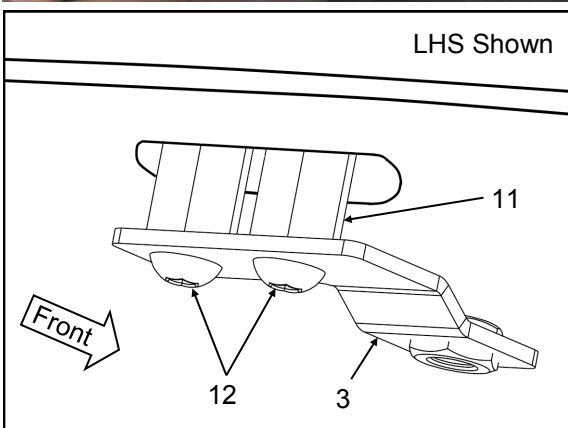

17. Place top LHS bracket ASM (3) over the LHS threaded spacers as shown.
18. Secure the bracket in place using button head screws (12).
19. Tighten and torque up screws to 22Nm.
20. Repeat on the RHS using bracket ASM (4).



### CUTTING ACCESS HOLES FOR UPPER MOUNTS

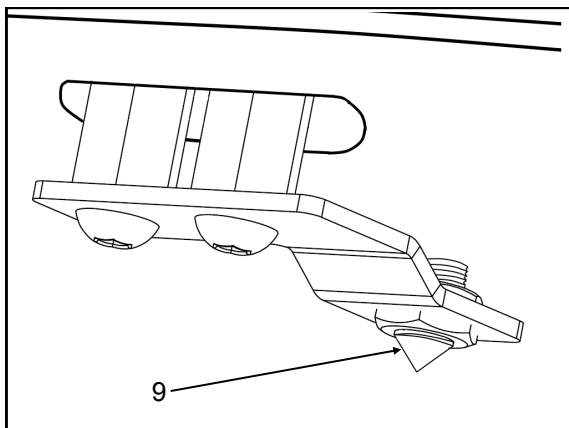

21. Screw marking pin (9) into the captive nut of an upper mounting bracket as shown, with just the point protruding.

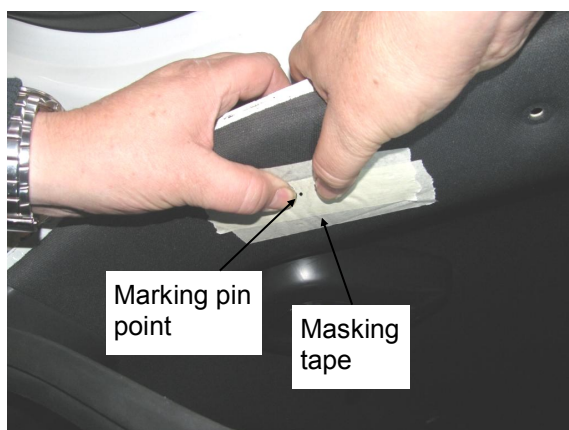

22. At the approximate location of marking pin, apply masking tape to inside surface of roof lining.
23. Carefully apply pressure to the roof lining at the marking pin location until the point pierces through the roof lining. Mark this location on masking tape if not very clear.
24. Move the marking pin to the other side then repeat procedure.

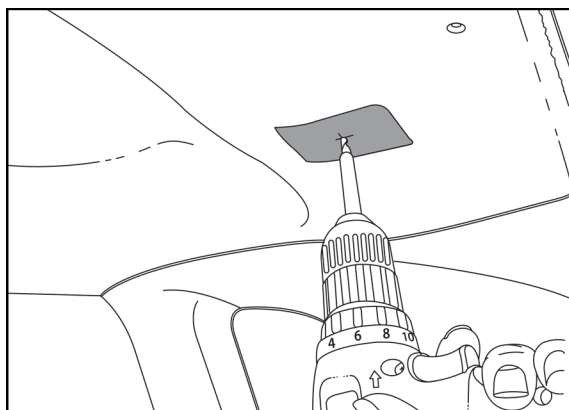

25. Using a 5mm drill bit with drill stop set at 10mm, carefully drill a pilot hole through the roof lining at each of the marked locations from steps 21/22.

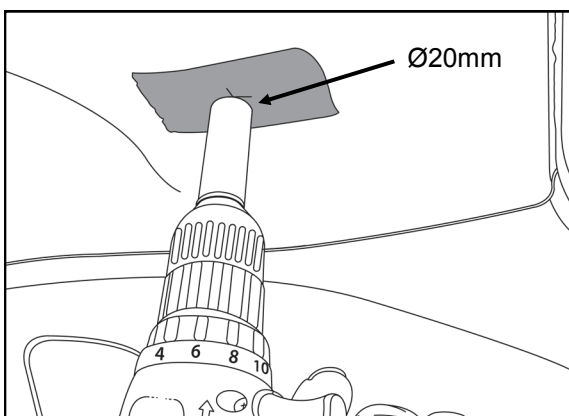
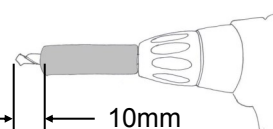

26. Using a Ø20mm vinyl cutter, carefully enlarge each of the pilot holes from step 23.
27. Remove masking tape.
28. Vacuum away any cutting dust.



### INSTALLATION OF TRIM PLUGS IN ROOF

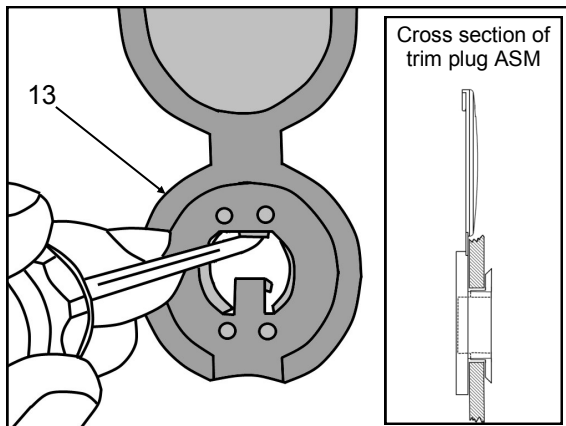

29. Push a trim garnish (13) into a cut hole in the roof lining with the lid facing forwards.
30. Using a small screwdriver push the securing legs outwards behind the roof lining.

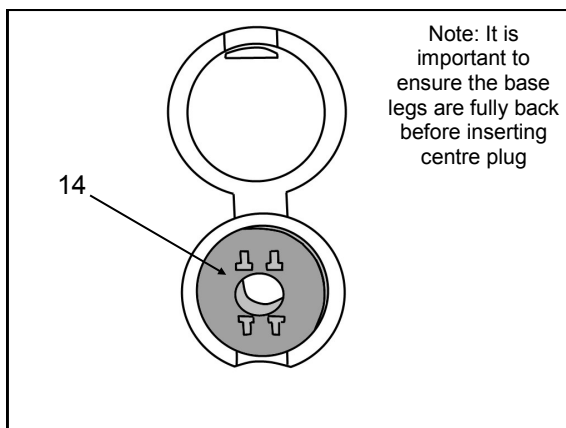

31. With trim garnish securing legs pushed outwards, insert the garnish spacer (14) into the centre. Push the spacer until it clips in place.
32. Repeat steps 29 to 31 on other side.



33. Clip the roof lining back in place.
34. Re attach the rear door seal.

# TOYOTA COROLLA HATCHBACK CARGO BARRIER INSTALLATION INSTRUCTION

Part # 609750

VEHICLE YEARS OF MANUFACTURE - FROM OCT 2012 TO JUNE 2018



## AFFIXING OF WARNING LABEL



Item 10

35. Clean the area inside drivers door opening as shown using clean cloth.
36. Affix orange warning label (10) at that location as shown.

**Please ensure User Instructions are left with vehicle owner after installation.**

## INSTALLATION OF CARGO BARRIER 'Behind 2nd row of seats'

1. Remove cargo shelf if installed. *Cargo shelf should not be used when cargo barrier is in the behind 2nd row seats position.*
2. Pivot attaching straps towards the meshed side of the cargo barrier.
3. Position cargo barrier behind 2nd row seats with the rating label (meshed side of cargo barrier) facing the rear of the vehicle.
4. Attach top straps to upper mounts using 24mm Milbolts (7) with wave washers (8) under heads.
5. Attach bottom straps to lower mounts using 19mm Milbolts (6) with wave washers (8) under heads.
6. Tighten all Milbolts.

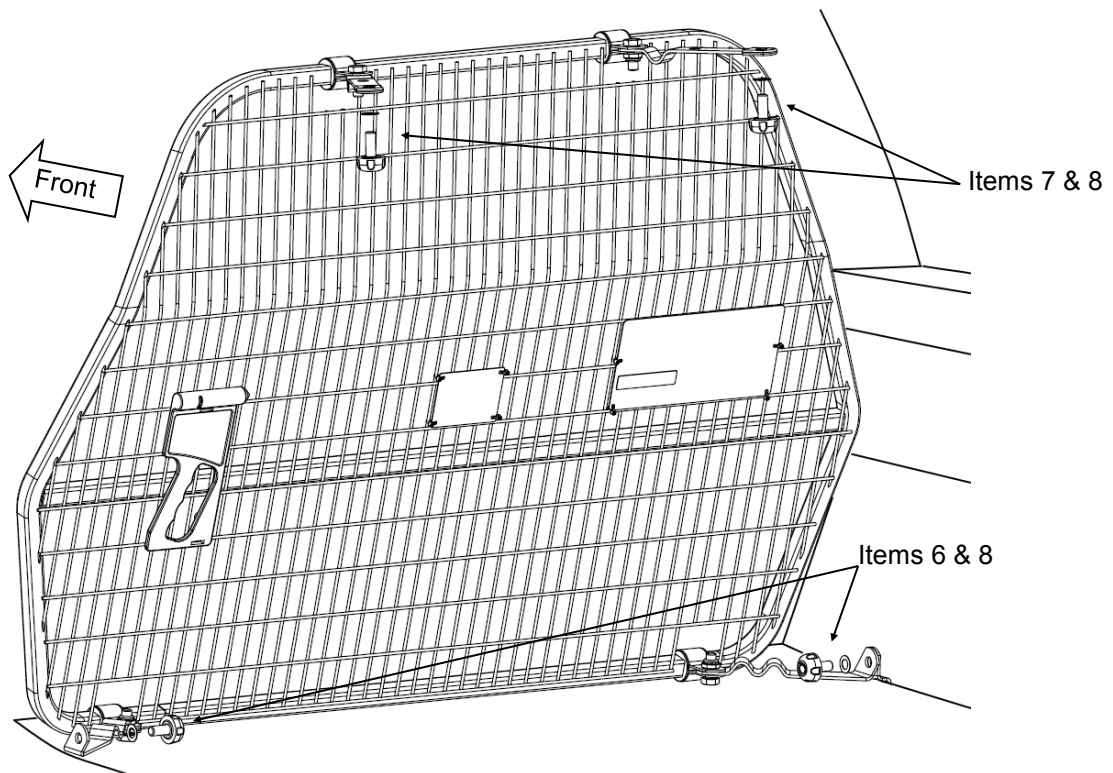

**IMPORTANT NOTE: Check that all bolts and screws are tight and re check periodically.**