



# TOYOTA COROLLA HATCHBACK CARGO BARRIER INSTALLATION INSTRUCTION Part # 607200

VEHICLE YEARS OF MANUFACTURE - FROM JUNE 2018



This cargo barrier is capable of being located in two positions\*, behind the 2nd row of seats with the seats in an upright position, and behind the 1st row of seats\* with the 2nd row of seats in their folded position. The installation kit contains sufficient components for fitment in rear position only. A high degree of technical competence is necessary to correctly install this product.

We recommend this cargo barrier be installed by an authorised outlet to ensure the barrier installation complies with AS/NZS 4034 Standard.

The cargo barrier is designed, manufactured and fitted to decrease the impact hazard in an accident to occupants from cargo carried within the interior cargo space of the vehicle. In the event of an accident, a cargo barrier can reduce injuries caused by cargo intruding into occupant's space.

\*For installation in the behind 1st row seats position, front position kit P/N 607202 (sold separately) is required.

**Note: There is a danger of entrapment if rear cargo shelf is installed with cargo barrier. Cargo barrier does not comply with AS4034 if cargo shelf is installed.**

"The estimated fitting time is based on an experienced fitter conversant with the fitment procedure"

**Installation time approximately 0.75 Hour**



## WARNINGS

- Strict compliance with fitting instructions is essential for this safety product to meet its rated capacity. Refer user instructions regarding correct usage of the cargo barrier.
- Do not modify cargo barrier in any way.
- Do not use this cargo barrier in any other vehicle for which it is not designed.
- Modifications to the cargo barrier or its fixings or use in any other vehicle for which it is not designed may void the load rating and warranty.
- Do not attach the cargo barrier to the vehicle using seat, seat belt or child restraint anchorage's.
- Where high tensile threaded fasteners are used, the cargo barrier must be installed using the size and grade fasteners specified by Milford Industries.
- Do not drill, rivet, adhere or attach objects to the front or rear of the cargo barrier.
- Do not place smaller items, that may bypass the cargo barrier in the event of heavy braking or collision, near the edges of the barrier.
- Position the load against the cargo barrier.
- When load is positioned against cargo barrier, secure the load with a restraint system.
- During a collision moving cargo may damage seat belts or tether straps of a child restraint device, or its anchorage. Load should be carefully positioned so as not to come in contact with these items.
- Do not obstruct seat belts or child restraints, or their operation.
- Long thin items of cargo should be positioned in the vehicle with the long axis across the vehicle to minimise the penetration risk.
- If involved in an accident or accidentally damaged, the cargo barrier should be replaced and the anchorage's repaired to as new condition.
- Clean with soap and water only. Do not use solvents or chemicals. Discard cargo barrier if it becomes rusted. Do not expose to direct sunlight for long periods.
- It is extremely dangerous to ride in the cargo area of the vehicle behind the cargo barrier. It is recommended that the cargo barrier be removed. In a collision people or children riding unrestrained in these areas are more likely to be seriously injured or killed.
- Never leave a child in the vehicle unattended, particularly in the rear cargo area. The cargo area should never be used as a play area for children.
- The cargo barrier may deform and significantly intrude into occupant's space in an accident.
- Remember that the tailgate cannot be opened from inside the cargo area.
- The fixed labeling should not be removed from the cargo barrier.
- Failure to comply with warning notes may prevent the barrier protecting the occupants.
- Parents should explain to children how and when to use **EMERGENCY ESCAPE HAMMER** attached to cargo barrier.
- Do not remove the rating plaque from the cargo barrier.

## NOTICE TO INSTALLERS & DISTRIBUTORS

**Please ensure User Instructions are left with vehicle owner after installation.**

# TOYOTA COROLLA HATCHBACK CARGO BARRIER INSTALLATION INSTRUCTION

**Part # 607200**

VEHICLE YEARS OF MANUFACTURE - FROM JUNE 2018



**IMPORTANT:** The installation kit contains sufficient components to fit the cargo barrier. A high degree of technical competence is necessary to correctly install this product. We recommend this cargo barrier be installed by an authorised outlet to ensure the barrier installation is correct. These instructions must be read and clearly understood before commencing installation. Check contents of kit before commencing fitment and report any discrepancies or damage.

## Parts List

Item	Component Name	Part No.	Qty
1	Cargo Barrier ASM (see page 15)	607200	1
2	Bush—Pivot Saddle	752680	4
3	Pivot Saddle	752700	4
4	Nut - Hex Head Nyloc M10	922090	4
5	Bolt - Hex Head M10 x 1.5 x 20	912205	6
6	Versa Nut M8 x 1.25	922290	4
7	Mounting Plate	754000	2
8	Screw - Hex Head 5/16" x 1	912125	4
9	Screw - Button Head M8 x 30	913137	4
10	Milbolt - M10 x 1.5 x 34mm	912835	2
11	Milbolt - M10 x 1.5 x 19mm	912820	2
12	Trim Garnish - Base With Lid (Black)	753095	2
13	Trim Garnish—Insert (Black)	753097	2
14	Washer - Crinkle 3/8"	932125	4
15	Marking Pin	906185	1
16	Rust Preventative Sealer	906300	1
17	Top Strap	776041	2
18	LHS Top Bracket ASM	753814	1
19	RHS Top Bracket ASM	753812	1
20	Bottom Left Strap	776034	1
21	Bottom Right Strap	776033	1
22	LHS Bottom Bracket ASM	753803	1
23	RHS Bottom Bracket ASM	753805	1
24	Installation Tool	754200	1
25	Flat Washer 8mm	932280	6

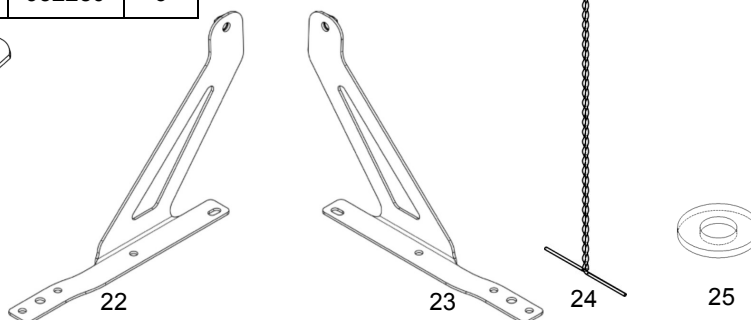
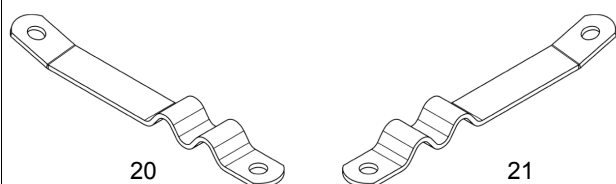
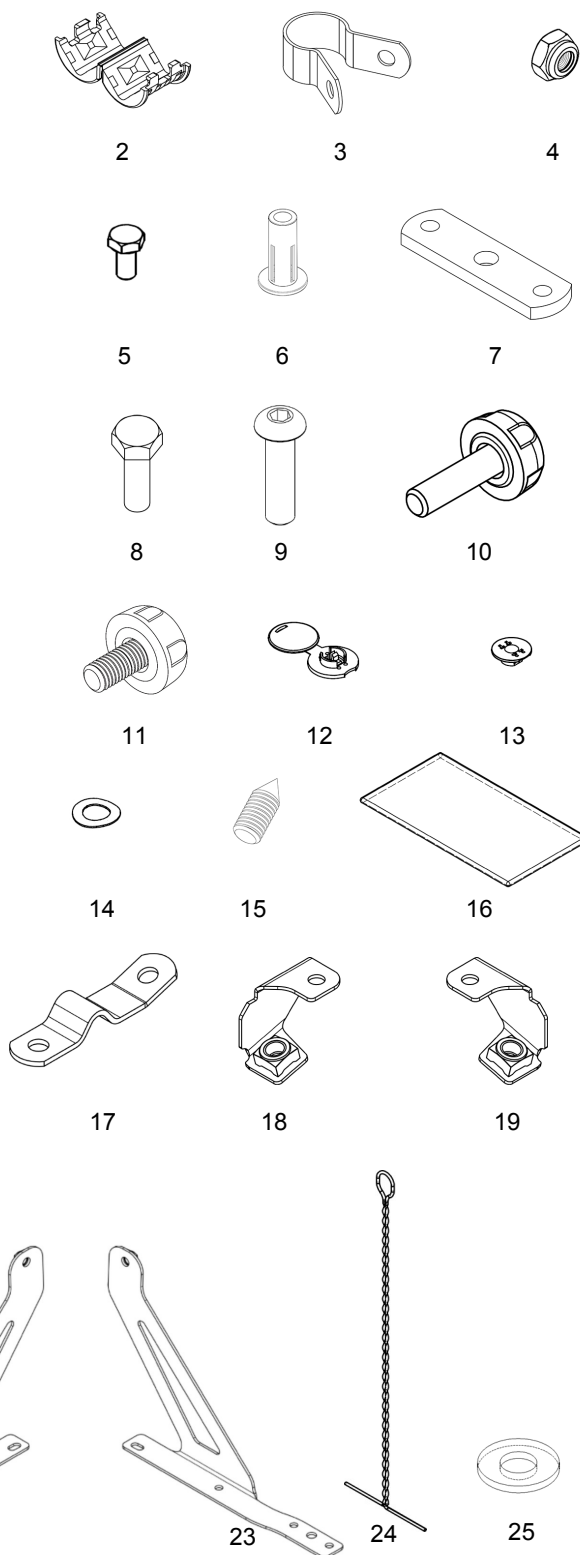



## ADVICE TO FITTER

**Note:** To fit the cargo barrier the following is essential: (where applicable)

- ☐ Always drill perpendicular to surface (Unless stated otherwise).
- ☐ A positive drill stop should always be used to prevent accidental damage to external panels, fuel lines etc.
- ☐ Ensure Safety Eye Protection and Gloves are worn as required when using cutting tools.
- ☐ When cutting metal panels be very careful of sharp edges, for risk of skin cuts etc.
- ☐ Care should be taken when applying Rust Preventative sealer to all holes drilled, to negate the possibility of skin and eye irritation.
- ☐ Check screws in relevant components by hand before installation. Should there be resistance re-tap threads and re-check.
- ☐ **Before marking or drilling to install this cargo barrier, check vehicle for LPG conversion & non standard fuel tanks. Locate tanks and all lines attached and take EXTREME CARE not to damage whilst installing this cargo barrier.**
- ☐ **Before drilling to install this cargo barrier, check for concealed wiring looms. E.g. tow bar, reversing camera, reversing sensor wiring etc.. Relocate before drilling to avoid damage.**

**CARE SHOULD BE TAKEN NOT TO CROSS THREAD THE FASTENERS DURING  
INSTALLATION OF COMPONENTS TO THE VEHICLE.**

## TOOLS REQUIRED

- |                                |                            |
|--------------------------------|----------------------------|
| ◦ Socket Wrench                | ◦ Masking Tape             |
| ◦ Metric Hex Sockets           | ◦ Marker                   |
| ◦ Metric Spanners              | ◦ 5mm Drill Bit            |
| ◦ Torque Wrench (8Nm/22Nm)     | ◦ Drill Stop               |
| ◦ Trim Removal Tools           | ◦ Ø20mm Vinyl Cutter       |
| ◦ Power Drill                  | ◦ Cover Sheet / Drop Sheet |
| ◦ Small Flat Blade Screwdriver | ◦ Clean Cloth              |
| ◦ Centre Punch                 | ◦ Multi Tool               |
| ◦ Hammer                       | ◦ Sharp Knife              |
| ◦ Threaded Insert Tool         | ◦ 22mm Hole Saw            |
| ◦ Magnetic Pickup Tool         | ◦ 5mm Hex Drive            |
| ◦ Vacuum Cleaner               |                            |



## INSTALLATION PROCEDURE FOR LOWER MOUNTS



1. Remove the parcel shelf. (Note: Parcel shelf cannot be reinstalled with the cargo barrier in the behind 2nd row seats position)



2. Remove the cargo area floor covering.



3. Remove the trim plug securing the foam insert, then remove the foam insert.
4. Repeat on other side.

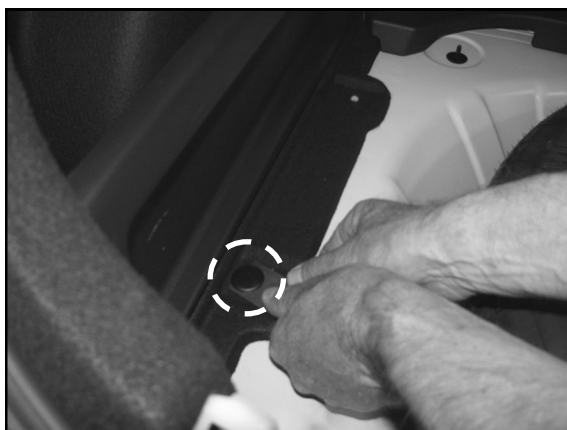

5. Remove the two trim plugs from the side trim.
6. Repeat on other side.



## INSTALLATION PROCEDURE FOR BOTTOM MOUNTS

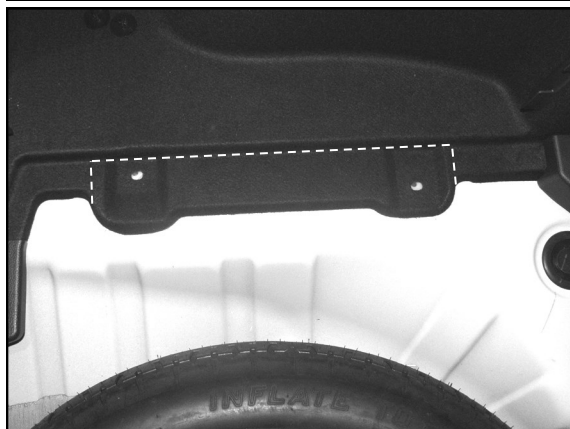

7. Mark out the bottom of the side trim as shown.
8. Using a suitable tool, cut and remove the trim.



9. Position the correct bottom bracket ASM in the cut out, with the forwardmost hole and the second rearmost hole over the plastic plug centres.
10. Mark out the three remaining hole positions.
11. Lift bracket away to allow access to the marked locations. Repeat on the other side.

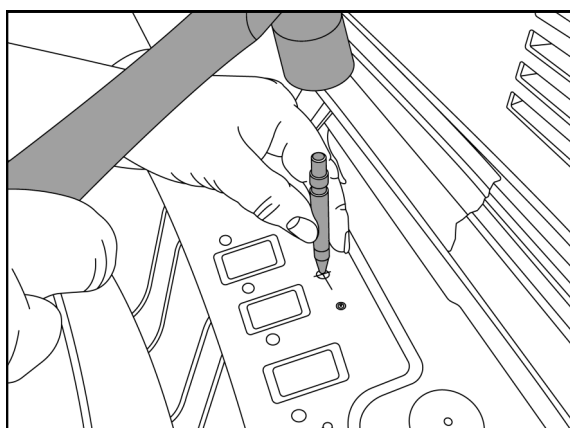

12. Centre punch the six marked hole positions.

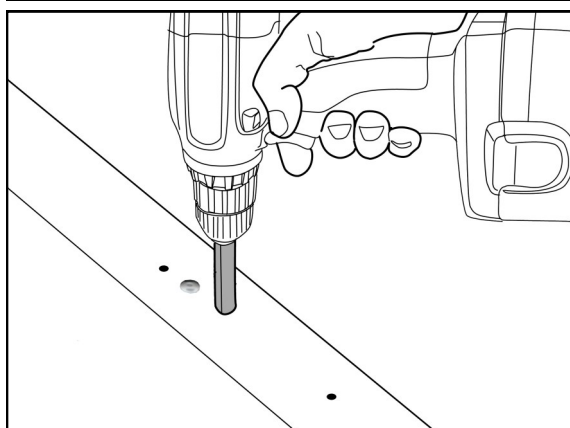

13. Using a 5mm drill bit with the drill stop set at 10mm, carefully drill a pilot hole through the metal floor panel in the six marked locations.

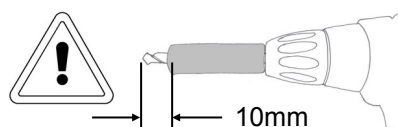

# TOYOTA COROLLA HATCHBACK CARGO BARRIER INSTALLATION INSTRUCTION

Part # 607200

VEHICLE YEARS OF MANUFACTURE - FROM JUNE 2018

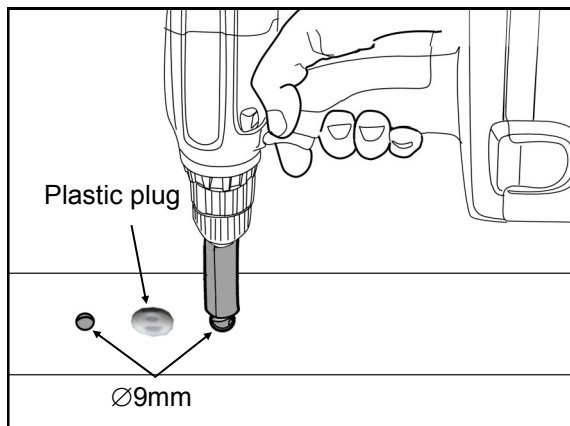

14. Using a 9mm drill bit with the drill stop set at 10mm, carefully enlarge the rearmost and third rearmost holes.

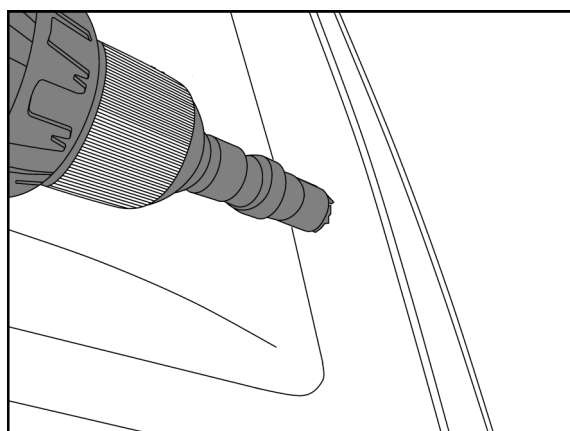
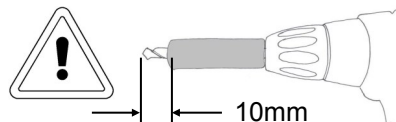

15. Using a 22mm hole saw, cut out the rearmost plastic plug and metal floor panel underneath.

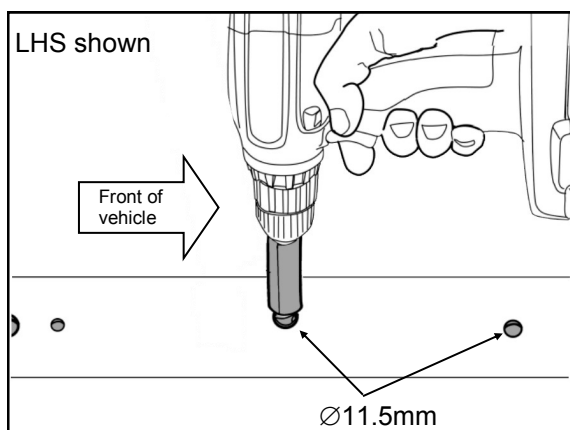

16. Using a 11.5mm drill bit, drill out the front plastic plug and enlarge the middle hole.
17. Vacuum away the drilling swarf.

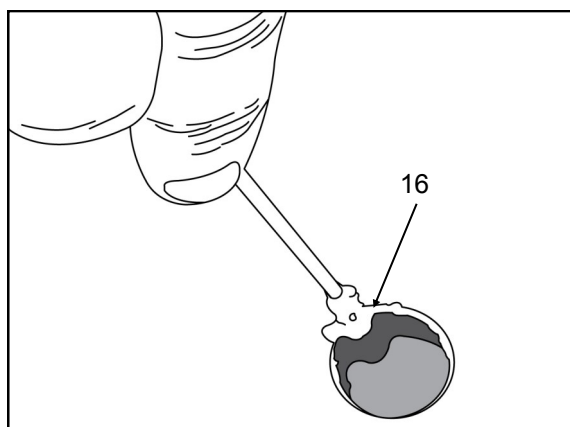

18. Apply rust preventative sealer (16) to the drilled holes.



# TOYOTA COROLLA HATCHBACK CARGO BARRIER INSTALLATION INSTRUCTION

**Part # 607200**

VEHICLE YEARS OF MANUFACTURE - FROM JUNE 2018

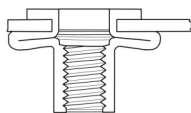
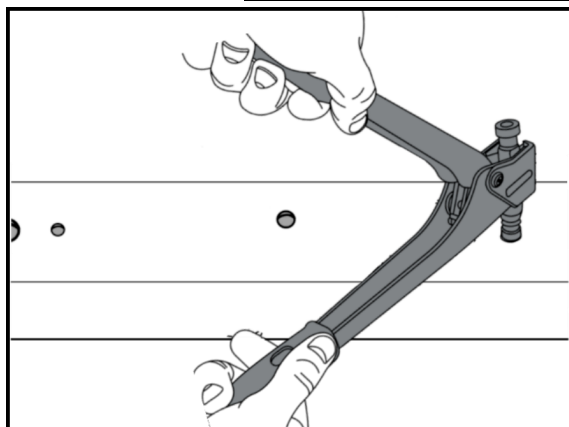

Cross section  
of threaded  
insert pulled up

19. Screw a versa nut (6) onto a suitable versa nut tool.
20. Fit versa nuts into the two forwardmost holes.

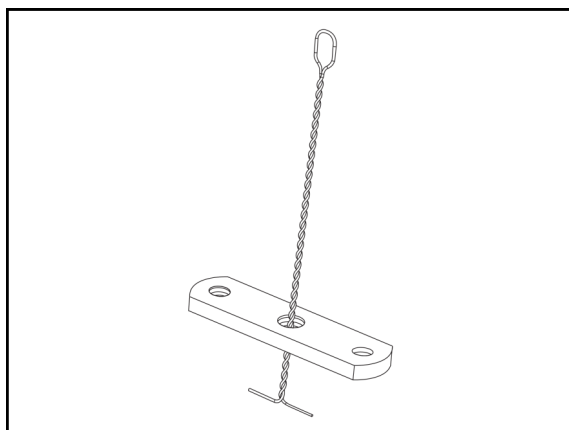

21. Place a mounting plate (7) over an installation tool (24) as shown.

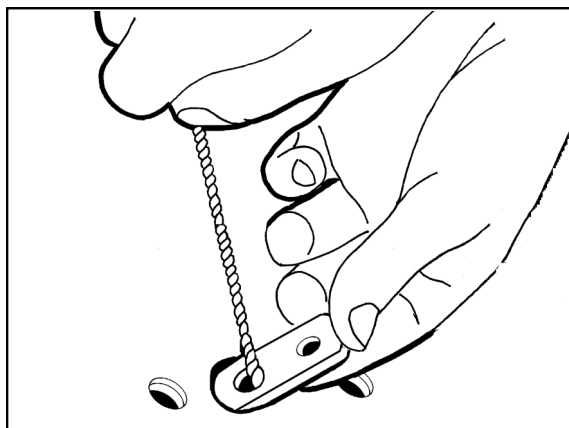

22. Whilst keeping hold of the installation tool, pushing the mounting plate through the 22mm hole in the floor panel.

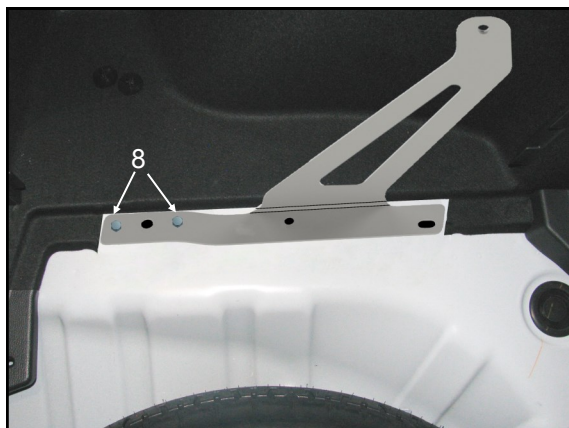

23. Place the bottom bracket ASM in position with the second to rearmost hole over the installation tool, and then loosely secure hex head screws (8) through the bracket and into the mounting plate.
24. Pull the installation tool upwards and remove it from the hole.

# TOYOTA COROLLA HATCHBACK CARGO BARRIER INSTALLATION INSTRUCTION

Part # 607200

VEHICLE YEARS OF MANUFACTURE - FROM JUNE 2018

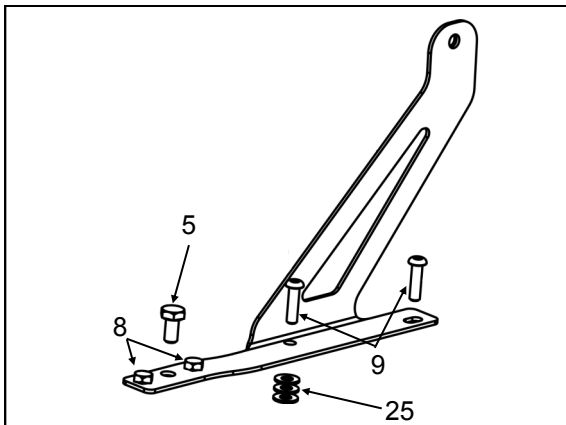

22Nm

8Nm

25. Place three flat washers (25) underneath the middle hole, then secure in place with a button head screw (9) as shown.
26. Place a button head screw (9) through the bottom bracket ASM in the forwardmost hole.
27. Place a hex head bolt (5) through the final hole.
28. With all screws in place, torque up the bolt (5) and screws (9) to 22Nm.
29. Torque up the screw (8) to 8Nm.

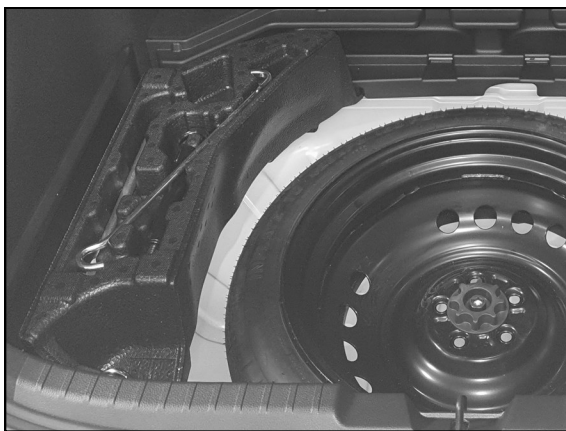

30. Replace the foam insert and the trim plugs.



31. Replace the cargo area floor covering.





### INSTALLATION OF THE UPPER MOUNTS

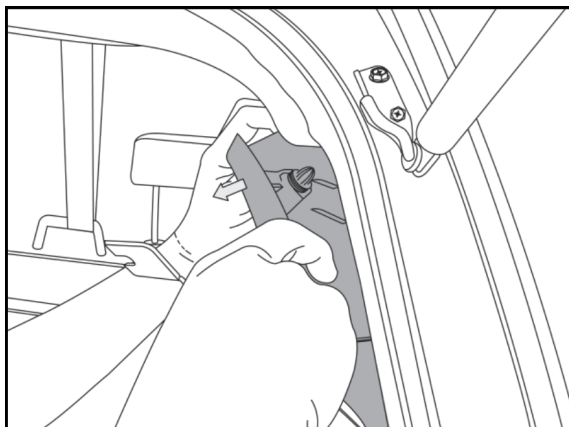

32. Place a drop sheet over the cargo area to protect the trim.
33. With the aid of a trim removal tool, carefully unclip the back and top edge of the rear inner 1/4 trims. Both sides.

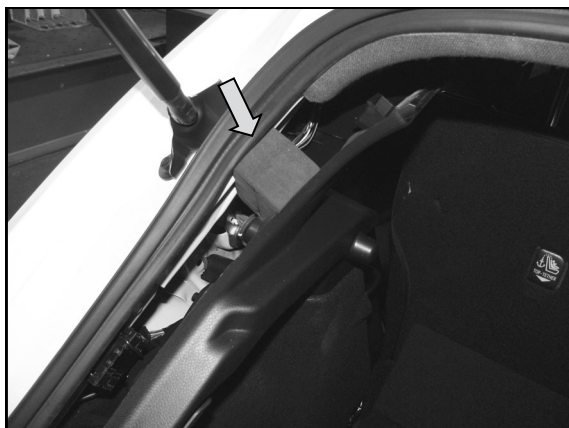

34. Use a suitable soft wedge to support the trim away from the panel, to allow the roof lining to be moved down. Both sides.



35. At the top of the tailgate opening unfasten the rubber door seal.
36. Using a suitable trim removal tool carefully remove the trim clips securing the back of the roof lining in place.

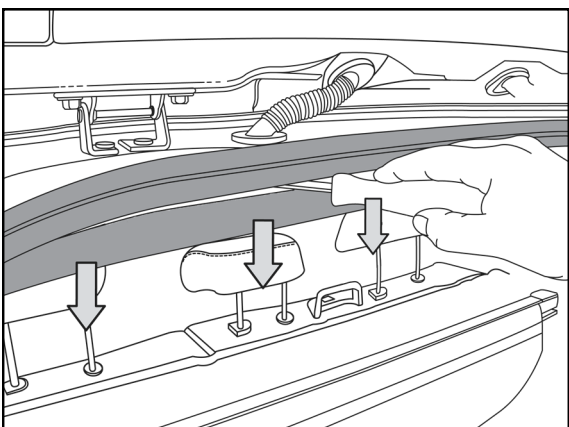

37. Whilst taking care not to stress damage the roof lining, pull the roof lining down far enough to access the LHS tailgate hinge securing nuts.

# TOYOTA COROLLA HATCHBACK CARGO BARRIER INSTALLATION INSTRUCTION

Part # 607200

VEHICLE YEARS OF MANUFACTURE - FROM JUNE 2018



38. Remove the nut on the inner side of the vehicle.

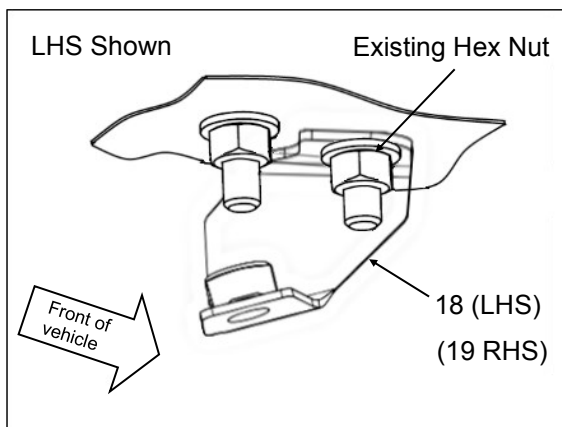

39. Place the top LHS bracket ASM (18) over the vacant tailgate hinge stud as shown, then replace the nut.
40. Tighten and torque up the hinge nut to 22Nm.
41. Repeat steps 36 to 38 on the other side.

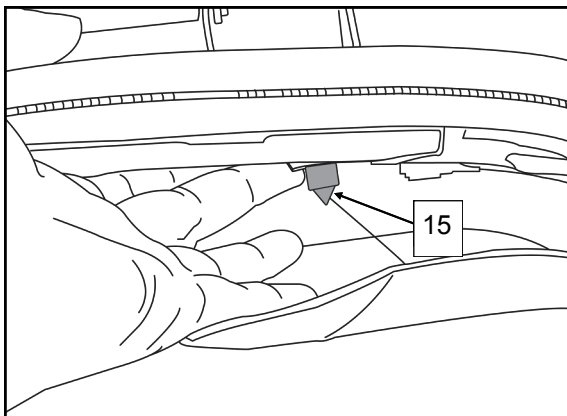

42. Screw a marking pin (15) into the captive nut in roof brackets with just the point protruding on one side.

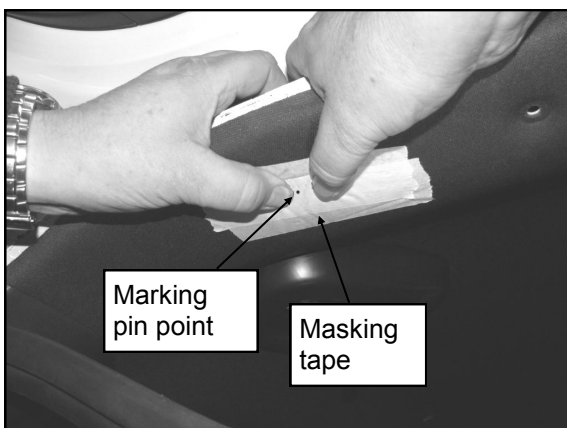

43. At the approximate location of the marking pin, apply masking tape to the inside surface of the roof lining.
44. Carefully apply pressure to the roof lining at the marking pin location until the point pierces through the roof lining. Mark this location on masking tape if not very clear.
45. Move the marking pin to the other side then repeat procedure.

# TOYOTA COROLLA HATCHBACK CARGO BARRIER INSTALLATION INSTRUCTION

Part # 607200

VEHICLE YEARS OF MANUFACTURE - FROM JUNE 2018

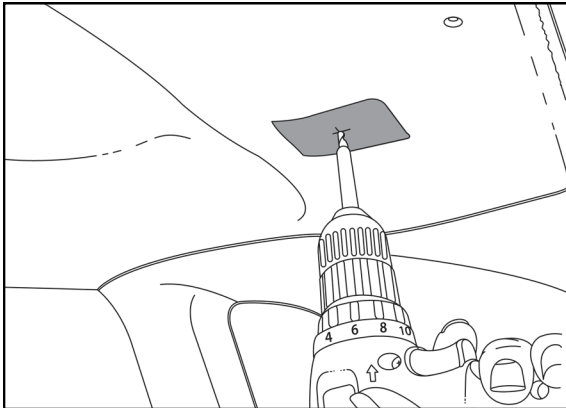

46. Using a 5mm drill bit with the drill stop set as 10mm, carefully drill a pilot hole through the roof lining at each of the marked locations from step 42.

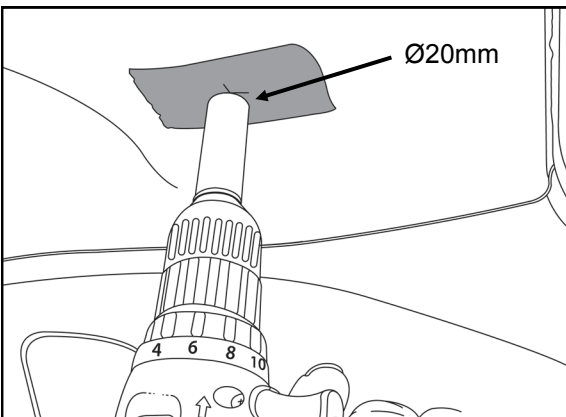
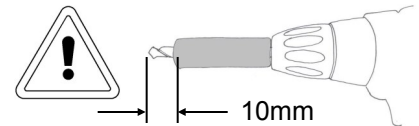

47. Using a Ø20mm vinyl cutter, carefully enlarge each of the pilot holes from step above.
48. Remove the masking tape.
49. Vacuum away any cutting dust.

## INSTALLATION OF TRIM PLUGS IN ROOF

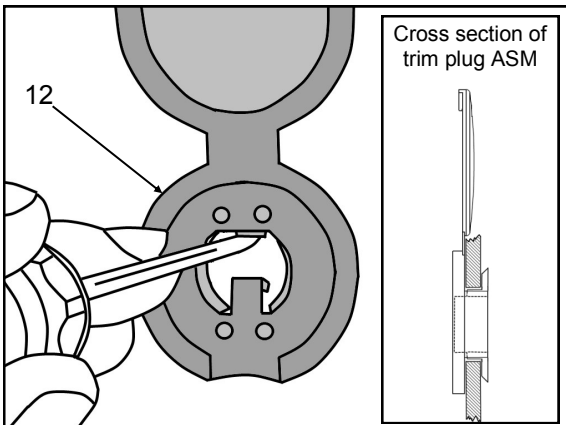

50. Push a trim garnish (12) into a cut hole in the roof lining with the lid facing forwards.
51. Using a small screwdriver push the securing legs outwards behind the roof lining.

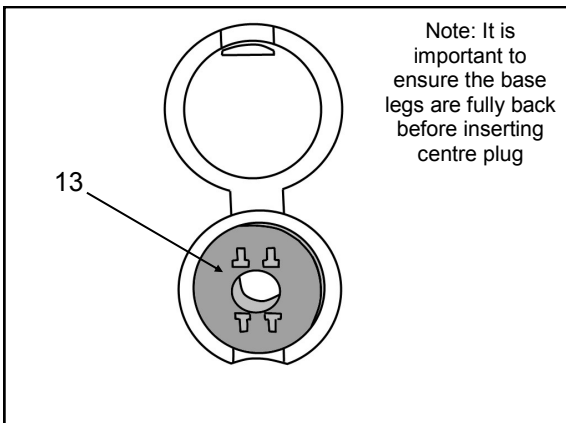

52. With the trim garnish securing legs pushed outwards, insert the garnish spacer (13) into the centre. Push the spacer until it clips in place.
53. Repeat above steps on the other side.



## TOYOTA COROLLA HATCHBACK CARGO BARRIER INSTALLATION INSTRUCTION

Part # 607200

VEHICLE YEARS OF MANUFACTURE - FROM JUNE 2018



54. Clip the roof lining and side trims back in place.

### AFFIXING OF WARNING LABEL



55. Reattach the rear door seal.
56. Clean the area inside drivers door opening as shown using a clean cloth.
57. Affix orange warning label at the location shown.

***Please ensure User Instructions are left with vehicle owner after installation.***

# TOYOTA COROLLA HATCHBACK CARGO BARRIER INSTALLATION INSTRUCTION

Part # 607200

VEHICLE YEARS OF MANUFACTURE - FROM JUNE 2018



## ASSEMBLE STRAPS TO TOP OF CARGO BARRIER

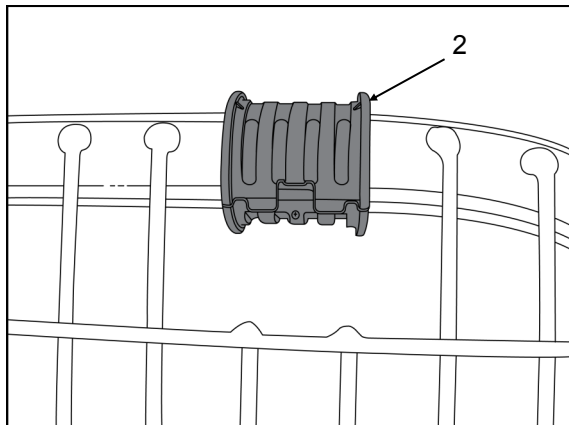

*Note: Refer to page 15 for detail of correct strap locations and orientation.*

58. At each of the cut outs in the mesh on the perimeter at the top sides of the cargo barrier, place a pivot saddle bush (2) as shown.

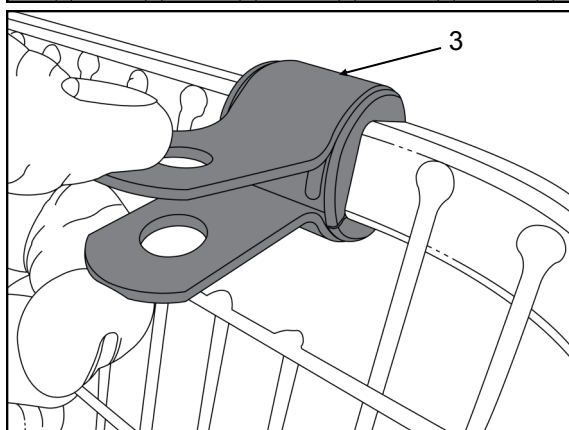

59. Place a pivot saddle (3) over each of the pivot saddle bushes then push the ends together.

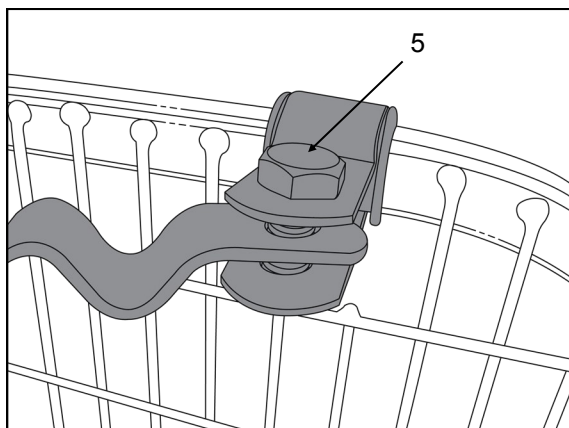

60. Place a strap (17) in between the pivot saddle ends then place a hex screw (5) through the saddle and strap.

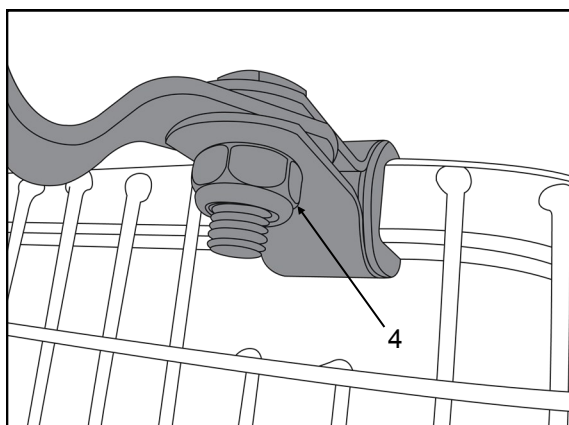

61. Place a nyloc hex nut (4) onto each of the hex screws then tighten until the strap is firm in saddle but can still be pivoted.





### ASSEMBLE STRAPS TO BOTTOM OF CARGO BARRIER

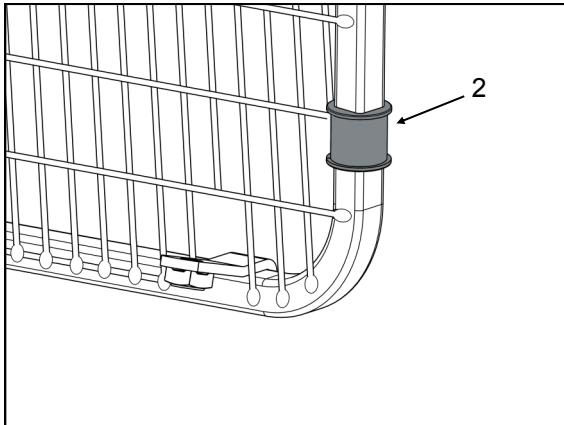

*Note: Refer to page 15 for detail of correct strap locations and orientation.*

62. At each of the cut outs in the mesh on the perimeter at the lower sides of the cargo barrier, place a pivot saddle bush (2) as shown.

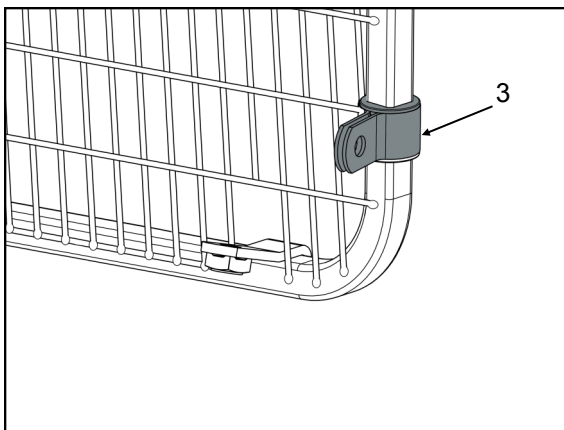

63. Place a pivot saddle (3) over each of the pivot saddle bushes then push the ends together.

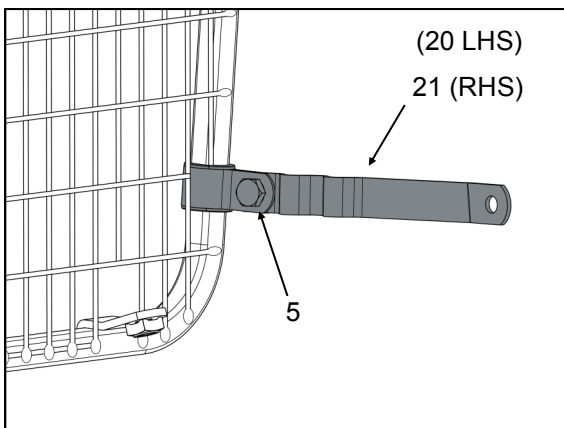

64. Place the correct strap in between the pivot saddle ends then place a hex screw (5) through the saddle and strap.

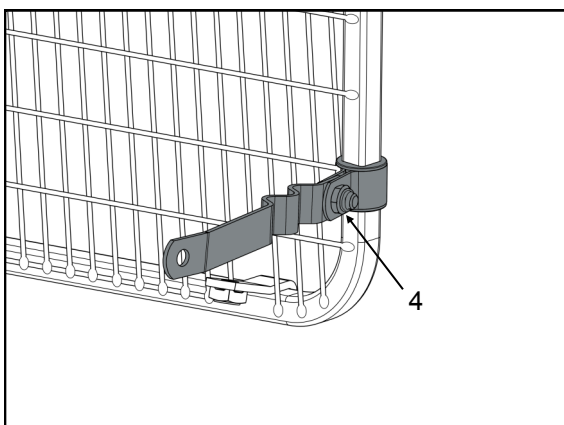

65. Place a nyloc hex nut (4) onto each of the hex screws then tighten until the strap is firm in saddle but can still be pivoted.

## TOYOTA COROLLA HATCHBACK CARGO BARRIER INSTALLATION INSTRUCTION

Part # 607200

VEHICLE YEARS OF MANUFACTURE - FROM JUNE 2018



### INSTALLATION OF CARGO BARRIER 'Behind 2nd row of seats'

1. Remove cargo shelf if installed. *Cargo shelf should not be used when cargo barrier is in the behind 2nd row seats position.*
2. Pivot attaching straps towards the meshed side of the cargo barrier.
3. Position cargo barrier behind 2nd row seats with the rating label (meshed side of cargo barrier) facing the rear of the vehicle.
4. Attach top straps to upper mounts using 34mm Milbolts (10) with wave washers (14) under heads.
5. Attach bottom straps to lower mounts using 19mm Milbolts (11) with wave washers (14) under heads.
6. Tighten all Milbolts.

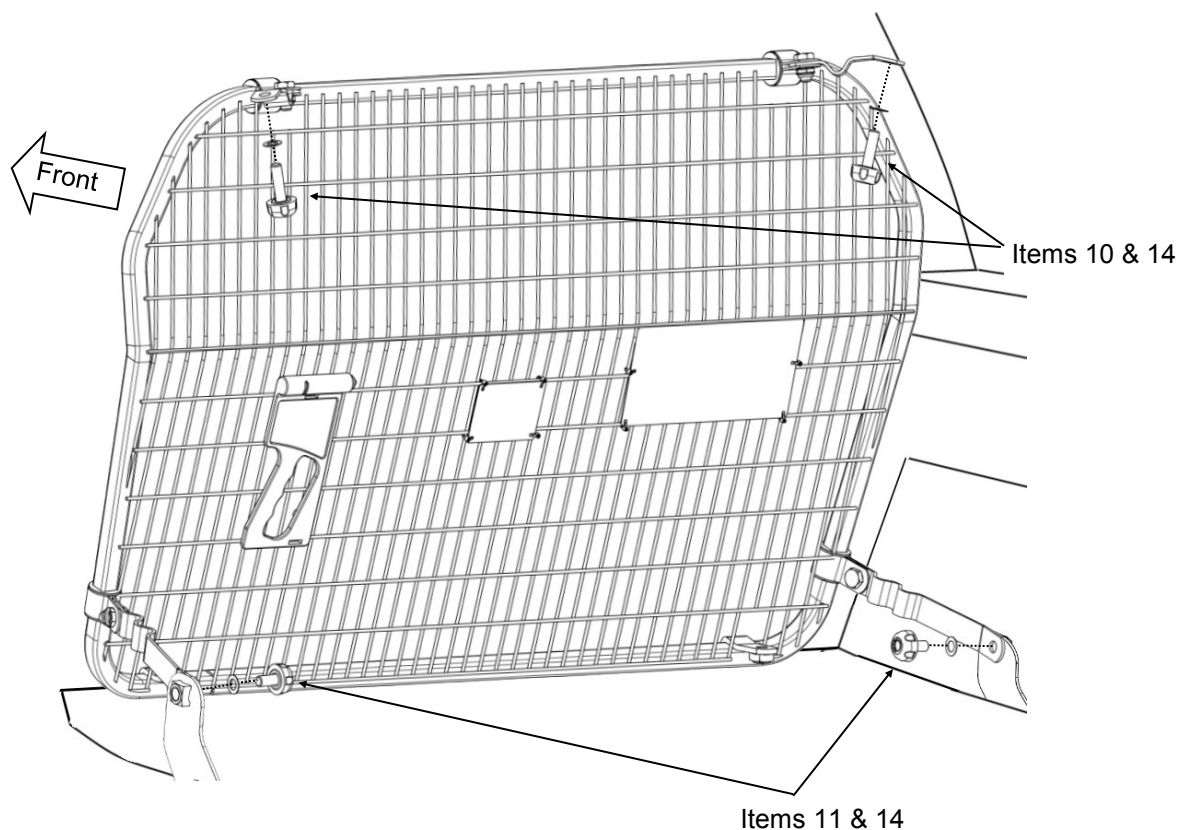

**IMPORTANT NOTE: Check that all bolts and screws are tight and re check periodically.**