



*Behind you all the way*

## **SUBARU OUTBACK CARGO BARRIER FITTING INSTRUCTION PART #705150**

VEHICLE YEARS OF MANUFACTURE - From Dec 2020



This cargo barrier is capable of being located in two positions, behind the 2nd row of seats with the seats in an upright position and behind the 1st row of seats\* with the 2nd row of seats in their folded position. The installation kit contains sufficient components for fitment to the behind 2nd row seats location only. A high degree of technical competence is necessary to correctly install this product.

We recommend this cargo barrier be installed by an authorised outlet to ensure the barrier installation complies with AS/NZS 4034 Standard.

The cargo barrier is designed, manufactured and fitted to decrease the impact hazard in an accident to occupants from cargo carried within the interior cargo space of the vehicle. In the event of an accident, a cargo barrier can reduce injuries caused by cargo intruding into occupant's space.

**\*Optional front position kit P/N 705152 (sold separately) is required to be able to install the cargo barrier behind the 1st row of seats.**

### **Installation time - Approximately 1 Hour**

*"The estimated fitting time is based on an experienced fitter conversant with the fitment procedure"*



## **WARNINGS**

- **Strict compliance with fitting instructions is essential for this safety product to meet its rated capacity. Refer user instructions regarding correct usage of the cargo barrier.**
- **Do not modify cargo barrier in any way.**
- **Do not use this cargo barrier in any other vehicle for which it is not designed.**
- **Modifications to the cargo barrier or its fixings or use in any other vehicle for which it is not designed may void the load rating and warranty.**
- **Do not attach the cargo barrier to the vehicle using seat, seat belt or child restraint anchorage's.**
- **Where high tensile threaded fasteners are used, the cargo barrier must be installed using the size and grade fasteners specified by Milford Industries.**
- **Do not drill, rivet, adhere or attach objects to the front or rear of the cargo barrier.**
- **Do not place smaller items, that may bypass the cargo barrier in the event of heavy braking or collision, near the edges of the barrier.**
- **Position the load against the cargo barrier.**
- **When load is positioned against cargo barrier, secure the load with a restraint system.**
- **During a collision moving cargo may damage seat belts or tether straps of a child restraint device, or its anchorage. Load should be carefully positioned so as not to come in contact with these items.**
- **Do not obstruct seat belts or child restraints, or their operation.**
- **Long thin items of cargo should be positioned in the vehicle with the long axis across the vehicle to minimise the penetration risk.**
- **If involved in an accident or accidentally damaged, the cargo barrier should be replaced and the anchorage's repaired to as new condition.**
- **Clean with soap and water only. Do not use solvents or chemicals. Discard cargo barrier if it becomes rusted. Do not expose to direct sunlight for long periods.**
- **It is extremely dangerous to ride in the cargo area of the vehicle behind the cargo barrier. It is recommended that the cargo barrier be removed. In a collision people or children riding unrestrained in these areas are more likely to be seriously injured or killed.**
- **Never leave a child in the vehicle unattended, particularly in the rear cargo area. The cargo area should never be used as a play area for children.**
- **The cargo barrier may deform and significantly intrude into occupant's space in an accident.**
- **The fixed labeling should not be removed from the cargo barrier.**
- **Failure to comply with warning notes may prevent the barrier protecting the occupants.**
- **Do not remove the rating plaque from the cargo barrier.**

### **NOTICE TO INSTALLERS & DISTRIBUTORS**

***Please ensure User Instructions are left with vehicle owner after installation.***



# SUBARU OUTBACK CARGO BARRIER FITTING INSTRUCTION PART #705150

VEHICLE YEARS OF MANUFACTURE - From Dec 2020



**IMPORTANT:** The installation kit contains sufficient components to fit the cargo barrier. A high degree of technical competence is necessary to correctly install this product. We recommend this cargo barrier be installed by an authorised outlet to ensure the barrier installation is correct. These instructions must be read and clearly understood before commencing installation. Check contents of kit before commencing fitment and report any discrepancies or damage.

## Parts List

Item	Component Name	Part No.	Qty
1	Cargo Barrier ASM (not shown)	705165	1
2	Top Strap	776217	2
3	Bottom Strap	772825	2
4	LH Floor Bracket	756152	1
5	RH Floor Bracket	756154	1
6	Roof Bracket	756147	2
7	Mounting Plate	756161	2
8	Screw - M8 x 1.25 x 16mm Zn	912670	4
9	Trim Garnish Base	753075	2
10	Trim Garnish Spacer	753076	2
11	Flat Washer M8	932280	4
12	Milbolt - M10 x 1.5 x 39mm	912840	2
13	Milbolt - M10 x 1.5 x 29mm	912830	2
14	Wave Washer	932125	4
15	Pivot Saddle Bush	752684	4
16	Pivot Saddle	752700	4
17	Screw - Hex Head M10 x 1.5 x 20mm Zn	912205	4
18	Nut - Hex Head Nyloc M10 x 1.5	922090	4
19	Marking Pin	906185	2
20	Adhesive Warning Label	905017	1

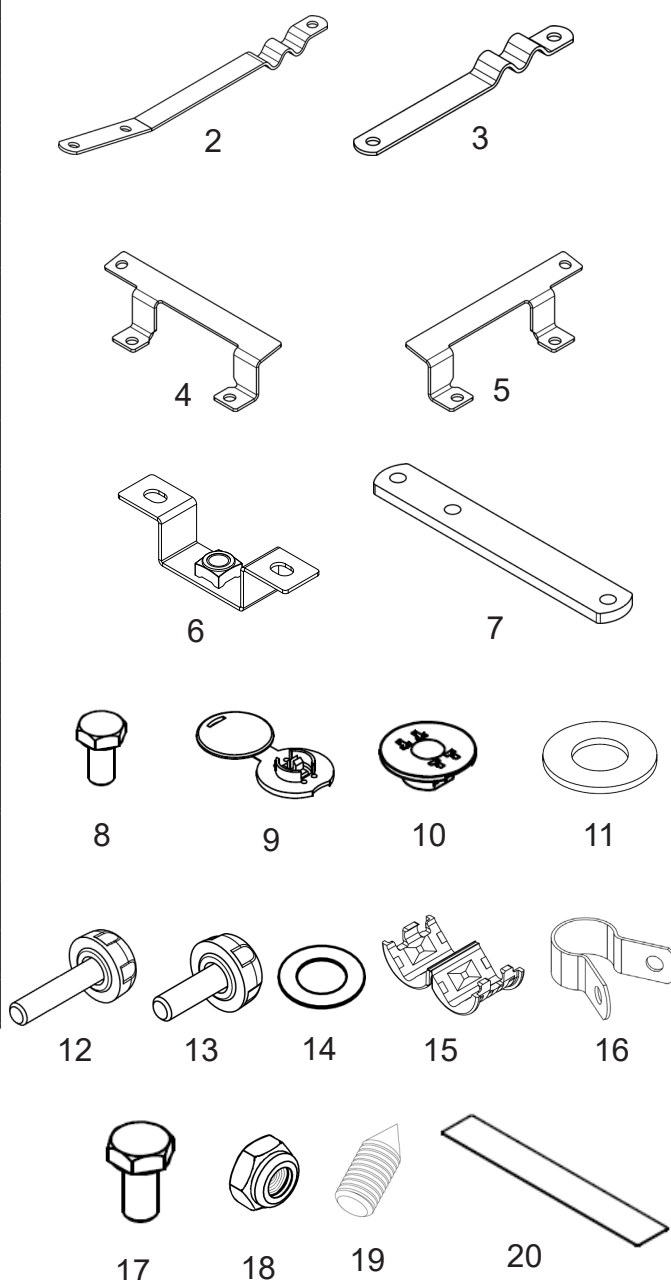

**E and OE—Errors and Omissions Excepted**

## **SUBARU OUTBACK CARGO BARRIER FITTING INSTRUCTION PART #705150**

VEHICLE YEARS OF MANUFACTURE - From Dec 2020



### **ADVICE TO FITTERS**

**Note:** To fit the cargo barrier the following is essential: (where applicable)

- Always drill perpendicular to surface (Unless stated otherwise).
- A positive drill stop should always be used to prevent accidental damage to external panels, fuel lines etc.
- Ensure Safety Eye Protection and Gloves are worn as required when using cutting tools.
- When cutting metal panels be very careful of sharp edges, for risk of skin cuts etc.
- Care should be taken when applying Rust Preventative sealer to all holes drilled, to negate the possibility of skin and eye irritation.
- Check screws in relevant components by hand before installation. Should there be resistance re-tap threads and re-check.
- **Before marking or drilling to install this cargo barrier, check vehicle for LPG conversion & non standard fuel tanks. Locate tanks and all lines attached and take EXTREME CARE not to damage whilst installing this cargo barrier.**
- **Before drilling to install this cargo barrier, check for concealed wiring looms. E.g. tow bar, reversing camera, reversing sensor wiring etc.. Relocate before drilling to avoid damage.**

**CARE SHOULD BE TAKEN NOT TO CROSS THREAD THE FASTENERS DURING  
INSTALLATION OF COMPONENTS TO THE VEHICLE.**

### **TOOLS REQUIRED**

- |                         |                                |
|-------------------------|--------------------------------|
| • Trim Removal Tools    | • 5mm Drill Bit                |
| • Masking Tape          | • 16mm Vinyl Cutter            |
| • Marker                | • 20mm Vinyl Cutter            |
| • Multi-Tool            | • Drill Stop                   |
| • Socket Wrench         | • Small Flat-Blade Screwdriver |
| • 13mm/14mm/17mm Socket | • 16mm Spanner                 |
| • Torque Wrench         | • Vacuum Cleaner               |
| • Sharp Knife           | • Clean Rag                    |
| • Power Drill           |                                |



*Behind you all the way*

## SUBARU OUTBACK CARGO BARRIER FITTING INSTRUCTION PART #705150

VEHICLE YEARS OF MANUFACTURE - From Dec 2020



### INSTALLATION OF FLOOR MOUNTS



1. Remove the cargo blind if installed and store in a safe place.
2. Remove the cargo area floor covering from vehicle and store in a safe place.



3. Remove the side floor covers from the cargo area and store in a safe place.

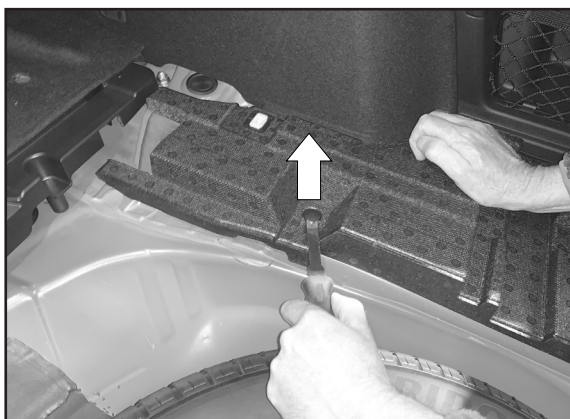

4. Remove the trim plugs securing the foam support in place and store in a safe place.



5. Remove the foam support from the vehicle and store in a safe place.
6. Repeat on the other side.





Behind you all the way

## SUBARU OUTBACK CARGO BARRIER FITTING INSTRUCTION PART #705150

VEHICLE YEARS OF MANUFACTURE - From Dec 2020



### INSTALLATION OF FLOOR MOUNTS Cont'd



7. Fold the 2nd row seats down and remove the carpet cover behind the 2nd row seats by pulling upwards, as shown.



RHS Shown

8. Familiarise yourself with the plastic trim panel behind the 2nd row seats, specifically the indent with hole highlighted.

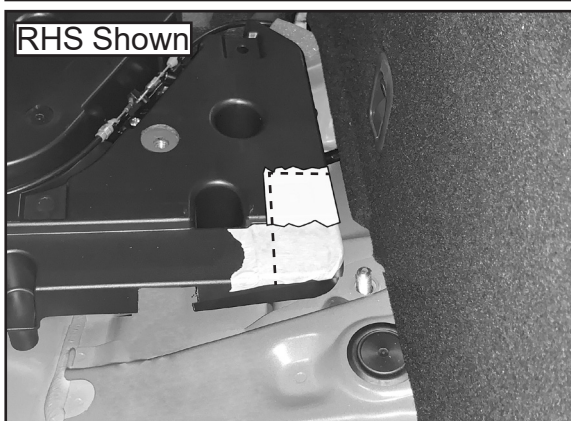

RHS Shown

9. On the RHS, place masking tape in the bottom right corner on the plastic trim panel, over the indent as shown.
10. Mark a line starting from the top left corner of the indent parallel towards the RHS of the vehicle as shown.
11. Mark a line starting from the top left corner of the indent parallel towards the rear of the vehicle as shown.
12. Carefully cut away the marked area using a multi-tool and remove from the plastic trim.
13. Repeat on the LHS.



RHS Shown

14. Remove the two securing nuts shown on both sides. Retain for use later.



Behind you all the way

## SUBARU OUTBACK CARGO BARRIER FITTING INSTRUCTION PART #705150

VEHICLE YEARS OF MANUFACTURE - From Dec 2020



### INSTALLATION OF FLOOR MOUNTS Cont'd

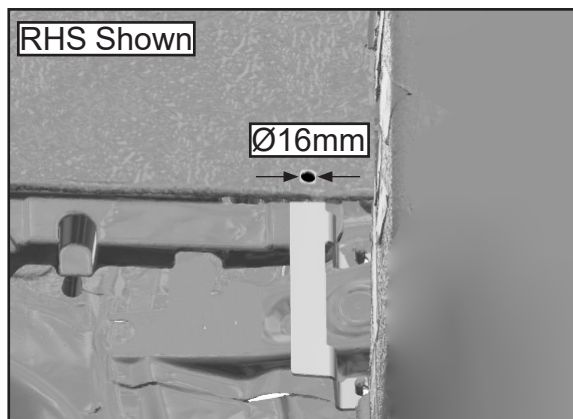
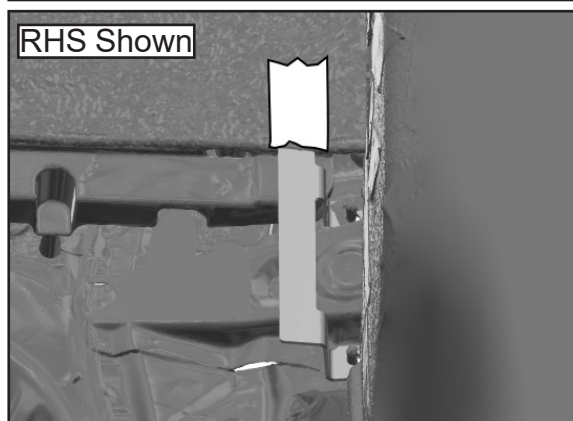
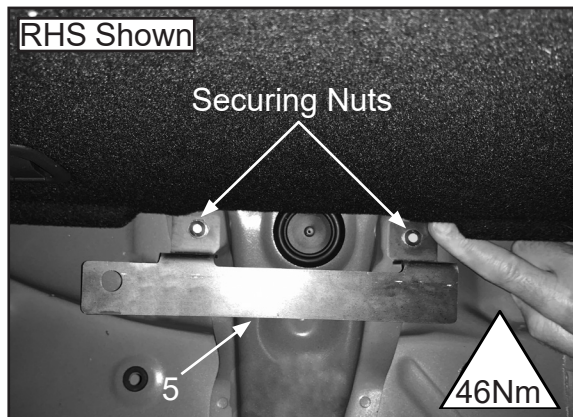

15. On the RHS, attach the RH floor bracket (5) to the mounting location and use the securing nuts to secure it in place.
16. Repeat on the LHS with the LH floor bracket (4).
17. Tighten and torque all securing nuts to 46Nm.

18. Screw a marking pin (19) into each of the captive nuts in floor brackets with the end protruding.
19. Place the carpet cover back over its original location.

20. Place masking tape in the approximate marking pin locations on the carpet cover as shown.
21. Apply pressure to the carpet cover at the marking pin locations until the point can be seen on the masking tape.
22. Remove marking pins.



23. At the marked locations carefully drill a Ø5mm pilot hole through carpet cover.
24. Using a Ø16mm vinyl cutter enlarge the pilot holes through carpet cover.
25. Remove masking tape.



Behind you all the way

## SUBARU OUTBACK CARGO BARRIER FITTING INSTRUCTION PART #705150

VEHICLE YEARS OF MANUFACTURE - From Dec 2020



### INSTALLATION OF ROOF MOUNTS

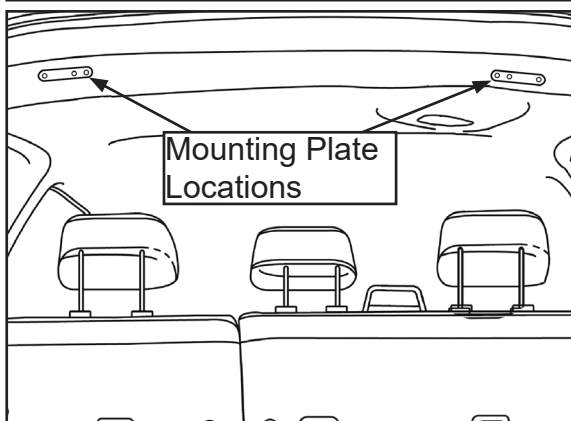
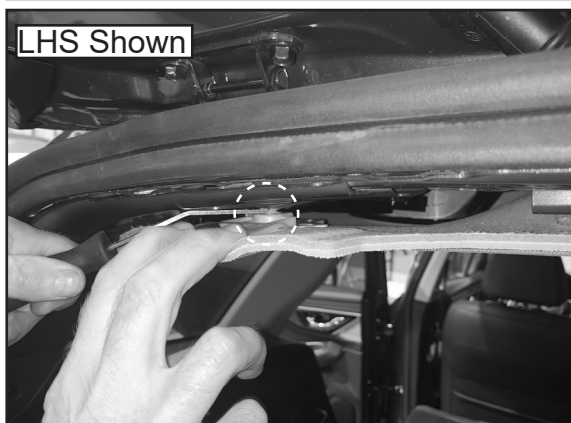
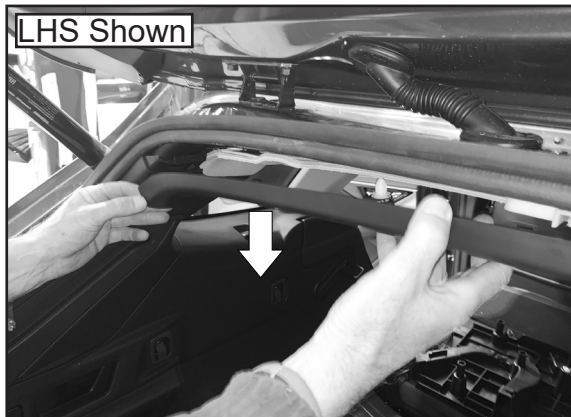

26. Place a drop sheet over the cargo area floor.
27. At the top of the tailgate opening carefully remove the plastic roof trim using a trim removal tool and store in a safe place.

28. Using a trim removal tool, unclip the three clips along the roof lining holding it in place.

29. Familiarise yourself with the inside of the roof lining, in particular to the two holes on each side that will secure the roof brackets in place.

30. The mounting plates (7) will be installed inside the metal roof panel in the orientation shown.





# SUBARU OUTBACK CARGO BARRIER FITTING INSTRUCTION PART #705150

VEHICLE YEARS OF MANUFACTURE - From Dec 2020



## INSTALLATION OF ROOF MOUNTS Cont'd

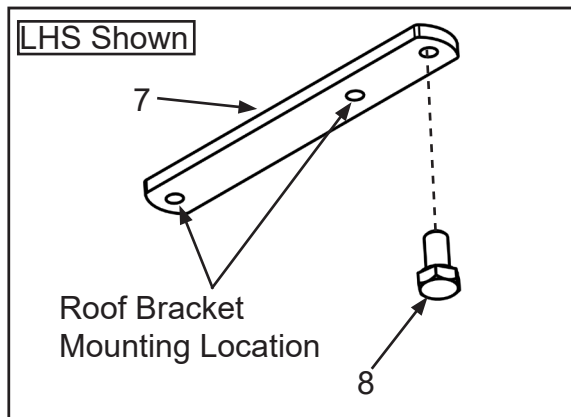

31. Screw an M8 screw (8) into the outer hole on a mounting plate (7) as shown.

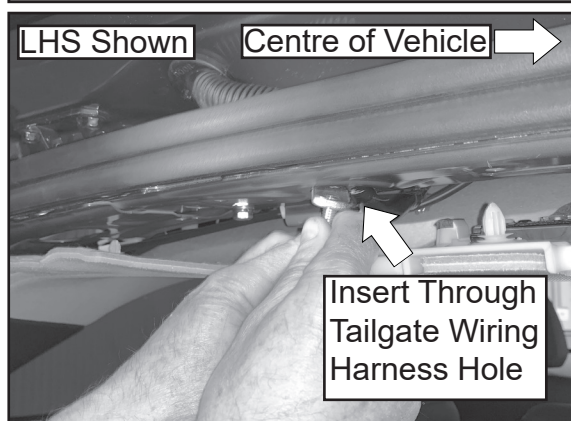

32. On the LHS, position the M8 screw and mounting plate ASM inside the vehicle roof with the roof bracket mounting location end facing outwards from the centre of the vehicle, pushing it through the tailgate wiring harness hole and aligned with the mounting hole locations in the roof panel as shown.

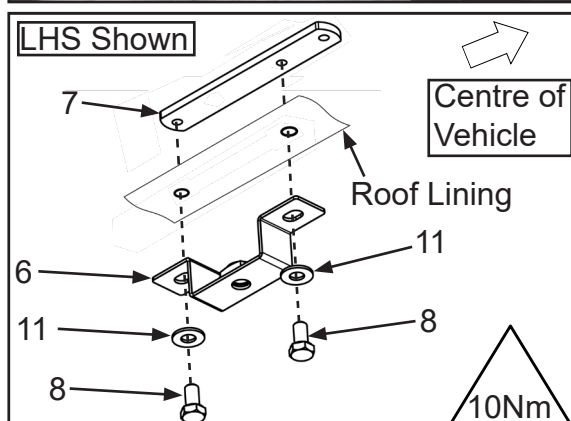

33. Whilst holding the M8 screw and mounting plate ASM in place, secure the roof bracket (6) to the mounting plate ASM using one M8 screw (8) with flat washer (11) under the head as shown.
34. Remove the M8 installation screw (8) from the mounting plate ASM.
35. Pivot the mounting plate forward until the 2nd mounting plate hole aligns with the existing mounting hole.
36. Secure the remaining roof bracket hole an M8 screw (8) and a flat washer (11) under the head.
37. Repeat on the RHS.
38. Tighten and torque all M8 screws to 10Nm.

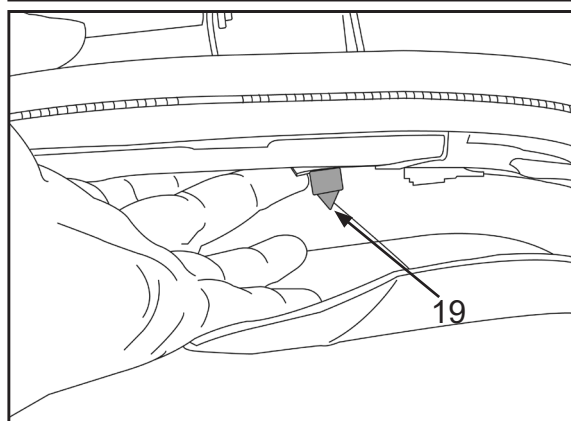

39. Screw a marking pin (19) into each of the captive nuts in roof brackets with approximately 8mm protruding.





# SUBARU OUTBACK CARGO BARRIER FITTING INSTRUCTION PART #705150

VEHICLE YEARS OF MANUFACTURE - From Dec 2020



## INSTALLATION OF ROOF MOUNTS Cont'd

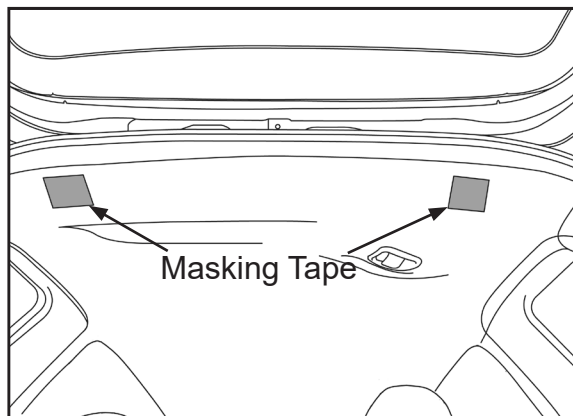

40. Affix masking tape to the cabin side of the roof lining at the approximate location of the marking pins in upper mounting brackets.

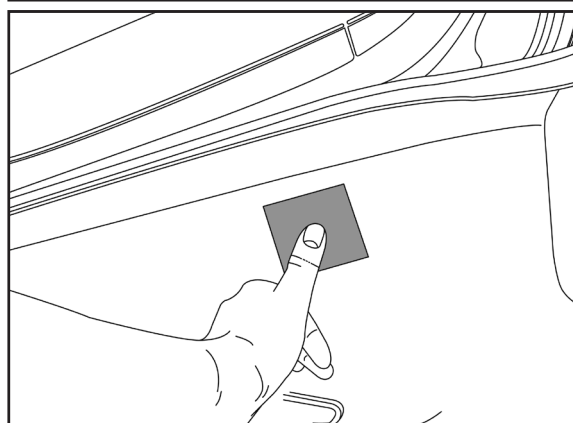

41. Apply pressure to the roof lining at the marking pin locations until the point can be seen on the cabin side of the roof lining. Mark this location if required.
42. Remove marking pins.

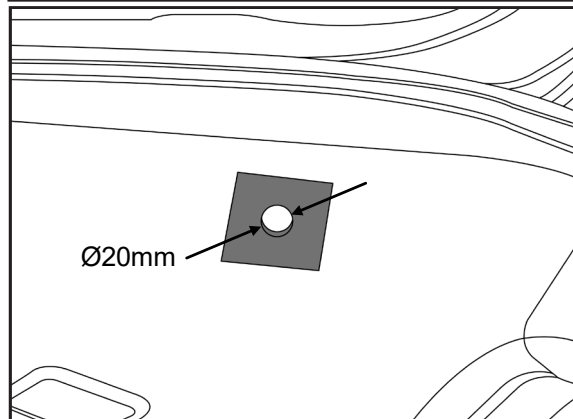

43. At the marked locations carefully drill a Ø5mm pilot hole through roof lining.  
**Note: Use of a drill stop is recommended.**
44. Using a Ø20mm vinyl cutter enlarge the pilot holes through roof lining.
45. Remove masking tape.

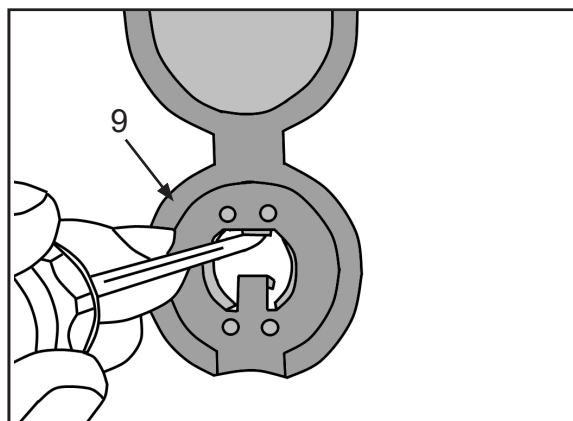
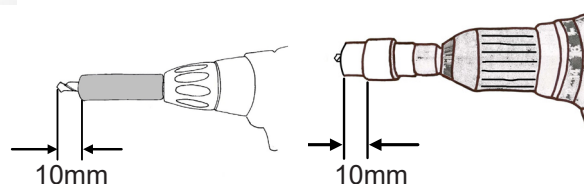

46. Insert a trim plug base (9) into the 20mm hole in trim with the cover positioned towards the front of vehicle.
47. Using a small screwdriver or similar push the trim plugs retention legs outwards to engage them in behind the roof trim.



# SUBARU OUTBACK CARGO BARRIER FITTING INSTRUCTION PART #705150

VEHICLE YEARS OF MANUFACTURE - From Dec 2020



## INSTALLATION OF TOP MOUNTS Cont'd

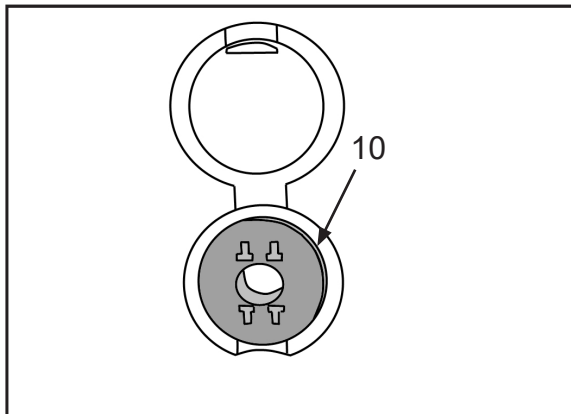

48. Push a trim plug insert (10) into the centre of the trim plug base until it clips in place flush.

49. Repeat steps 46 to 48 on the other side.

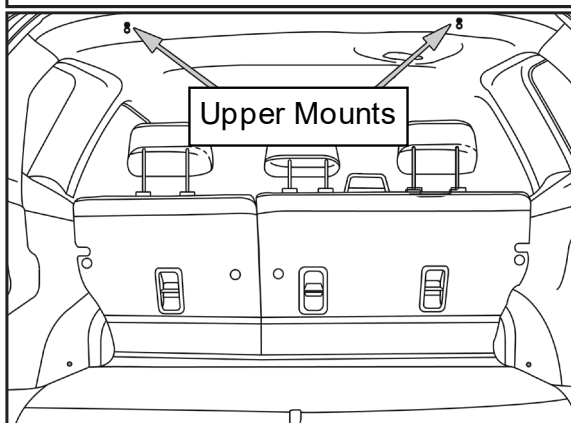

50. Reassemble the roof lining and plastic roof trim in reverse order to the removal.

51. Remove the drop sheet from vehicle vacuum away any swarf.

## ATTACHING STRAPS TO CARGO BARRIER

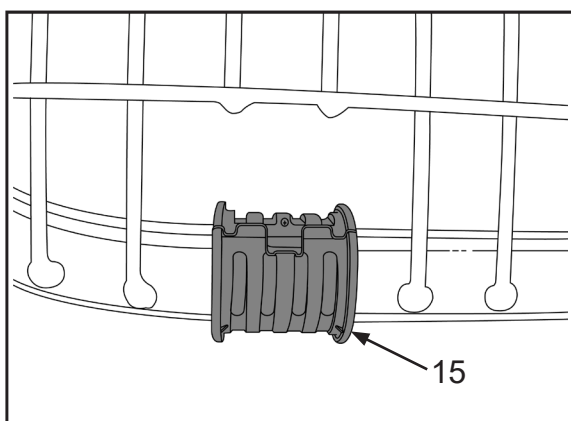

52. At each of the cut outs in the mesh on the perimeter of the cargo barrier, at the top and bottom, place a pivot saddle bush (15) as shown.

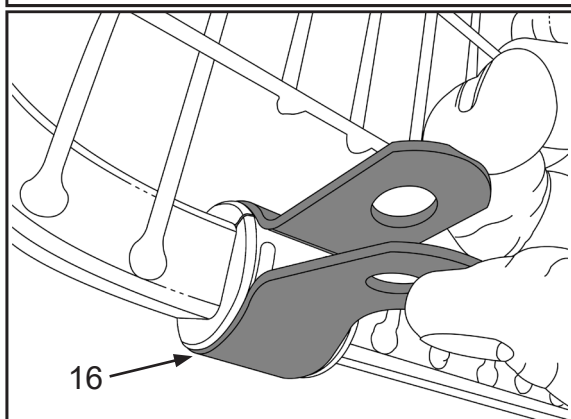

53. Place a pivot saddle (16) over each of the pivot saddle bushes then push the ends together.



Behind you all the way

## SUBARU OUTBACK CARGO BARRIER FITTING INSTRUCTION PART #705150

VEHICLE YEARS OF MANUFACTURE - From Dec 2020



### ATTACHING STRAPS TO CARGO BARRIER Cont'd

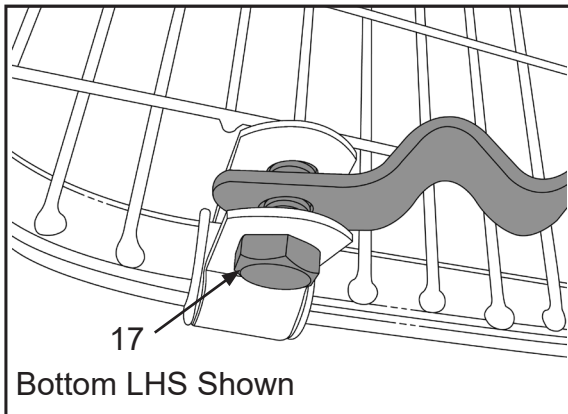

54. Place the correct strap in between the pivot saddle ends then place a hex screw (17) through the saddle and strap.

Note: See images below for correct orientation.

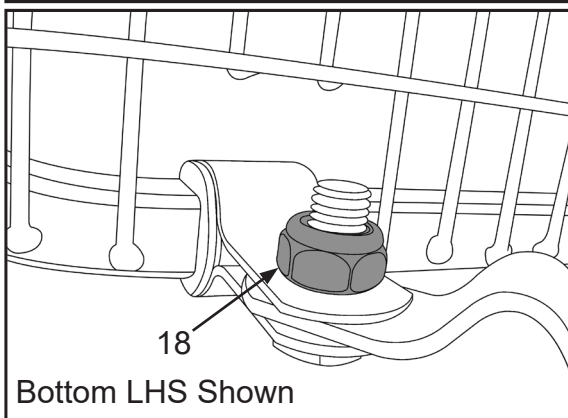

55. Place a nyloc hex nut (18) onto each of the hex screws then tighten until the strap is firm in saddle but can still be pivoted.

### INSTALLING CARGO BARRIER IN VEHICLE

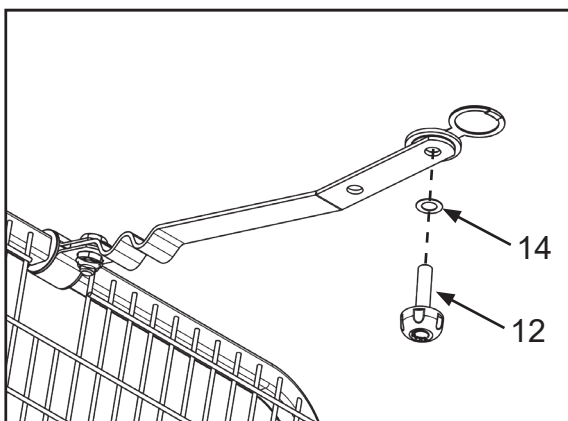

56. Ensure all straps are pivoted towards the meshed side of the cargo barrier.
57. Manoeuvre cargo barrier into vehicle with the rating label (meshed side of cargo barrier) facing the rear of the vehicle. Locate cargo barrier in the behind 2nd row seat position.
58. Attach the top straps to the upper mounts using 39mm Milbolts (12) with wave washers (14) under heads.

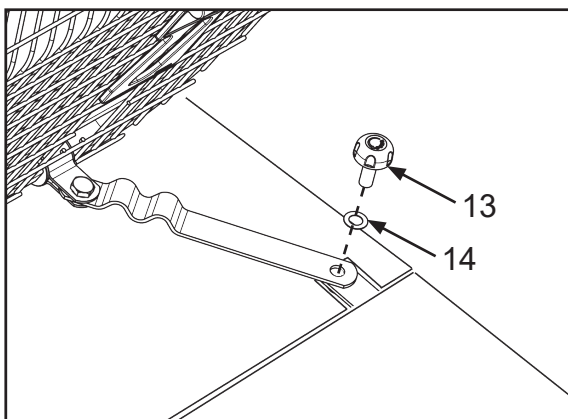

59. Attach the bottom straps to the bottom mounts using 29mm Milbolts (13) with wave washers (14) under heads.
60. Tighten all Milbolts.
61. Replace cargo blind if required.
62. Put 2nd row seat backs into upright position.



*Behind you all the way*

## **SUBARU OUTBACK CARGO BARRIER FITTING INSTRUCTION PART #705150**

VEHICLE YEARS OF MANUFACTURE - From Dec 2020



### **SECURING ADHESIVE RATING LABEL TO VEHICLE**

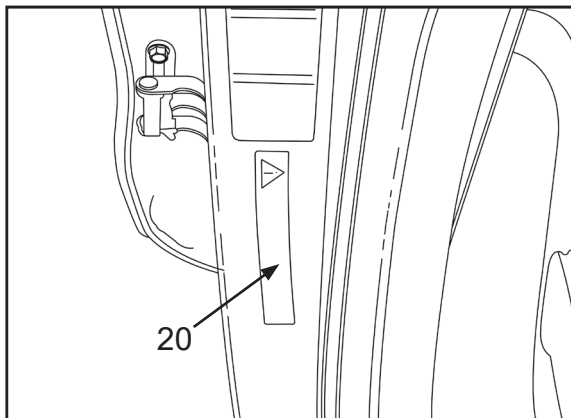

63. Clean the area inside the drivers door opening just below side airbag warning label as shown. Affix orange warning label (20) at that location as shown.