



# **SUBARU FORESTER**

## **CARGO BARRIER INSTALLATION INSTRUCTION**

### **Part # 705025**

VEHICLE YEARS OF MANUFACTURE - FROM JULY 2018



This cargo barrier is capable of being located in two positions, behind the 2nd row of seats with the seats in an upright position, and behind the 1st row of seats with the 2nd row of seats in their folded position. The installation kit contains sufficient components for fitment to both positions. A high degree of technical competence is necessary to correctly install this product.

We recommend this cargo barrier be installed by an authorised outlet to ensure the barrier installation complies with AS/NZS 4034 Standard.

The cargo barrier is designed, manufactured and fitted to decrease the impact hazard in an accident to occupants from cargo carried within the interior cargo space of the vehicle. In the event of an accident, a cargo barrier can reduce injuries caused by cargo intruding into occupant's space.

**Installation time approximately 0.75 Hour**

"The estimated fitting time is based on an experienced fitter conversant with the fitment procedure"



## **WARNINGS**

- **Strict compliance with fitting instructions is essential for this safety product to meet its rated capacity. Refer user instructions regarding correct usage of the cargo barrier.**
- **Do not modify cargo barrier in any way.**
- **Do not use this cargo barrier in any other vehicle for which it is not designed.**
- **Modifications to the cargo barrier or its fixings or use in any other vehicle for which it is not designed may void the load rating and warranty.**
- **Do not attach the cargo barrier to the vehicle using seat, seat belt or child restraint anchorage's.**
- **Where high tensile threaded fasteners are used, the cargo barrier must be installed using the size and grade fasteners specified by Milford Industries.**
- **Do not drill, rivet, adhere or attach objects to the front or rear of the cargo barrier.**
- **Do not place smaller items, that may bypass the cargo barrier in the event of heavy braking or collision, near the edges of the barrier.**
- **Position the load against the cargo barrier.**
- **When load is positioned against cargo barrier, secure the load with a restraint system.**
- **During a collision moving cargo may damage seat belts or tether straps of a child restraint device, or its anchorage. Load should be carefully positioned so as not to come in contact with these items.**
- **Do not obstruct seat belts or child restraints, or their operation.**
- **Long thin items of cargo should be positioned in the vehicle with the long axis across the vehicle to minimise the penetration risk.**
- **If involved in an accident or accidentally damaged, the cargo barrier should be replaced and the anchorage's repaired to as new condition.**
- **Clean with soap and water only. Do not use solvents or chemicals. Discard cargo barrier if it becomes rusted. Do not expose to direct sunlight for long periods.**
- **It is extremely dangerous to ride in the cargo area of the vehicle behind the cargo barrier. It is recommended that the cargo barrier be removed. In a collision people or children riding unrestrained in these areas are more likely to be seriously injured or killed.**
- **Never leave a child in the vehicle unattended, particularly in the rear cargo area. The cargo area should never be used as a play area for children.**
- **The cargo barrier may deform and significantly intrude into occupant's space in an accident.**
- **Remember that the tailgate cannot be opened from inside the cargo area.**
- **The fixed labeling should not be removed from the cargo barrier.**
- **Failure to comply with warning notes may prevent the barrier protecting the occupants.**
- **Parents should explain to children how and when to use *EMERGENCY ESCAPE HAMMER* attached to cargo barrier.**
- **Do not remove the rating plaque from the cargo barrier.**

## **NOTICE TO INSTALLERS & DISTRIBUTORS**

***Please ensure User Instructions are left with vehicle owner after installation.***



# SUBARU FORESTER CARGO BARRIER INSTALLATION INSTRUCTION

Part # 705025

VEHICLE YEARS OF MANUFACTURE - FROM JULY 2018



**IMPORTANT:** The installation kit contains sufficient components to fit the cargo barrier. A high degree of technical competence is necessary to correctly install this product. We recommend this cargo barrier be installed by an authorised outlet to ensure the barrier installation is correct. These instructions must be read and clearly understood before commencing installation. Check contents of kit before commencing fitment and report any discrepancies or damage.

## Parts List

Item	Component Name	Part No.	Qty
1	Cargo Barrier ASM (not shown)	705775	1
2	Trim Plug Base	753075	2
3	Trim Plug Insert	753077	2
4	Marking Pin (M10 x 25)	906185	1
5	Warning Label (Orange)	905017	1
6	Bottom Bracket ASM RHS	753119	1
7	Bottom Bracket ASM LHS	753099	1
8	Roof Bracket ASM RHS	753128	1
9	Roof Bracket ASM LHS	753130	1
10	Milbolt—M10 x 29mm	912830	2
11	Milbolt—M10 x 19mm	912820	2
12	Wave Washer—10mm ZP	932125	4
13	Pivot Saddle Bush	752680	4
14	Pivot Saddle	752700	4
15	Screw—Hex Head M10 x 20mm ZP	912205	4
16	Hex Nut—Nyloc ZP	922090	4
17	Bottom Strap RHS	776028	1
18	Bottom Strap LHS	776029	1
19	Top Strap RHS	776026	1
20	Top Strap LHS	776027	1

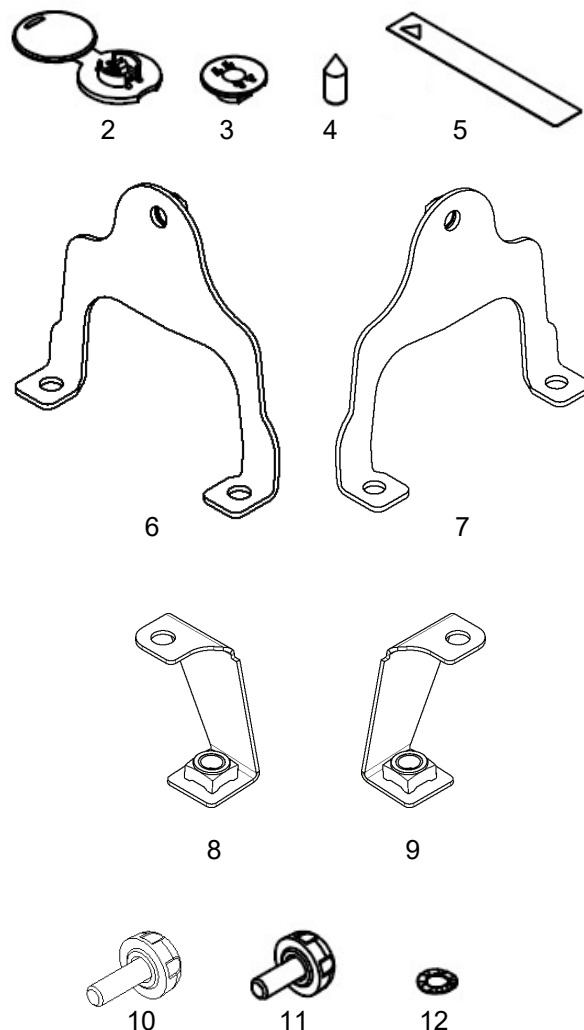

13

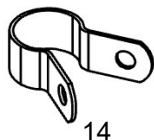

14



15



16

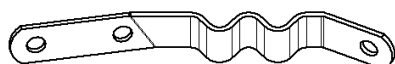

17

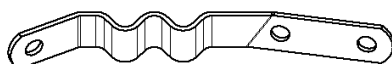

18

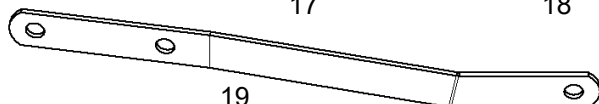

19

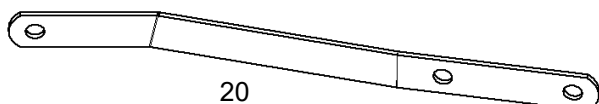

20

**E and OE—Errors and Omissions Excepted**



## ADVICE TO FITTER

**Note:** To fit the cargo barrier the following is essential: (where applicable)

- ☐ Always drill perpendicular to surface (Unless stated otherwise).
- ☐ A positive drill stop should always be used to prevent accidental damage to external panels, fuel lines etc.
- ☐ Ensure Safety Eye Protection and Gloves are worn as required when using cutting tools.
- ☐ When cutting metal panels be very careful of sharp edges, for risk of skin cuts etc.
- ☐ Care should be taken when applying Rust Preventative sealer to all holes drilled, to negate the possibility of skin and eye irritation.
- ☐ Check screws in relevant components by hand before installation. Should there be resistance re-tap threads and re-check.
- ☐ **Before marking or drilling to install this cargo barrier, check vehicle for LPG conversion & non standard fuel tanks. Locate tanks and all lines attached and take EXTREME CARE not to damage whilst installing this cargo barrier.**
- ☐ **Before drilling to install this cargo barrier, check for concealed wiring looms. E.g. tow bar, reversing camera, reversing sensor wiring etc.. Relocate before drilling to avoid damage.**

**CARE SHOULD BE TAKEN NOT TO CROSS THREAD THE FASTENERS DURING  
INSTALLATION OF COMPONENTS TO THE VEHICLE.**

## TOOLS REQUIRED

- |                      |                                |
|----------------------|--------------------------------|
| ◦ Socket wrench      | ◦ 20mm Vinyl Cutter            |
| ◦ Metric hex sockets | ◦ Small Flat Blade Screwdriver |
| ◦ Trim removal tools | ◦ Side cutters                 |
| ◦ Power Drill        | ◦ Sharp Knife                  |
| ◦ Masking Tape       | ◦ DeBurr Tool                  |
| ◦ Marker             | ◦ Vacuum Cleaner               |
| ◦ 5mm Drill Bit      | ◦ Cover sheet / Drop sheet     |
| ◦ 14mm Hole Saw      | ◦ Torque Wrench 22Nm/46Nm      |
| ◦ Drill stop's       | ◦ Clean Rag                    |



## PREPARE VEHICLE FOR BOTTOM MOUNT INSTALLATION

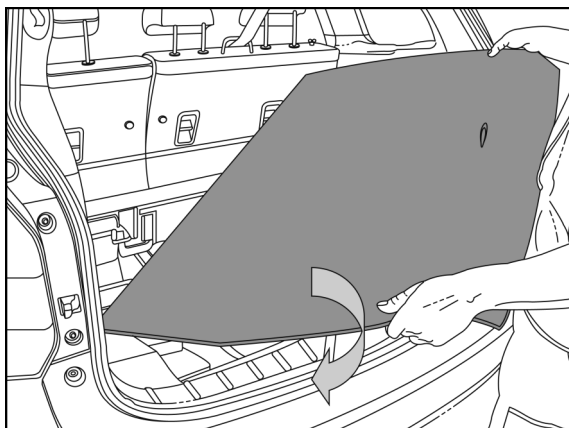

1. Remove the cargo blind if installed and store in a safe place.
2. Remove the cargo area floor covering from vehicle and store in a safe place.
3. Remove the foam insert covering the spare wheel and store in a safe place.
4. Remove the side floor covers from the cargo area and store in a safe place.

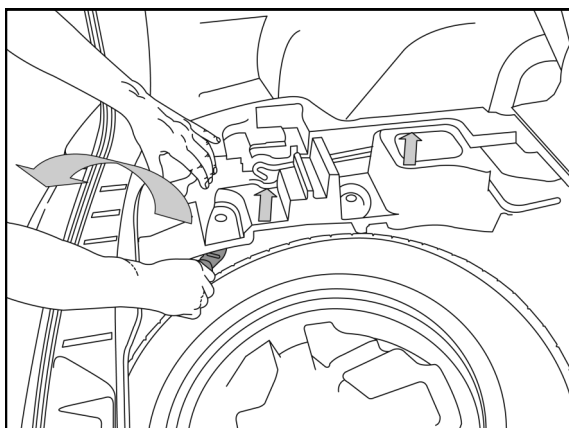

5. Using a trim removal tool to assist, carefully unclip and remove the styrene foam under floor inserts. Store in a safe place.

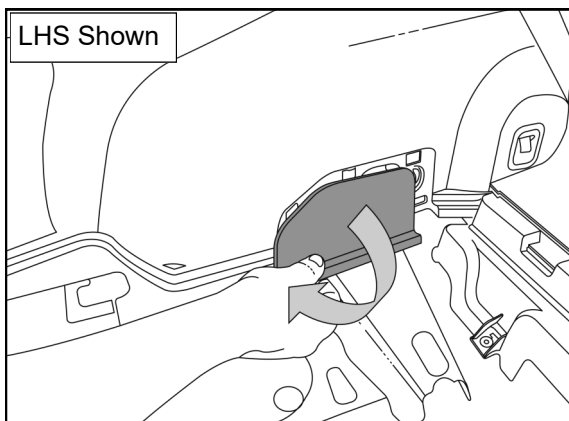

6. At the sides of the cargo area in the wheel arch area, unfasten and remove the clip on covers. Both sides. Store covers in a safe place. Note: The covers are easily removed by pulling the barbed clips downwards on the bottom backside of the trim.

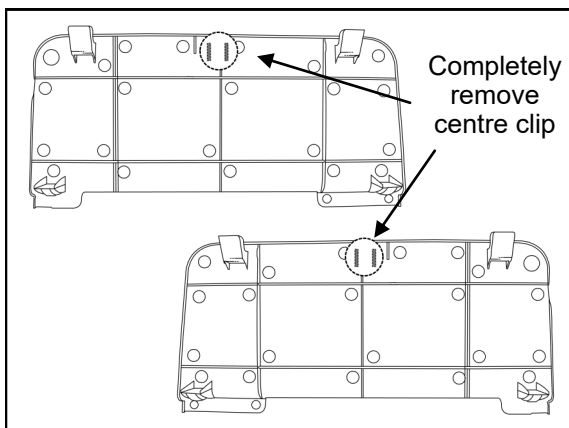

7. On the back side of both of the trim covers removed at step 6, cut away the centre clip flush to the back face of cover as shown.



# SUBARU FORESTER CARGO BARRIER INSTALLATION INSTRUCTION

Part # 705025

VEHICLE YEARS OF MANUFACTURE - FROM JULY 2018



## INSTALLATION PROCEDURE FOR BOTTOM MOUNTS

LHS Trim

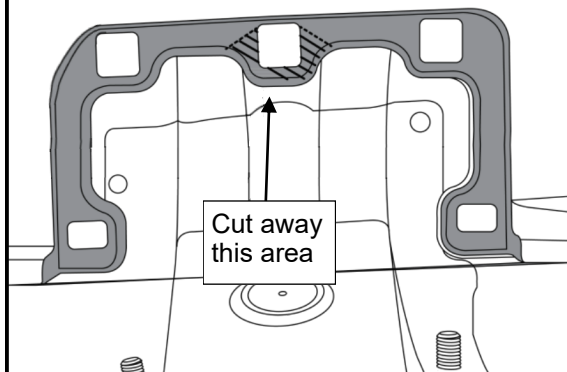

RHS Trim

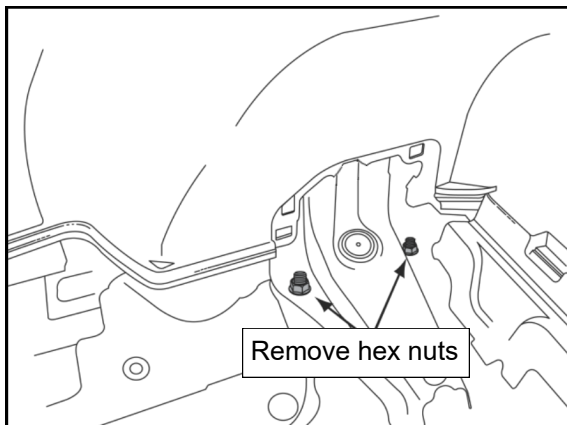
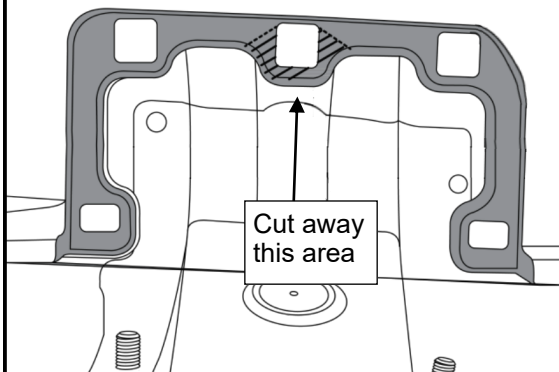

8. On each side at the location where the clip on covers have been removed, mark out then carefully trim away hard plastic in the (hatched) areas shown.

9. Using a 14mm AF socket remove the hex nuts securing the rear suspension struts in place. Both sides. Retain the nuts for reuse later.

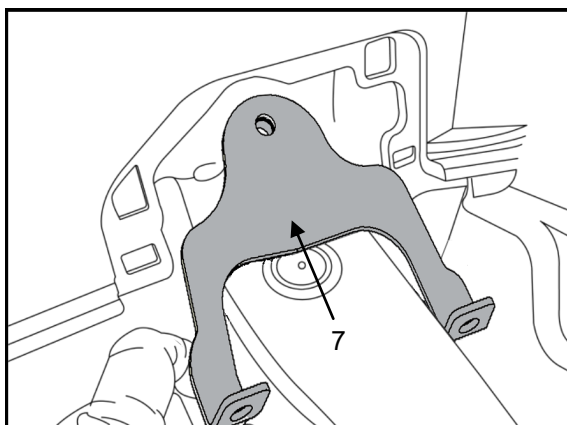

10. Feed a LHS bottom bracket (7) in behind the side trim then position as shown over the rear strut studs.
11. Repeat on the other side with RHS bottom bracket (6).

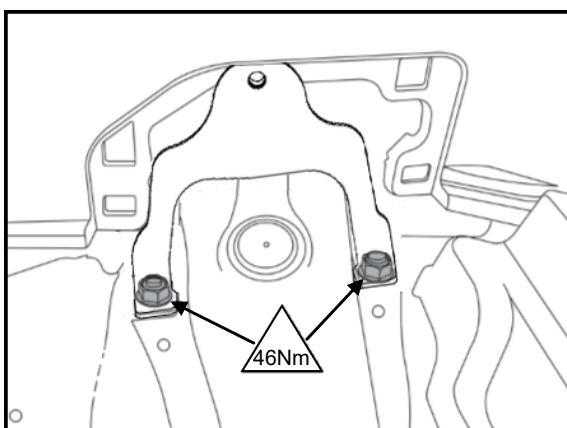

12. With the bottom brackets in position replace the flanged hex nuts removed earlier.
13. Tighten and torque up nuts to 46Nm using a suitable torque wrench.







## INSTALLATION PROCEDURE FOR BOTTOM MOUNTS –Cont'd

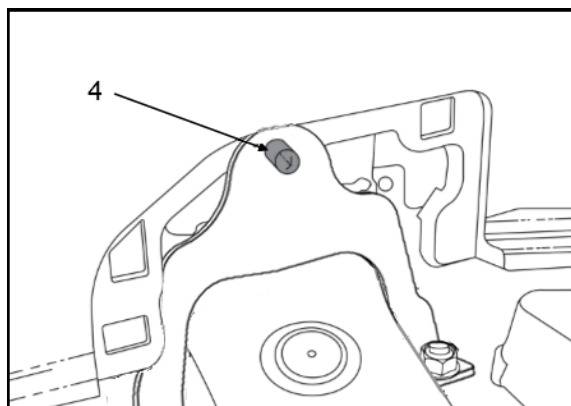

14. Screw a marking pin (4) into each of the captive nuts in bottom brackets, with just the point protruding.

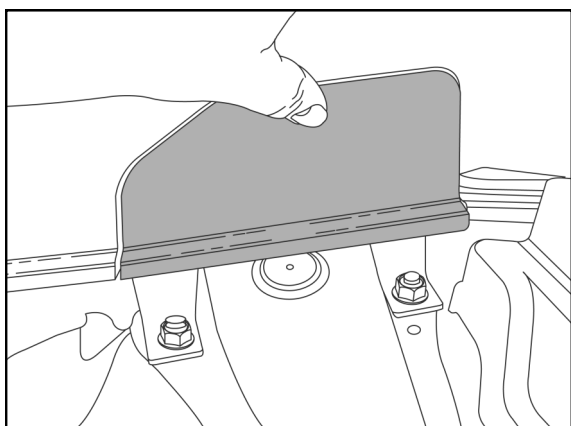

15. Carefully relocate each of the trim covers back into their home position, then apply pressure to the marking pin area until a mark is left on the back face.

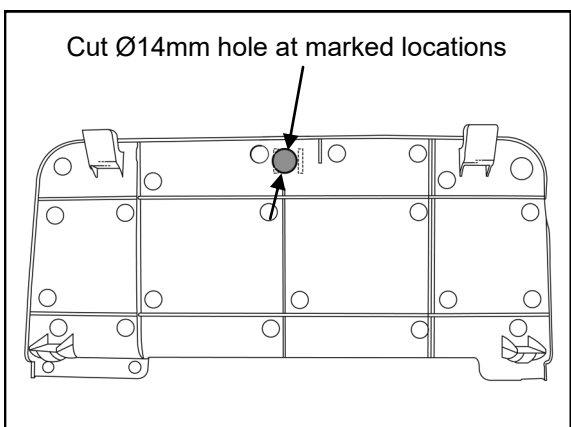

16. Remove trim covers and drill a 5mm pilot hole at the marked locations from above.  
 17. Using a Ø14mm hole saw enlarge the pilot holes.  
 18. Carefully deburr the holes if required using a deburr tool or sharp knife.

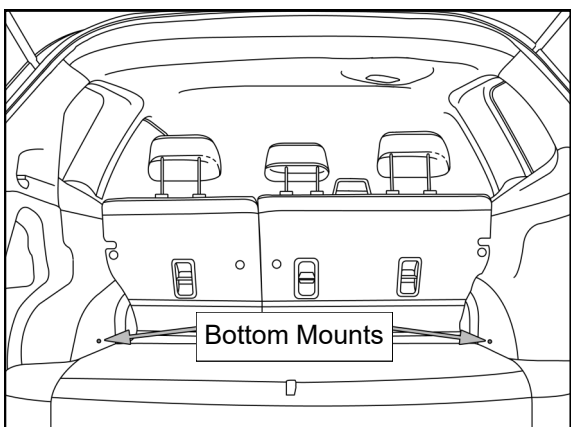

19. Reinstall trim covers to vehicle. Replace the items removed at steps 2 to 5.



## PREPARE VEHICLE FOR UPPER MOUNT INSTALLATION

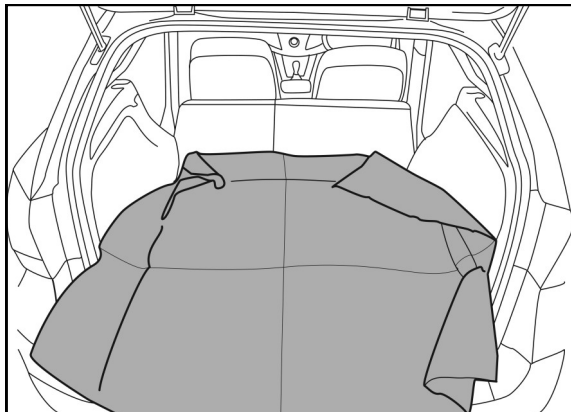

20. Place a drop sheet over cargo area floor to protect trim.

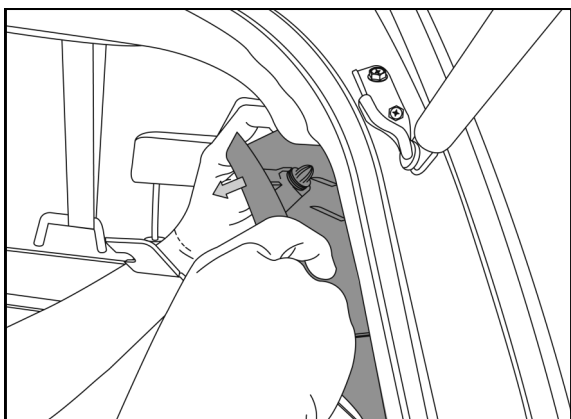

21. With the aid of a trim removal tool carefully unclip the back and top edge of the rear inner 1/4 trims. Both sides.

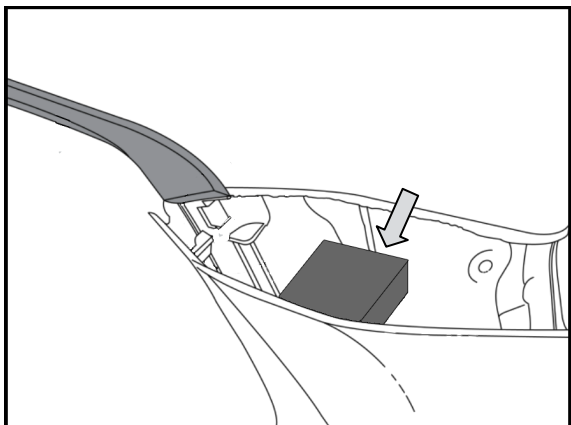

22. Use a suitable soft wedge to support the trim away from the panel, to allow roof lining to be moved down.

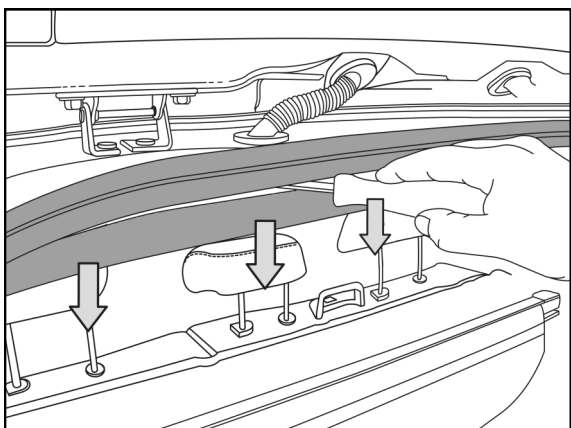

23. Using a suitable trim removal tool from the back edge, unclip the roof lining allowing enough space to access the tailgate hinge securing nuts.



## INSTALLATION PROCEDURE FOR UPPER MOUNTS

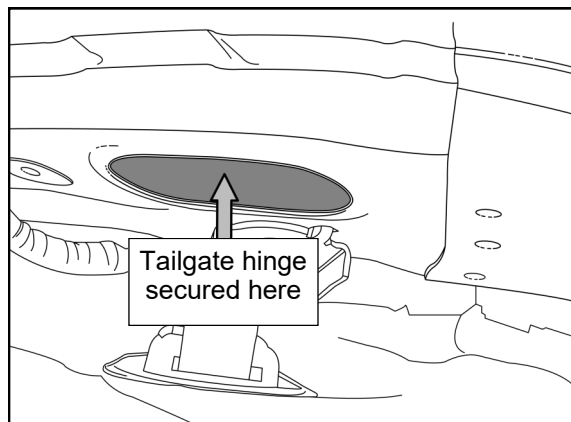

24. Familiarise yourself with the areas where the tailgate hinges are secured to the rear roof member. (oval cut outs in roof panel)
25. Working on one tailgate hinge at a time

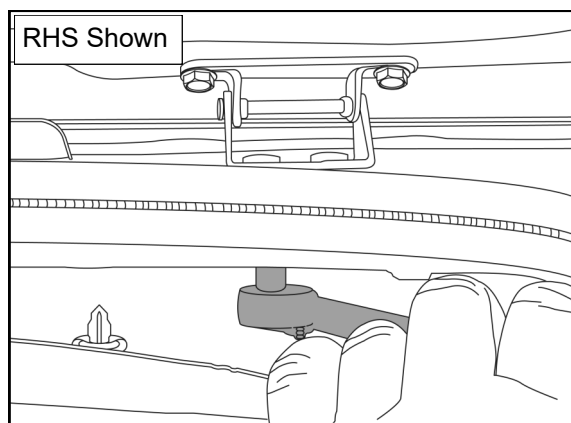

- undo and remove only the hex nut closest the middle of the vehicle.  
(12mm AF socket required)
- Important: Do not remove the 2nd (outer) hex nut securing the tailgate hinge.**
26. Place the correct roof bracket over the

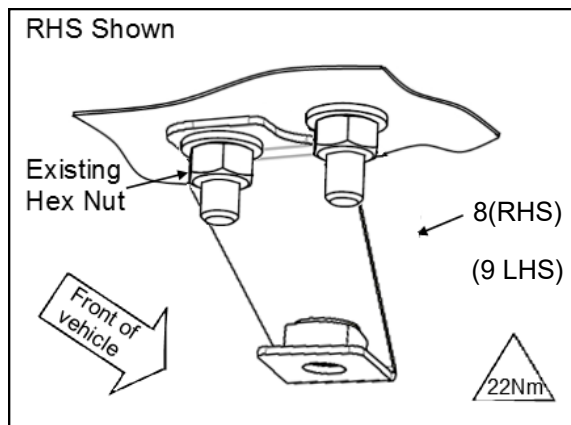

- vacant tailgate hinge stud as shown then replace the hex nut.
27. Tighten and torque up the hinge nut to 22Nm.
  28. Repeat steps 25 to 27 on the other side.
  29. Screw a marking pin (4) into each of the

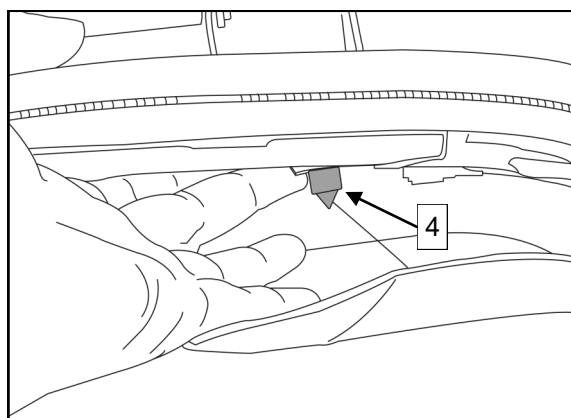

- captive nuts in roof brackets with approximately 8mm protruding.
30. Affix masking tape to the cabin side of





## INSTALLATION PROCEDURE FOR UPPER MOUNT TRIM PLUGS

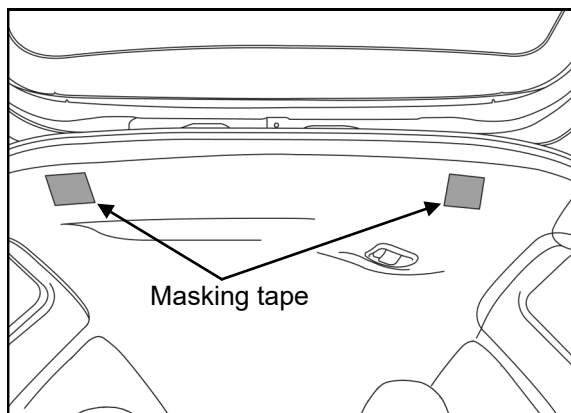

the roof lining at the approximate location of the marking pins in upper mounting brackets.

31. Apply pressure to the roof lining at the

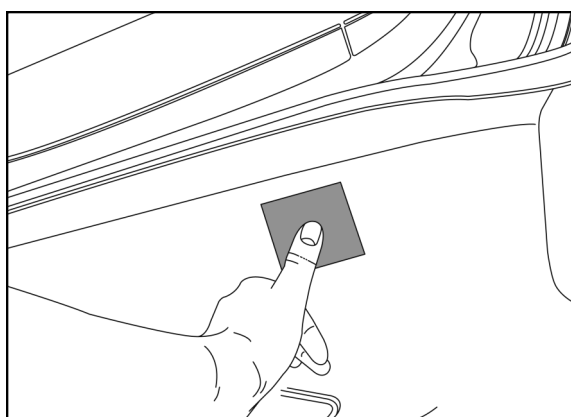

marking pin locations until the point can be seen on the cabin side of the roof lining. Mark this location if required.

32. Remove marking pins.

33. At the marked locations carefully drill a

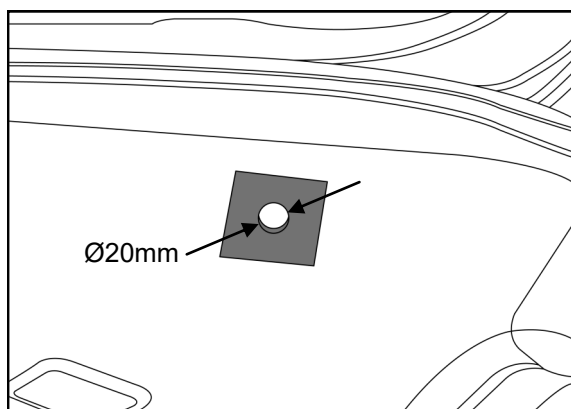

Ø5mm pilot hole through roof lining.  
**Use of a drill stop is recommended.**

34. Using a Ø20mm vinyl cutter enlarge the pilot holes through roof lining.

35. Remove masking tape.

36. Insert a trim plug base (2) into the

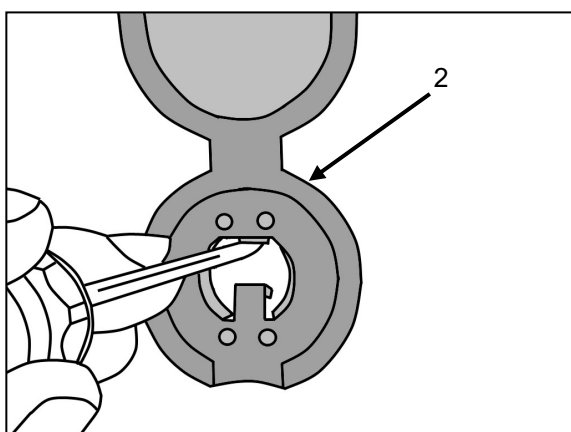
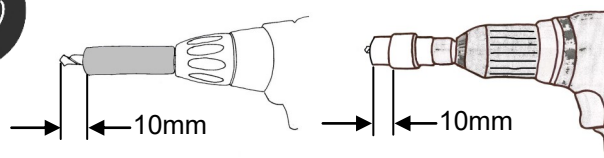

20mm hole in trim with the cover positioned towards the front of vehicle.

37. Using a small screwdriver or similar push the trim plugs retention legs outwards to engage them in behind the roof trim.

38. Push a trim plug insert (3) into the



## INSTALLATION PROCEDURE FOR UPPER MOUNT TRIM PLUGS—Cont'd

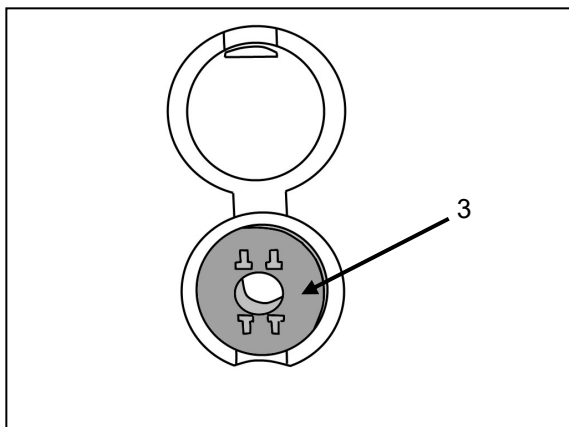

centre of the trim plug base until it clips in place flush.

39. Repeat steps 36 to 38 on the other side.
40. Remove the drop sheet from vehicle

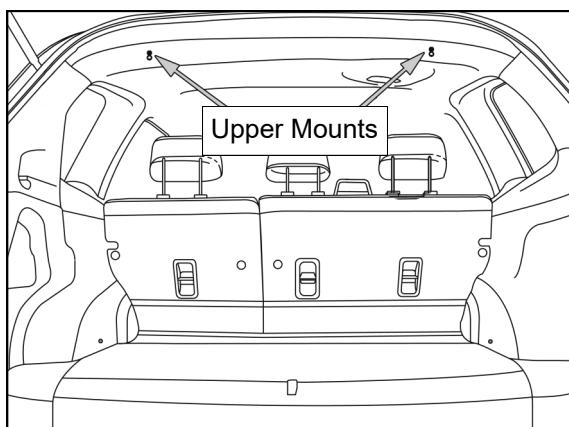

and clean up.

41. Clean the area inside the drivers door

## AFFIXING OF WARNING LABEL

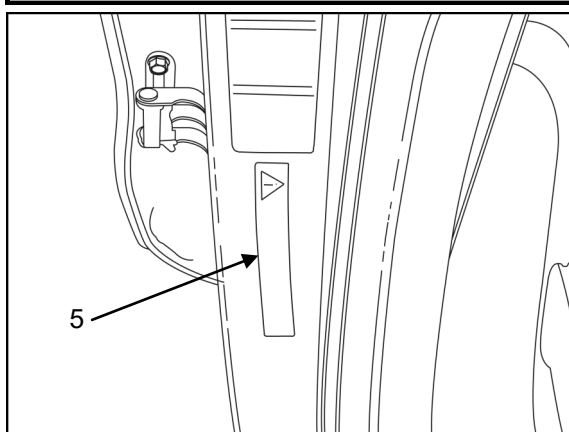

opening just below side airbag warning label as shown, using a clean rag. Affix orange warning label (5) at that location as shown.

42. At each of the cut outs in the mesh on



## ASSEMBLE STRAPS TO CARGO BARRIER

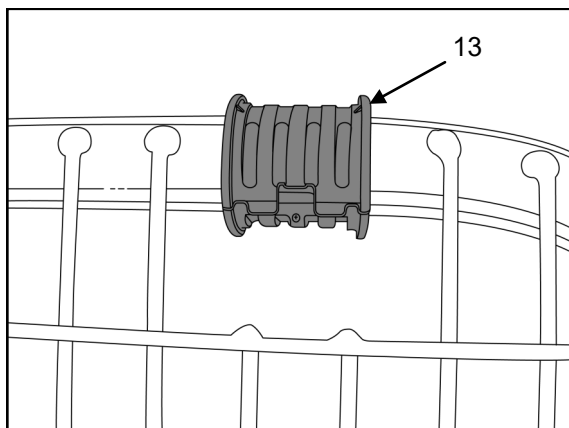

*Note: Refer to page 12 for detail of correct strap locations and orientation.*

the perimeter of the cargo barrier, place a pivot saddle bush (13) as shown.

43. Place a pivot saddle (14) over each of

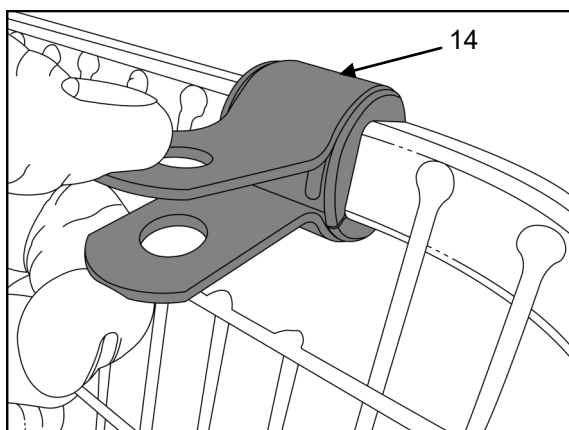

the pivot saddle bushes then push the ends together.

44. Place the correct strap in between the

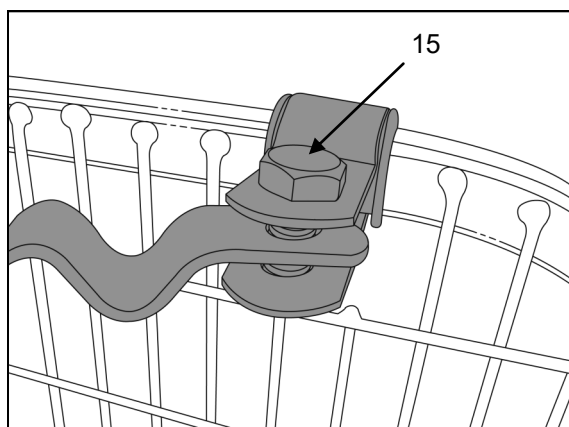

pivot saddle ends then place a hex screw (15) through the saddle and strap.

45. Place a nyloc hex nut (16) onto each of

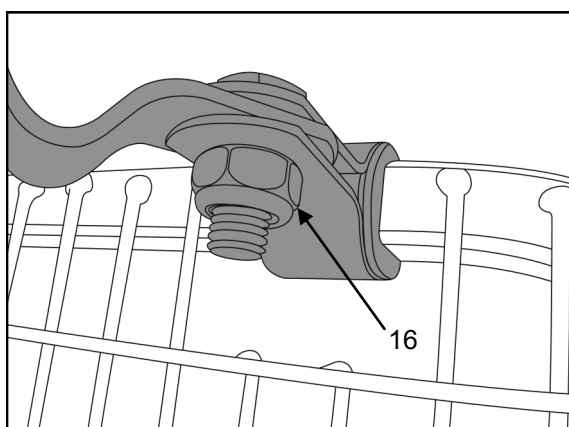

the hex screws then tighten until the strap is firm in saddle but can still be pivoted.



## **INSTALLATION OF CARGO BARRIER** **'Behind 2nd row of seats'**

- Remove cargo blind if installed.
- Fold 2nd row seats forward to allow space to manoeuvre cargo barrier into position.
- Ensure all straps are pivoted towards the meshed side of the cargo barrier.
- Manoeuvre cargo barrier into vehicle with the rating label (meshed side of cargo barrier) facing the rear of the vehicle. Locate cargo barrier in the behind 2nd row seat position.
- The AutoShift support braces can be used as shown on page 15 to support the cargo barrier whilst attaching the securing straps. Place support braces in the parked position as shown after securing the cargo barrier.
- Attach the top straps to the upper mounts using 29mm Milbolts (10) with wave washers (12) under heads.
- Attach the bottom straps to the bottom mounts using 19mm Milbolts (11) with wave washers (12) under heads.
- Tighten all Milbolts.
- Replace cargo blind if required.
- Put the 2nd row seats back to their upright position.

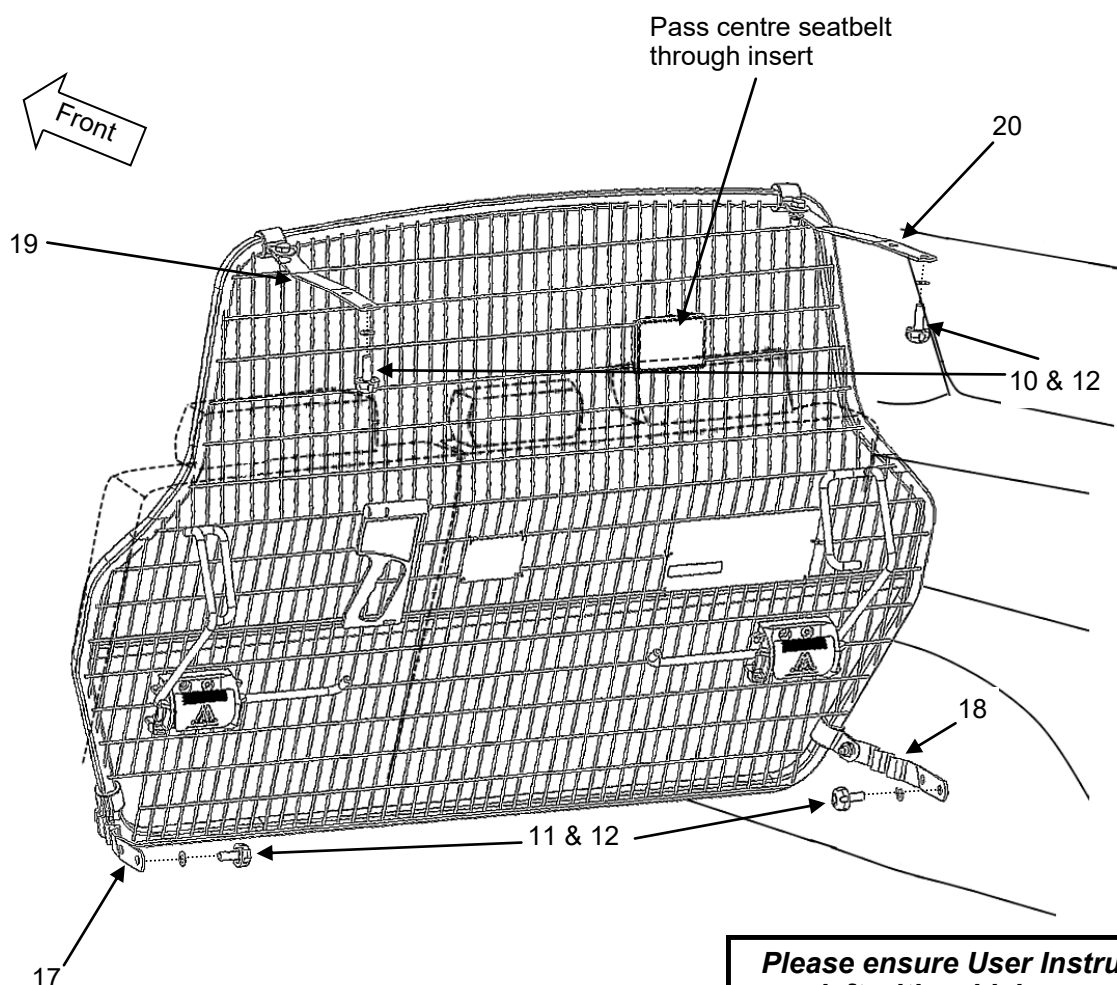

**Please ensure User Instructions are left with vehicle owner after installation.**



**IMPORTANT NOTE: Check that all bolts and screws are tight and re check periodically.**



## FRONT POSITION COMPONENTS

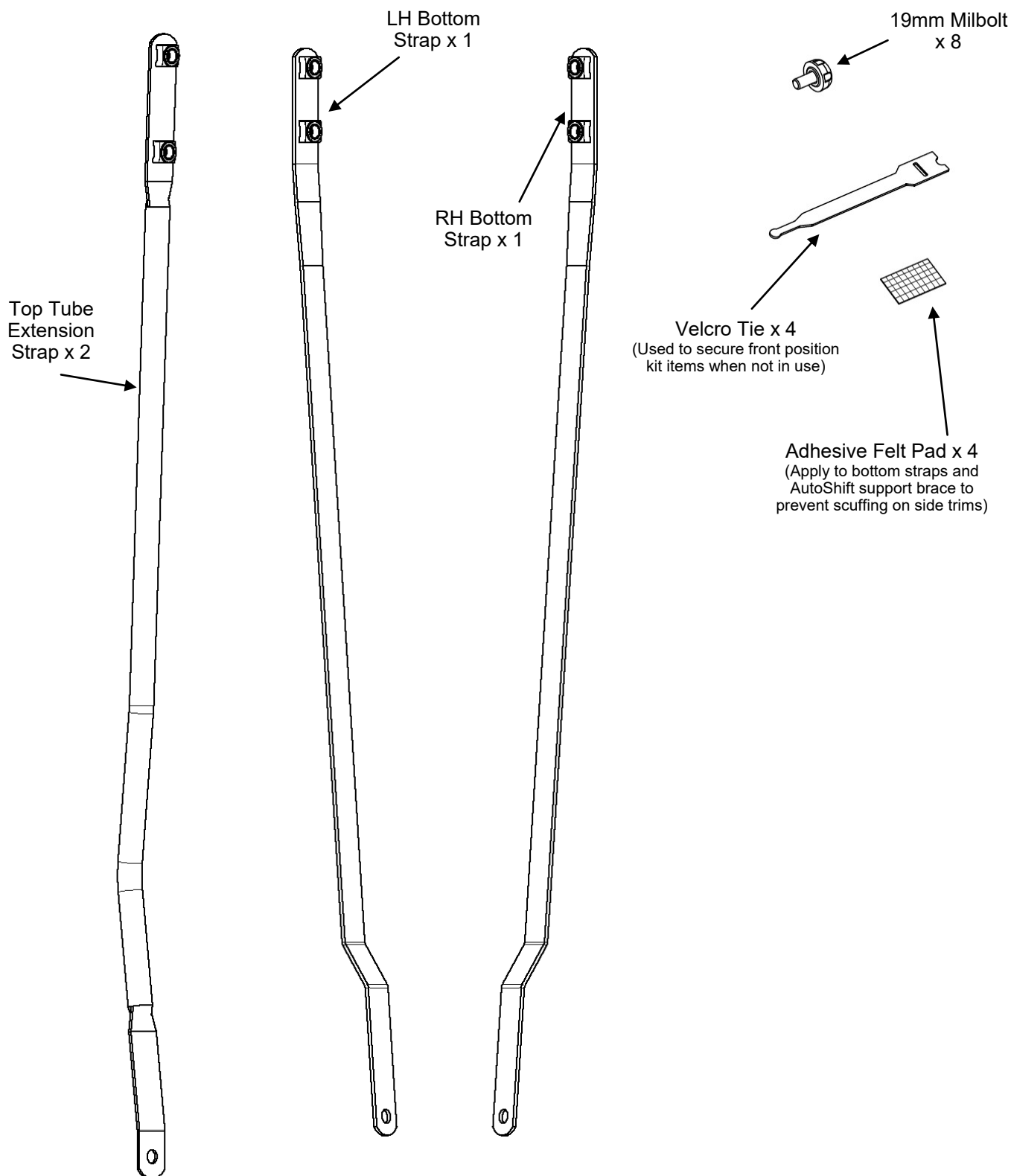





## INSTALLATION OF CARGO BARRIER 'Behind 1st row of seats'

- Ensure the head restraints for the 2nd row seats are in the fully down position.
- Lay the 2nd row seats down flat as shown in owners manual.
- Slide the front seats forward on runners to allow space to manoeuvre cargo barrier.
- Remove the cargo blind if fitted.
- Place the AutoShift support braces in the rear position assist location as shown on page 15.
- If moving from the rear position undo all Milbolts.
- Tilt the cargo barrier backwards then slide forward until the support braces are about 300mm from the front edge of the folded seat backs.
- Lay the cargo barrier on its meshed side in the cargo area.
- Pull the support braces outwards then lock in position as shown. Refer to page 15 for more detail.
- Lift the cargo barrier up with the bottom of the cargo barrier sitting in front of the folded seats and the support braces taking the weight of the cargo barrier as shown.
- Attach the tube extension straps to the top straps using 19mm Milbolts. 2 per strap.
- Attach the other end of the tube extension straps to the upper mounts using 29mm Milbolts (10) with the wave washers (12) under heads.
- Remove the 19mm Milbolts securing the short bottom straps to the cargo barrier if not already done.
- Attach the long bottom straps to the cargo barrier brackets as shown using 19mm Milbolts.
- Attach the other end of the long bottom straps to the bottom mounts using 19mm Milbolts (11) with the wave washers (12) under heads.
- Tighten all Milbolts including the ones securing the bottom straps to cargo barrier.
- *First time use* - At the location where the long bottom straps come into close proximity of the wheel arch trims, affix an adhesive felt pad to the straps to prevent scuffing of the trim.

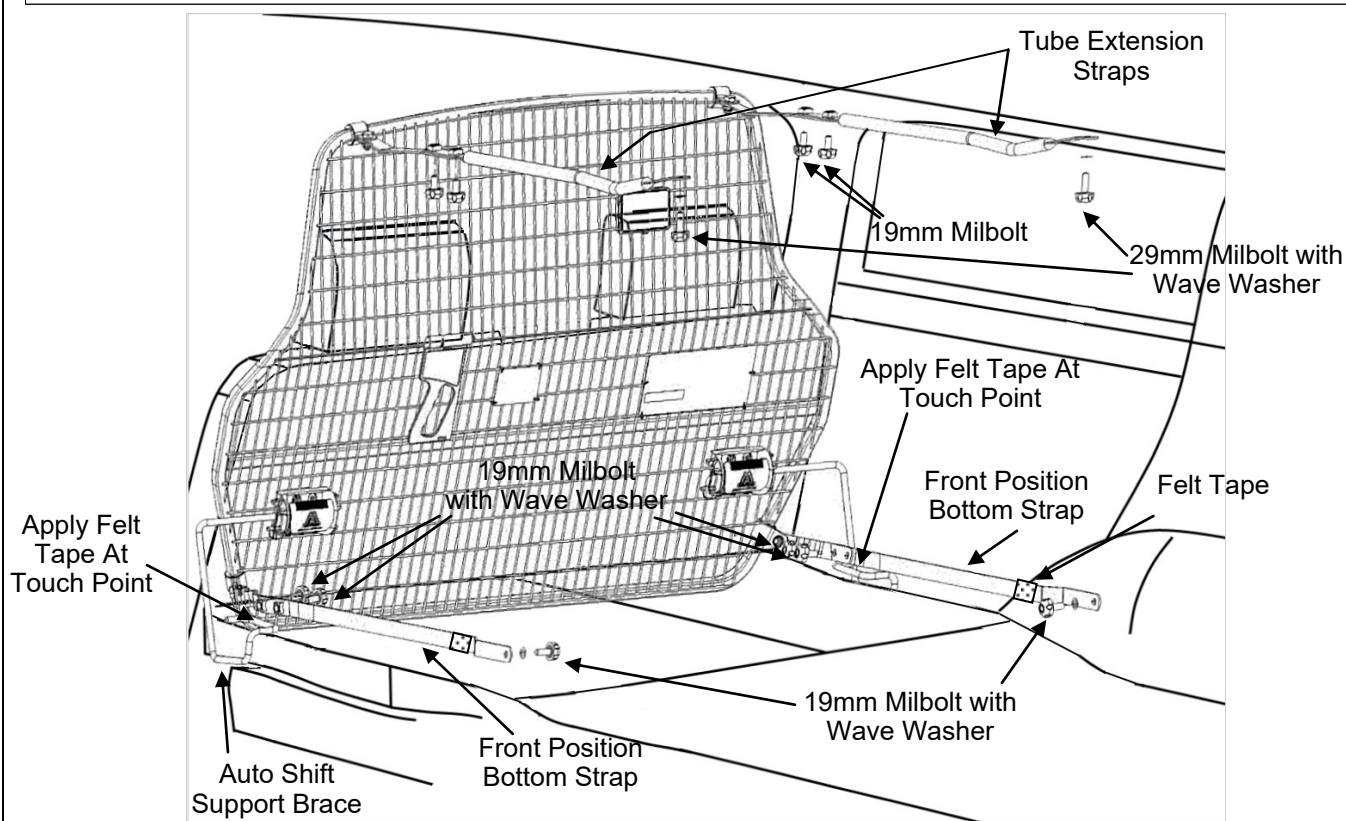

**IMPORTANT NOTE: Check that all bolts and screws are tight and re check periodically.**



## USING THE AutoShift EQUIPPED CARGO BARRIER

The AutoShift has 3 main modes to assist in installing, relocating and securing the cargo barrier in the vehicle.

1. **The parked position** - Use this position when the cargo barrier is installed in the behind 2nd row seats position.
2. **The behind 2nd row seats installation assist and cargo barrier relocation position** - Use this position to hold the cargo barrier upright whilst securing the mounting straps to the vehicle when using in the rear location, and as a slide to assist in moving the cargo barrier between positions.
3. **The behind 1st row seats support and stabilise position** - Use this position to support the cargo barrier at the correct height behind the 1st row seats, and to keep the cargo barrier laterally secure.

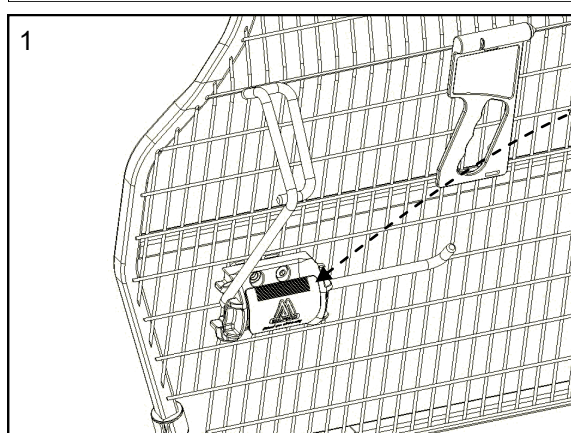

Release the clamping handle before moving the adjustable AutoShift support brace between positions. Use the clamping handle to lock the wire brace after positioning in the required position.



**Important:**  
Ensure the adjustable AutoShift support brace is fully engaged in the pivot housing as shown, before using in positions 2 or 3.

