

Fitting Instructions #5293IS

Jeep Cherokee KL (2014-On)

Control Arm Lower Inner Bush Kit

Note: Polyurethane bushings must be fitted to both sides of the vehicle.

- Wheel-align the vehicle before the job is started and note settings;
- Jack the vehicle up and support on jack stands;
- Remove the vertical bracket from the side of the lower load beam;

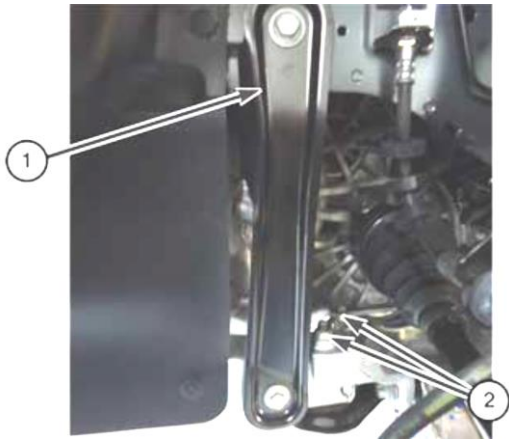

- Remove front bumper clip to gain access to the load beam bolts and extensions. Use a swivel head ratchet to undo the bolts.

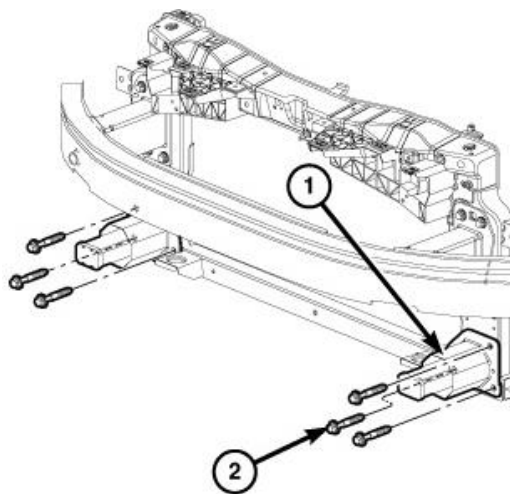

- Remove the bolts and the lower load beam bracket



- Remove the lower load beams;

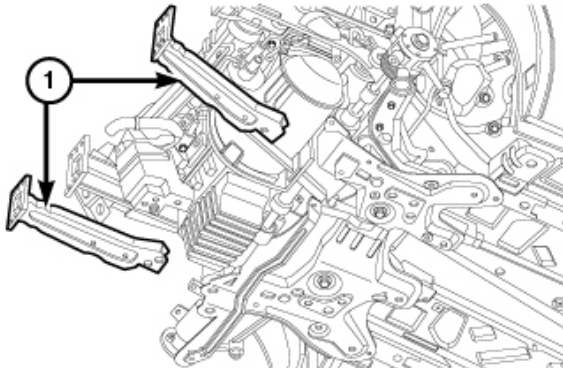

- Proceed to remove the front lower control arms from the vehicle;
- Remove original shell part bush from the housing with the use of a hydraulic press and suitable pressing tools;
- With reference to Table 01, align the rear bushing in the housing so that the hole in the bushing is positioned to give the desired castor result, then press the new '5293' and/or '5294' bushes into the control arm;
- Apply the white grease supplied to the bore of the bush, the outside of the crush tube and the inside of the poly spacers, then push in the crush tube and fit the poly spacers.

Side view of assembled new part in control arm

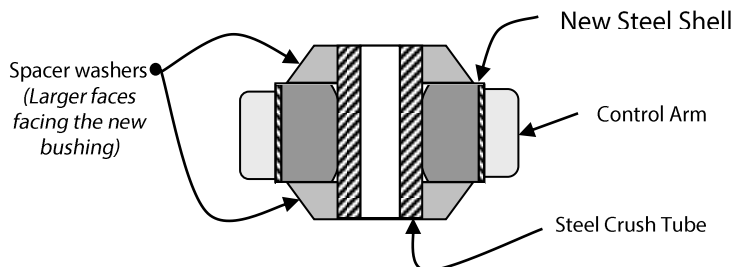

Note the orientation of the Spacer Washers.

- Install the front bush and crush tube with reference to figure below, ensure to apply grease on all mating surfaces;

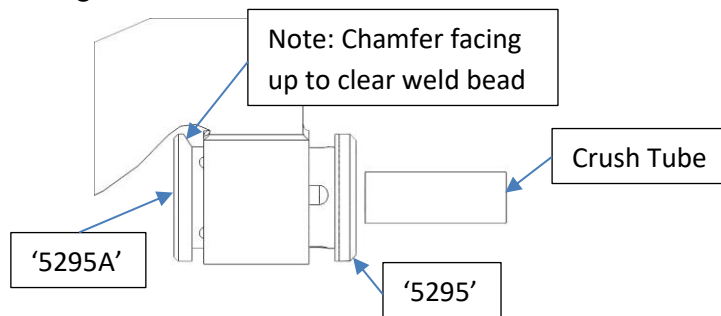

- Refit the control arms & load beams to the vehicle. Tighten all bolts to manufacture's torque settings and carry out a wheel alignment;

By offsetting the location of the **rear bush**, castor variation can be achieved.

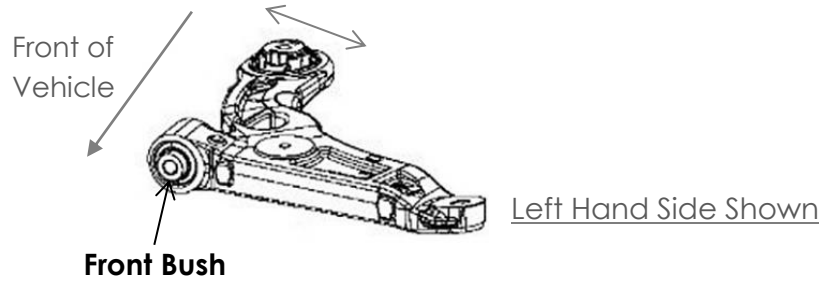
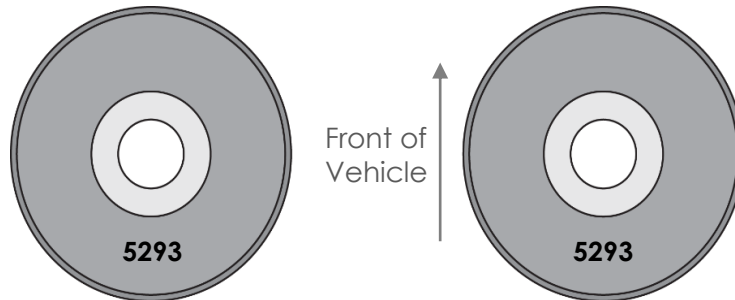
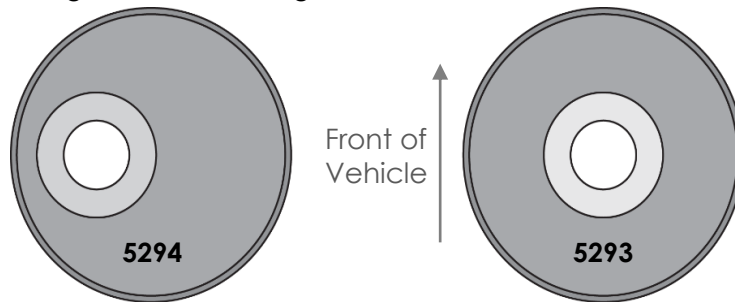

Table 01 – Castor Settings - As viewed from the top of the control arm.

Kit SPF5293K – Standard Replacement - No castor change



Kit SPF5603K – To counteract a slight pull to the left
Single Offset, Passenger's side castor increase



Kit SPF5294K – To counteract a strong pull left
Passenger's side castor increase and driver's side castor decrease

