

# Installation Guide

## Front Upper Inner Control Arm

Suits: Mitsubishi L400

50-5526

*(Always refer to the current catalogue for complete application listings)*

**N.B:** These instructions should be used in conjunction with the workshop manual.

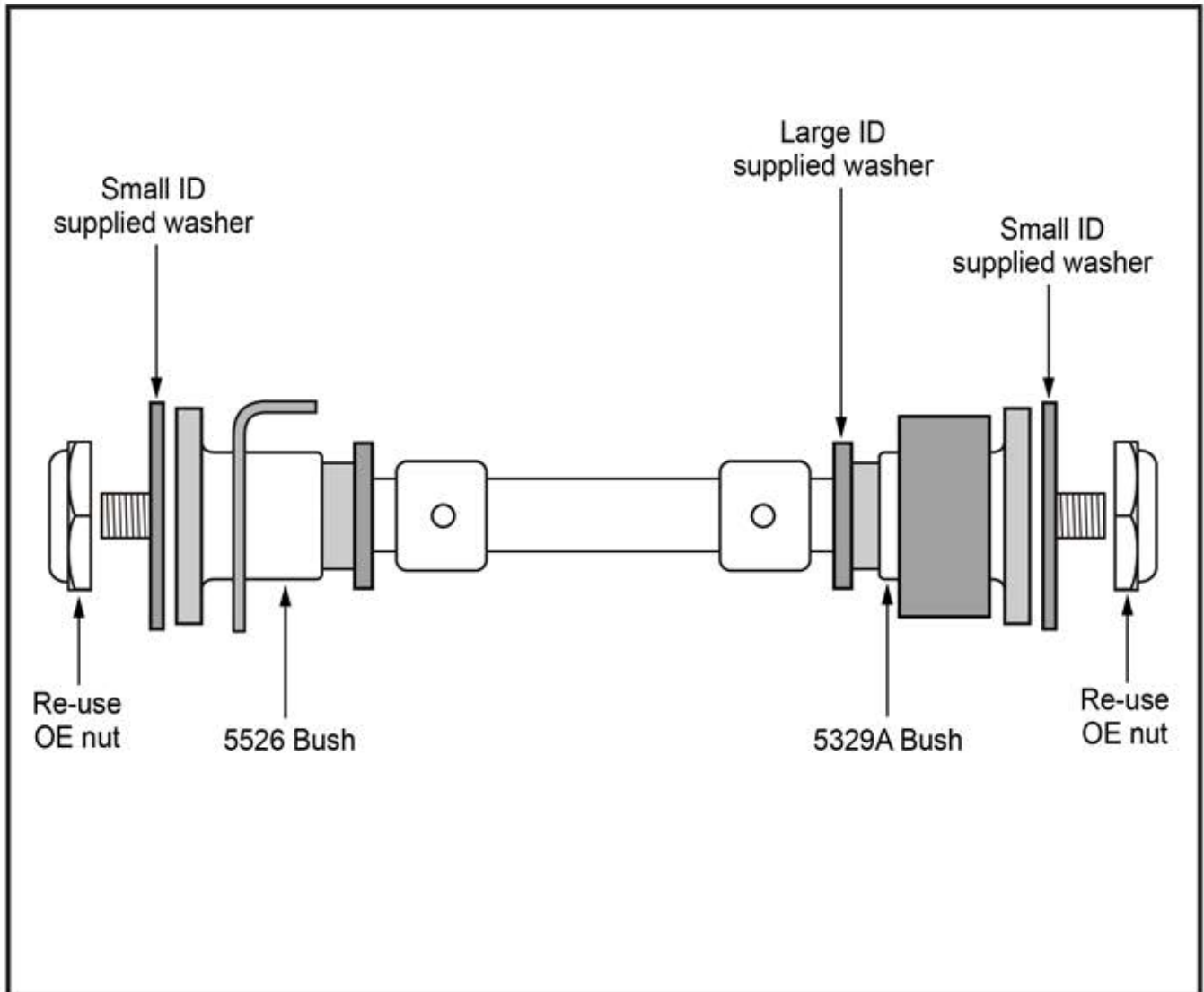

**N.B:** It is recommended that a licenced workshop or trades person carry out the above procedure and that workshop manual and relevant safety procedures are followed in addition to the above.