

Install Guide

Billet Upper Trailing Arms

Toyota LC300, LC250, Tacoma, 4Runner, Tundra, Sequoia



Note: These components must be fitted by a qualified person only, as per the manufacturers' service manual. Also, all relevant safety procedures are followed in addition to the following. Photos are an indication and may vary slightly in appearance from the actual product.

Kit Contents:

- 1x LH Upper Trailing Arm
- 1x RH Upper Trailing Arm
- 1x Headlight Sensor Bracket
- 2x M6 Bolts

1. This installation can be completed on the ground, a 4-post hoist, or using jack stands or a 2-post hoist. Ensure the vehicle is safely supported before starting.
2. Working on one side at a time, remove the front and rear upper trailing arm bolts to detach the factory trailing arm. Retain the OEM bolts for reinstallation.
3. Before installing the new arms, remove the bushing cups and apply sufficient grease to the inside of the bushings. Reinstall the cups securely.
4. Locate the directional marker on the top side of the billet arm. This marker identifies the front (chassis-side) position. The logo plate should face toward the wheel once installed.
5. For the RH arm, if your vehicle is fitted with a factory height sensor, you will need to install the supplied headlight sensor bracket onto the arm. The bracket is installed onto the top of the RH billet arm using the furthest 2x holes from the bushing and the 2x supplied M6 bolts (see image below).

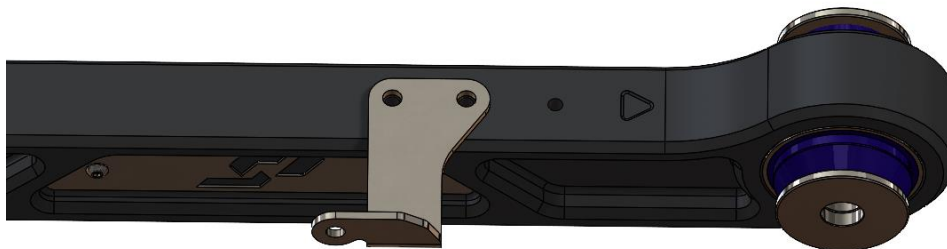

6. For Tundra's fitted with Factory Load-Levelling Rear Height Control Air Suspension, an additional bracket kit **ALOY1002BK** will need to be purchased. These brackets are installed onto both arms using the first 2x holes on the top side of the arm. Match the orientation to the factory arms.
7. Install the billet trailing arm according to the directional marker and reuse the OEM bolts. Hand-tighten initially.

Install Guide

Billet Upper Trailing Arms

Toyota LC300, LC250, Tacoma, 4Runner,
Tundra, Sequoia



8. Repeat the process on the opposite side.
9. Torque all bolts to factory specifications once both sides are installed.
10. After 1,000 km (600 miles) or 1 month, recheck and re-torque all bolts to ensure proper fitment and safety.